

VÄDERSTAD

Carrier X

CRX 425-625

No. 101-



**Reservdelsbok
Spare Parts List
Ersatzteilverzeichnis**

902605
08.09.2011 1



Замовлення запчастин

(050)-407-68-47

(050)-407-68-45

1 Förklaringar av koder Explanations of codes Erklärung kodes

Fig. / Abb.

1	Antal slitdelar, Number of wear plates, Anzahl verschleißteil	7
2	Ram, CR, Frame, CR, Rahmen, CR	9
3	Ram, Frame, Rahmen.....	11
4	Ram, Frame, Rahmen.....	13
5	Ram, Frame, Rahmen.....	15
6	Ram, System Disc, Frame, System Disc, Rahmen, System Disc.....	17
7	System Disc, System Disc, System Disc.....	19
8	Vältpaket, Stål, Roller ring unit, Steel, Walzenpaket, Stahl	21
9	Vältpaket, Gummi, Roller ring unit, Rubber, Walzenpaket, Gummi	23
10	Vältpaket, Ribbvält, Roller ring unit, Cage Roller, Walzenpaket, Krümlerwalze	25
11	Avskrapare, Stål, Scraper, Steel, Abstreifer, Stahl.....	27
12	Avskrapare,, Gummi, Scraper,, Rubber, Abstreifer,, Gummi	29
13	Utjämnare, Leveler, Ausgleicher	31
14	Hydraulik, Ram, Hydraulics, Frame, Hydraulik, Rahmen	33
15	Hydraulik, Ram, Hydraulics, Frame, Hydraulik, Rahmen	35
16	Hydraulik, System Disc, Hydraulics, System Disc, Hydraulik, System Disc	37
17	Belysning, Lighting, Beleuchtung	39
18	Säkerhetspaket, Standard, Security package, Standard, Sicherheitspaket, Standard	41
19	Säkerhetspaket, Frankrike, Security package, France, Sicherheitspaket, Frankreich	43
20	Säkerhetspaket, Tyskland, Security package, Germany, Sicherheitspaket, Deutschland	45
21	Dekaler, Decals, Aufkleber	47

(050)-407-68-47

(050)-407-68-45

1 Förklaringar av koder

Explanations of codes

Erklärung kodes

Förkortning Shortening Verkürzungen	Svenska	English	Deutsch
EXT	Förlängning	Extension	Verlängerung
LH	Vänster	Left hand	Links
RH	Höger	Right hand	Rechts
IN	Inre	Inner	Innere
OUT	Yttre	Outer	Äußere
UP	Övre	Upper	Obere
LOW	Undre	Lower	Untere
FR	Främre	Front	Vordere
REAR	Bakre	Rear	Hintere
CR	Mitt	Center	Mitte
ML	Hane	Male	Männchen
FML	Hona	Female	Weibchen
SPEC	Special	Special	Special
PL	Slät	Plain	Glatt
ST	Rak	Straight	Gerade
TW	Vriden	Twisted	Gedreht
ANG	Böjd	Bent	Gebogen
TO	Tandad	Toothed	Gezahnt
TR	Traktormönstrat	Tractor tread	Tractor profil
RB	Ribbat	Ribbed	Gerippt
ASSY	Komplett	Complete	Komplett
P.OF	Antal i förpackning	Package of	Anzahl pro Verpackung
DI	Diameter inre	Inner diameter	Innendurchmesser
DO	Diameter yttre	Outer diameter	Außendurchmesser
D	Hydraulicylinder diameter	Hydraulicylinder diameter	Hydraulicylinder durchmesser
H	Höjd	Height	Höhe
L	Längd	Length	Länge
T	Tjocklek	Thickness	Dicke
V	Volym	Volume	Volumen
W	Bredd	Width	Breite
WI	Bred	Wide	Breit
NW	Smal	Narrow	Schmal
Z	Antal kuggar	Number of cogs	Anzahl Zacken

(050)-407-68-45



Замовлення запчастин

(050)-407-68-47

(050)-407-68-45

Antal slitdelar / maskin
Number of wear plates / machine
Anzahl verschleißteil / maschine

		425	525	625
Antal tallrikar, System Disc Number of discs, System Disc Anzahl Scheiben, System Disc	474609	2	2	2
	466947	32	40	48
Antal vältringar, stål Number of roller rings, steel Anzahl Walzenringe, Stahl	479234	4	4	4
	479231	32	40	48
Antal vältringar, gummi Number of roller rings, rubber Anzahl Walzenringe, Gummi	467612	4	4	4
	465106	2	-	-
	465108	16	22	26



Замовлення запчастин

(050)-407-68-47

(050)-407-68-45



Замовлення запчастин

(050)-407-68-47

(050)-407-68-45

Fig. / Abb. 2

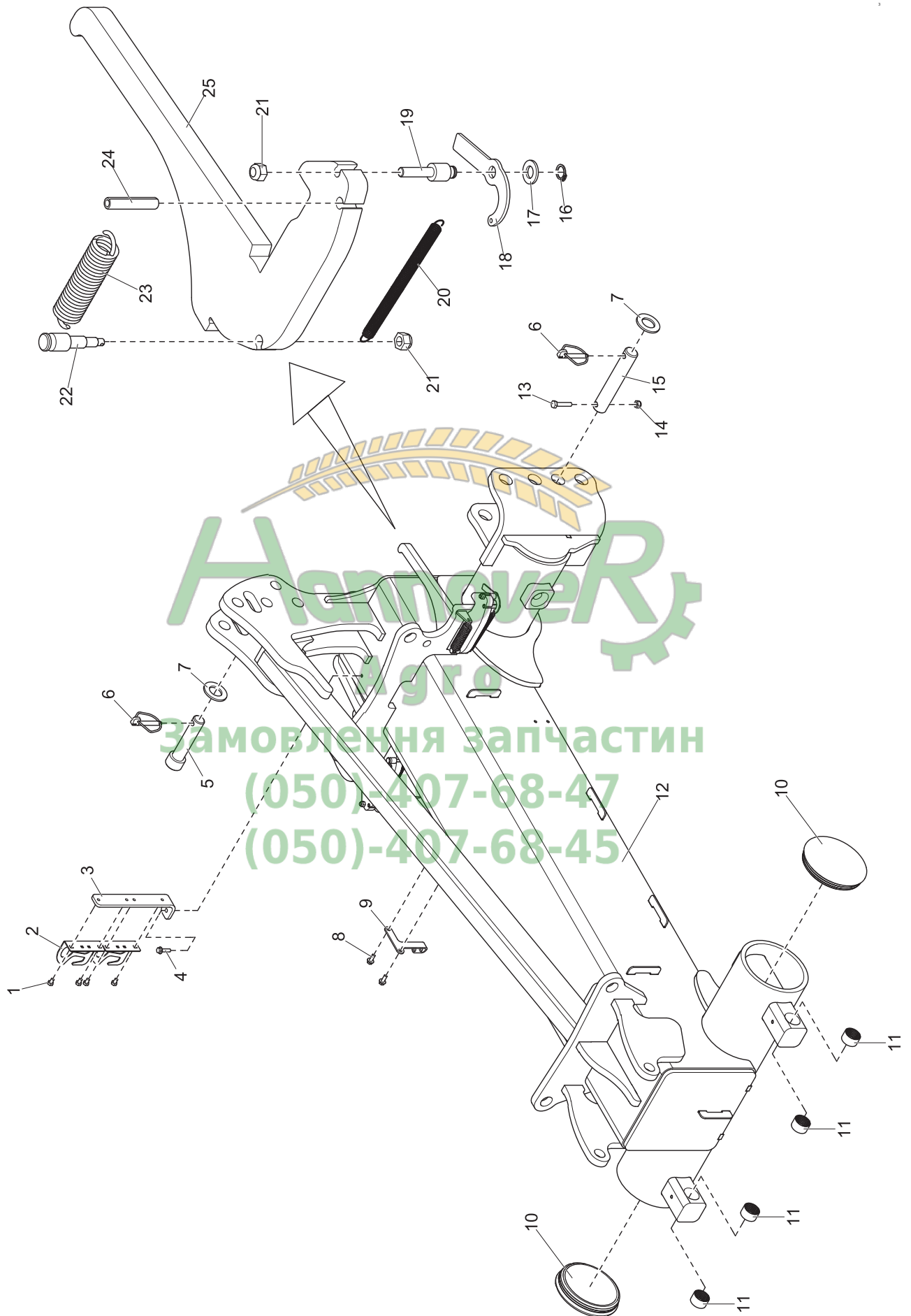
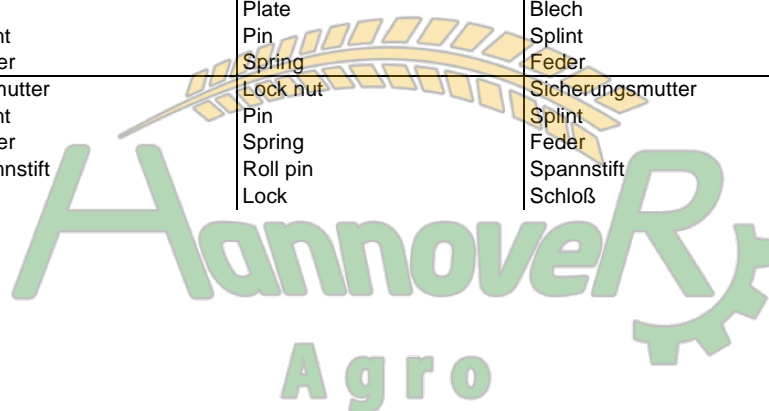

Fig. / Abb. 2

Ram, CR
Frame, CR
Rahmen, CR

CRX 425-625
101 -

Pos	No.	Svenska	English	Deutsch	Dim
1	50000801221	Skruv	Screw	Schraube	M8x12
2	449609	Plåt	Plate	Blech	
3	497608	Fäste	Bracket	Halterung	
4	50140803021	Skruv	Screw	Schraube	
5	487774	Sprint	Pin	Splint	
6	454400	Sprint	Pin	Splint	
7	52003600041	Bricka	Washer	Scheibe	M36
8	50140802021	Skruv	Screw	Schraube	
9	498476	Fäste	Bracket	Halterung	
10	496633	Plugg	Plug	Pfropfen	
11	496653	Glidlager	Slide bearing	Gleitlager	
12	496280	Sektion	Section		
13	50001005021	Skruv	Screw	Schraube	M10x50
14	51011000021	Låsmutter	Lock nut	Sicherungsmutter	M10
15	476635	Sprint	Pin	Splint	
16	54001000091	Låsring	Circlip	Seegerring	SGA 10
17	52001000041	Bricka	Washer	Scheibe	M10
18	458206	Plåt	Plate	Blech	
19	459103	Sprint	Pin	Splint	
20	458221	Fjäder	Spring	Feder	
21	51010800021	Låsmutter	Lock nut	Sicherungsmutter	M8
22	459107	Sprint	Pin	Splint	
23	441343	Fjäder	Spring	Feder	
24	53001005091	Spännstift	Roll pin	Spannstift	Ø10x50
25	497079	Lås	Lock	Schloß	



Замовлення запчастин
(050)-407-68-47
(050)-407-68-45



Ram
Frame
Rahmen
CRX 425
101 -

Pos	No.	Svenska	English	Deutsch	Dim	
1	491841	Ram	Frame	Rahmen		LH
2	467862	Glidlager	Slide bearing	Gleitlager		
3	464730	Tapp	Stud	Zapfen		
4	50002415011	Skruv	Screw	Schraube	M24x150, 10.9	
5	467866	Lock	Cover	Deckel		
6	407661	Smörjnippel	Grease nipple	Schmiernippel	ST, M8	
7	491842	Ram	Frame	Rahmen		RH
8	51170800021	Mutter	Nut	Mutter		
9	496631	Visare	Indicator	Zeiger		
10	50000803021	Skruv	Screw	Schraube	M8x30	



Замовлення запчастин
(050)-407-68-47
(050)-407-68-45

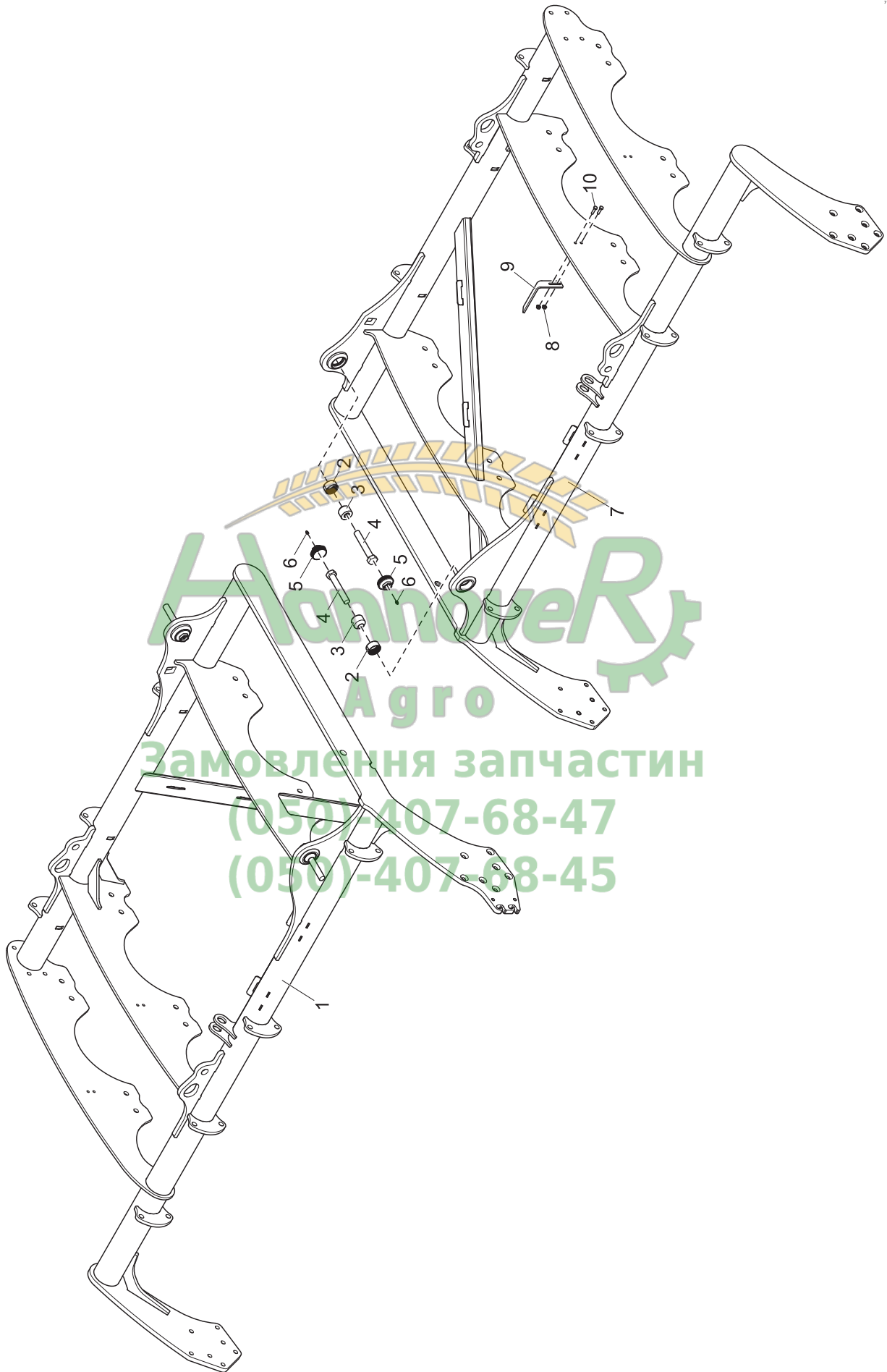

Ram
Frame
Rahmen
CRX 525
101 -

Pos	No.	Svenska	English	Deutsch	Dim	
1	493353	Ram	Frame	Rahmen		LH
2	467862	Glidlager	Slide bearing	Gleitlager		
3	464730	Tapp	Stud	Zapfen		
4	50002415011	Skruv	Screw	Schraube	M24x150, 10.9	
5	467866	Lock	Cover	Deckel		
6	407661	Smörjnippel	Grease nipple	Schmiernippel	ST, M8	
7	493354	Ram	Frame	Rahmen		RH
8	51170800021	Mutter	Nut	Mutter		
9	496631	Visare	Indicator	Zeiger		
10	50000803021	Skruv	Screw	Schraube	M8x30	

Замовлення запчастин
(050)-407-68-47
(050)-407-68-45

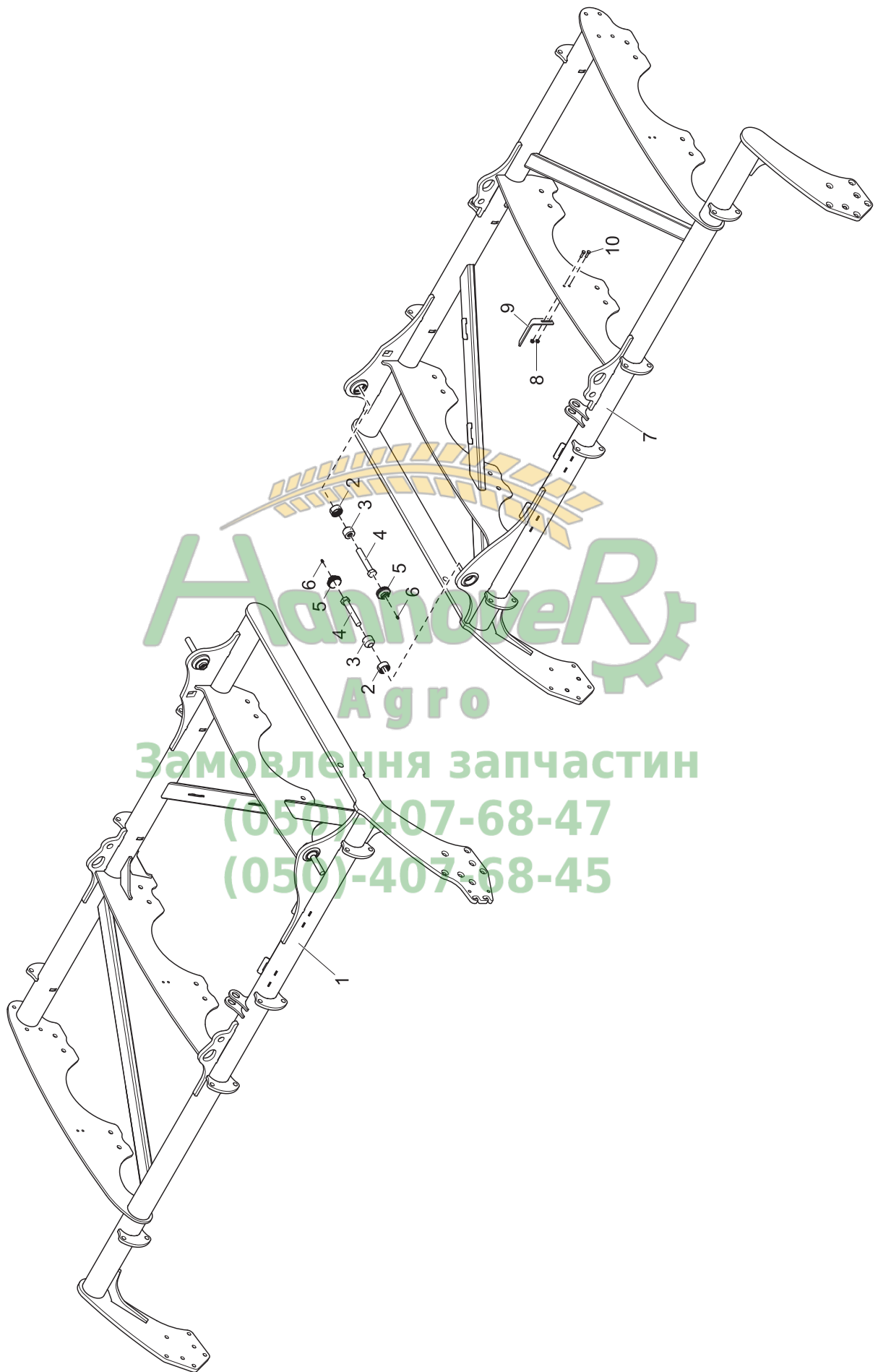

Ram
Frame
Rahmen
CRX 625
101 -

Pos	No.	Svenska	English	Deutsch	Dim	
1	496281	Ram	Frame	Rahmen		LH
2	467862	Glidlager	Slide bearing	Gleitlager		
3	464730	Tapp	Stud	Zapfen		
4	50002415011	Skruv	Screw	Schraube	M24x150, 10.9	
5	467866	Lock	Cover	Deckel		
6	407661	Smörjnippel	Grease nipple	Schmiernippel	ST, M8	
7	496282	Ram	Frame	Rahmen		RH
8	51170800021	Mutter	Nut	Mutter		
9	496631	Visare	Indicator	Zeiger		
10	50000803021	Skruv	Screw	Schraube	M8x30	

Замовлення запчастин
(050)-407-68-47
(050)-407-68-45

Fig. / Abb. 6

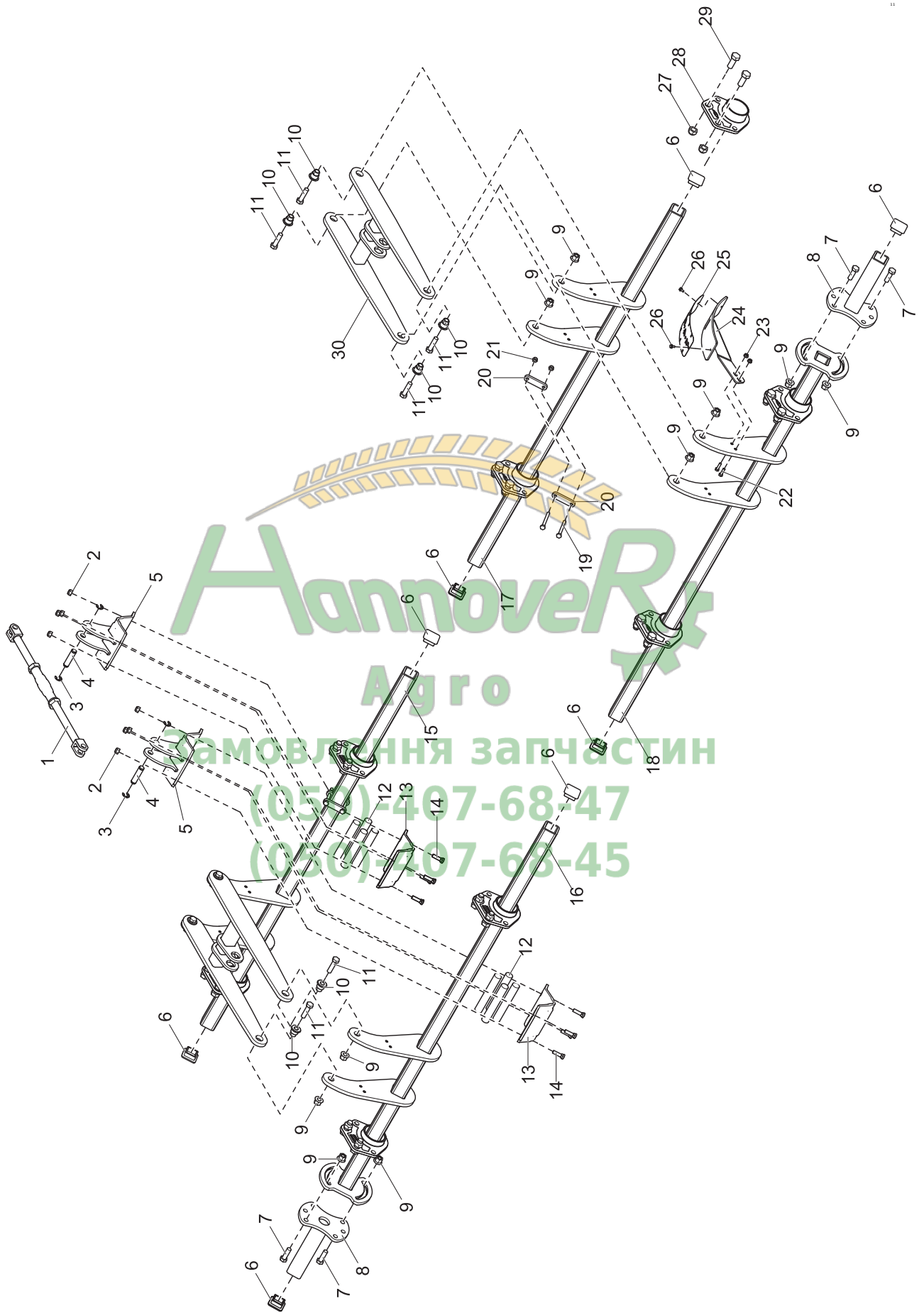

Ram, System Disc
Frame, System Disc
Rahmen, System Disc

CRX 425-625
101 -

Pos	No.	Svenska	English	Deutsch	Dim	
1	474591	Tryckstång	Push rod	Druckstange		
2	51011200021	Låsmutter	Lock nut	Sicherungsmutter	M12	
3	54021500091	Låsring	Circlip	Springring	RS15	
4	411253	Sprint	Pin	Splint	Ø20x85	
5	486388	Överfall	Cover	Führungsplatte		
6	413896	Plastplugg	Plastic plug	Kunststoffpfropfen	60x60	
7	50001605021	Skruv	Screw	Schraube	M16x50	
8	496287	Fäste	Bracket	Halterung		
9	51131600021	Låsmutter	Lock nut	Sicherungsmutter	M16	
10	493726	Hylsa	Sleeve	Hülse		
11	50001606021	Skruv	Screw	Schraube	M16x60	
12	450991	Gummistav	Rubber bar	Gummistab	L:190 mm	
13	307168	Överfall	Cover	Führungsplatte	200 mm	
14	428571	Vagnsbult	Carriage bolt	Bolzen	M12x42, 10.9	
15	492337	Axel	Axle	Achse		425, LH, FR
15	492347	Axel	Axle	Achse		525, LH, FR
15	491766	Axel	Axle	Achse		625, LH, FR
16	496299	Axel	Axle	Achse		425, LH, REAR
16	496297	Axel	Axle	Achse		525, LH, REAR
16	496285	Axel	Axle	Achse		625, LH, REAR
17	492343	Axel	Axle	Achse		425, RH, FR
17	492353	Axel	Axle	Achse		525, RH, FR
17	491772	Axel	Axle	Achse		625, RH, FR
18	496300	Axel	Axle	Achse		425, RH, REAR
18	496298	Axel	Axle	Achse		525, RH, REAR
18	496286	Axel	Axle	Achse		625, RH, REAR
19	50001010021	Skruv	Screw	Schraube	M10x100	
20	474237	Platta	Plate	Platte		
21	51011000021	Låsmutter	Lock nut	Sicherungsmutter	M10	
22	50000803021	Skruv	Screw	Schraube	M8x30	
23	51170800021	Mutter	Nut	Mutter		
24	496630	Fäste	Bracket	Halterung		
25	493592	Skala	Scale	Skala		
26	50140601221	Skruv	Screw	Schraube	M6x12	
27	51022000021	Låsmutter	Lock nut	Sicherungsmutter	M20	
28	446551	Fäste	Bracket	Halterung		
29	50002005021	Skruv	Screw	Schraube	M20x50	
30	486399	Fäste	Bracket	Halterung		

Fig. / Abb. 7

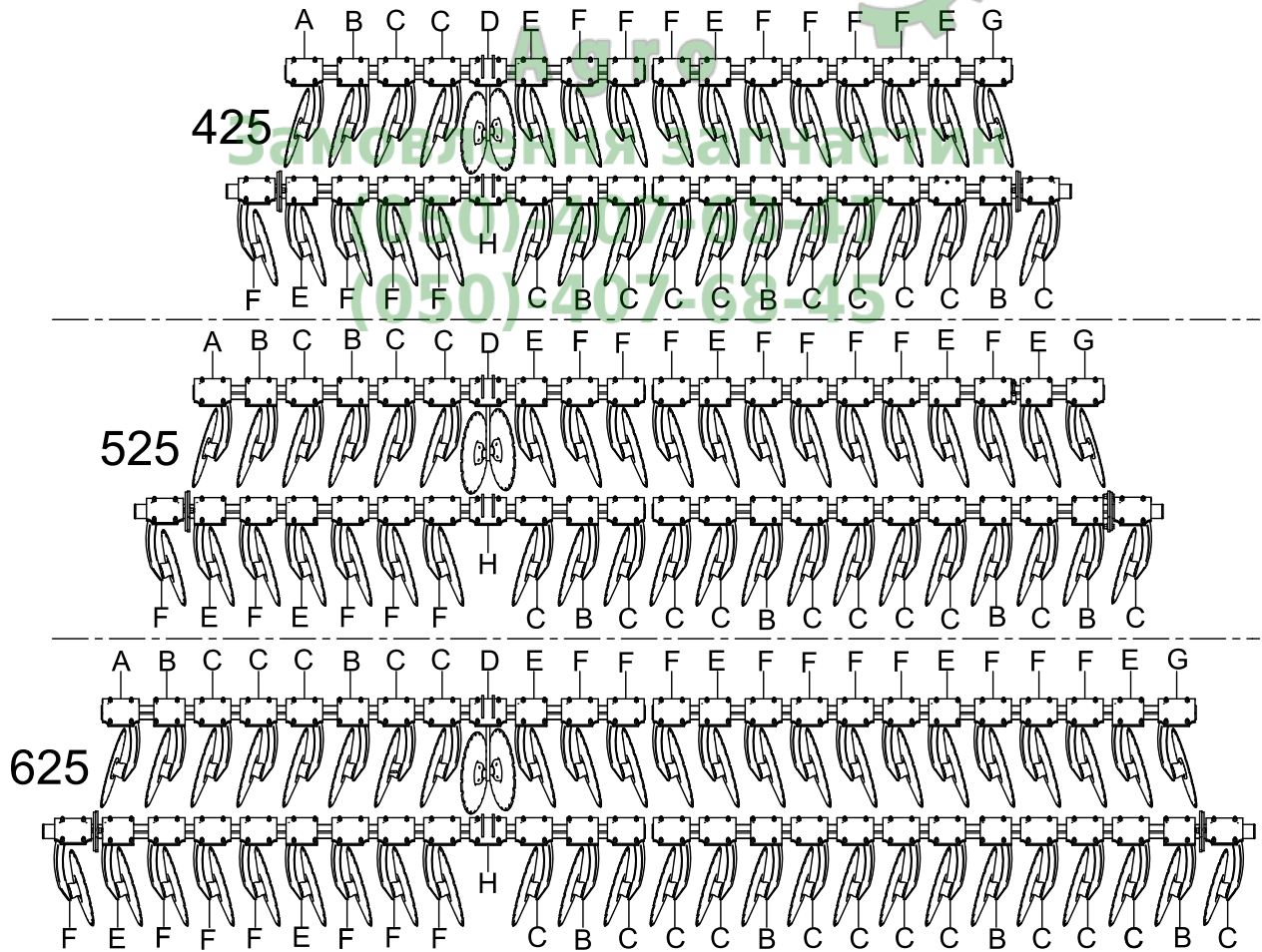
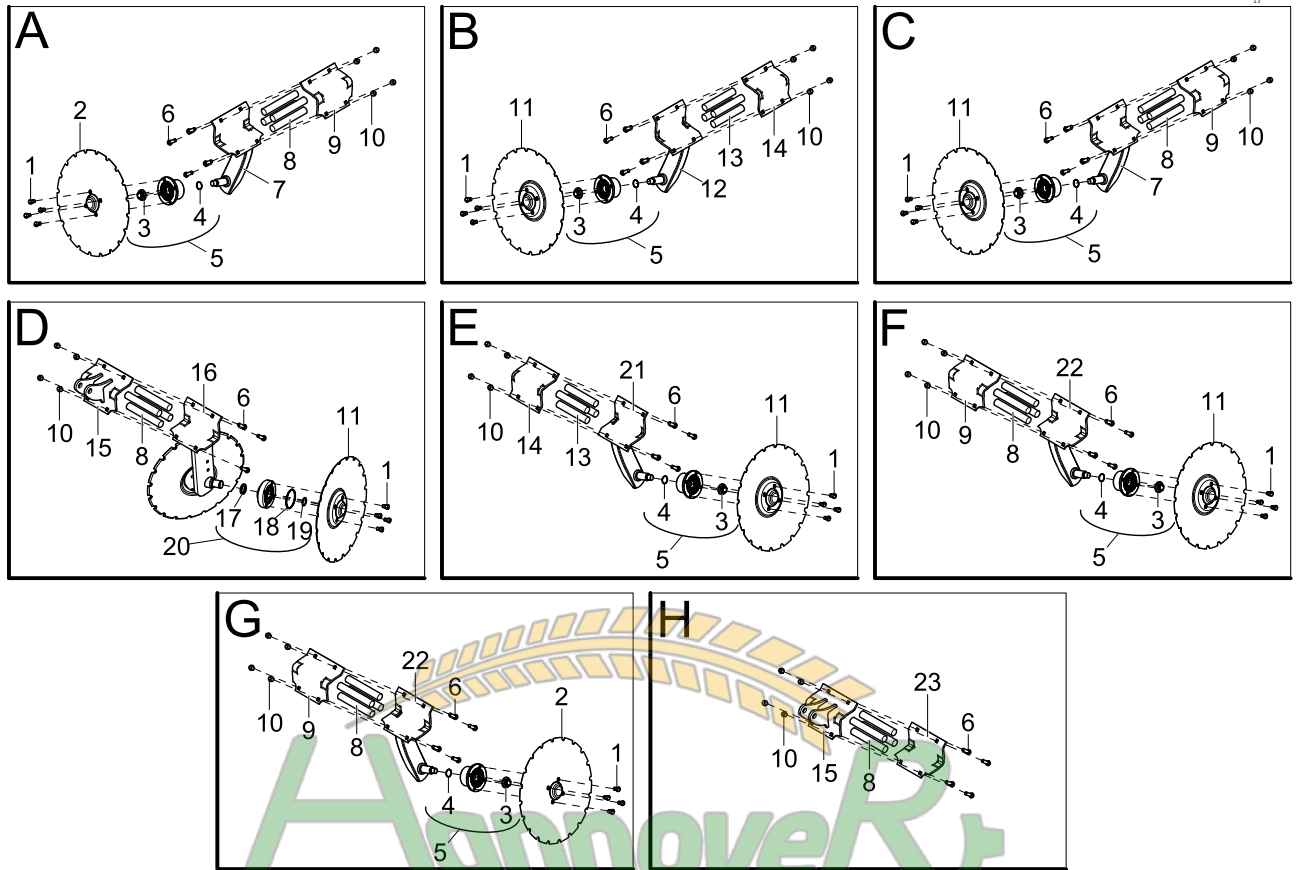

Pos	No.	Svenska	English	Deutsch	Dim
1	461262	Skruv	Screw	Schraube	
2	474609	Tallrik	Disc	Scheibe	
3	445483	Mutter	Nut	Mutter	M22
4	480005	O-ring	O-ring	Runddichtring	
5	482496	Hubb	Hub	Hub	ASSY
6	428571	Vagnsbult	Carriage bolt	Bolzen	M12x42, 10.9
7	489816	Tallriksarm, inkl. nav	Disc arm, incl. Hub	Scheibenarm, einschl. Nabe	
8	450991	Gummistav	Rubber bar	Gummistab	L:190 mm
9	307168	Överfall	Cover	Führungsplatte	200 mm
10	51011200021	Låsmutter	Lock nut	Sicherungsmutter	M12
11	466947	Tallrik	Disc	Scheibe	Ø450, V55
12	489818	Tallriksarm, inkl. nav	Disc arm, incl. Hub	Scheibenarm, einschl. Nabe	
13	414846	Gummistav	Rubber bar	Gummistab	L:170 mm
14	307169	Överfall	Cover	Führungsplatte	170 mm
15	486388	Överfall	Cover	Führungsplatte	
16	497058	Tallriksarm	Disc arm	Scheibenarm	
17	413545	V-ring	V-ring	V-Ring	
18	496644	O-ring	O-ring	Runddichtring	
19	406021	Låsring	Circlip	Seegerring	AS 30x2
20	496661	Sats	Kit	Satz	
21	489817	Tallriksarm, inkl. nav	Disc arm, incl. Hub	Scheibenarm, einschl. Nabe	
22	489815	Tallriksarm, inkl. nav	Disc arm, incl. Hub	Scheibenarm, einschl. Nabe	
23	307168	Överfall	Cover	Führungsplatte	200 mm

Annover
Agro

**Замовлення запчастин
(050)-407-68-47
(050)-407-68-45**

Fig. / Abb. 8

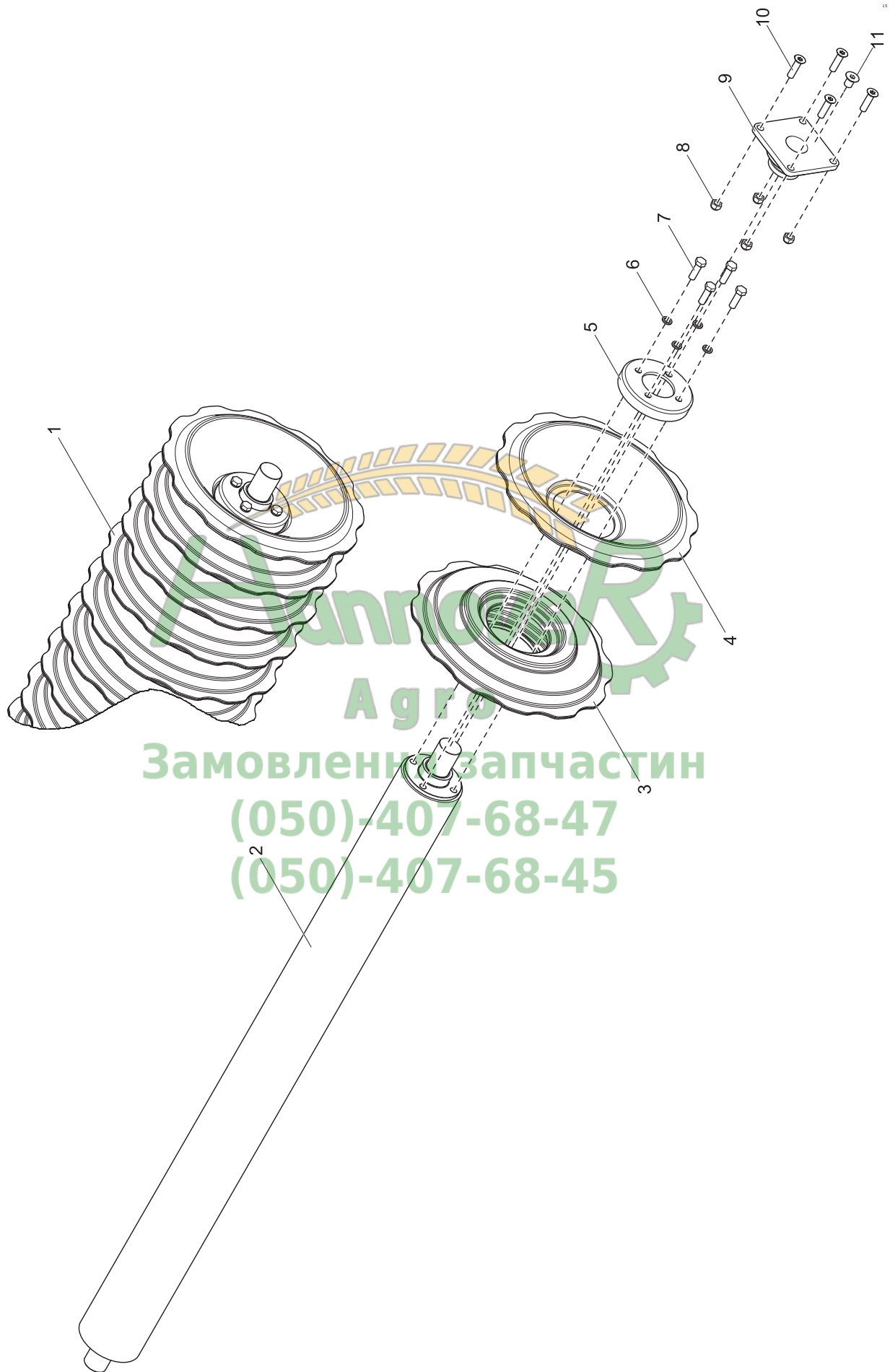

Замовлення запчастин
(050)-407-68-47
(050)-407-68-45

Fig. / Abb. 8
Vältpaket, Stål
Roller ring unit, Steel
Walzenpaket, Stahl
CRX 425-625
101 -

Pos	No.	Svenska	English	Deutsch	Dim	
1	490229	Vältpaket	Roller ring unit	Walzenpaket		425, LH, RH
1	490225	Vältpaket	Roller ring unit	Walzenpaket		525, LH, RH
1	484604	Vältpaket	Roller ring unit	Walzenpaket		625, LH, RH
2	490230	Axel	Axle	Achse		425, LH, RH
2	490226	Axel	Axle	Achse		525, LH, RH
2	484603	Axel	Axle	Achse		625, LH, RH
3	479231	Vältpaket	Roller ring unit	Walzenpaket		
4	479234	Vältring	Roller ring	Walzenringe		
5	489343	Bricka	Washer	Scheibe		
6	52081600041	Nordlockbricka	Nordlock washer	Scheibe, Nordlock	M16	
7	50001605021	Skruv	Screw	Schraube	M16x50	
8	51021600011	Låsmutter	Lock nut	Sicherungsmutter	M16, KI 10	
9	465889	Lagerhus	Bearing housing	Lagergehäuse		
10	50241606011	Skruv	Screw	Schraube	M16x60 T60	
11	50042002021	Skruv	Screw	Schraube		

Замовлення запчастин
(050)-407-68-47
(050)-407-68-45

Fig. / Abb. 9

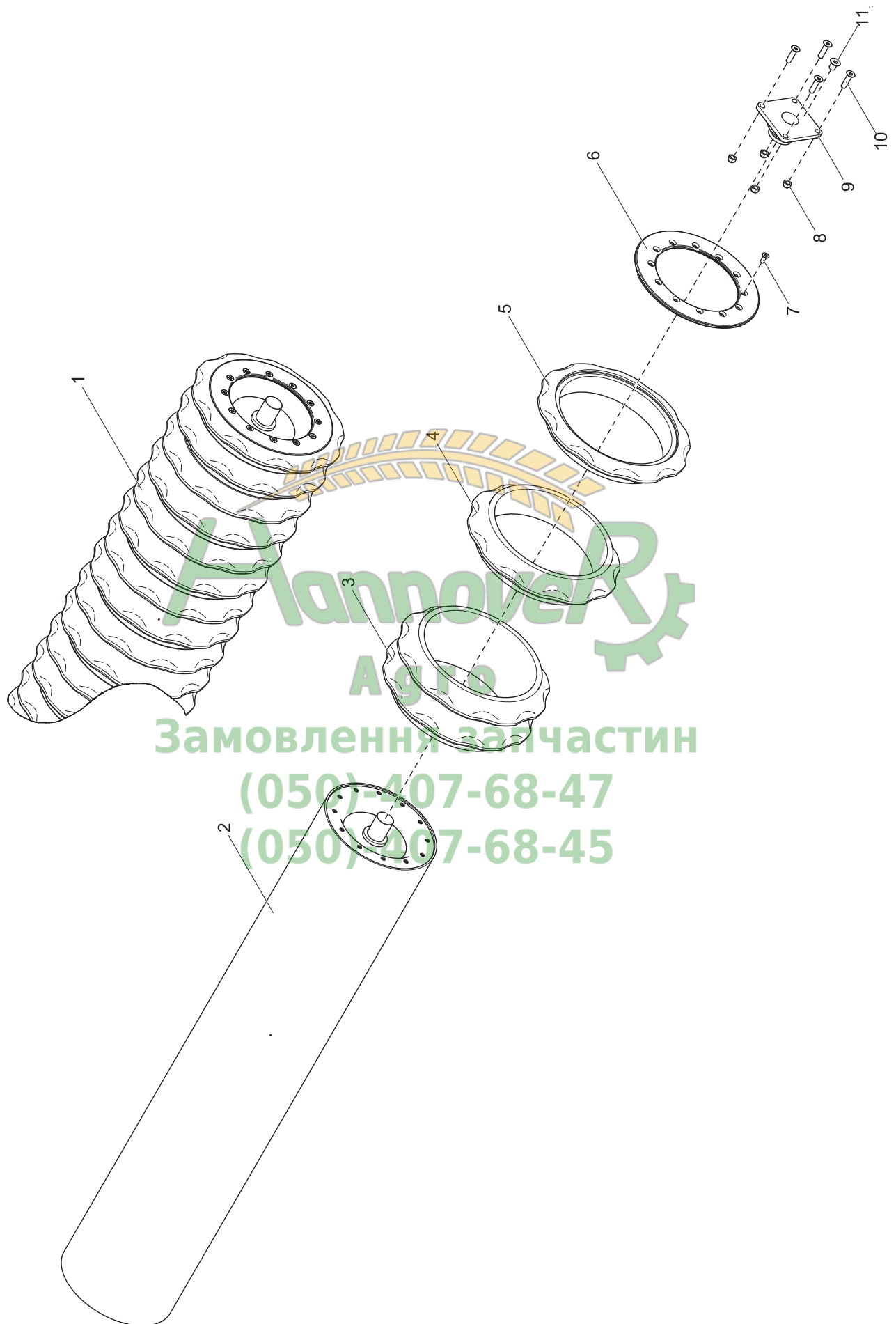

Vältpaket, Gummi
Roller ring unit, Rubber
Walzenpaket, Gummi

CRX 425-625
101 -

Pos	No.	Svenska	English	Deutsch	Dim	
1	490264	Vältpaket	Roller ring unit	Walzenpaket		425, LH, RH
1	490261	Vältpaket	Roller ring unit	Walzenpaket		525, LH, RH
1	487922	Vältpaket	Roller ring unit	Walzenpaket		625, LH, RH
2	490265	Axel	Axle	Achse		425, LH, RH
2	490262	Axel	Axle	Achse		525, LH, RH
2	488780	Axel	Axle	Achse		625, LH, RH
3	465108	Vältring	Roller ring	Walzenringe	Ø550x242	
5	467612	Vältring	Roller ring	Walzenringe	Ø550x89	
6	461972	Plåt	Plate	Blech		
7	50241203011	Skruv	Screw	Schraube	M12x30 T55	
8	51021600011	Låsmutter	Lock nut	Sicherungsmutter	M16, KI 10	
9	465889	Lagerhus	Bearing housing	Lagergehäuse		
10	50241606011	Skruv	Screw	Schraube	M16x60 T60	
11	50042002021	Skruv	Screw	Schraube		



Замовлення запчастин

(050)-407-68-47

(050)-407-68-45

Fig. / Abb. 10



Fig. / Abb. 10**Vältpaket, Ribbvält
Roller ring unit, Cage Roller
Walzenpaket, Krümlerwalze****CRX 425-625
101 -**

Pos	No.	Svenska	English	Deutsch	Dim
1	490470	Vält	Roller	Rolle	
1	490466	Vält	Roller	Rolle	
1	481600	Vält	Roller	Rolle	
2	51021600011	Låsmutter	Lock nut	Sicherungsmutter	M16, KI 10
3	465889	Lagerhus	Bearing housing	Lagergehäuse	
4	50241606011	Skruv	Screw	Schraube	M16x60 T60
5	50042002021	Skruv	Screw	Schraube	

**Замовлення запчастин****(050)-407-68-47****(050)-407-68-45**

Fig. / Abb. 11

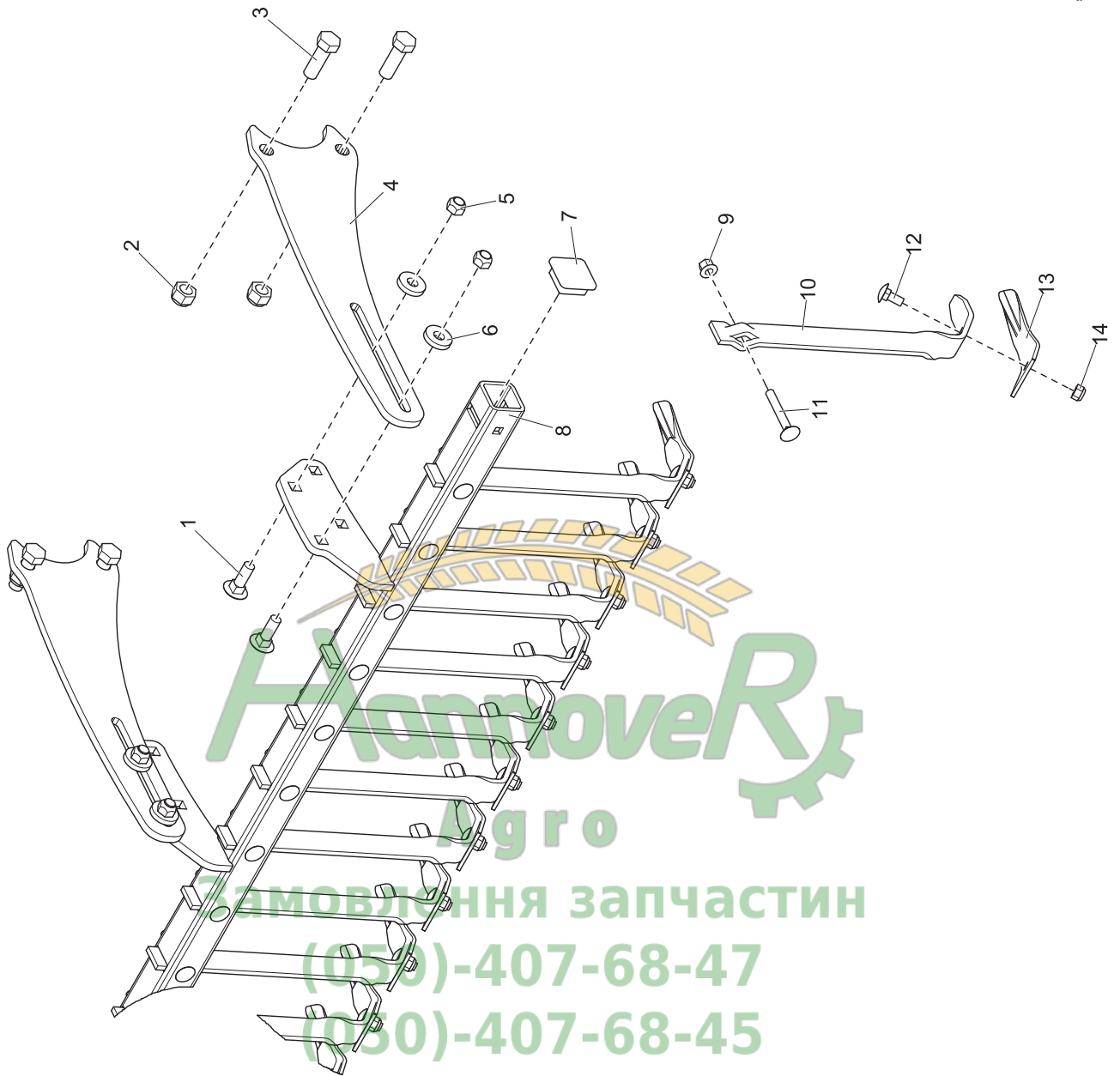

Fig. / Abb. 11

**Avskrapare, Stål
Scraper, Steel
Abstreifer, Stahl**

**CRX 425-625
101 -**

Pos	No.	Svenska	English	Deutsch	Dim	
1	50061605021	Vagnsbult	Carriage bolt	Bolzen	M16x50	
2	51012000021	Låsmutter	Lock nut	Sicherungsmutter	M20	
3	50002006021	Skruv	Screw	Schraube	M20x60	
4	494625	Plåt	Plate	Blech		
5	51021600021	Låsmutter	Lock nut	Sicherungsmutter	M16	
6	52111600041	Bricka	Washer	Scheibe	M16	
7	413896	Plastplugg	Plastic plug	Kunststoffpfropfen	60x60	
8	486371	Axel	Axle	Achse		425, LH
8	486373	Axel	Axle	Achse		425, RH
8	495368	Axel	Axle	Achse		525, LH, RH, OUT
8	495549	Axel	Axle	Achse		525-625, LH, IN
8	495550	Axel	Axle	Achse		525-625, RH, IN
8	495366	Axel	Axle	Achse		625, LH, RH, OUT
9	51131200011	Mutter	Nut	Mutter	M12, 10.9	
10	465486	Pinne	Tine	Zinken		
11	50061208521	Vagnsbult	Carriage bolt	Bolzen	M12x85	
12	50061203021	Vagnsbult	Carriage bolt	Bolzen	M12x30	
13	451404	Platta	Plate	Platte		
14	51011200021	Låsmutter	Lock nut	Sicherungsmutter	M12	



**Замовлення запчастин
(050)-407-68-47
(050)-407-68-45**

Fig. / Abb. 12

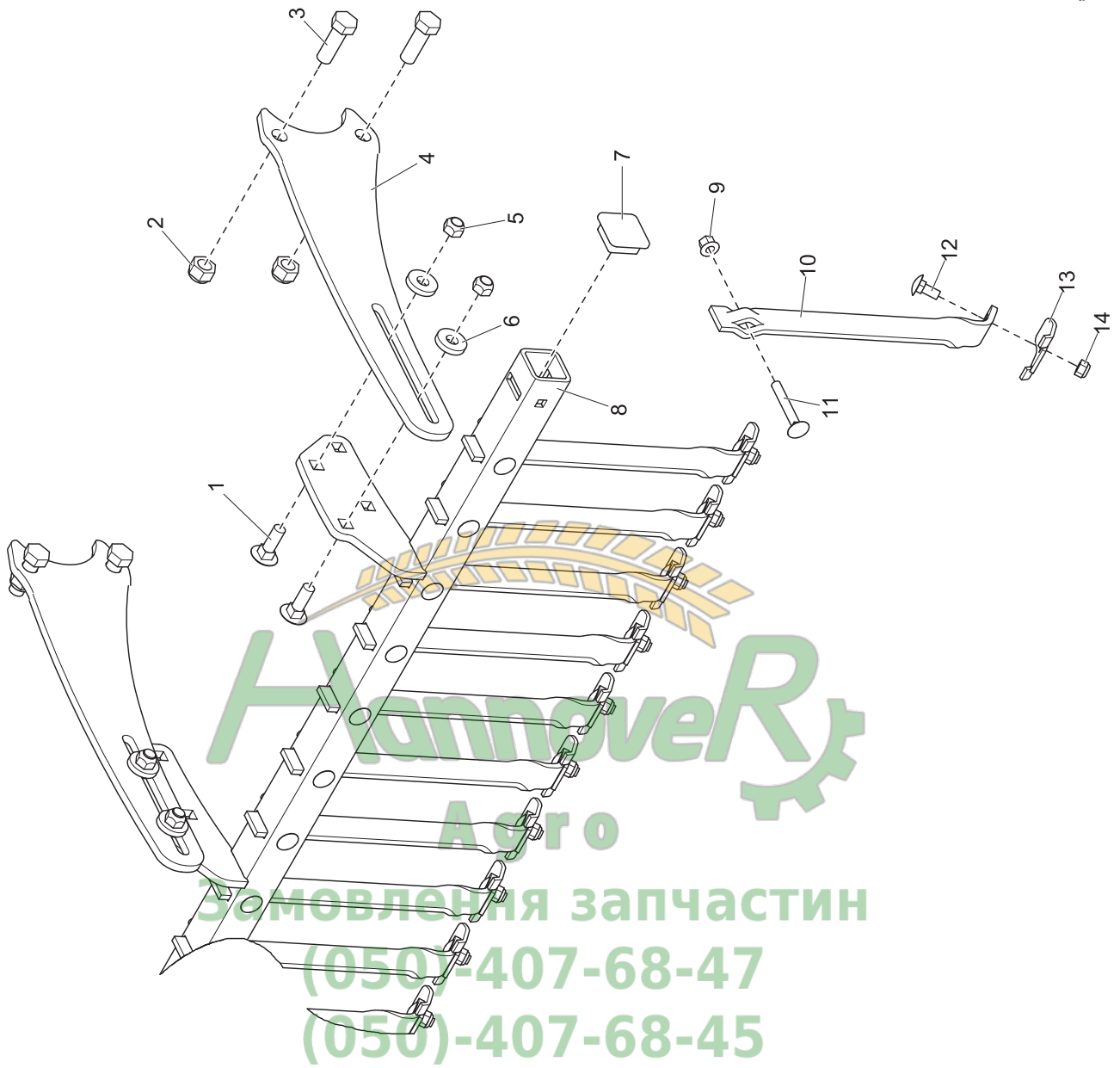

Fig. / Abb. 12

**Avskrapare,, Gummi
Scraper,, Rubber
Abstreifer,, Gummi**

**CRX 425-625
101 -**

Pos	No.	Svenska	English	Deutsch	Dim	
1	50061605021	Vagnsbult	Carriage bolt	Bolzen	M16x50	
2	51012000021	Låsmutter	Lock nut	Sicherungsmutter	M20	
3	50002006021	Skruv	Screw	Schraube	M20x60	
4	494625	Plåt	Plate	Blech		
5	51021600021	Låsmutter	Lock nut	Sicherungsmutter	M16	
6	52111600041	Bricka	Washer	Scheibe	M16	
7	413896	Plastplugg	Plastic plug	Kunststoffpfropfen	60x60	
8	495563	Axel	Axle	Achse		425, LH
8	495564	Axel	Axle	Achse		425, RH
8	495575	Axel	Axle	Achse		525, LH, OUT
8	495571	Axel	Axle	Achse		525, LH, IN
8	495576	Axel	Axle	Achse		525, RH, OUT
8	495572	Axel	Axle	Achse		525, RH, LH
8	495559	Axel	Axle	Achse		625, LH, OUT
8	495555	Axel	Axle	Achse		625, LH, IN
8	495560	Axel	Axle	Achse		625, RH, OUT
8	495556	Axel	Axle	Achse		625, RH, IN
9	51131200011	Mutter	Nut	Mutter	M12, 10.9	
10	467818	Pinne	Tine	Zinken		
11	50061208521	Vagnsbult	Carriage bolt	Bolzen	M12x85	
12	50061203021	Vagnsbult	Carriage bolt	Bolzen	M12x30	
13	467951	Platta	Plate	Platte		
14	51011200021	Låsmutter	Lock nut	Sicherungsmutter	M12	



**Замовлення запчастин
(050)-407-68-47
(050)-407-68-45**

Fig. / Abb. 13



АннOVER
Агро
Замовлення запчастин
(050)-407-68-47
(050)-407-68-45

Fig. / Abb. 13

**Utjämnare
Leveler
Ausgleicher**

**CRX 425-625
101 -**

Pos	No.	Svenska	English	Deutsch	Dim
1	50061206021	Vagnsbult	Carriage bolt	Bolzen	M12x60
2	493734	Plåt	Plate	Blech	
3	50001206021	Skruv	Screw	Schraube	M12x60
4	495356	Fäste	Bracket	Halterung	
5	51131200011	Mutter	Nut	Mutter	M12, 10.9
6	464288	Gummistav	Rubber bar	Gummistab	



Замовлення запчастин

(050)-407-68-47

(050)-407-68-45

Fig. / Abb. 14



Fig. / Abb. 14

**Hydraulik, Ram
Hydraulics, Frame
Hydraulik, Rahmen**

**CRX 425
101 -**

Pos	No.	Svenska	English	Deutsch	Dim
1	469859	Sprint	Pin	Splint	
2	53000805091	Spännstift	Roll pin	Spannstift	Ø8x50
3	458968	Kolvstångshuvud	Piston rod head	Kolbenstangenende	
4	52003000041	Bricka	Washer	Scheibe	M30
5	412620	Lågmutter	Low nut	Flachmutter	M36x2
6	480457	Hydraulcylinder	Hydraulic ram	Hydraulik zylinder	
6	480461	Tätningssats	Sealing kit	Dichtungssatz	
7	402202	Gummistålbricka	Rubber steel washer	Gummistahlscheibe	1/4"
8	491563	Koppling	Coupling	Kupplung	
9	406753	Hålskruv, strypt 1,5 mm	Hole screw, reducing 1,5 mm	Hohlschraube, gedrosselt 1,5 mm	1/4"
10	406751	Hålskruv, banjo	Hole screw, banjo	Hohlschraube, Banjo	1/4"
11	498524	Hydraulslang	Hydraulic hose	Hydraulikschlauch	DI:1/4" L=1310
12	498522	Hydraulslang	Hydraulic hose	Hydraulikschlauch	DI:1/4" L=1800
13	498523	Hydraulslang	Hydraulic hose	Hydraulikschlauch	DI:1/4" L=2000
14	498521	Hydraulslang	Hydraulic hose	Hydraulikschlauch	DI:1/4" L=2460
15	411916	T-rör	T-piece	T-stück	
16	471376	Nippel	Nipple	Nippel	
17	471377	Nippel	Nipple	Nippel	
18	497510	Hydraulslang	Hydraulic hose	Hydraulikschlauch	DI:1/4" L=2300
19	401782	Nippel	Nipple	Nippel	1/4"-1/2"
20	401774	Gummistålbricka	Rubber steel washer	Gummistahlscheibe	1/2"
21	401776	Snabbkoppling	Quick coupling	Schnellkupplung	ML, 1/2"
22	427914	Skydd	Cover	Schutz	

Hannover
Agro

Замовлення запчастин

(050)-407-68-47

(050)-407-68-45

Fig. / Abb. 15

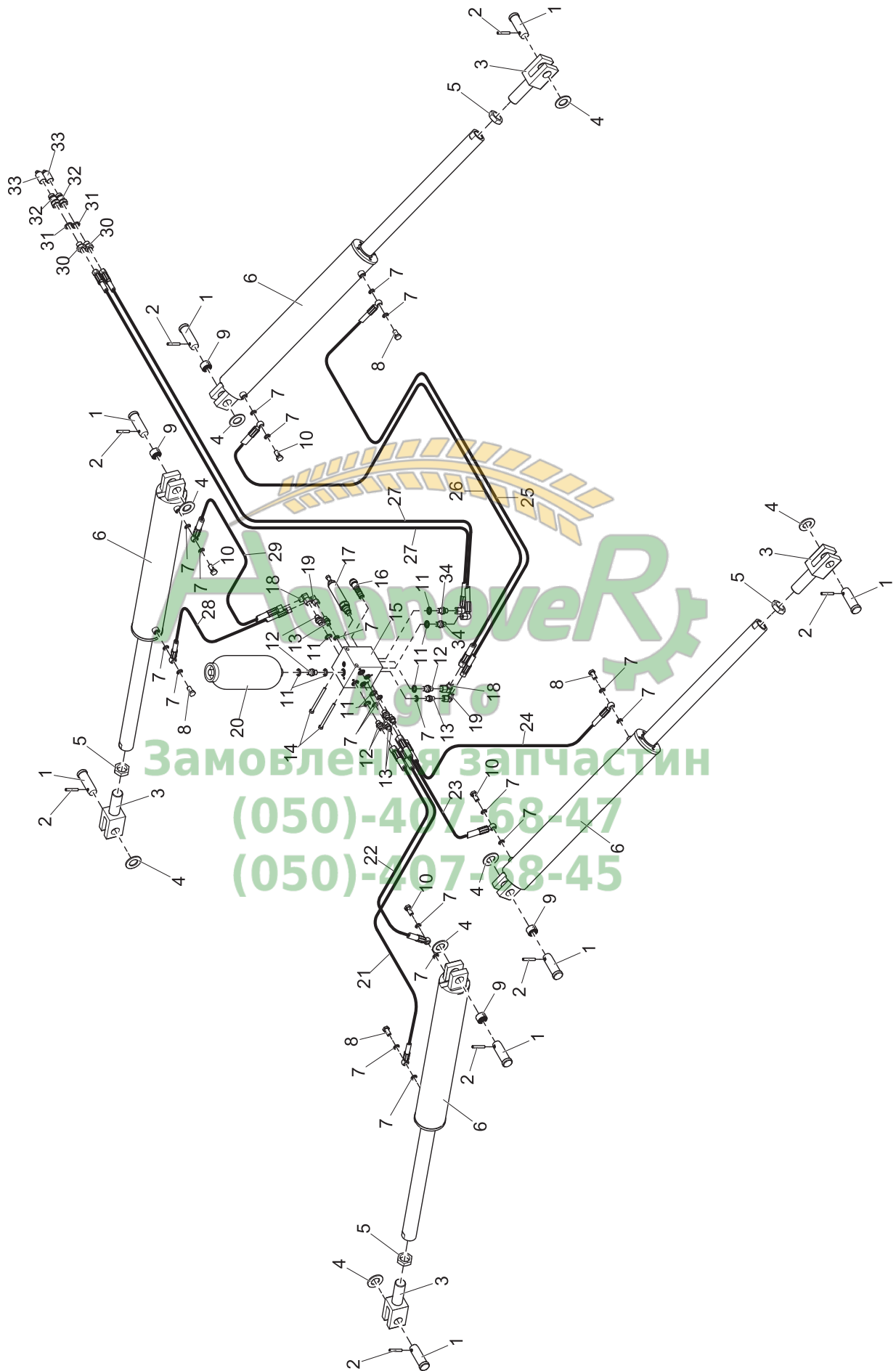

Fig. / Abb. 15

Hydraulik, Ram
Hydraulics, Frame
Hydraulik, Rahmen

CRX 525-625
101 -

Pos	No.	Svenska	English	Deutsch	Dim
1	469859	Sprint	Pin	Splint	
2	53000805091	Spännstift	Roll pin	Spannstift	Ø8x50
3	458968	Kolvstångshuvud	Piston rod head	Kolbenstangenende	
4	52003000041	Bricka	Washer	Scheibe	M30
5	412620	Lågmutter	Low nut	Flachmutter	M36x2
6	480457	Hydraulcylinder	Hydraulic ram	Hydraulik zylinder	
6	480461	Tätningssats	Sealing kit	Dichtungssatz	
7	402202	Gummistålbricka	Rubber steel washer	Gummistahlscheibe	1/4"
8	406753	Hålskruv, strypt 1,5 mm	Hole screw, reducing 1,5 mm	Hohlschraube, gedrosselt 1,5 mm	1/4"
9	496634	Glidlager	Slide bearing	Gleitlager	
10	406751	Hålskruv, banjo	Hole screw, banjo	Hohlschraube, Banjo	1/4"
11	402203	Gummistålbricka	Rubber steel washer	Gummistahlscheibe	3/8"
12	401777	Adapter	Adapter	Adapter	
13	401790	Nippel	Nipple	Nippel	1/4"-1/4"
14	50000811021	Skruv	Screw	Schraube	M8x110
15	497223	Hydraulblock	Hydraulic block	Hydraulikblock	
16	497514	Ventil	Valve	Ventil	
17	497512	Ventil	Valve	Ventil	
18	414651	Adapter	Adapter	Adapter	DO: R3/8"/DI: 3/8"
19	414650	Nippel	Nipple	Nippel	
20	422061	Akkumulator, förladdad 20 bar (standard)	Accumulator, precharged to 20 bar (standard)	Akkumulator, Vorladedruck 20 bar (standard)	1,5 l
21	497505	Hydraulslang	Hydraulic hose	Hydraulikschlauch	DI:1/4" L=2100
22	497504	Hydraulslang	Hydraulic hose	Hydraulikschlauch	DI:3/8" L=1550
23	497503	Hydraulslang	Hydraulic hose	Hydraulikschlauch	DI:3/8" L=1770
24	497502	Hydraulslang	Hydraulic hose	Hydraulikschlauch	DI:1/4" L=2450
25	497506	Hydraulslang	Hydraulic hose	Hydraulikschlauch	DI:3/8" L=1050
26	497507	Hydraulslang	Hydraulic hose	Hydraulikschlauch	DI:1/4" L=1720
27	497510	Hydraulslang	Hydraulic hose	Hydraulikschlauch	DI:1/4" L=2300
28	497508	Hydraulslang	Hydraulic hose	Hydraulikschlauch	DI:1/4" L=1300
29	497509	Hydraulslang	Hydraulic hose	Hydraulikschlauch	DI:3/8" L=600
30	401782	Nippel	Nipple	Nippel	1/4"-1/2"
31	401774	Gummistålbricka	Rubber steel washer	Gummistahlscheibe	1/2"
32	401776	Snabbkoppling	Quick coupling	Schnellkupplung	ML, 1/2"
33	427914	Skydd	Cover	Schutz	
34	401789	Nippel	Nipple	Nippel	1/4"-3/8"

(050)-407-68-47

(050)-407-68-45

Fig. / Abb. 16

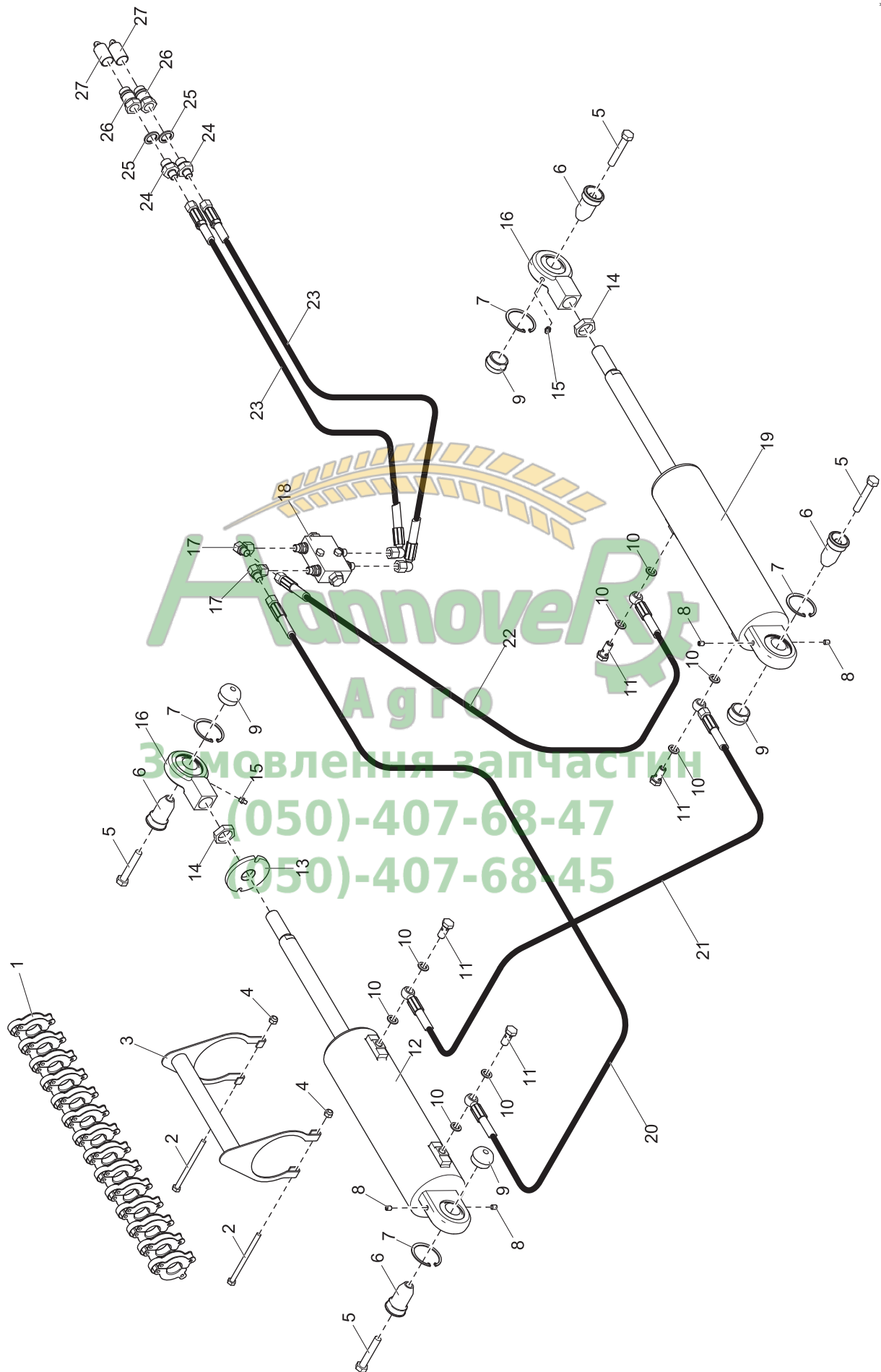

Fig. / Abb. 16

**Hydraulik, System Disc
Hydraulics, System Disc
Hydraulik, System Disc**

**CRX 425-625
101 -**

Pos	No.	Svenska	English	Deutsch	Dim
1	495275	Distans	Spacer	Distanz	
2	50000812021	Skruv	Screw	Schraube	M8x120
3	495597	Fäste	Bracket	Halterung	
4	51010800021	Låsmutter	Lock nut	Sicherungsmutter	M8
5	50001207021	Skruv	Screw	Schraube	M12x70
6	490396	Hylsa	Sleeve	Hülse	
7	54015800094	Låsring	Circlip	Seegerring	
8	491481	Plugg	Plug	Pfropfen	
9	490397	Hylsa	Sleeve	Hülse	
10	402202	Gummistålbricka	Rubber steel washer	Gummistahlscheibe	1/4"
11	406751	Hålskruv, banjo	Hole screw, banjo	Hohlschraube, Banjo	1/4"
12	490040	Hydraulcylinder	Hydraulic ram	Hydraulik zylinder	
12	490043	Tätningssats	Sealing kit	Dichtungssatz	
13	495475	Anslag	Stop bolt	Anschlag	
14	51032800021	Mutter	Nut	Mutter	
15	407661	Smörjnippel	Grease nipple	Schmiernippel	ST, M8
16	497411	Kolvstångshuvud	Piston rod head	Kolbenstangenende	
17	414650	Nippel	Nipple	Nippel	
18	428236	Ventilblock	Valve block	Ventilblock	
19	490035	Hydraulcylinder	Hydraulic ram	Hydraulik zylinder	
19	490038	Tätningssats	Sealing kit	Dichtungssatz	
20	497215	Hydraulslang	Hydraulic hose	Hydraulikschlauch	DI:1/4" L=2420
21	497261	Hydraulslang	Hydraulic hose	Hydraulikschlauch	DI:1/4" L=3100
22	497216	Hydraulslang	Hydraulic hose	Hydraulikschlauch	DI:1/4" L=2400
23	497510	Hydraulslang	Hydraulic hose	Hydraulikschlauch	DI:1/4" L=2300
24	401782	Nippel	Nipple	Nippel	1/4"-1/2"
25	401774	Gummistålbricka	Rubber steel washer	Gummistahlscheibe	1/2"
26	401776	Snabbkoppling	Quick coupling	Schnellkupplung	ML, 1/2"
27	427914	Skydd	Cover	Schutz	

Агро

Замовлення запчастин

(050)-407-68-47

(050)-407-68-45

Fig. / Abb. 17

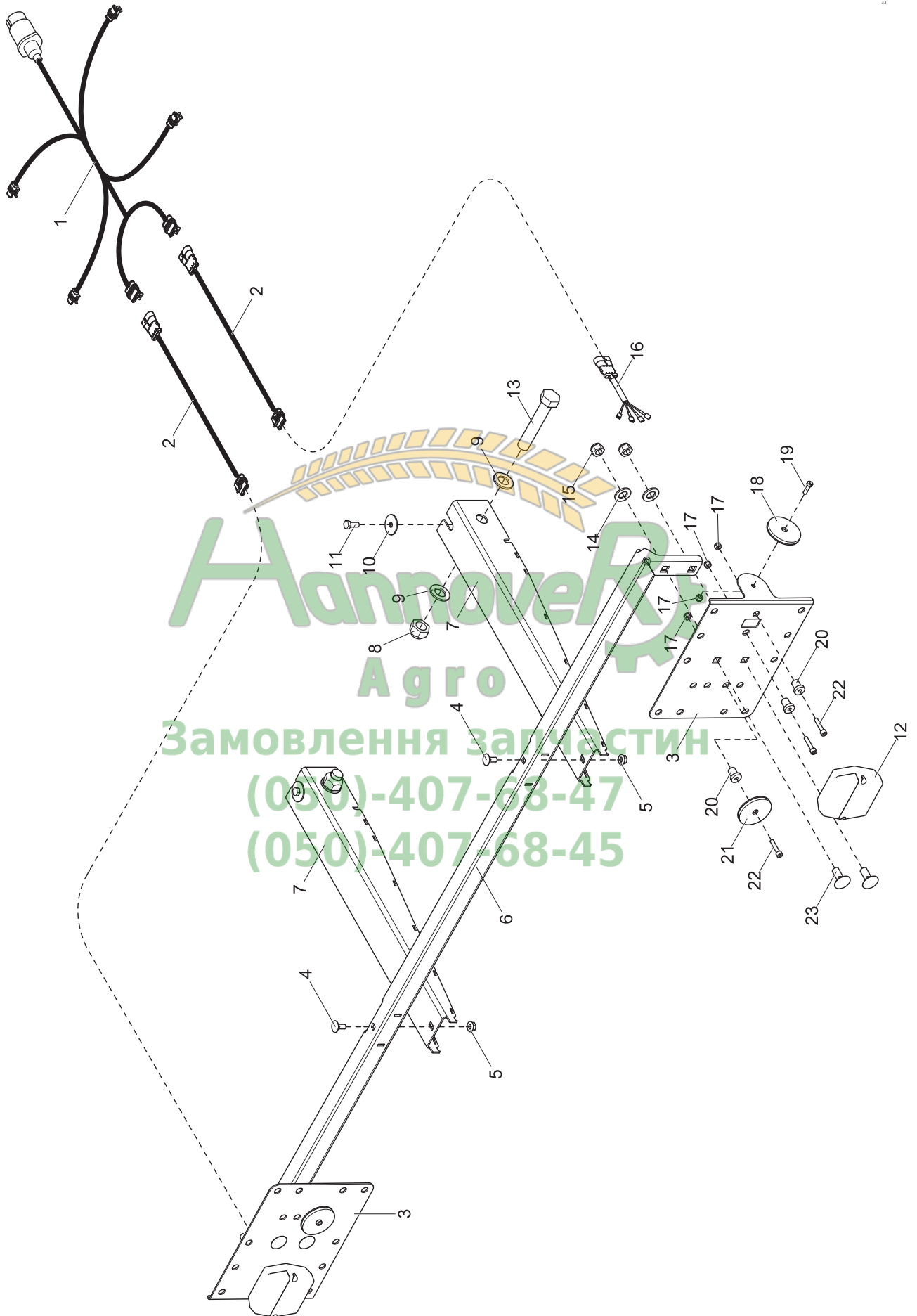

АгровеР
Агро
Замовлення за частин
(050)-407-68-47
(050)-407-68-45

Fig. / Abb. 17

Belysning
Lighting
Beleuchtung
CRX 425-625
101 -

Pos	No.	Svenska	English	Deutsch	Dim
1	489441	Kablage	Cable harness	Kabel	
2	499512	Kabel	Cable	Kabel	
3	483662	Plåt	Plate	Blech	
4	50060802021	Vagnsbult	Carriage bolt	Bolzen	M8x20
5	51170800021	Mutter	Nut	Mutter	
6	499527	Fyrkantrör	Square tube	Veirkantrohr	
7	496338	Fäste	Bracket	Halterung	
8	51022000021	Låsmutter	Lock nut	Sicherungsmutter	M20
9	52052100041	Bricka	Washer	Scheibe	
10	52050800041	Bricka	Washer	Scheibe	M8
11	50000802021	Skruv	Screw	Schraube	M8x20
12	412895	Bakljus	Rear lights	Rücklicht	ASSY
12	413339	Glödlampa	Bulb	Glühbirne	12V, 21/5W
12	413499	Glödlampa	Bulb	Glühbirne	12V, 10W
13	50002011021	Skruv	Screw	Schraube	M20x110
14	52001600041	Bricka	Washer	Scheibe	M16
15	51011200021	Låsmutter	Lock nut	Sicherungsmutter	M12
16	475317	Kabel	Cable	Kabel	
17	51010600021	Låsmutter	Lock nut	Sicherungsmutter	M6
18	307393	Reflex, gul	Reflex, yellow	Reflex, gelb	
19	50130602071	Skruv	Screw	Schraube	M6x20
20	484193	Mutter	Nut	Mutter	
21	307392	Reflex, röd	Reflex, red	Reflex, rot	
22	50030603021	Skruv	Screw	Schraube	M6x30
23	50061203021	Vagnsbult	Carriage bolt	Bolzen	M12x30



Замовлення запчастин
(050)-407-68-47
(050)-407-68-45

Fig. / Abb. 18

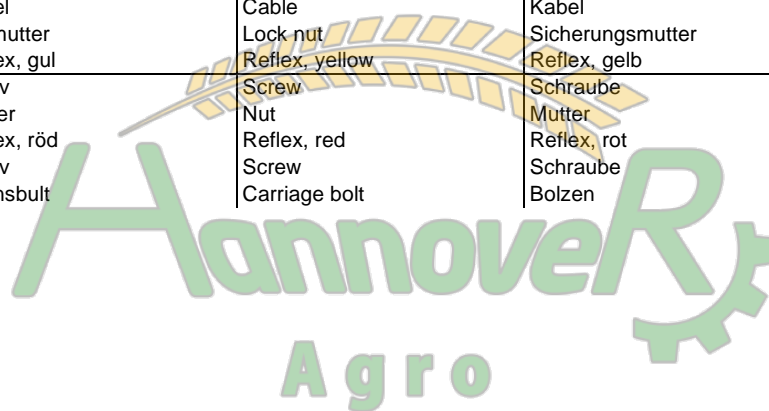

Fig. / Abb. 18

**Säkerhetspaket, Standard
Security package, Standard
Sicherheitspaket, Standard**

**CRX 425-625
101 -**

Pos	No.	Svenska	English	Deutsch	Dim
1	50140603021	Skruv	Screw	Schraube	
2	413376	Dekal "LGF"	Sticker "Slow vehicle"	Aufkleber Warndreieck"	400x350
3	422663	Plåt LGF-skylt	Plate, "slow vehicle"	Blech, Warndreieck	
4	484193	Mutter	Nut	Mutter	
5	51010600021	Låsmutter	Lock nut	Sicherungsmutter	M6



**Замовлення запчастин
(050)-407-68-47
(050)-407-68-45**



Нанновер
Агро
Замовлення запчастин
(050)-407-68-47
(050)-407-68-45

Fig. / Abb. 19**Säkerhetspaket, Frankrike
Security package, France
Sicherheitspaket, Frankreich****CRX 425-625
101 -**

Pos	No.	Svenska	English	Deutsch	Dim	
1	489729	Varningsskylt	Warning panel			LH
2	497830	Fäste	Bracket	Halterung		LH
3	50021202021	Skruv, Tensilock	Screw, Tensilock	Schraube, Tensilock	M12x20	
4	51071200021	Mutter	Nut	Mutter	M12	
5	497827	Fäste	Bracket	Halterung		RH
6	51010600021	Låsmutter	Lock nut	Sicherungsmutter	M6	
7	484193	Mutter	Nut	Mutter		
8	489652	Varningsskylt	Warning panel	Warntafel		RH
9	50140603021	Skruv	Screw	Schraube		

**Замовлення запчастин****(050)-407-68-47****(050)-407-68-45**



Säkerhetspaket, Tyskland
Security package, Germany
Sicherheitspaket, Deutschland

CRX 425-625
101 -

Pos	No.	Svenska	English	Deutsch	Dim
1	471132	Plåt	Plate	Blech	
2	471133	Plåt	Plate	Blech	
3	50140603021	Skruv	Screw	Schraube	
4	484193	Mutter	Nut	Mutter	
5	51010600021	Låsmutter	Lock nut	Sicherungsmutter	M6



VÄDERSTAD

Carrier X 425

Carrier X 525

Carrier X 625

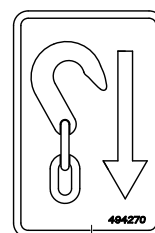
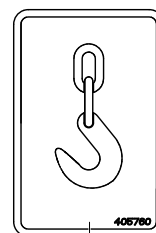
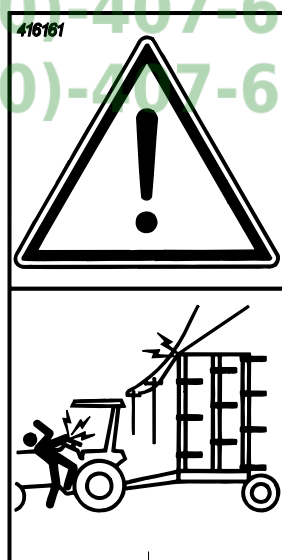
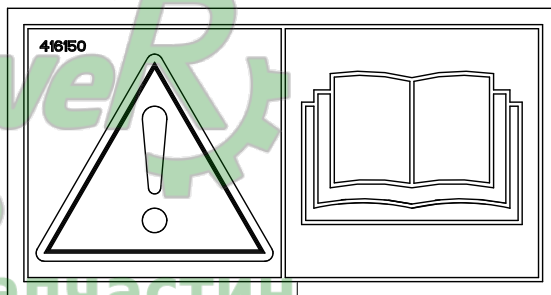
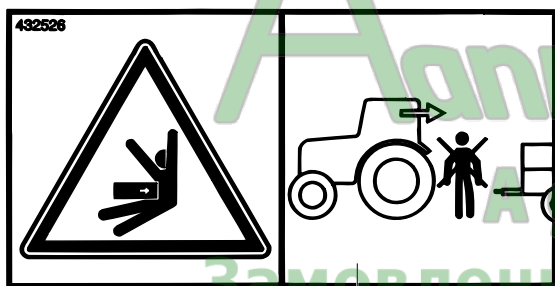

Fig. / Abb. 21**Dekaler
Decals
Aufkleber****CRX 425-625
101 -**

Pos	No.	Svenska	English	Deutsch	Dim
1	411128	Dekal "Väderstad"	Sticker "Väderstad"	Aufkleber "Väderstad"	490x70
2	494614	Dekal	Sticker	Aufkleber	
3	494615	Dekal	Sticker	Aufkleber	
4	494616	Dekal	Sticker	Aufkleber	
5	432526	Varningsdekal	Warning sticker	Warnungs-Aufkleber	
6	416150	Varningsdekal	Warning sticker	Warnungs-Aufkleber	
7	416154	Varningsdekal	Warning sticker	Warnungs-Aufkleber	
8	416161	Varningsdekal	Warning sticker	Warnungs-Aufkleber	88x167
9	405760	Dekal "Lyft här"	Sticker "Lift here"	Aufkleber "hier anheben"	60x40
10	494270	Dekal	Sticker	Aufkleber	



**Замовлення запчастин
(050)-407-68-47
(050)-407-68-45**



No.	Page no.	No.	Page no.	No.	Page no.
307168	17, 19	474591	17	495475	37
307169	19	474609	19	495549	27
307392	39	475317	39	495550	27
307393	39	476635	9	495555	29
401774	33, 35, 37	479231	21	495556	29
401776	33, 35, 37	479234	21	495559	29
401777	35	480005	19	495560	29
401782	33, 35, 37	480457	33, 35	495563	29
401789	35	480461	33, 35	495564	29
401790	35	481600	25	495571	29
402202	33, 35, 37	482496	19	495572	29
402203	35	483662	39	495575	29
405760	47	484193	39, 41, 43, 45	495576	29
406021	19	484603	21	495597	37
406751	33, 35, 37	484604	21	496280	9
406753	33, 35	486371	27	496281	15
407661	11, 13, 15, 37	486373	27	496282	15
411128	47	486388	17, 19	496285	17
411253	17	486399	17	496286	17
411916	33	487774	9	496287	17
412620	33, 35	487922	23	496297	17
412895	39	488780	23	496298	17
413339	39	489343	21	496299	17
413376	41	489441	39	496300	17
413499	39	489652	43	496338	39
413545	19	489729	43	496630	17
413896	17, 27, 29	489815	19	496631	11, 13, 15
414650	35, 37	489816	19	496633	9
414651	35	489817	19	496634	35
414846	19	489818	19	496644	19
416150	47	490035	37	496653	9
416154	47	490038	37	496661	19
416161	47	490040	37	497058	19
422061	35	490043	37	497079	9
422663	41	490225	21	497215	37
427914	33, 35, 37	490226	21	497216	37
428236	37	490229	21	497223	35
428571	17, 19	490230	21	497261	37
432526	47	490261	23	497411	37
441343	9	490262	23	497502	35
445483	19	490264	23	497503	35
446551	17	490265	23	497504	35
449609	9	490396	37	497505	35
450991	17, 19	490397	37	497506	35
451404	27	490466	25	497507	35
454400	9	490470	25	497508	35
458206	9	491481	37	497509	35
458221	9	491563	33	497510	33, 35, 37
458968	33, 35	491766	17	497512	35
459103	9	491772	17	497514	35
459107	9	491841	11	497608	9
461262	19	491842	11	497827	43
461972	23	492337	17	497830	43
464288	31	492343	17	498476	9
464730	11, 13, 15	492347	17	498521	33
465108	23	492353	17	498522	33
465486	27	493353	13	498523	33
465889	21, 23, 25	493354	13	498524	33
466947	19	493592	17	499512	39
467612	23	493726	17	499527	39
467818	29	493734	31	50000801221	9
467862	11, 13, 15	494270	47	50000802021	39
467866	11, 13, 15	494614	47	50000803021	11, 13, 15, 17
467951	29	494615	47	50000811021	35
469859	33, 35	494616	47	50000812021	37
471132	45	494625	27, 29	50001005021	9
471133	45	495275	37	50001010021	17
471376	33	495356	31	50001206021	31
471377	33	495366	27	50001207021	37
474237	17	495368	27	50001605021	17, 21

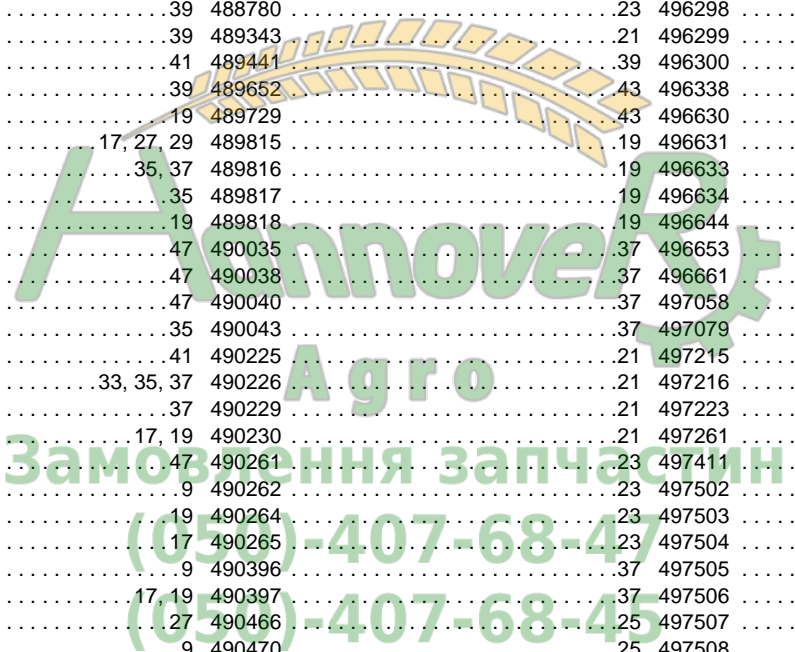

INDEX

No.	Page no.	No.	Page no.	No.	Page no.
50001606021	17				
50002005021	17				
50002006021	27, 29				
50002011021	39				
50002415011	11, 13, 15				
50021202021	43				
50030603021	39				
50042002021	21, 23, 25				
50060802021	39				
50061203021	27, 29, 39				
50061206021	31				
50061208521	27, 29				
50061605021	27, 29				
50130602071	39				
50140601221	17				
50140603021	41, 43, 45				
50140802021	9				
50140803021	9				
50241203011	23				
50241606011	21, 23, 25				
51010600021	39, 41, 43, 45				
51010800021	9, 37				
51011000021	9, 17				
51011200021	17, 19, 27, 29, 39				
51012000021	27, 29				
51021600011	21, 23, 25				
51021600021	27, 29				
51022000021	17, 39				
51032800021	37				
51071200021	43				
51131200011	27, 29, 31				
51131600021	17				
51170800021	11, 13, 15, 17, 39				
52001000041	9				
52001600041	39				
52003000041	33, 35				
52003600041	9				
52050800041	39				
52052100041	39				
52081600041	21				
52111600041	27, 29				
53000805091	33, 35				
53001005091	9				
54001000091	9				
54015800094	37				
54021500091	17				

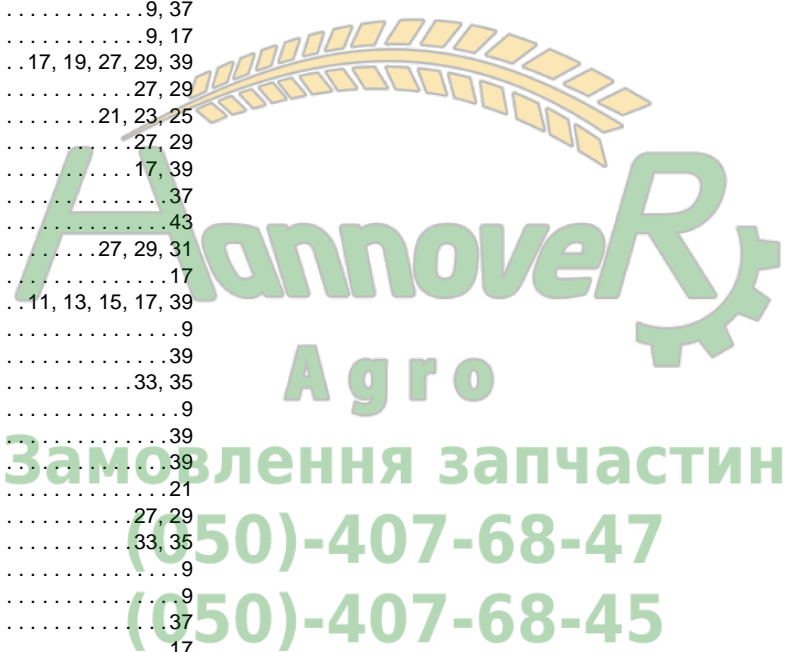



Замовлення запчастин

(050)-407-68-47

(050)-407-68-45



Замовлення запчастин

(050)-407-68-47

(050)-407-68-45



590 21 VÄDERSTAD

Telefon 0142-820 00
Telefax 0142-820 10
www.vaderstad.com

**S-590 21 VÄDERSTAD
SWEDEN**

Telephone +46 142 820 00
Telefax +46 142 820 10