

Агросервіс
Agro

Замовлення запчастин

RO-XXL GEO

(050)-407-68-47

(050)-407-68-45

Spare Parts Manual

Article number:	A138375440
Language:	EN
Production year (from):	2016
Prod. Series nr (from):	VN25400
01001 < Mach. ID <=	



Замовлення запчастин

(050)-407-68-47

(050)-407-68-45

RO-XXL GEO / Table of Contents



PosNo.	Assembly group	Page
1	FRAME	1
2	PROTECTION	2
2	PROTECTION	3
3	HOPPER AND SIEVE (1875 L / 495 GAL)	4
4	LIGHTING EU/OTHERS	5
4	LIGHTING US/CA	6
5	DRIVE	7
6	DOSAGE	8
6	DOSAGE	9
7	DISC, BROADCASTER	10
8	CONTROL, ISO	11
8	CONTROL, ISO	12
12	UNIV. JOINT SHAFT	13
13	DECAL SCHEMATIC ISO (EU/OTHERS)	14
13	DECAL SCHEMATIC ISO (FRANCE)	15
13	DECAL SCHEMATIC ANSI EN (US/CANADA)	16
99	HOPPER EXTENSION (1875 L / 495 GAL)	17
99	TARPAULIN (1875 L / 495 GAL)	18
99	TARPAULIN (1875 L / 495 GAL)	19
99	WARNING TRIANGLE SMV	20
99	MUD GUARDS	21
99	HOPPER EMPTYING SET	22
99	VANES SET	23
99	LADDERSET	24
99	WHEELSET	25
99	BOUNDARY SPREADING PLATE (HYDRAULIC)	26
99	TRIMFLOW RIGHT	27
99	ELECTRONICS	28
99	FEELER GAUGE	29
99	SPREADING PATTERN CONTROLSET	30
99	GPS SPEED SENSOR	31

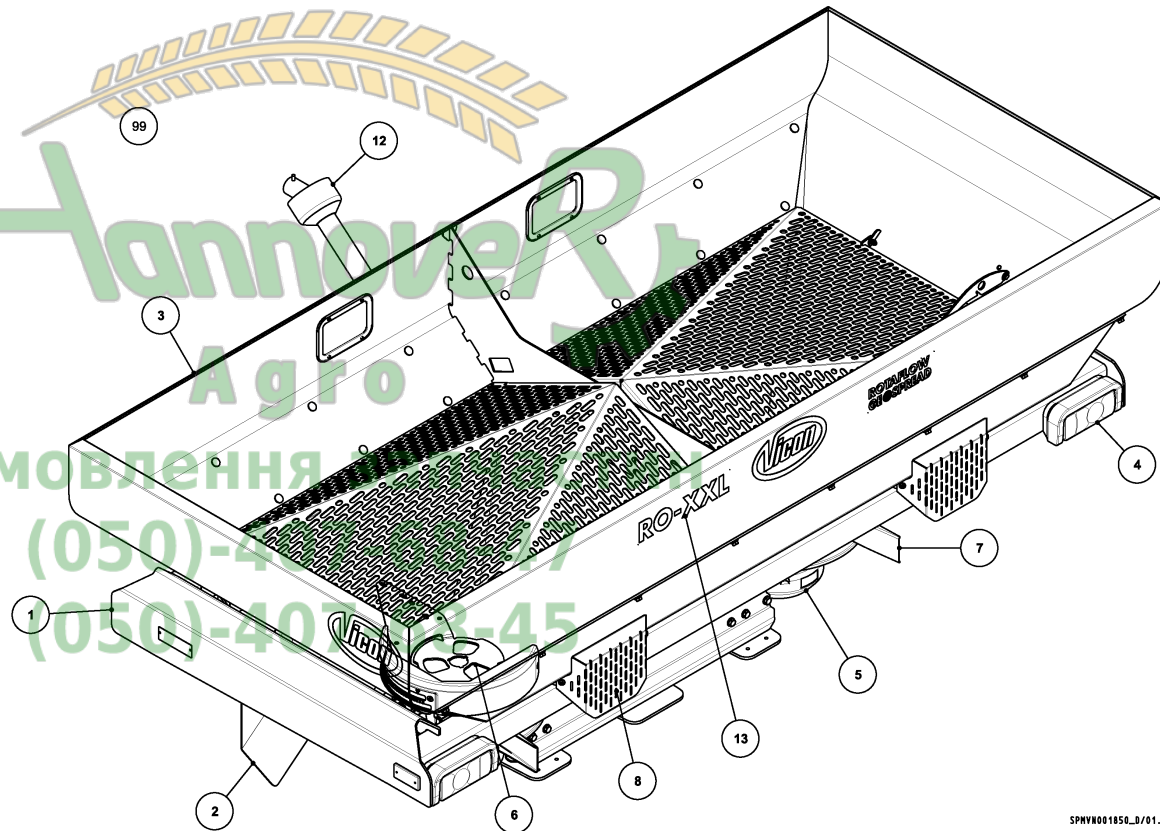

SPHY001850_D/01.001

RO-XXL GEO / FRAME



PosNo.	Part No.	Qty.
1	KG00501000	2
2	KG00501200	1
3	KG01070100	3
4	KG01901600	2
5	VN37601011	2
6	VN46120101	1
7	VNB0765193	2
8	VNB0870178	1
9	VNB0897393	1
10	VNB1599786	1
11	VNB1599986	2
12	VNB2332686	1
13	VNB3358786	1
14	VNB4995086	1

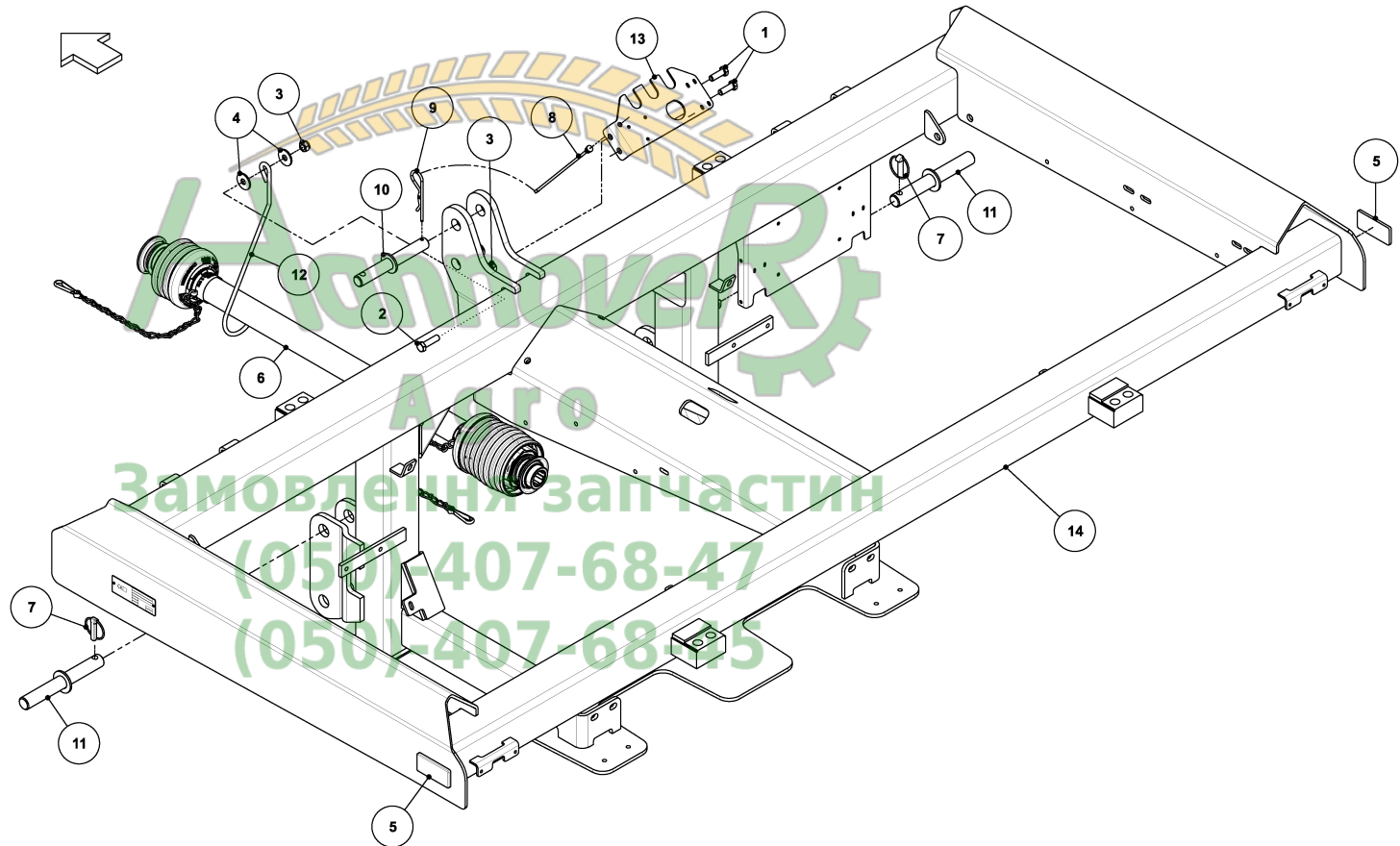

A138375130-01

RO-XXL GEO / PROTECTION



PosNo.	Part No.	Qty.
1	A138199002	1
2	A138199102	1
3	KG00494900	10
4	KG00501000	8
5	KG01059600	6
6	KG01069900	10
7	KG01070100	8
8	KG01264100	16
9	KG01901400	10
10	VN30128821	10
11	VN30143310	2
12	VNB2426674	1
13	VNB4281502	1
14	VNB4344486	1
15	VNB4708802	4
16	VNB4780478	4
17	VNB4945378	2

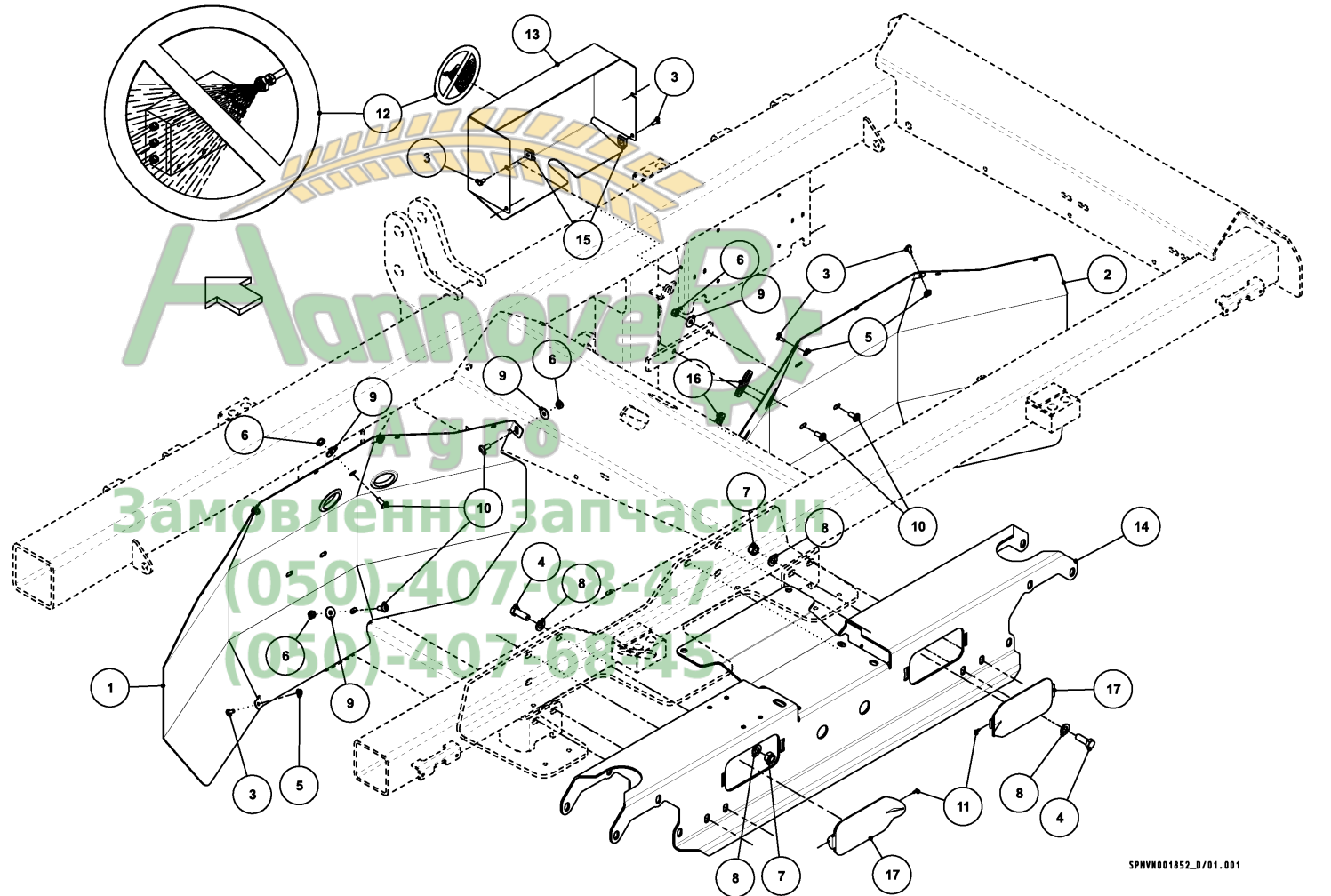

SPHY001852_0/01.001

A138375130-02

RO-XXL GEO / PROTECTION



PosNo.	Part No.	Qty.
1	A100022900	32
2	A138196802	4
3	A138197002	1
4	A138197102	1
5	A138460602	24
6	KG00654300	32
7	KG01059700	8
8	VN30128821	8
9	VNB4281294	2

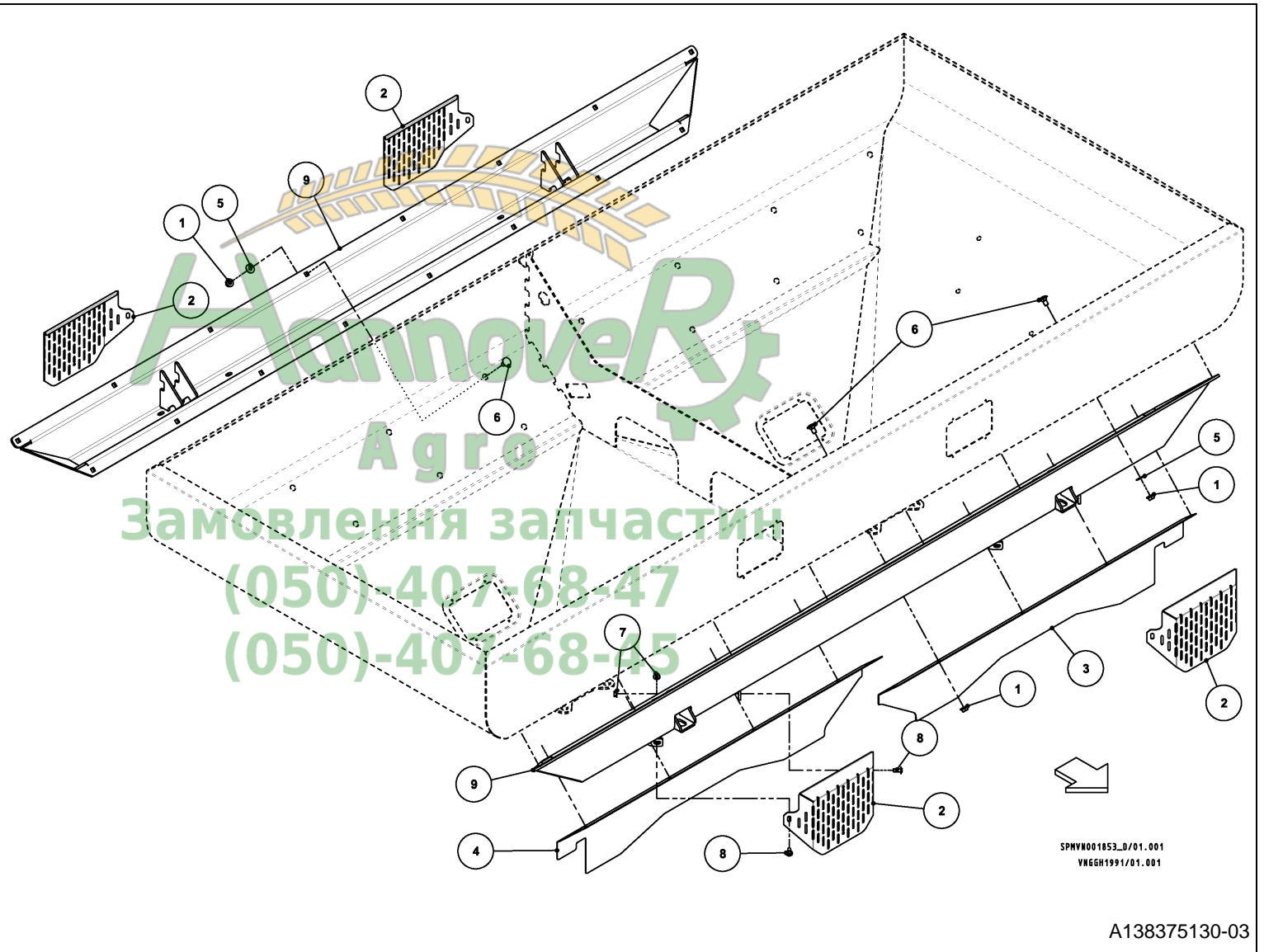

RO-XXL GEO / HOPPER AND SIEVE (1875 L / 495 GAL)



PosNo.	Part No.	Qty.
1	A138186478	2
2	A138186502	2
3	KG00497100	6
4	KG00498700	6
5	KG00738100	2
6	KG00870000	4
7	KG01069800	6
8	KG01069900	6
9	KG01070000	6
10	KG01264000	6
11	KG01901400	6
12	KG01901500	6
13	VN30143310	16
14	VNB2068778	4
15	VNB2760978	4
16	VNB4270602	6
17	VNB4277786	2
18	VNB4277994	1
19	VNB4278094	1
20	VNB4319078	2
21	VNB4363594	1
22	VNB4627794	2

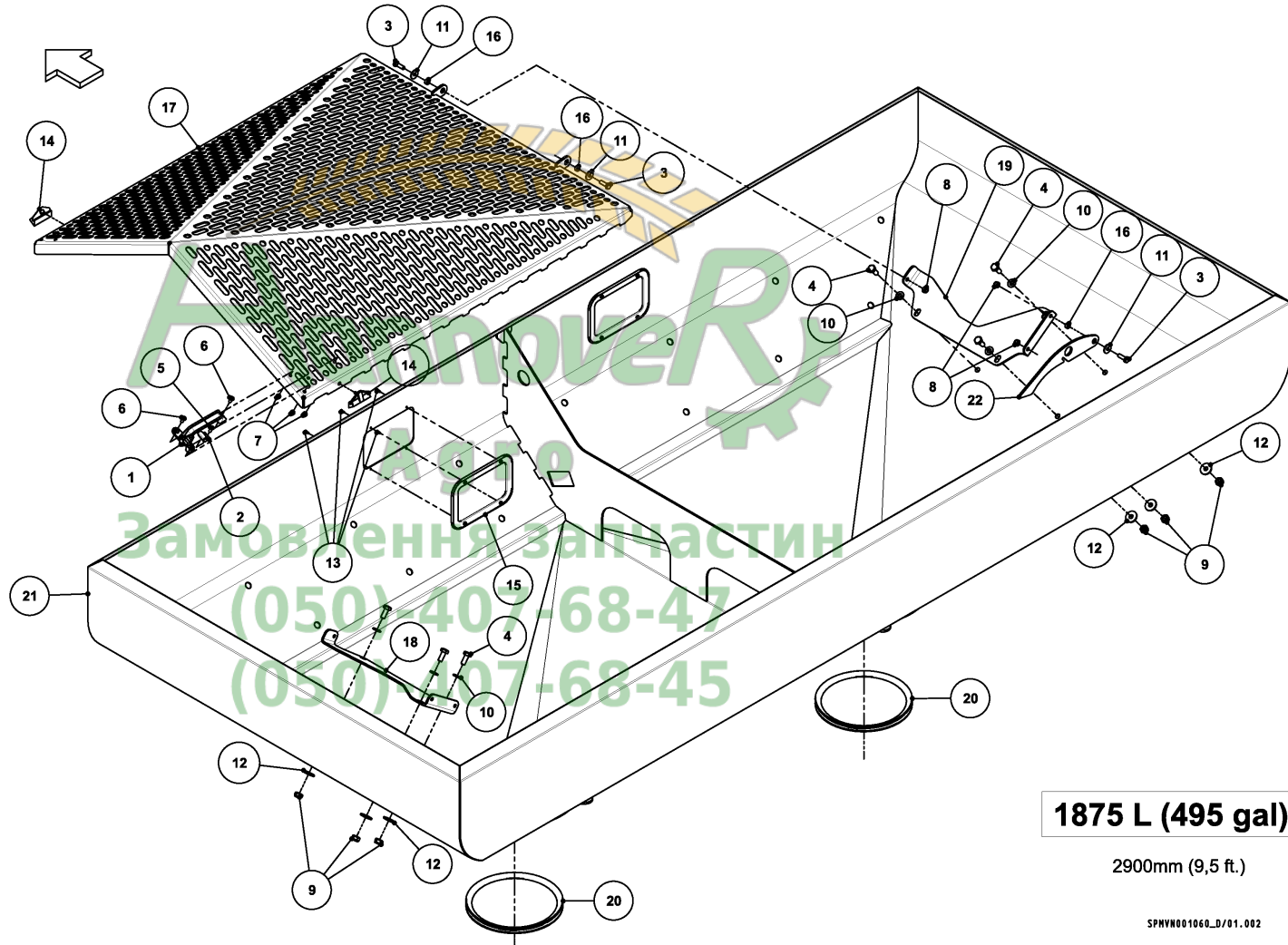

RO-XXL GEO / LIGHTING EU/OTHERS



PosNo.	Part No.	Qty.
1	KG00563000	3
2	KG01059600	4
3	KG01069700	3
4	VN48101007	1
5	VN80504001	2
6	VN80504003	12
7	VNB0341273	1
8	VNB5007578	2
9	VNB5030178	2

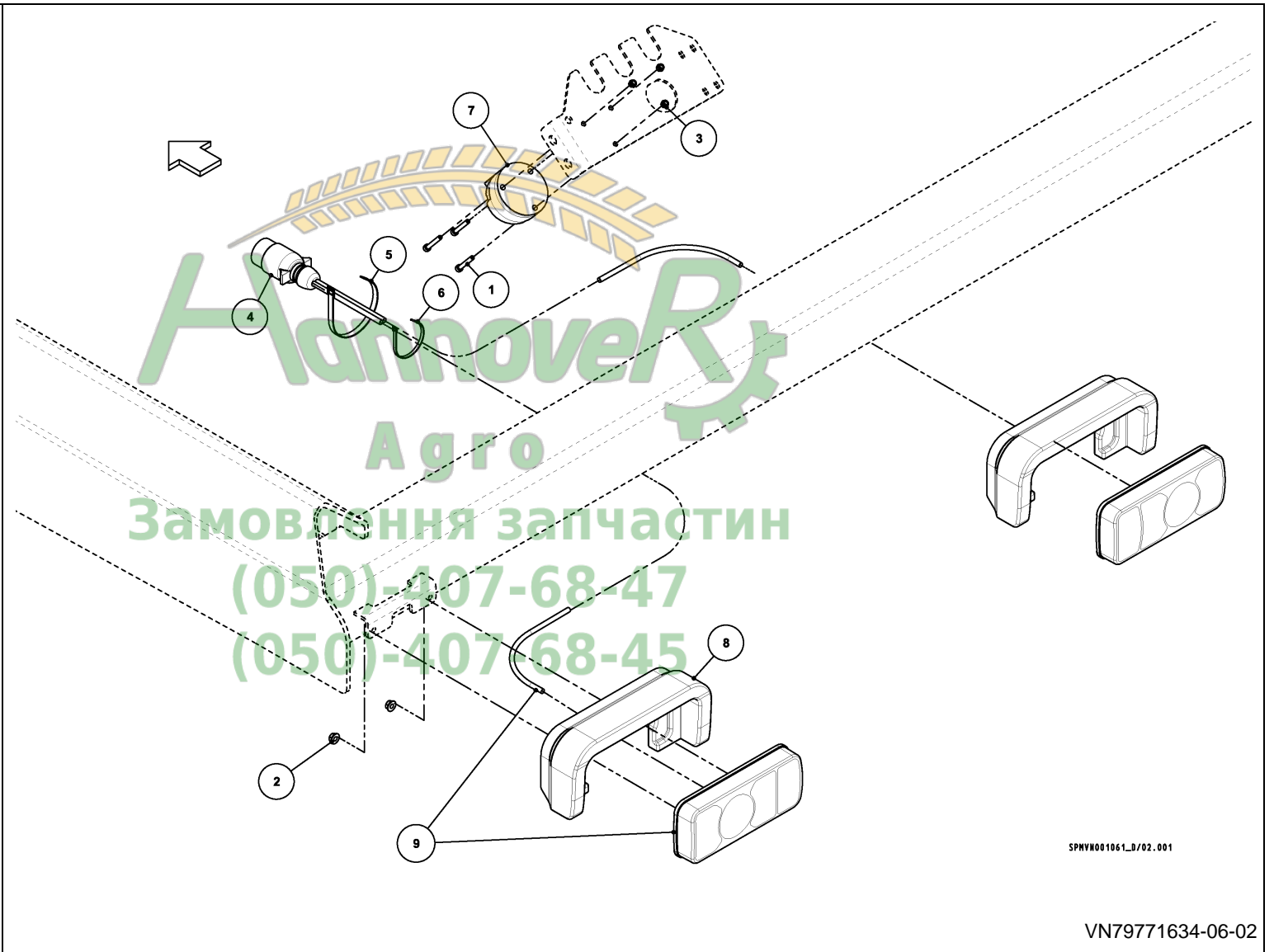

SPMVK001061_D/02.001

VN79771634-06-02

RO-XXL GEO / LIGHTING US/CA



PosNo.	Part No.	Qty.
1	A138263478	1
2	A138263502	1
3	A138270878	1
4	A138271078	2
5	KG00562600	2
6	KG00739400	2
7	KG01059600	4
8	KG01069700	2
9	KG01069900	2
10	KG01263900	2
11	VN80504001	2
12	VN80504003	10
13	VNB5007578	2

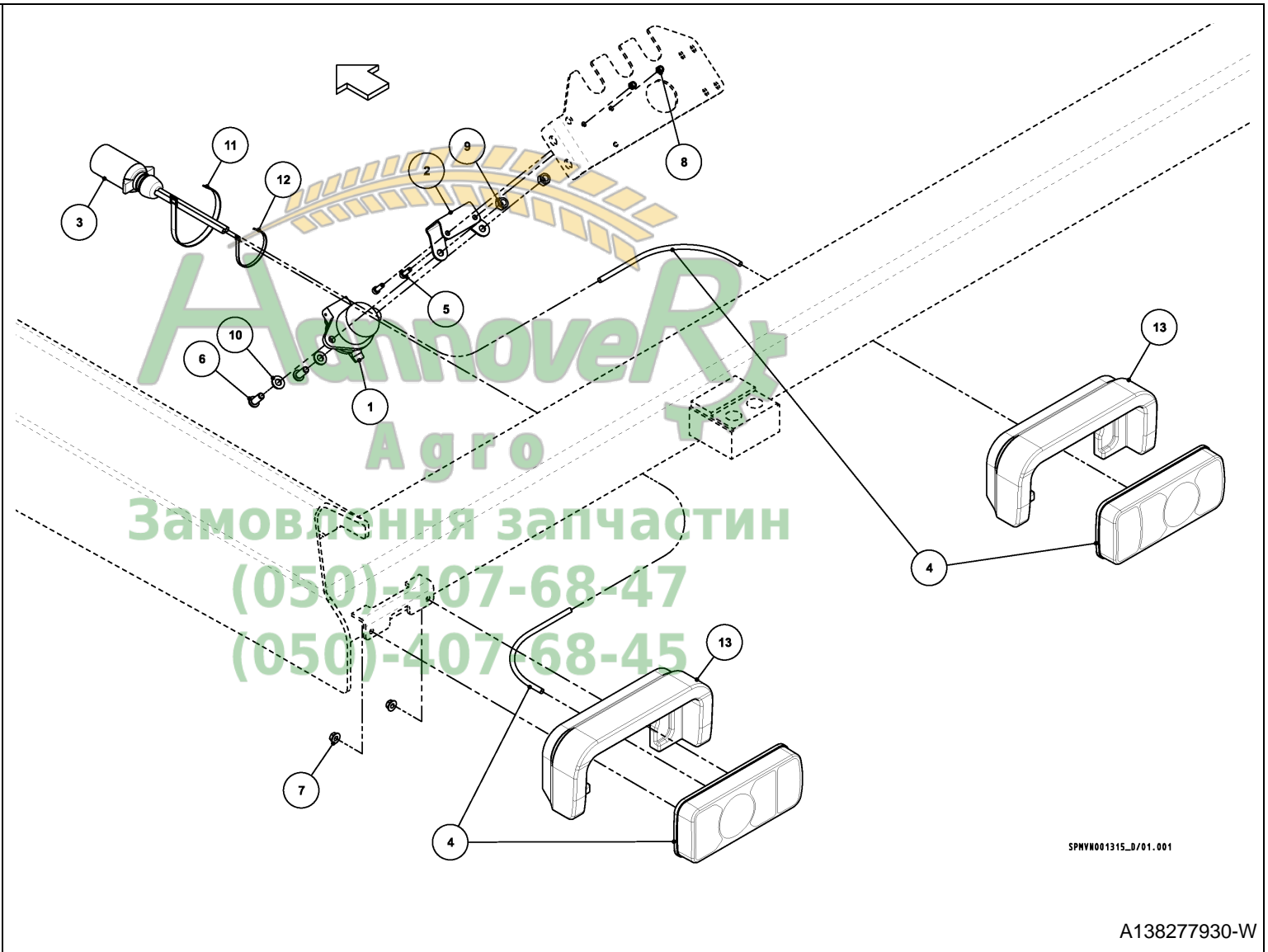

RO-XXL GEO / DRIVE



PosNo.	Part No.	Qty.
1	KG00399400	4
2	KG00399800	6
3	KG00739600	12
4	KG01069900	28
5	KG01070100	10
6	KG01263900	12
7	KG01264100	20
8	RG00050664	12
9	VNB0682965	2
10	VNB2417578	4
11	VNB2417602	24
12	VNB3550678	1
13	VNB3588378	6
14	VNB3588478	6
15	VNB3910902	4
16	VNB4064878	1
17	VNB4064978	1
18	VNB4341978	1
19	VNB4347965	2
20	VNB4348165	2
21	VNB4348365	2
22	VNB4348493	4
23	VNB4466478	2
24	VNB4466678	1
25	VNB4668565	4

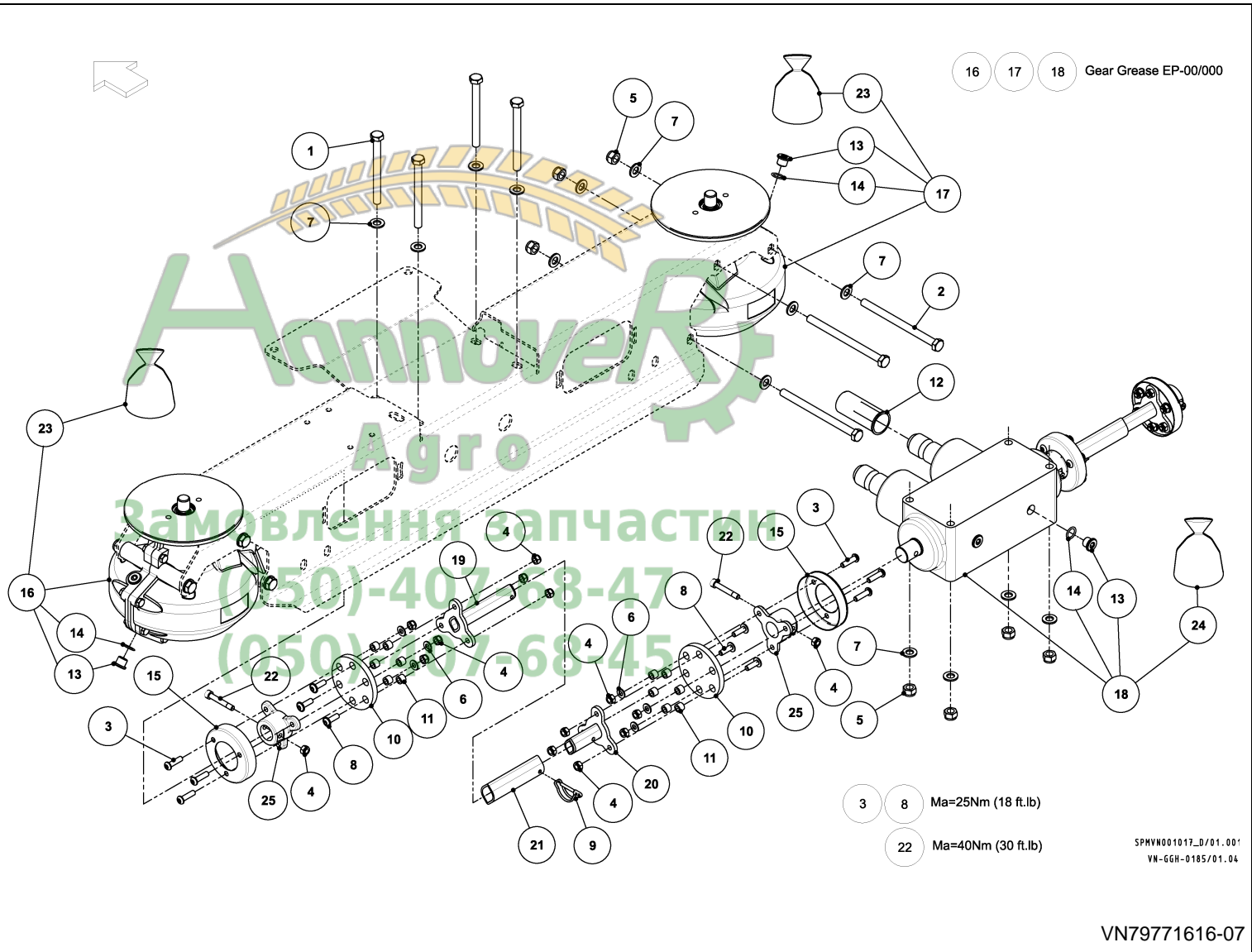

RO-XXL GEO / DOSAGE



PosNo.	Part No.	Qty.
1	A138195602	2
2	A138216098	1
3	A138216198	1
4	A138217502	1
5	A138217602	1
6	A138218102	1
7	A138218202	1
8	KG00499500	8
9	KG00562400	6
10	KG00738100	6
11	KG00747600	4
12	KG00870200	6
13	KG01044900	8
14	KG01053800	16
15	KG01069800	12
16	KG01107862	2
17	KG01283000	6
18	KG01421400	4
19	VN30117100	8
20	VN36112005	4
21	VNB3317278	2
22	VNB3559902	2
23	VNB3958278	2
24	VNB3970002	2
25	VNB4023502	2
26	VNB4042498	1
27	VNB4042598	1
28	VNB4042702	16
29	VNB4059402	2
30	VNB4060978	2
31	VNB4061702	2
32	VNB4061978	2
33	VNB4073178	2
34	VNB4077378	6
35	VNB4225402	2

50Nm
37 ft.lb

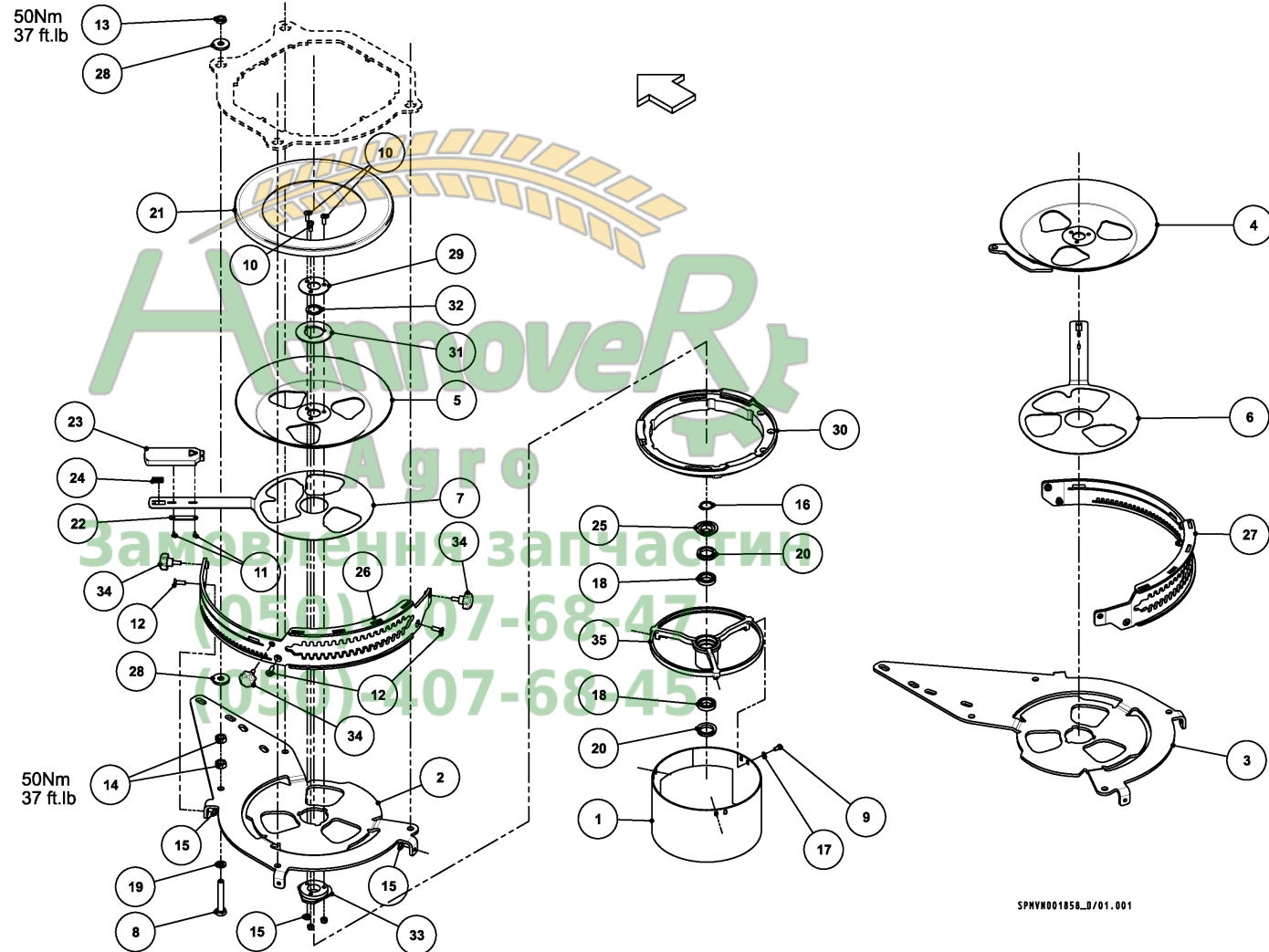

SPHY001858_D/01.001

A138375130-08

RO-XXL GEO / DOSAGE



PosNo.	Part No.	Qty.
1	A138222330	4
2	KG00498700	8
3	KG00870000	6
4	KG00945900	4
5	KG01069800	6
6	KG01069900	8
7	KG01070000	8
8	KG01901500	8
9	VN30130800	4
10	VN36107317	4
11	VNB0566173	1
12	VNB2235978	16
13	VNB3317378	4
14	VNB4063078	1
15	VNB4063178	1
16	VNB4713902	2
17	VNB4790102	1
18	VNB4790202	1
19	VNB4790302	1
20	VNB4790402	1
21	VNB4808502	8

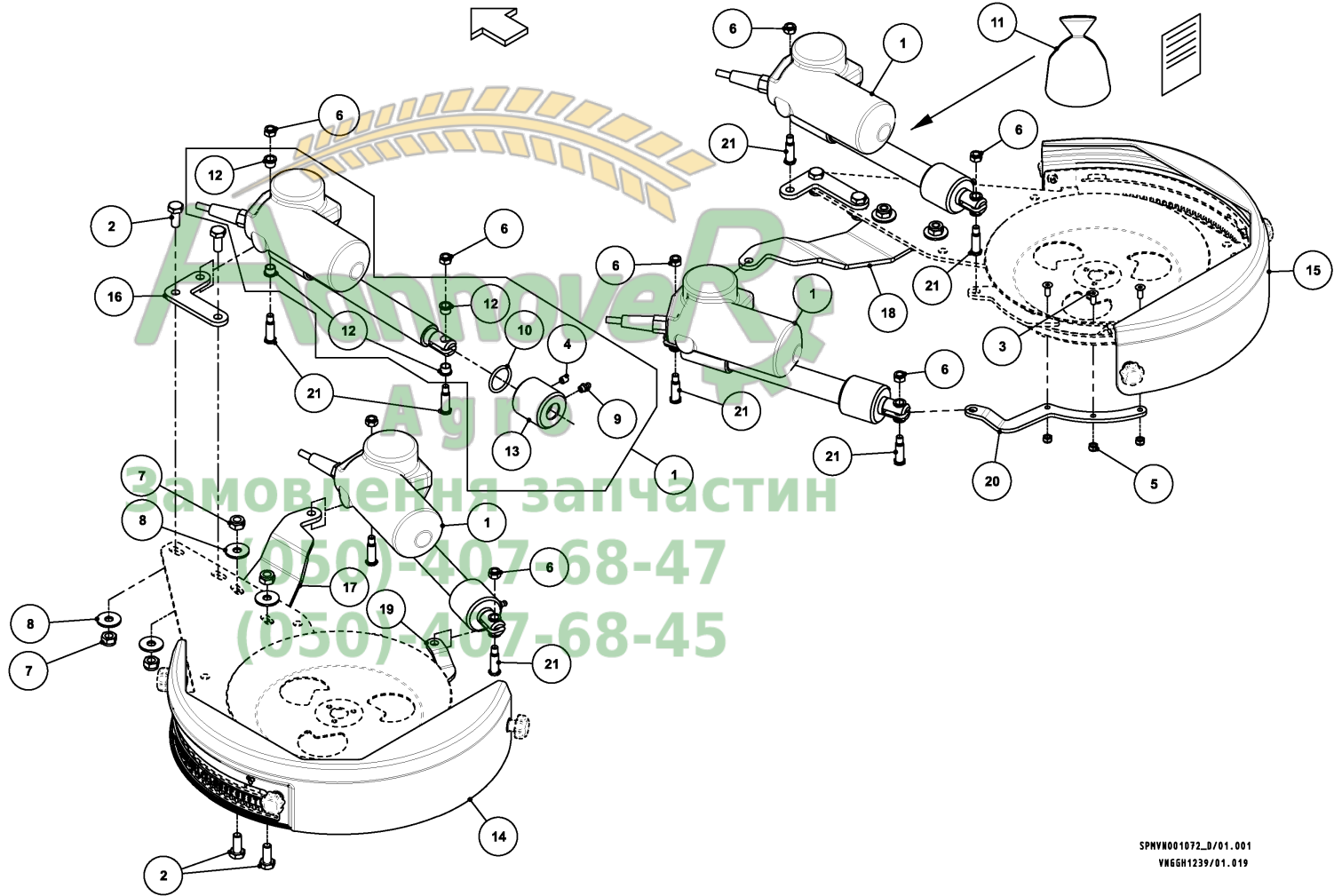

SPMVM001072_D/01.001
VNGGH1239/01.019

VN79771635-09-01

RO-XXL GEO / DISC, BROADCASTER



PosNo.	Part No.	Qty.
1	A138193402	1
2	A138193802	1
3	A138194202	1
4	A138195302	1
5	A138196602	12
6	A138205502	2
7	A138370002	4
8	KG00498800	4
9	KG00565700	2
10	KG01069900	2
11	KG01283300	4
12	VN30105200	16
13	VN30130800	4
14	VN36112032	2
15	VN79771219	1
16	VNB3388365	2
17	VNB3717802	2
18	VNB4916674	1

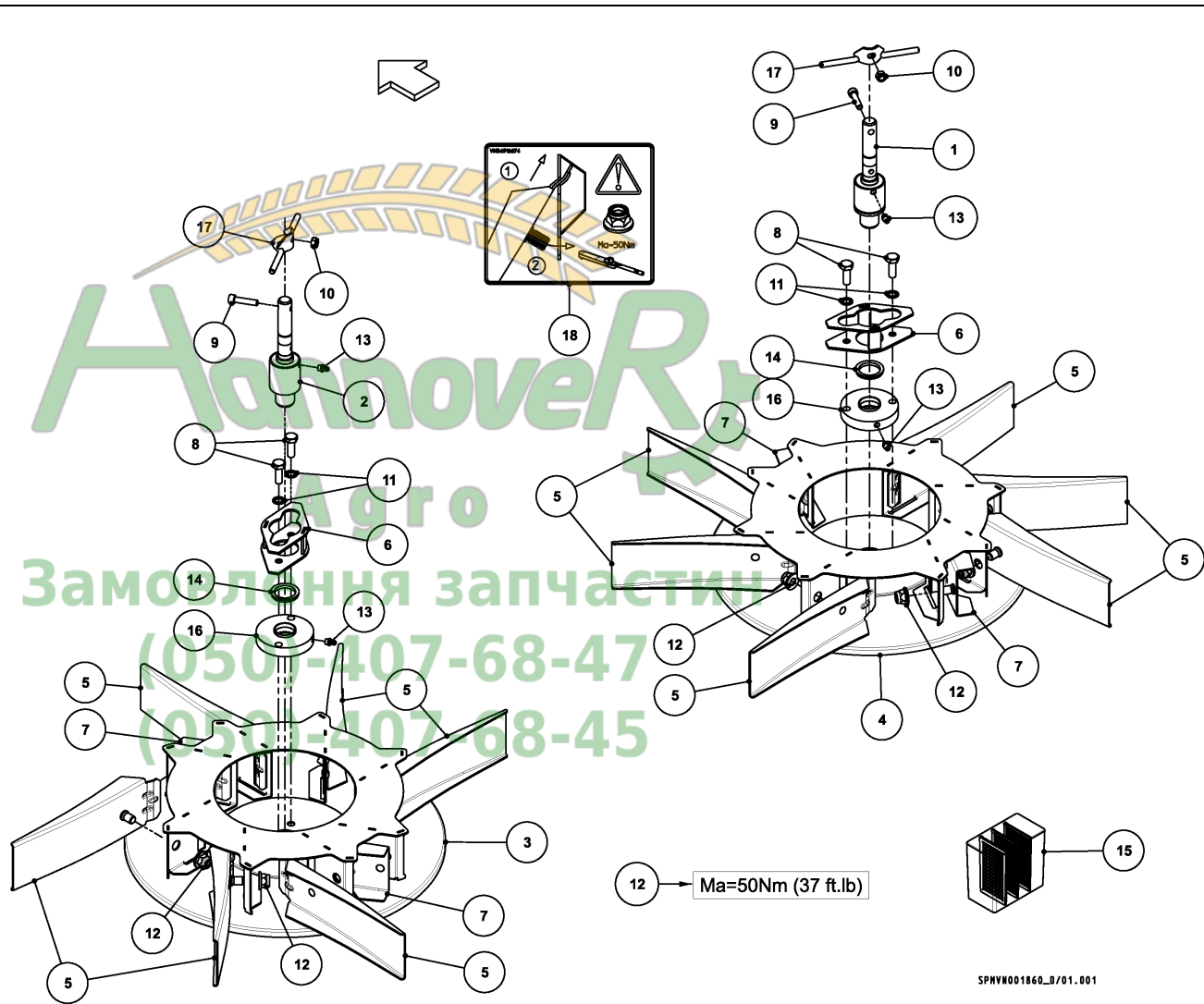

RO-XXL GEO / CONTROL, ISO



PosNo.	Part No.	Qty.
1	A100005600	4
2	A138198202	4
3	KG00433200	8
4	KG00497600	4
5	KG01069900	4
6	MT00001356	1
7	VN80504001	6
8	VNB2336686	1
9	VNB4070073	4
10	VNB4190502	4
11	VNB4190602	4
12	VNB4190702	4
13	VNB4281802	8
14	VNB4281902	4

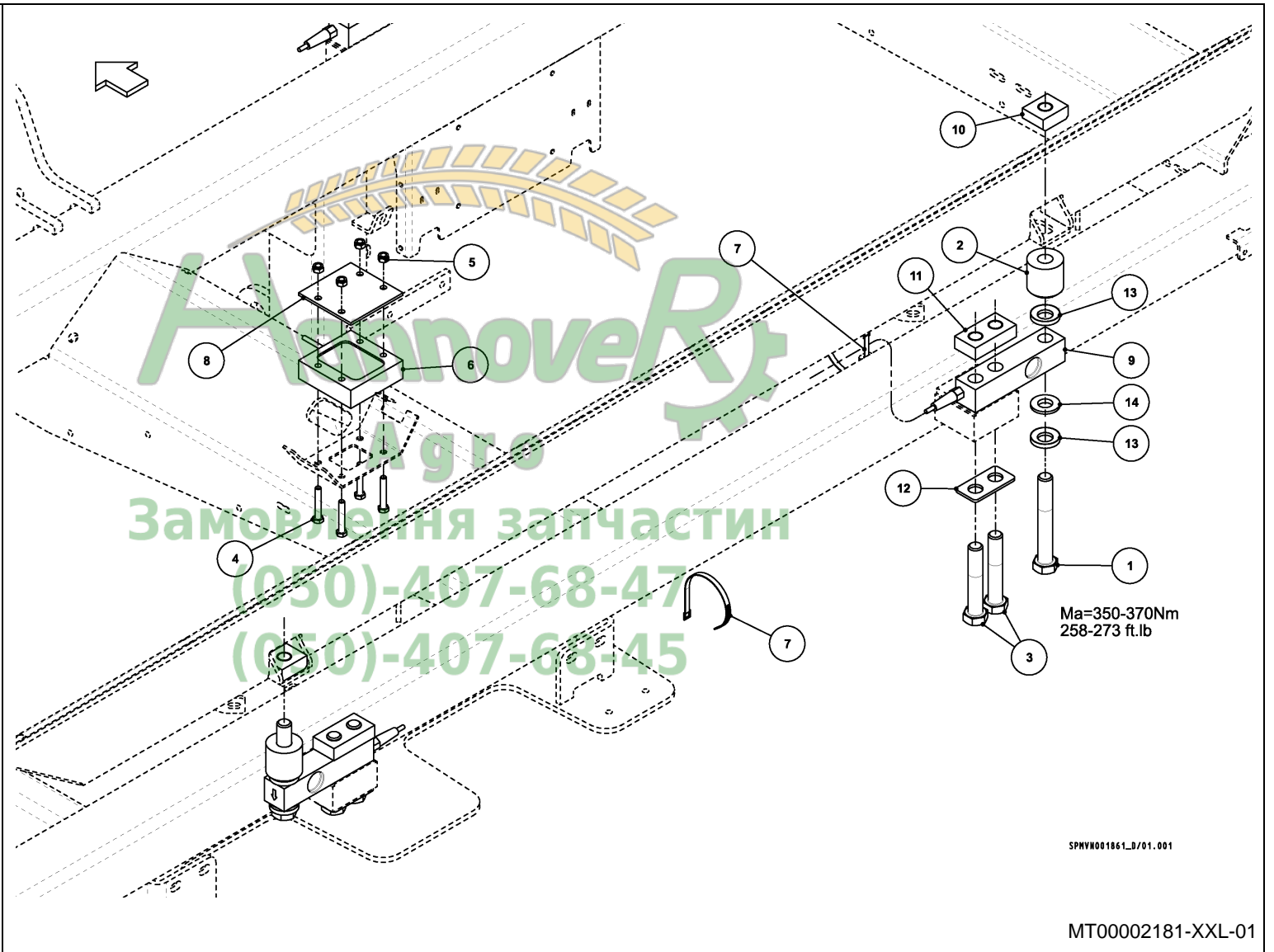

RO-XXL GEO / CONTROL, ISO



PosNo.	Part No.	Qty.
1	A136026300	1
2	A136074900	1
3	A136081400	1
4	A136081500	1
5	A136081700	1
6	KG00496800	2
7	KG01053500	4
8	KG01069900	2
9	MT00001663	1
10	MT00001688	1
11	MT00002021	1
12	MT00002274	1
13	VN30117600	4
14	VN80504001	12
15	VN80504003	10
16	VNB0253473	1
17	VNB0489473	1
18	VNB0563673	1
19	VNB0578473	1
20	VNB4256202	1

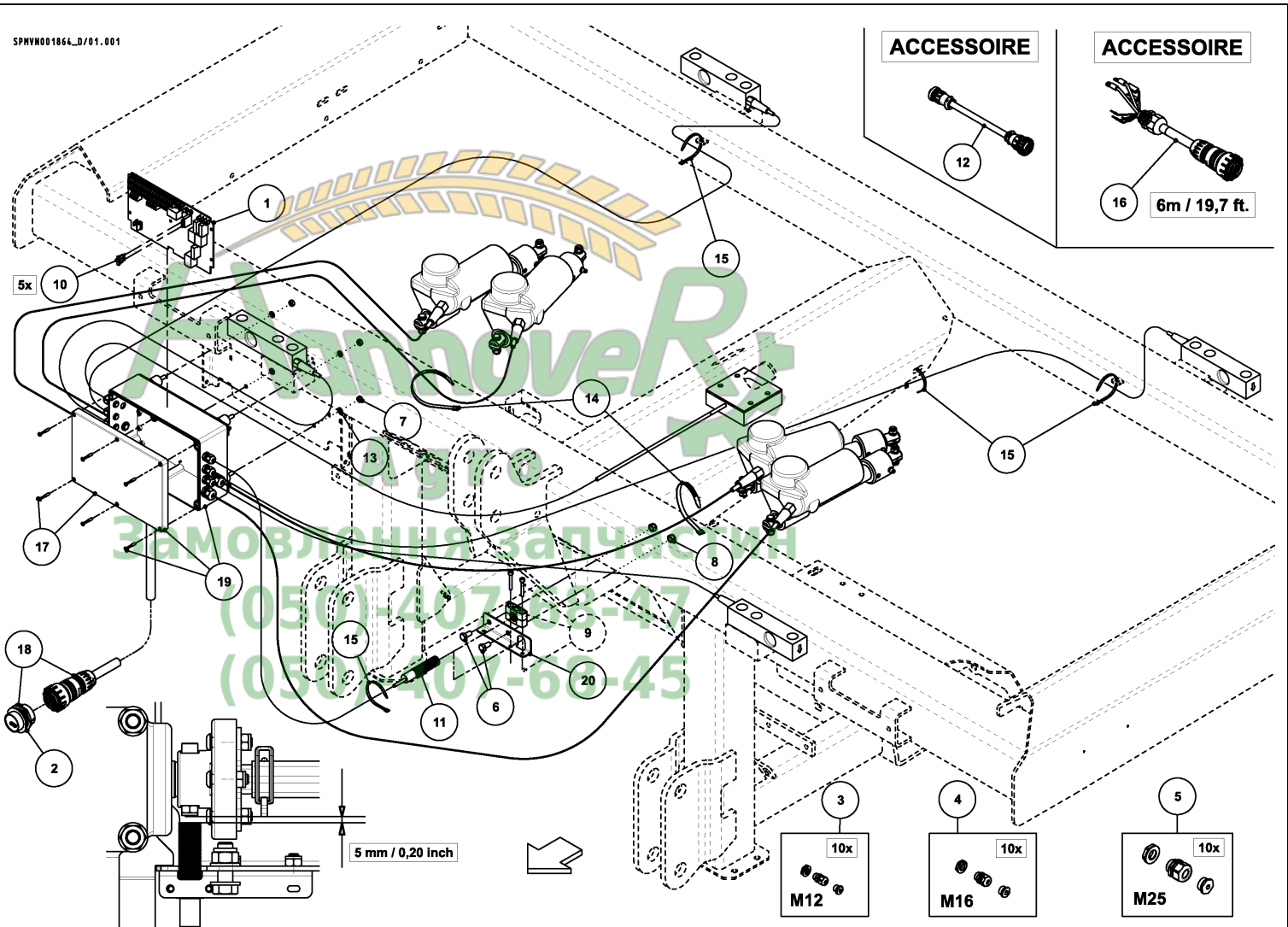

MT00002181-WGEO-2016

RO-XXL GEO / UNIV. JOINT SHAFT



PosNo.	Part No.	Qty.
1	KG00742063	6
2	KG01192062	2
3	KG02000000	1
4	KG02000100	1
5	KG02000200	1
6	KG02000300	1
7	KG02000400	1
8	KG02000500	2
9	KG02000600	2
10	KG02000700	1
11	KG02000800	1
12	KG02000900	1
13	KG02001000	1
14	KG02001100	2
15	KG02001200	1
16	KG02001300	2
17	KG02001400	1
18	KG02001500	2
19	KG02001600	1
20	KT56968000	1
21	KT56969000	1
22	VF16661794	1
23	VF16661795	1
24	VGTR1029	1

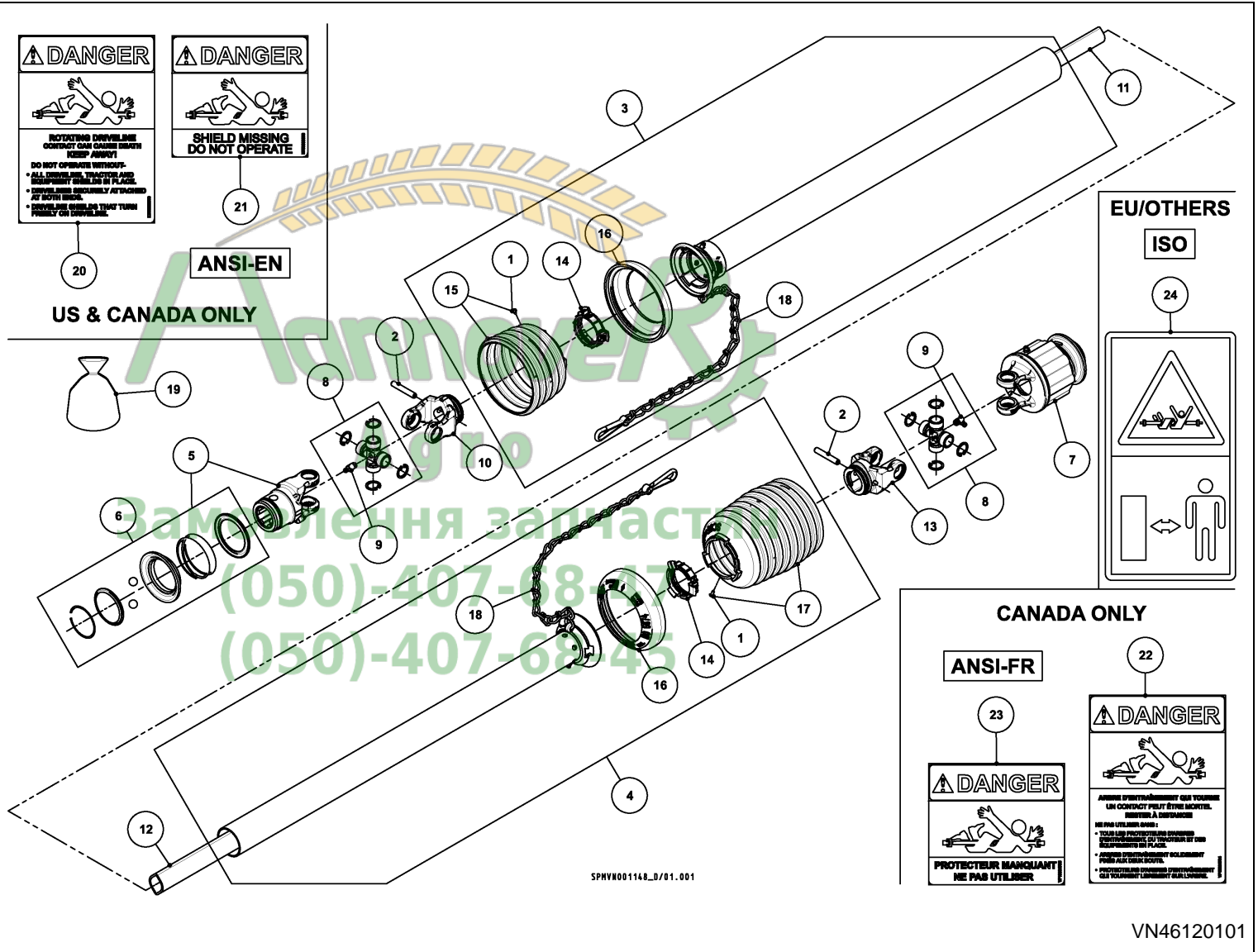

RO-XXL GEO / DECAL SCHEMATIC ISO (EU/OTHERS)



PosNo.	Part No.	Qty.
1	A138371674	1
2	VNB2071674	3
3	VNB2426674	1
4	VNB2822600	1
5	VNB3444974	1
6	VNB4053074	1
7	VNB4366374	2
8	VNB4376974	2
9	VNB4377074	1
10	VNB4377174	1
11	VNB4377474	2
12	VNB4377574	2
13	VNB4493474	1
14	VNB4800374	1
15	VNB4916674	2
16	VNB5049874	2

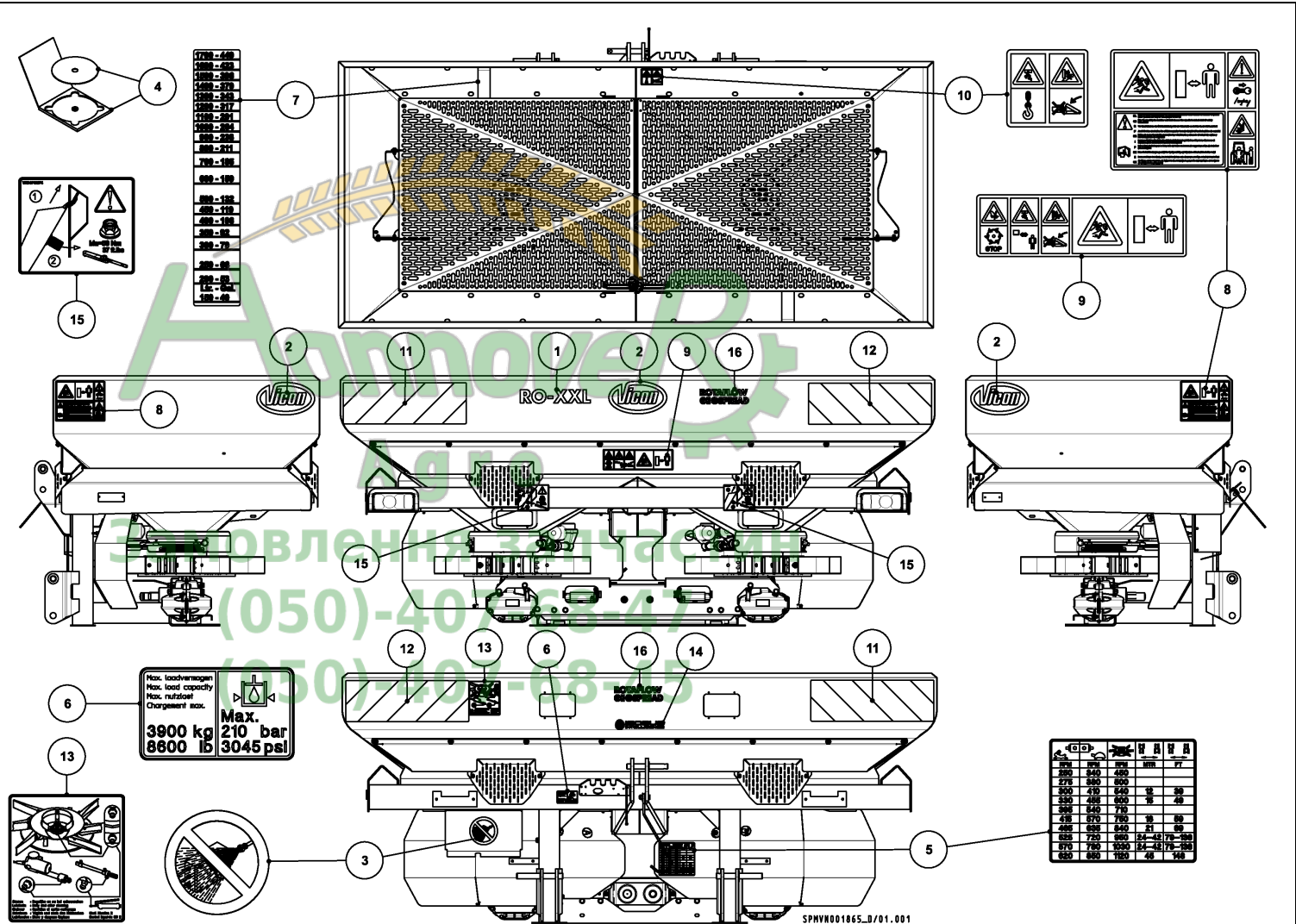

RO-XXL GEO / DECAL SCHEMATIC ISO (FRANCE)



PosNo.	Part No.	Qty.
1	VNB4377474	1
2	VNB4377574	1

A138375030

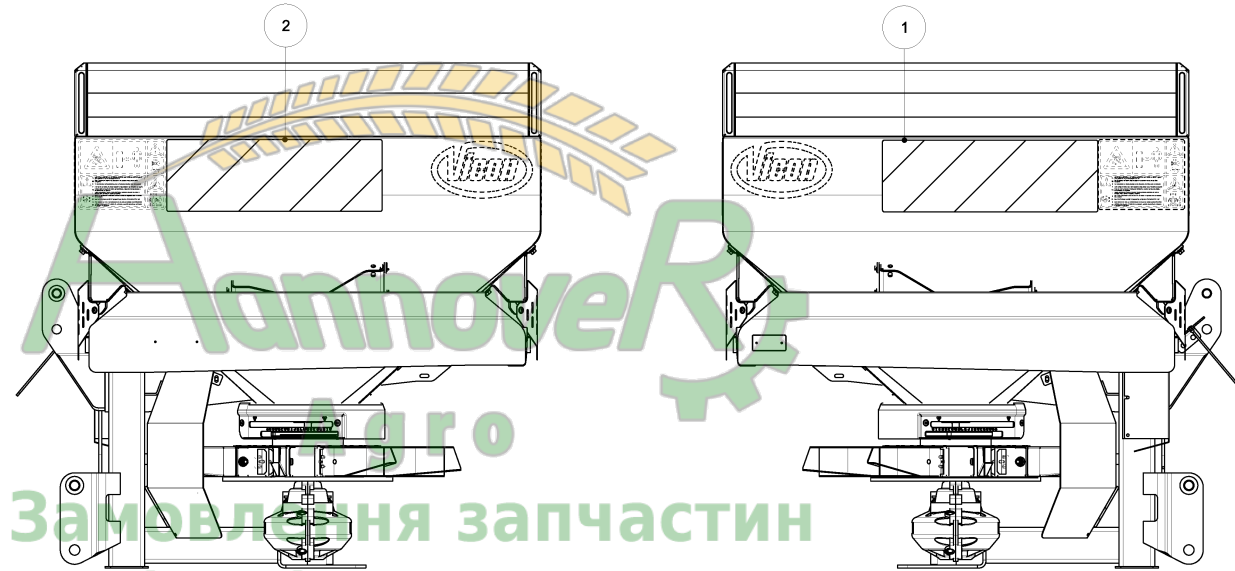

Заповнення запчастин
 (050)-407-68-47
 (050)-407-68-45

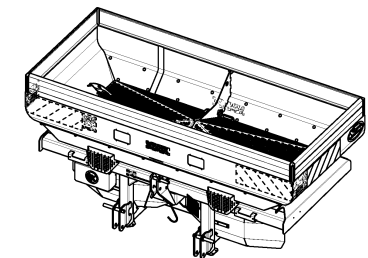

SPMKN001866_D/01.001

ROXXL_VN25400_DC2

RO-XXL GEO / DECAL SCHEMATIC ANSI EN (US/CANADA)



PosNo.	Part No.	Qty.
1	A138371674	1
2	VF16649537	2
3	VF16649538	2
4	VF16649632	2
5	VF16661493	3
6	VF16661496	2
7	VF16661498	2
8	VF16661500	2
9	VF16661510	1
10	VF16661512	2
11	VF16661574	1
12	VGTR2039	1
13	VNB2071674	3
14	VNB2426674	1
15	VNB2822600	1
16	VNB3444974	1
17	VNB4053074	1
18	VNB4366374	2
19	VNB4493474	1
20	VNB4800374	2
21	VNB4916674	2
22	VNB5049874	2

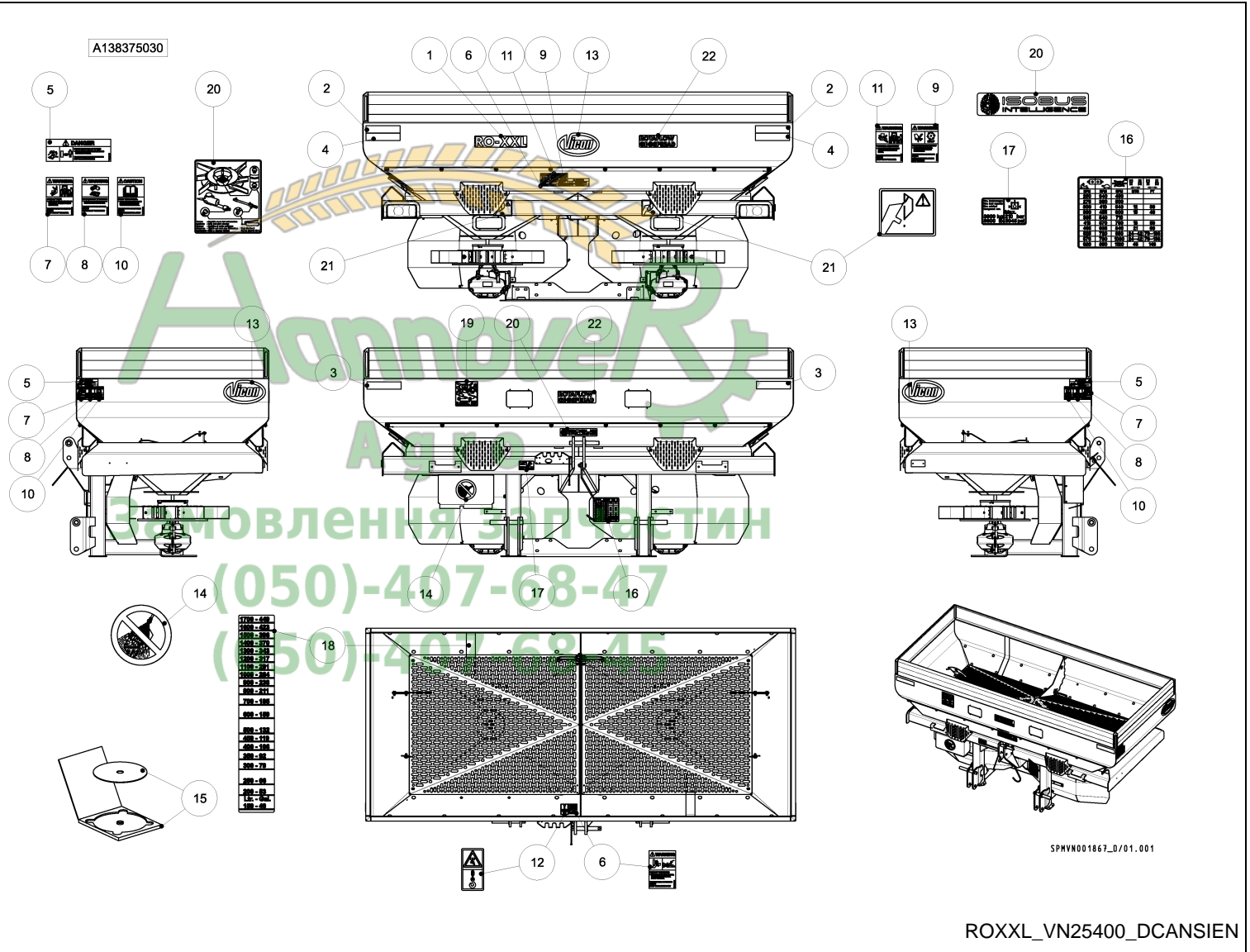

RO-XXL GEO / HOPPER EXTENSION (1875 L / 495 GAL)



PosNo.	Part No.	Qty.
1	VNB3984186	4
2	VNB4014778	4
3	VNB4053474	8
4	VNB4218178	16
5	VNB4675502	2
6	VNB4675702	2

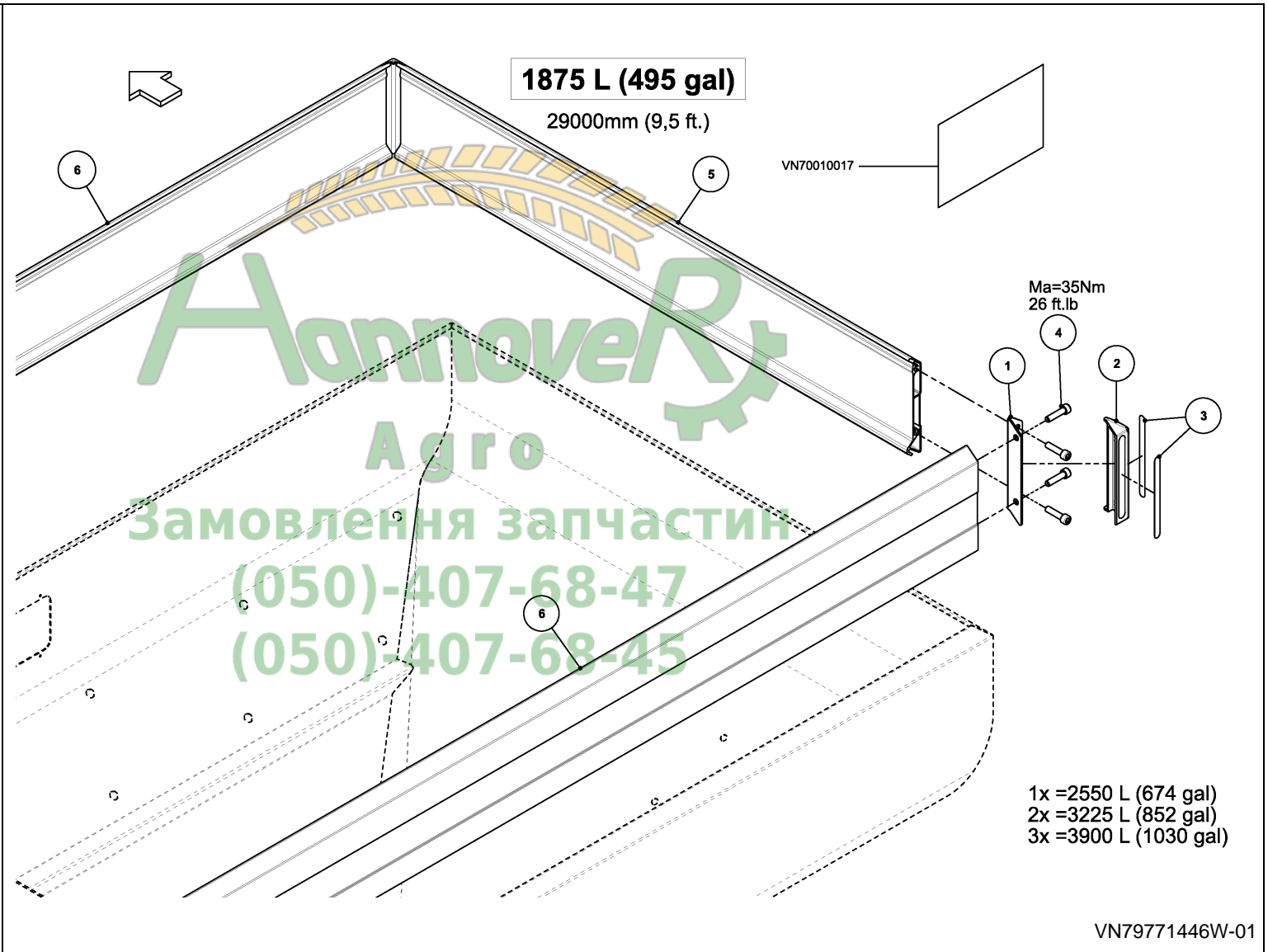

RO-XXL GEO / TARPAULIN (1875 L / 495 GAL)



PosNo.	Part No.	Qty.
1	KG00497200	8
2	KG00497600	8
3	KG00652900	4
4	KG00712400	1
5	KG00738100	2
6	KG00739600	8
7	KG01053500	2
8	KG01053700	8
9	KG01069600	1
10	KG01069900	12
11	KG01263600	1
12	KG01263900	4
13	KG01901400	4
14	KG01901500	8
15	RG00040217	1
16	VF16661496	1
17	VF16661768	1
18	VGTR2059	1
19	VNB2092402	4
20	VNB3443478	4
21	VNB3447178	1
22	VNB3603398	1
23	VNB3603598	1
24	VNB3708098	1
25	VNB4306798	1
26	VNB4306898	1
27	VNB4306998	1
28	VNB4309102	8
29	VNB4373498	2
30	VNB4487278	4
31	VNB4998778	1

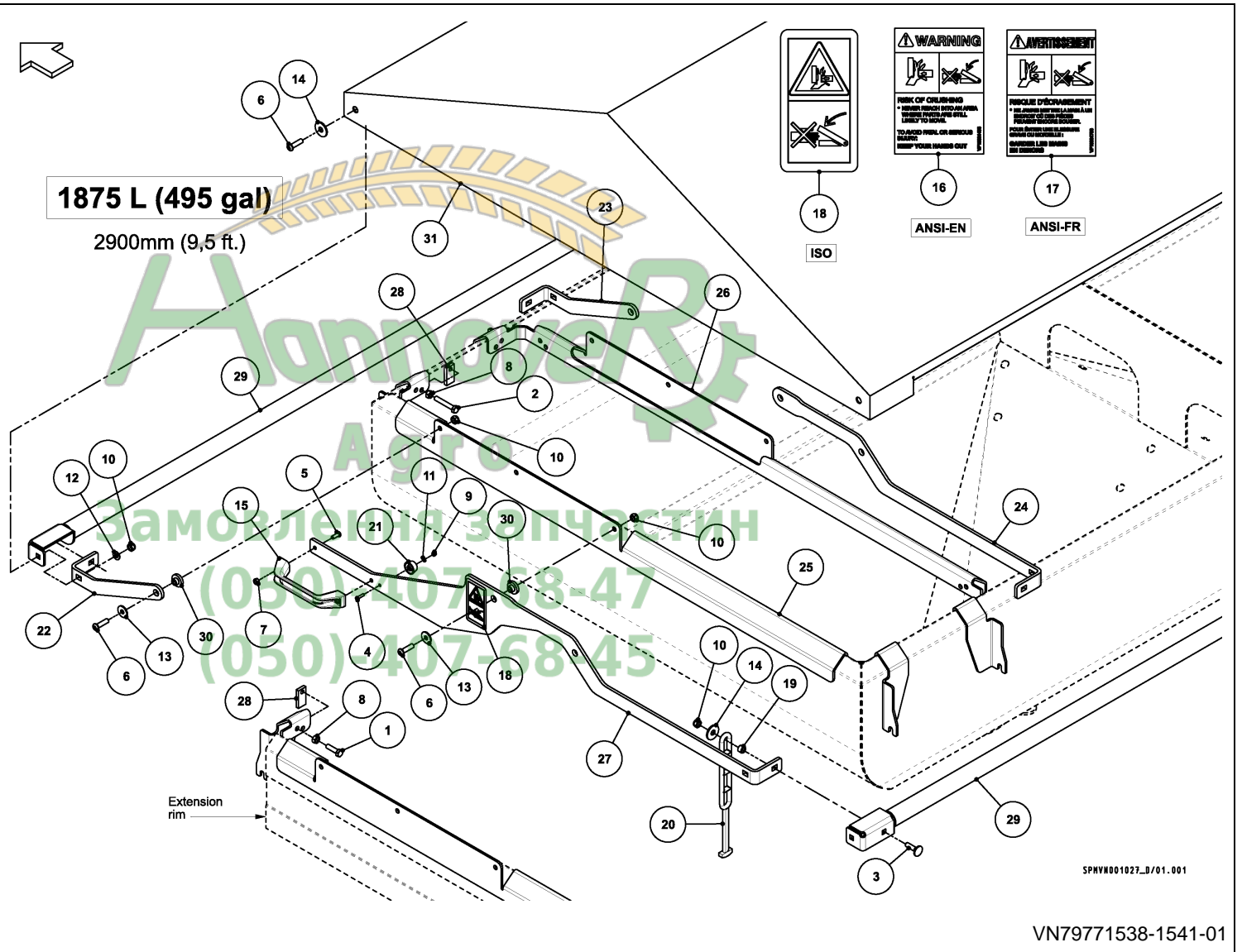

RO-XXL GEO / TARPAULIN (1875 L / 495 GAL)



PosNo.	Part No.	Qty.
1	KG00652900	8
2	KG00739600	2
3	KG01069900	10
4	KG01263900	4
5	KG01901400	6
6	VNB3602698	1
7	VNB3602798	1
8	VNB3603198	2
9	VNB4373498	1
10	VNB4487278	6

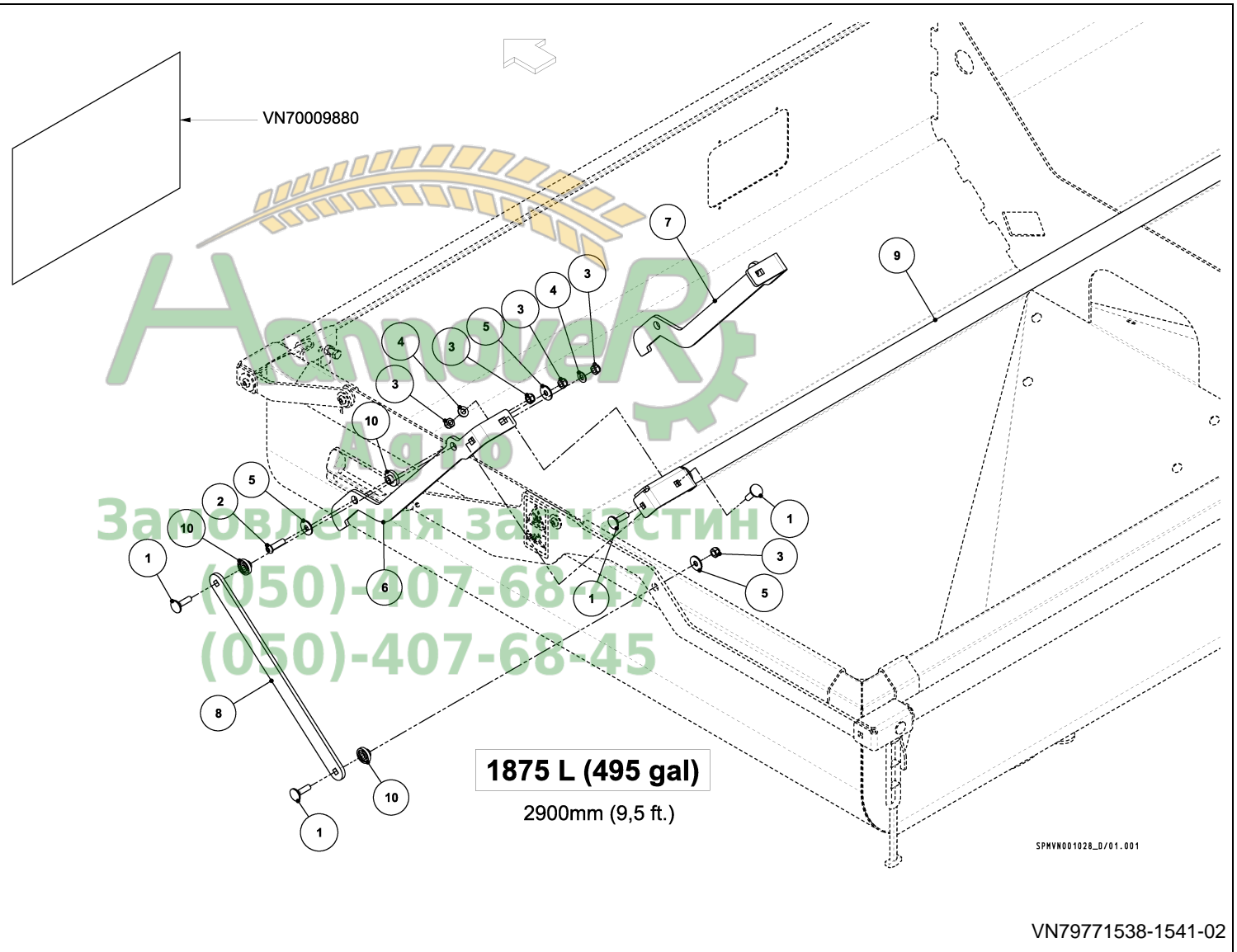

RO-XXL GEO / WARNING TRIANGLE SMV



PosNo.	Part No.	Qty.
1	KG00738100	2
2	KG01069800	2
3	VNB1063478	2
4	VNB1847378	1

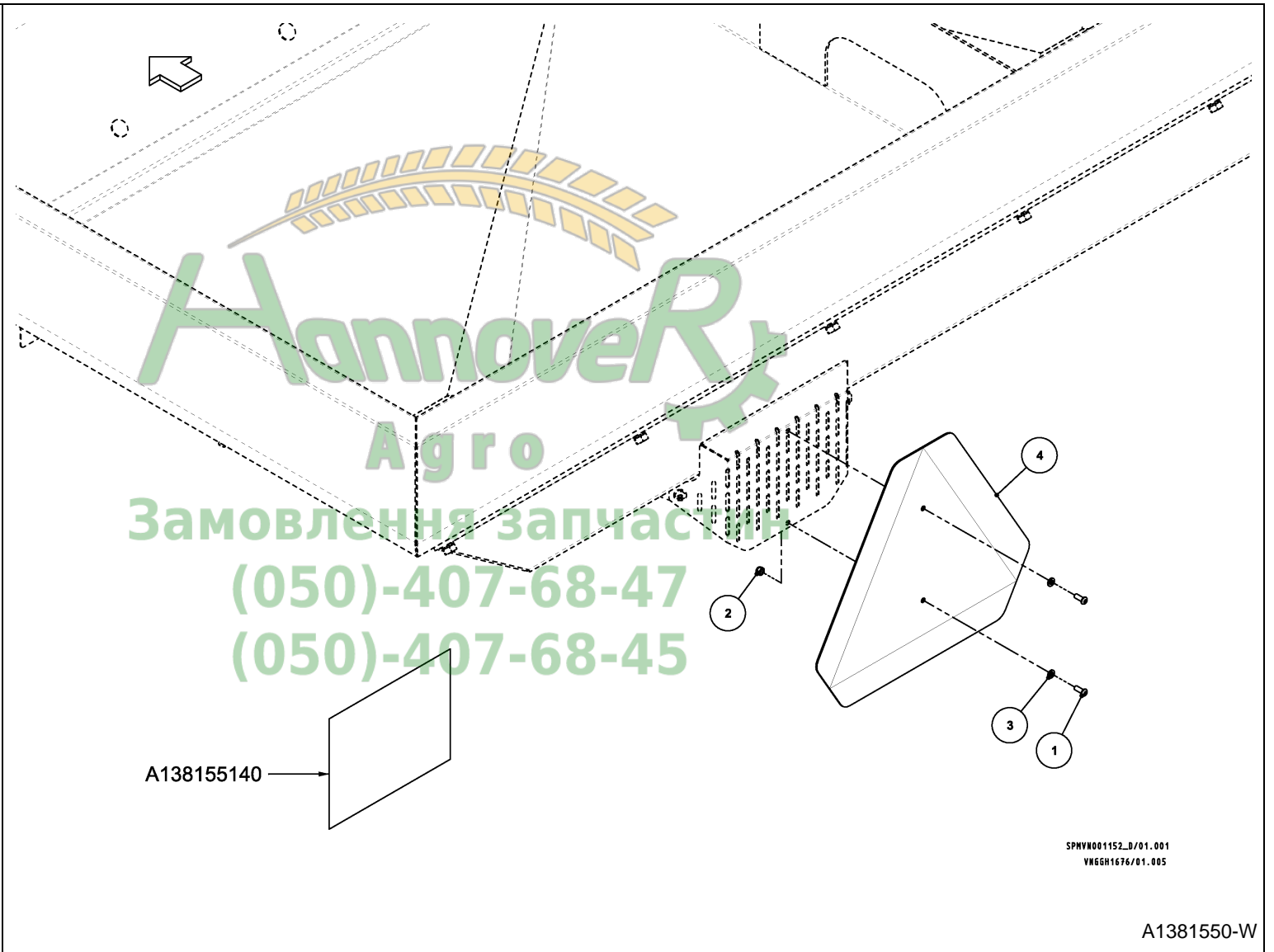

SPNV001152_D/01.001
VNGH1676/01.005

A1381550-W

RO-XXL GEO / MUD GUARDS



PosNo.	Part No.	Qty.
1	A138076102	4
2	KG00495100	8
3	KG00871700	4
4	KG01069800	8
5	KG01069900	4
6	VN30128812	4
7	VNB4292878	4
8	VNB4998302	2
9	VNB5001602	2
10	VNB5001778	2
11	VNB5015098	2

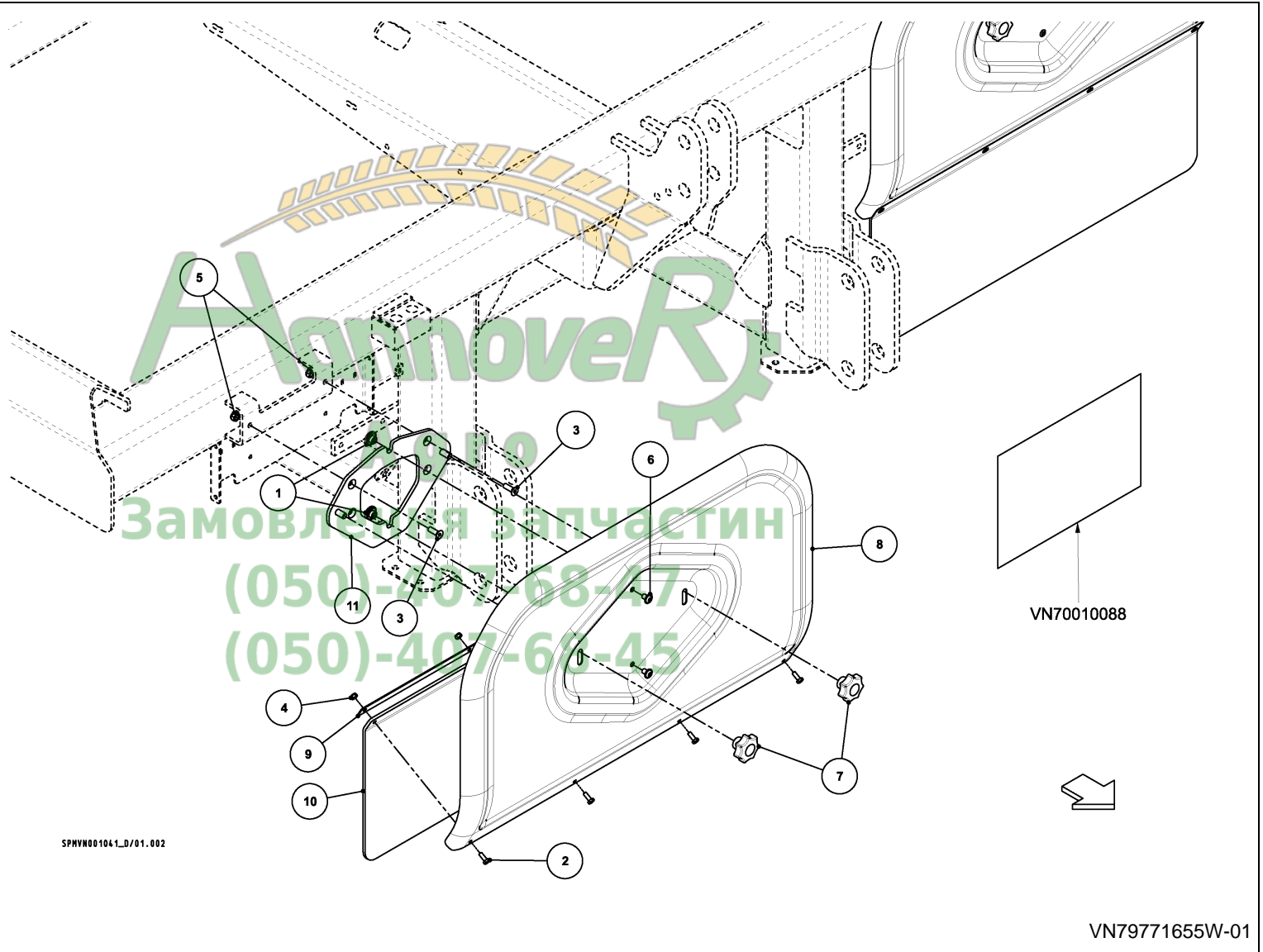

RO-XXL GEO / HOPPER EMPTYING SET



PosNo.	Part No.	Qty.
1	A138367202	6
2	A138367302	2
3	KG00679900	8
4	KG00738100	4
5	KG00738300	6
6	KG01069800	6
7	KG01263600	8
8	KG01264000	6
9	KG01901300	2
10	VN30105400	8
11	VNB4334578	4
12	VNB4408202	2
13	VNB4408302	2
14	VNB4451002	6
15	VNB4975278	2

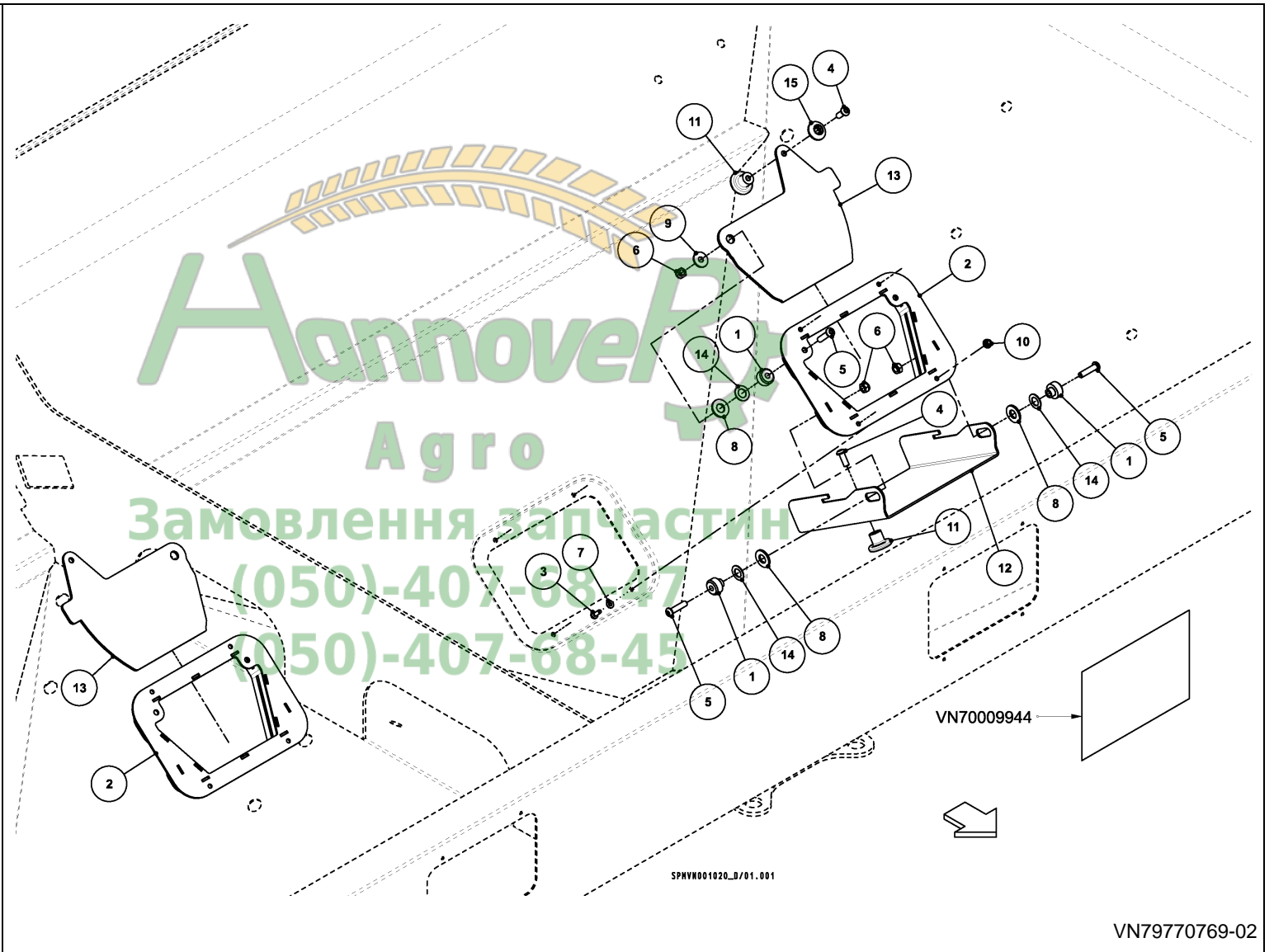

SPNV001020_D/01.001

VN79770769-02

RO-XXL GEO / VANES SET



PosNo.	Part No.	Qty.
1	A138379202	8
2	A138379402	4
3	A138379602	2
4	A138379802	8
5	A138380002	4
6	A138380202	2
7	VN30105200	16
8	VNB4916674	1

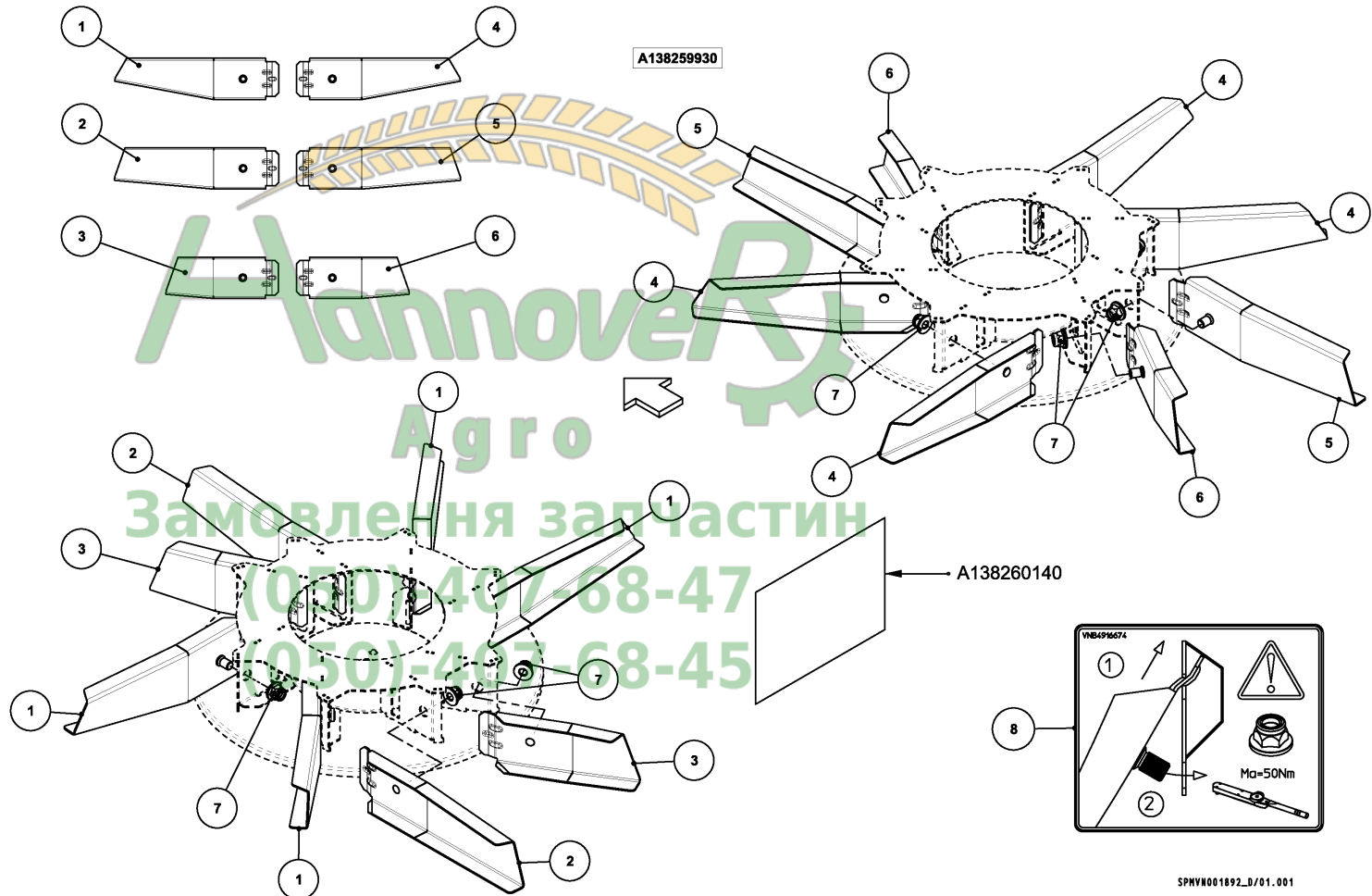

SPVH001892_D/01.001

A138259930

RO-XXL GEO / LADDERSET



PosNo.	Part No.	Qty.
1	KG00497100	7
2	KG00654400	1
3	KG00868600	6
4	KG00870200	6
5	KG01069700	6
6	KG01069800	6
7	KG01069900	7
8	KG01901400	7
9	VNB4442278	1
10	VNB4450578	2
11	VNB4451198	1
12	VNB4451298	2
13	VNB4451398	7
14	VNB4451498	1
15	VNB4451978	1
16	VNB4473502	1
17	VNB4743378	3

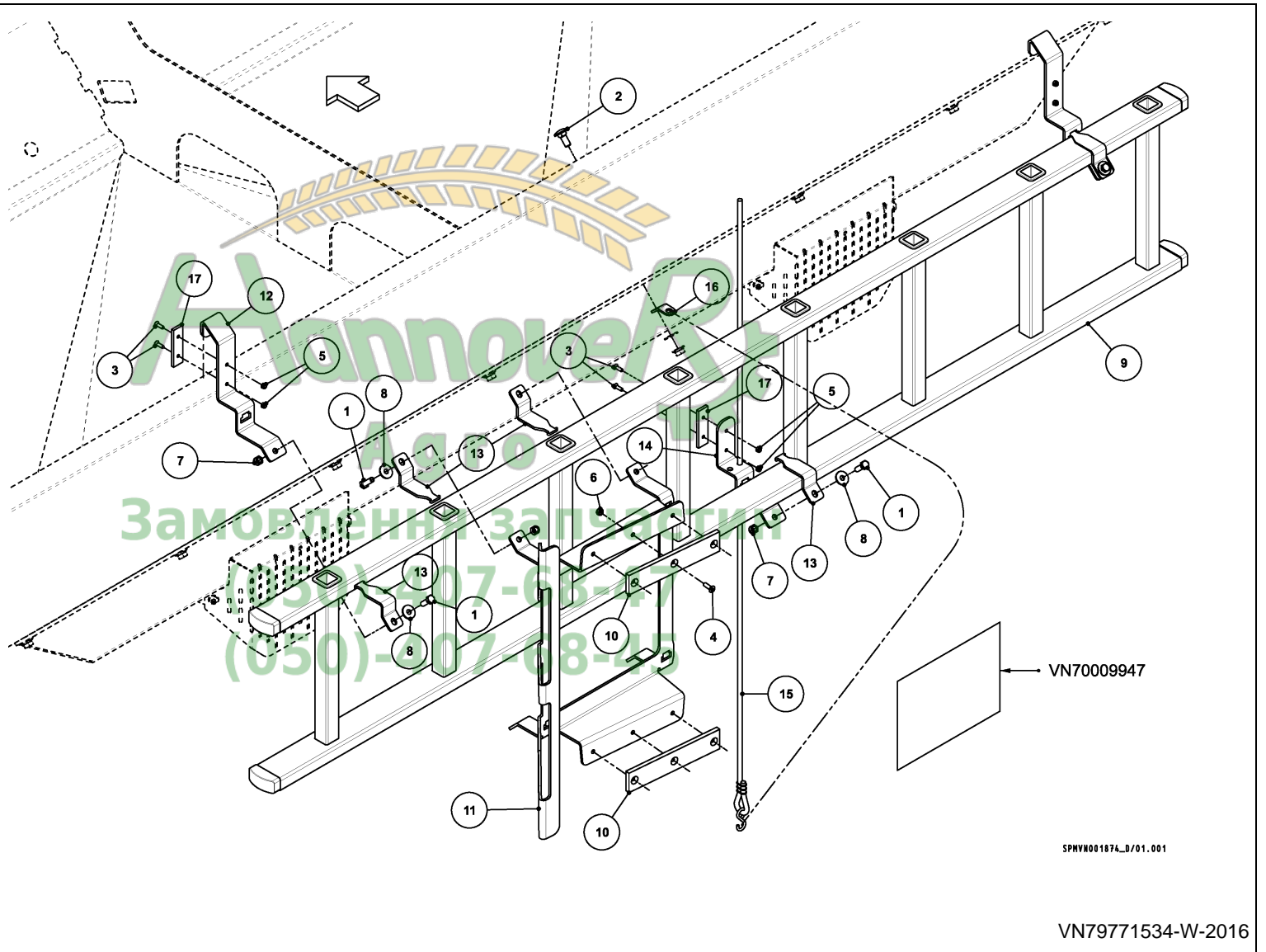

SPNVN001874_D/01.001

VN79771534-W-2016

RO-XXL GEO / WHEELSET



PosNo.	Part No.	Qty.
1	A138159830	4
2	KG00654300	10
3	KG01069900	2
4	KG01070000	10
5	RG00050664	2
6	VNB0682965	4
7	VNB5010086	1
8	VNB5014002	1
9	VNB5014502	1

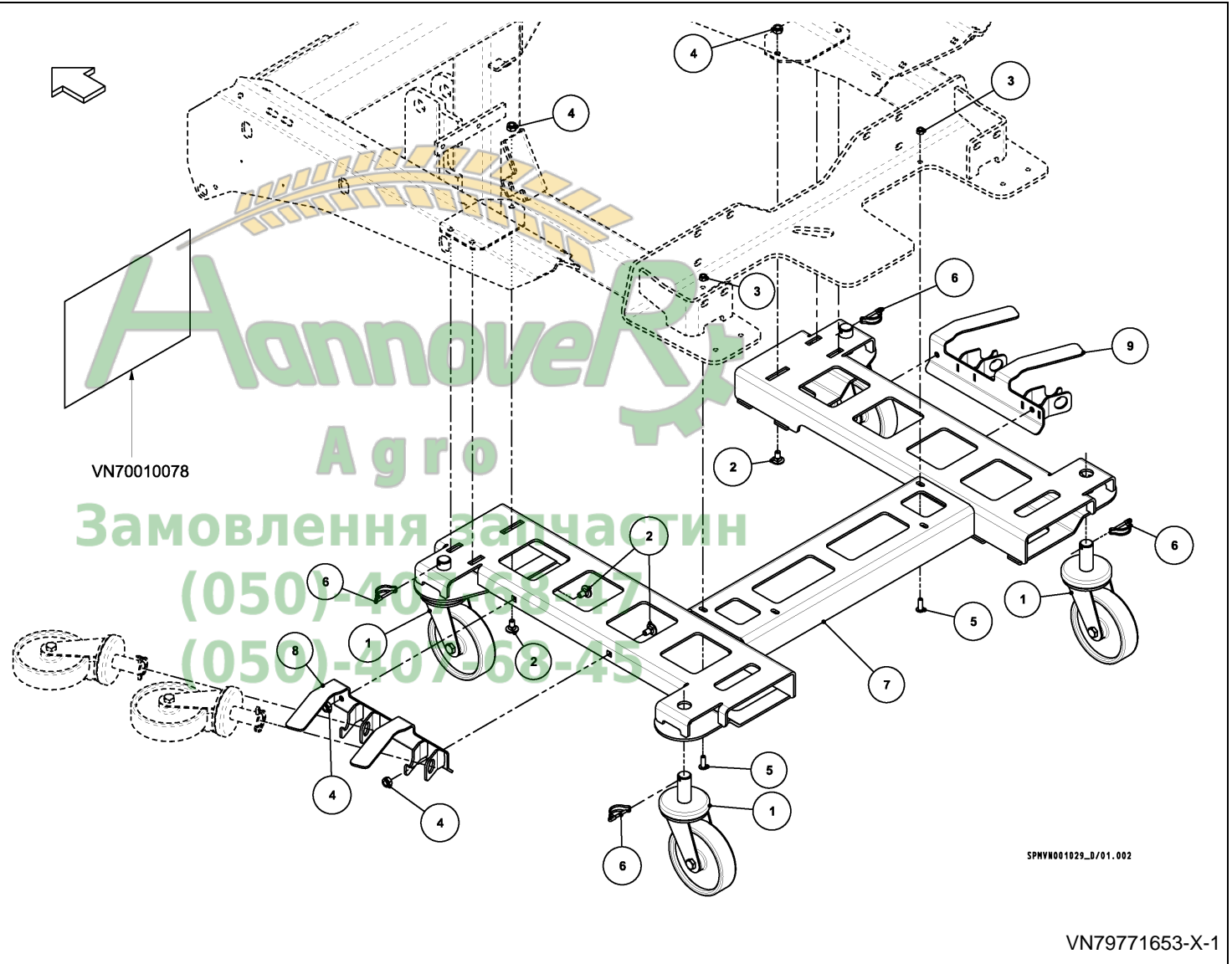

SPHY001029_D/01.002

VN79771653-X-1

RO-XXL GEO / BOUNDARY SPREADING PLATE (HYDRAULIC)



PosNo. Part No. Qty.

1	A100004700	4
2	A138059394	1
3	A138113078	4
4	A138135402	1
5	KG00496900	2
6	KG00497200	4
7	KG00746800	4
8	KG01069800	4
9	KG01069900	14
10	KG01070000	6
11	KG01263900	10
12	KG01901300	4
13	RG00048610	1
14	VF16661496	2
15	VF16661768	2
16	VGTR2059	2
17	VN31419900	2
18	VN38241605	1
19	VN38854581	1
20	VN79771437	1
21	VN80504003	5
22	VNB0450173	1
23	VNB2235978	12
24	VNB4008178	1
25	VNB4297478	1
26	VNB4808502	1
27	VNB4808802	7
28	VNB5004194	2
29	VNB5004394	1
30	VNB5004494	1
31	VNB5004994	1
32	VNB5006002	1
33	VNB5006102	1
34	VNB5036902	2

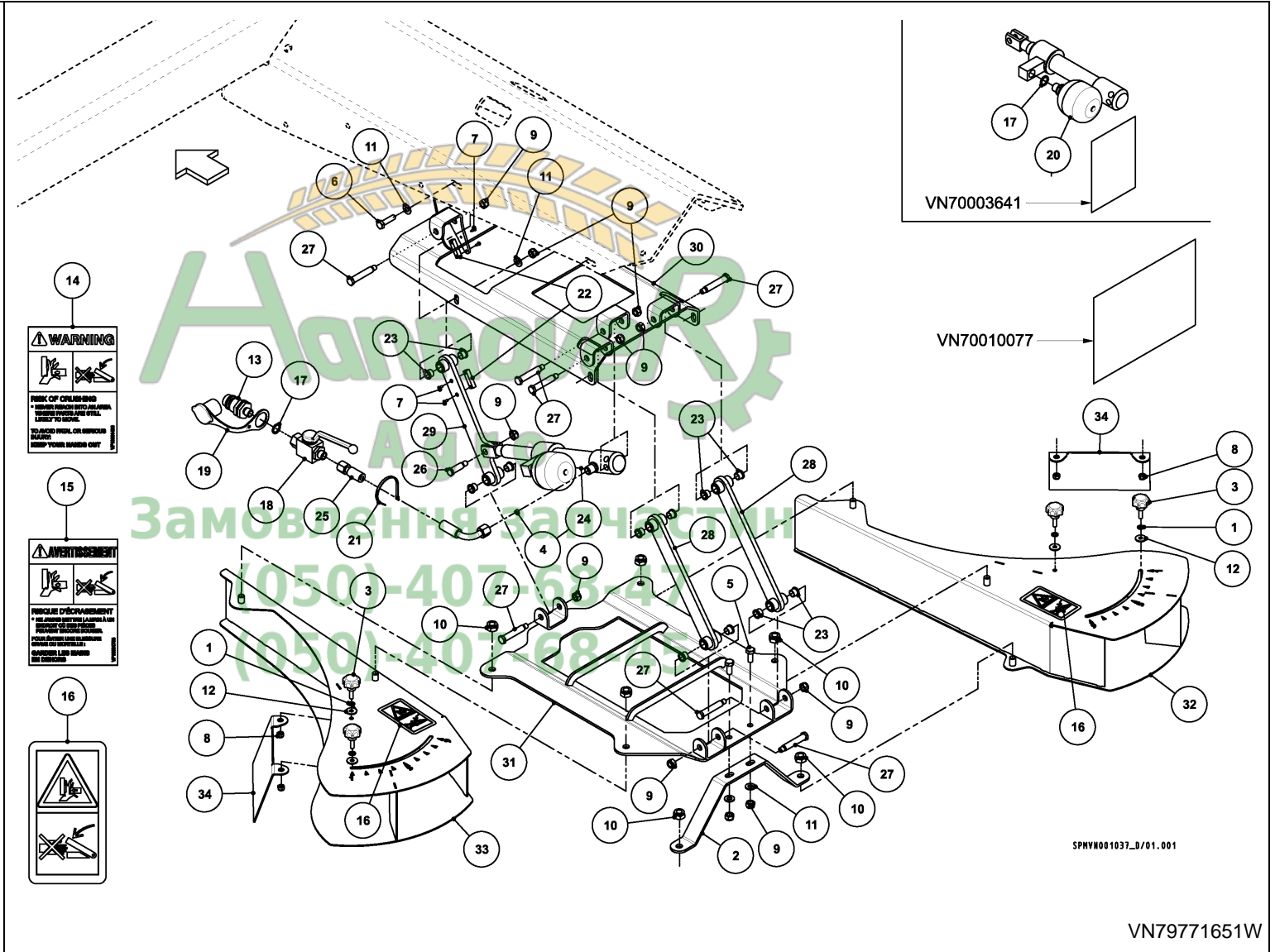

RO-XXL GEO / TRIMFLOW RIGHT



PosNo. Part No. Qty.

1	A138135402	1
2	A138243002	1
3	A138244894	1
4	A138244994	1
5	A138245094	1
6	A138345594	1
7	A138346602	1
8	A138346778	1
9	KG00402500	3
10	KG00402800	1
11	KG00498700	2
12	KG00498900	1
13	KG00746800	4
14	KG00868600	2
15	KG01069700	2
16	KG01069900	1
17	KG01070000	5
18	KG01070300	4
19	KG01264300	4
20	KG01901500	5
21	RG00048610	1
22	VF16661496	1
23	VF16661768	1
24	VGTR2059	1
25	VN17856588	2
26	VN30117100	2
27	VN31419900	2
28	VN38241605	1
29	VN38854581	1
30	VN79771437	1
31	VN80504003	5
32	VNB0450173	1
33	VNB3281778	8
34	VNB4192002	1
35	VNB4194694	1
36	VNB4297478	1
37	VNB4743378	1
38	VNB4769578	8
39	VNB4808802	1
40	VNB5038078	1

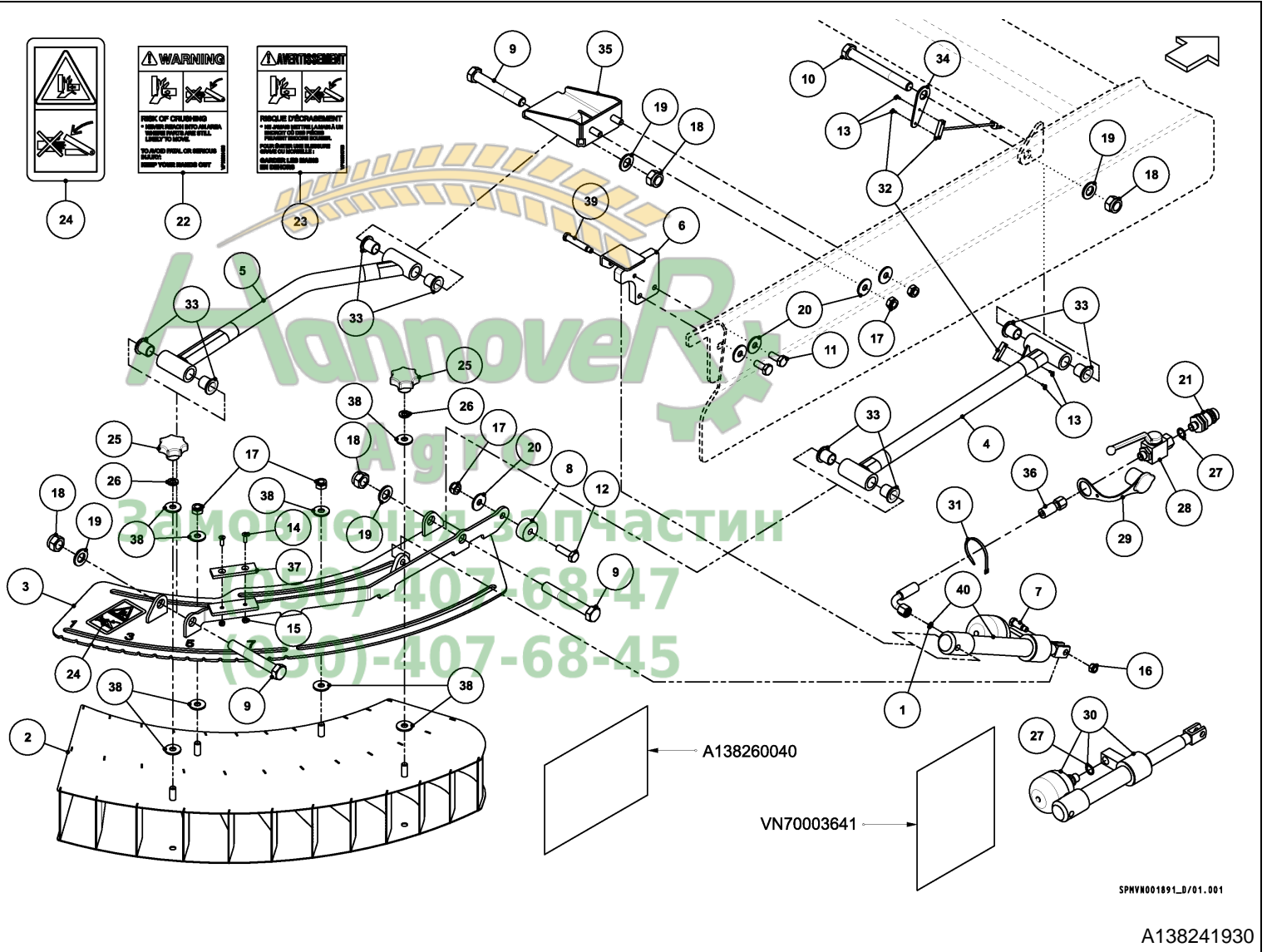

RO-XXL GEO / ELECTRONICS



PosNo.	Part No.	Qty.
1	KG00561500	2
2	KG00562500	3
3	KG01069600	2
4	KG01069700	3
5	MT00002819	1
6	VNB5055402	1

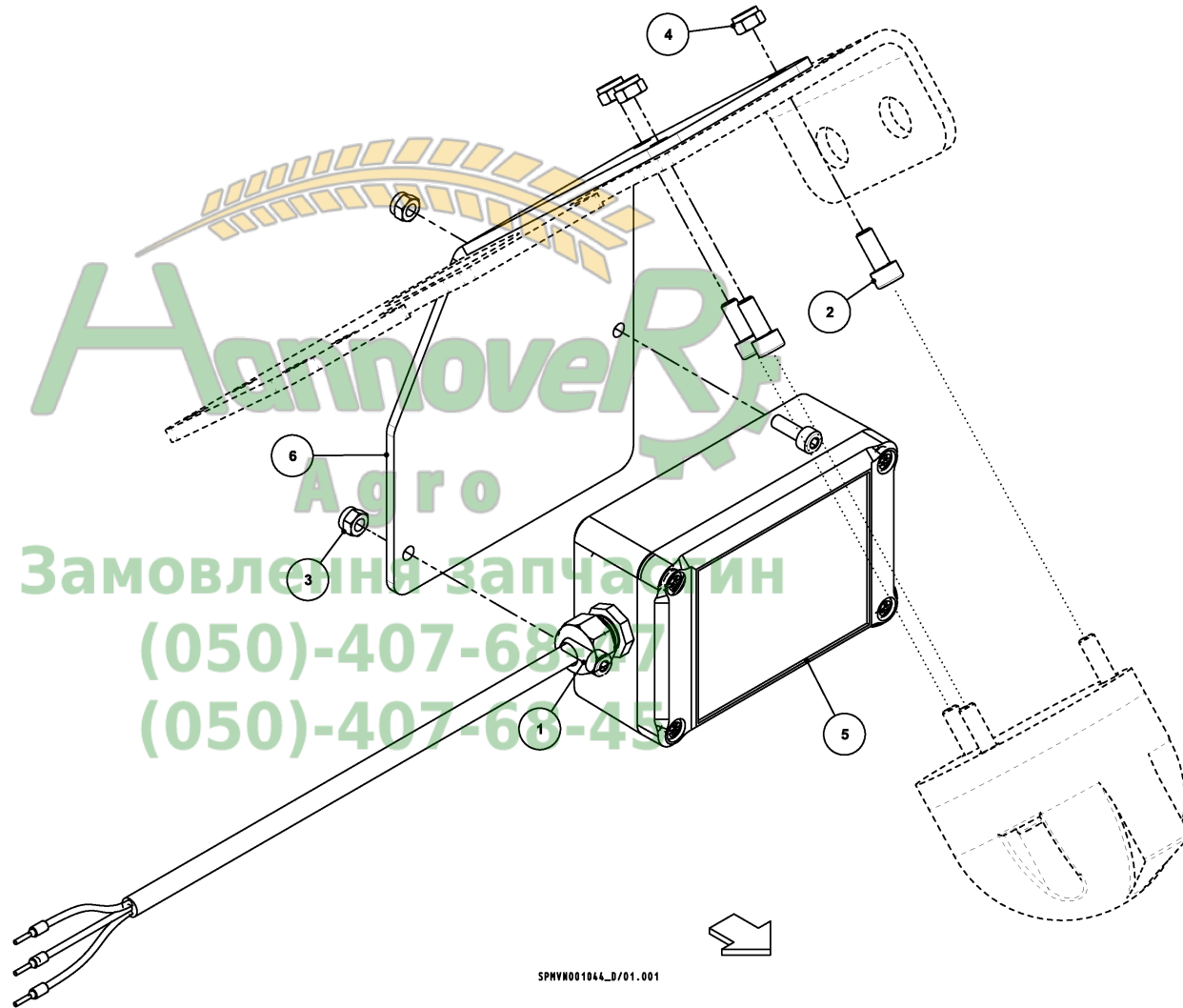

MT00002817

RO-XXL GEO / FEELER GAUGE



PosNo.	Part No.	Qty.
1	VNB1709302	1
2	VNB1754278	1



SPHYN001042_0/01.001
VN79770216/01.001

VN79770216-01

RO-XXL GEO / SPREADING PATTERN CONTROLSET



PosNo.	Part No.	Qty.
1	AC353924	1
2	VN79771219	1
3	VN79771400	1
4	VNB3405278	1

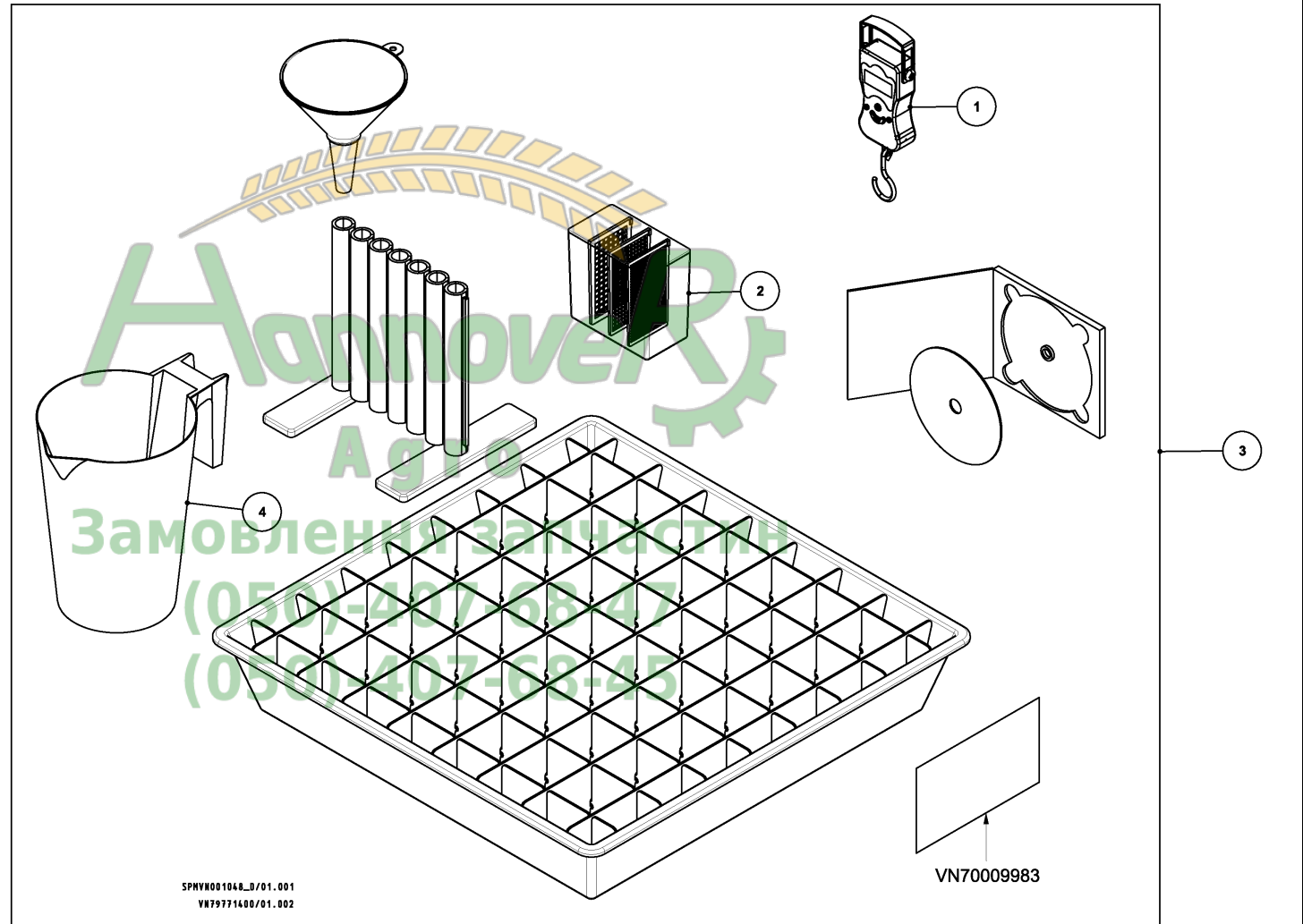

VN79771400-02

RO-XXL GEO / GPS SPEED SENSOR



PosNo.	Part No.	Qty.
1	VN79895978	1
2	VNB0305973	1



SPHV000983_D/01.001

VN79895978-VNB0305973

RO-XXL GEO / Part No Index



Part No.	Page	Pos No	Part No.	Page	Pos No	Part No.	Page	Pos No	Part No.	Page	Pos No
A100004700	26	1	A138218102	8	6	KG00495100	21	2	KG00738100	18	5
A100005600	11	1	A138218202	8	7	KG00496800	12	6	KG00738100	20	1
A100022900	3	1	A138222330	9	1	KG00496900	26	5	KG00738100	22	4
A136026300	12	1	A138243002	27	2	KG00497100	4	3	KG00738300	22	5
A136074900	12	2	A138244894	27	3	KG00497100	24	1	KG00739400	6	6
A136081400	12	3	A138244994	27	4	KG00497200	18	1	KG00739600	7	3
A136081500	12	4	A138245094	27	5	KG00497200	26	6	KG00739600	18	6
A136081700	12	5	A138263478	6	1	KG00497600	11	4	KG00739600	19	2
A138059394	26	2	A138263502	6	2	KG00497600	18	2	KG00742063	13	1
A138076102	21	1	A138270878	6	3	KG00498700	4	4	KG00746800	26	7
A138113078	26	3	A138271078	6	4	KG00498700	9	2	KG00746800	27	13
A138135402	26	4	A138345594	27	6	KG00498700	27	11	KG00747600	8	11
A138135402	27	1	A138346602	27	7	KG00498800	10	8	KG00868600	24	3
A138159830	25	1	A138346778	27	8	KG00498900	27	12	KG00868600	27	14
A138186478	4	1	A138367202	22	1	KG00499500	8	8	KG00870000	4	6
A138186502	4	2	A138367302	22	2	KG00501000	1	1	KG00870000	9	3
A138193402	10	1	A138370002	10	7	KG00501000	2	4	KG00870200	8	12
A138193802	10	2	A138371674	14	1	KG00501200	1	2	KG00870200	24	4
A138194202	10	3	A138371674	16	1	KG00561500	28	1	KG00871700	21	3
A138195302	10	4	A138379202	23	1	KG00562400	8	9	KG00945900	9	4
A138195602	8	1	A138379402	23	2	KG00562500	28	2	KG01044900	8	13
A138196602	10	5	A138379602	23	3	KG00562600	6	5	KG01053500	12	7
A138196802	3	2	A138379802	23	4	KG00563000	5	1	KG01053500	18	7
A138197002	3	3	A138380002	23	5	KG00565700	10	9	KG01053700	18	8
A138197102	3	4	A138380202	23	6	KG00652900	18	3	KG01053800	8	14
A138198202	11	2	A138460602	3	5	KG00652900	19	1	KG01059600	2	5
A138199002	2	1	AC353924	30	1	KG00654300	3	6	KG01059600	5	2
A138199102	2	2	KG00399400	7	1	KG00654300	25	2	KG01059600	6	7
A138205502	10	6	KG00399800	7	2	KG00654400	24	2	KG01059700	3	7
A138216098	8	2	KG00402500	27	9	KG00679900	22	3	KG01069600	18	9
A138216198	8	3	KG00402800	27	10	KG00712400	18	4	KG01069600	28	3
A138217502	8	4	KG00433200	11	3	KG00738100	4	5	KG01069700	5	3
A138217602	8	5	KG00494900	2	3	KG00738100	8	10	KG01069700	6	8

RO-XXL GEO / Part No Index



Part No.	Page	Pos No	Part No.	Page	Pos No	Part No.	Page	Pos No	Part No.	Page	Pos No
KG01069700	24	5	KG01070100	7	5	KG02000200	13	5	VF16661496	18	16
KG01069700	27	15	KG01070300	27	18	KG02000300	13	6	VF16661496	26	14
KG01069700	28	4	KG01107862	8	16	KG02000400	13	7	VF16661496	27	22
KG01069800	4	7	KG01192062	13	2	KG02000500	13	8	VF16661498	16	7
KG01069800	8	15	KG01263600	18	11	KG02000600	13	9	VF16661500	16	8
KG01069800	9	5	KG01263600	22	7	KG02000700	13	10	VF16661510	16	9
KG01069800	20	2	KG01263900	6	10	KG02000800	13	11	VF16661512	16	10
KG01069800	21	4	KG01263900	7	6	KG02000900	13	12	VF16661574	16	11
KG01069800	22	6	KG01263900	18	12	KG02001000	13	13	VF16661768	18	17
KG01069800	24	6	KG01263900	19	4	KG02001100	13	14	VF16661768	26	15
KG01069800	26	8	KG01263900	26	11	KG02001200	13	15	VF16661768	27	23
KG01069900	2	6	KG01264000	4	10	KG02001300	13	16	VF16661794	13	22
KG01069900	4	8	KG01264000	22	8	KG02001400	13	17	VF16661795	13	23
KG01069900	6	9	KG01264100	2	8	KG02001500	13	18	VGTR1029	13	24
KG01069900	7	4	KG01264100	7	7	KG02001600	13	19	VGTR2039	16	12
KG01069900	9	6	KG01264300	27	19	KT56968000	13	20	VGTR2059	18	18
KG01069900	10	10	KG01283000	8	17	KT56969000	13	21	VGTR2059	26	16
KG01069900	11	5	KG01283300	10	11	MT00001356	11	6	VGTR2059	27	24
KG01069900	12	8	KG01421400	8	18	MT00001663	12	9	VN17856588	27	25
KG01069900	18	10	KG01901300	22	9	MT00001688	12	10	VN30105200	10	12
KG01069900	19	3	KG01901300	26	12	MT00002021	12	11	VN30105200	23	7
KG01069900	21	5	KG01901400	2	9	MT00002274	12	12	VN30105400	22	10
KG01069900	24	7	KG01901400	4	11	MT00002819	28	5	VN30117100	8	19
KG01069900	25	3	KG01901400	18	13	RG00040217	18	15	VN30117100	27	26
KG01069900	26	9	KG01901400	19	5	RG00048610	26	13	VN30117600	12	13
KG01069900	27	16	KG01901400	24	8	RG00048610	27	21	VN30128812	21	6
KG01070000	4	9	KG01901500	4	12	RG00050664	7	8	VN30128821	2	10
KG01070000	9	7	KG01901500	9	8	RG00050664	25	5	VN30128821	3	8
KG01070000	25	4	KG01901500	18	14	VF16649537	16	2	VN30130800	9	9
KG01070000	26	10	KG01901500	27	20	VF16649538	16	3	VN30130800	10	13
KG01070000	27	17	KG01901600	1	4	VF16649632	16	4	VN30143310	2	11
KG01070100	1	3	KG02000000	13	3	VF16661493	16	5	VN30143310	4	13
KG01070100	2	7	KG02000100	13	4	VF16661496	16	6	VN31419900	26	17

RO-XXL GEO / Part No Index



Part No.	Page	Pos No	Part No.	Page	Pos No	Part No.	Page	Pos No	Part No.	Page	Pos No
VN31419900	27	27	VNB0566173	9	11	VNB3388365	10	16	VNB4061978	8	32
VN36107317	9	10	VNB0578473	12	19	VNB3405278	30	4	VNB4063078	9	14
VN36112005	8	20	VNB0682965	7	9	VNB3443478	18	20	VNB4063178	9	15
VN36112032	10	14	VNB0682965	25	6	VNB3444974	14	5	VNB4064878	7	16
VN37601011	1	5	VNB0765193	1	7	VNB3444974	16	16	VNB4064978	7	17
VN38241605	26	18	VNB0870178	1	8	VNB3447178	18	21	VNB4070073	11	9
VN38241605	27	28	VNB0897393	1	9	VNB3550678	7	12	VNB4073178	8	33
VN38854581	26	19	VNB1063478	20	3	VNB3559902	8	22	VNB4077378	8	34
VN38854581	27	29	VNB1599786	1	10	VNB3588378	7	13	VNB4190502	11	10
VN46120101	1	6	VNB1599986	1	11	VNB3588478	7	14	VNB4190602	11	11
VN48101007	5	4	VNB1709302	29	1	VNB3602698	19	6	VNB4190702	11	12
VN79771219	10	15	VNB1754278	29	2	VNB3602798	19	7	VNB4192002	27	34
VN79771219	30	2	VNB1847378	20	4	VNB3603198	19	8	VNB4194694	27	35
VN79771400	30	3	VNB2068778	4	14	VNB3603398	18	22	VNB4218178	17	4
VN79771437	26	20	VNB2071674	14	2	VNB3603598	18	23	VNB4225402	8	35
VN79771437	27	30	VNB2071674	16	13	VNB3708098	18	24	VNB4256202	12	20
VN79895978	31	1	VNB2092402	18	19	VNB3717802	10	17	VNB4270602	4	16
VN80504001	5	5	VNB2235978	9	12	VNB3910902	7	15	VNB4277786	4	17
VN80504001	6	11	VNB2235978	26	23	VNB3958278	8	23	VNB4277994	4	18
VN80504001	11	7	VNB2332686	1	12	VNB3970002	8	24	VNB4278094	4	19
VN80504001	12	14	VNB2336686	11	8	VNB3984186	17	1	VNB4281294	3	9
VN80504003	5	6	VNB2417578	7	10	VNB4008178	26	24	VNB4281502	2	13
VN80504003	6	12	VNB2417602	7	11	VNB4014778	17	2	VNB4281802	11	13
VN80504003	12	15	VNB2426674	2	12	VNB4023502	8	25	VNB4281902	11	14
VN80504003	26	21	VNB2426674	14	3	VNB4042498	8	26	VNB4292878	21	7
VN80504003	27	31	VNB2426674	16	14	VNB4042598	8	27	VNB4297478	26	25
VNB0253473	12	16	VNB2760978	4	15	VNB4042702	8	28	VNB4297478	27	36
VNB0305973	31	2	VNB2822600	14	4	VNB4053074	14	6	VNB4306798	18	25
VNB0341273	5	7	VNB2822600	16	15	VNB4053074	16	17	VNB4306898	18	26
VNB0450173	26	22	VNB3281778	27	33	VNB4053474	17	3	VNB4306998	18	27
VNB0450173	27	32	VNB3317278	8	21	VNB4059402	8	29	VNB4309102	18	28
VNB0489473	12	17	VNB3317378	9	13	VNB4060978	8	30	VNB4319078	4	20
VNB0563673	12	18	VNB3358786	1	13	VNB4061702	8	31	VNB4334578	22	11



RO-XXL GEO / Part No Index

Part No.	Page	Pos No	Part No.	Page	Pos No	Part No.	Page	Pos No
VNB4341978	7	18	VNB4493474	14	13	VNB5004194	26	28
VNB4344486	2	14	VNB4493474	16	19	VNB5004394	26	29
VNB4347965	7	19	VNB4627794	4	22	VNB5004494	26	30
VNB4348165	7	20	VNB4668565	7	25	VNB5004994	26	31
VNB4348365	7	21	VNB4675502	17	5	VNB5006002	26	32
VNB4348493	7	22	VNB4675702	17	6	VNB5006102	26	33
VNB4363594	4	21	VNB4708802	2	15	VNB5007578	5	8
VNB4366374	14	7	VNB4713902	9	16	VNB5007578	6	13
VNB4366374	16	18	VNB4743378	24	17	VNB5010086	25	7
VNB4373498	18	29	VNB4743378	27	37	VNB5014002	25	8
VNB4373498	19	9	VNB4769578	27	38	VNB5014502	25	9
VNB4376974	14	8	VNB4780478	2	16	VNB5015098	21	11
VNB4377074	14	9	VNB4790102	9	17	VNB5030178	5	9
VNB4377174	14	10	VNB4790202	9	18	VNB5036902	26	34
VNB4377474	14	11	VNB4790302	9	19	VNB5038078	27	40
VNB4377474	15	1	VNB4790402	9	20	VNB5049874	14	16
VNB4377574	14	12	VNB4800374	14	14	VNB5049874	16	22
VNB4377574	15	2	VNB4800374	16	20	VNB5055402	28	6
VNB4408202	22	12	VNB4808502	9	21			
VNB4408302	22	13	VNB4808502	26	26			
VNB4442278	24	9	VNB4808802	26	27			
VNB4450578	24	10	VNB4808802	27	39			
VNB4451002	22	14	VNB4916674	10	18			
VNB4451198	24	11	VNB4916674	14	15			
VNB4451298	24	12	VNB4916674	16	21			
VNB4451398	24	13	VNB4916674	23	8			
VNB4451498	24	14	VNB4945378	2	17			
VNB4451978	24	15	VNB4975278	22	15			
VNB4466478	7	23	VNB4995086	1	14			
VNB4466678	7	24	VNB4998302	21	8			
VNB4473502	24	16	VNB4998778	18	31			
VNB4487278	18	30	VNB5001602	21	9			
VNB4487278	19	10	VNB5001778	21	10			

AANHAALMOMENTEN / TORQUES / ANZUGSMOMENTE / COUPLES DE SERRAGE / PARES DE APRIETE / BINÁRIOS DE APERTO / MOMENTI DI TORSIONE / MEGHÚZÁSI NYOMATÉKOK

NL Richtlijnen voor aanhaalmomenten in **Nm (ft.lb)** voor zelfborgende moeren, zeskantbouten en moeren.
DE Richtlinien für Anzugsmomente in **Nm (ft.lb)** für selbstsichernde Muttern, Sechskantschrauben und -mutter.
ES Directrices para los pares de apriete en **Nm (ft.lb)** para las tuercas autoblocantes, los tornillos hexagonales y las tuercas.
IT Direttive per momenti di torsione espressi in **Nm (ft.lb)** per dadi autobloccanti, bulloni esagonali e dadi.

EN Guidelines for torques in **Nm (ft.lb)** for self-locking nuts, hexagon bolts and nuts.
FR Directives pour les couples de serrage en **Nm (ft.lb)** pour écrous à autobloquants, boulons à six pans et écrous.
PT Directrizes para os binários de aperto em **Nm (ft.lb)** para porcas autobloqueadoras, parafusos hexagonais e porcas.
HU Előírt meghúzási nyomatékok **Nm-ben (ft.lb)** az önzáró anyákhoz, hatlapfejű csavarokhoz és anyákhoz

Kwaliteit / Quality / Qualität / Qualité / Calidad / Qualidade / Qualità / Minőség	4.6				8.8				10.9				12.9			
	0,10		0,13		0,10		0,13		0,10		0,13		0,10		0,13	
Wrijving / Friction / Reibung / Fricción / Atrito / Attrito / Súrlódás *	0,10		0,13		0,10		0,13		0,10		0,13		0,10		0,13	
Schroefdraad / Thread / Gewinde / Filetage Rosca / Filettatura / Menet	Nm	ft.lb	Nm	ft.lb	Nm	ft.lb	Nm	ft.lb	Nm	ft.lb	Nm	ft.lb	Nm	ft.lb	Nm	ft.lb
M5	1,7	1,3	2	1,5	5	4	6	4	7	5	9	6	8	7	10	7
M6	3	2	4	3	9	7	10	7	13	10	15	11	15	11	18	13
M8	8	6	9	7	21	15	25	18	31	23	36	27	36	27	42	31
M10	16	12	19	14	40	30	50	37	60	44	70	52	70	52	85	63
M12	27	20	32	24	70	52	85	63	105	77	120	89	120	89	145	107
M14	42	31	50	37	115	85	135	100	165	122	195	144	195	144	230	170
M16	65	48	76	56	175	129	210	155	260	192	300	221	300	221	350	258
M18	90	66	110	81	250	185	290	214	350	258	420	310	410	303	490	362
M20	125	92	150	111	350	258	420	310	500	369	600	443	580	428	700	517
M22	170	125	200	148	470	347	560	413	670	494	800	590	780	576	930	686
M24	210	155	250	185	600	443	710	524	860	635	1020	753	1000	738	1180	871

- * **NL** De wrijvingscoëfficiënt van 0,10 geldt voor geoliede plaat, gietijzer, geharde vlakken, vette schroefdraad, etc. De hogere waarde van 0,13 geldt voor een droge plaat. Uitzonderingen op deze tabel zijn vermeld in het onderdelen- en/of instructieboek. Aanhaalmomenten voor bouten en moeren met gekartelde onderkant, zoals Tensilock en Whizlock, 10% extra.
- * **EN** The friction coefficient of 0.10 applies to oiled sheet, cast iron, hardened surfaces, greasy thread, etc. The higher value of 0.13 applies to dry sheet. Exceptions to this table are stated in the parts- and /or instruction manual. Torques for bolts and nuts with a knurled underside, like Tensilock and Whizlock, 10% extra.
- * **DE** Der Reibungskoeffizient von 0,10 gilt für geölte Flächen, Gusseisen, gehärtete Flächen, gefettetes Gewinde usw. Der höhere Wert von 0,13 gilt für trockene Flächen. Ausnahmen zu dieser Tabelle sind im Ersatzteilheft und/oder in der Betriebsanleitung. Anzugsmomente für Schrauben und Muttern mit gerändelter Unterseite, wie Tensilock und Whizlock, zuzüglich 10% extra.
- * **FR** Le coefficient de frottement de 0,10 s'applique aux surfaces huilées, à la fonte, aux surfaces trempées, aux filetages graissés etc. Le coefficient de 0,13 aux surfaces sèches. Les exceptions à se tableau sont mentionnées dans la nomenclature des pièces et/ou dans le manuel d'emploi. Ajoutez 10% pour les boulons et écrous à partie inférieure crénelée, comme les Tensilock et les Whizlock.
- * **ES** El coeficiente de fricción de 0,10 es indicado para planchas lubricadas, hierro fundido, superficies endurecidas, rosca grasienta, etc. El valor más alto de 0,13 es para planchas secas. Las excepciones a este cuadro se mencionan en el libro de repuestos y/o manual de instrucciones. Los pares de apriete para tornillos y tuercas con cara inferior dentada, como los Tensilock y Whizlock, 10% extra.
- * **PT** O coeficiente de atrito de 0.10 aplica-se às superfícies olcadas, ao ferro fundado, às superfícies temperadas, às roscas emassadas etc. O coeficiente de 0.13 às superfícies secas. As exceções a este quadro estão mencionadas na nomenclatura das peças e/ou no manual de instruções. Os binarios de aperto para porcas e parafusos cujas bases sejam serradas (Tensilock, Whizlock) devem ser aumentados em 10%.
- * **IT** Il coefficiente di frizione pari a 0,10 si riferisce a superfici oliate, alla ghisa, a superfici temprate, a filettature spesse ecc. Il valore più alto, npari a 0,13, si riferisce a superfici asciutte. Tutte le eccezioni a quanto riportato in questa tabella, si trovano nel libretto dei pezzi o nel libretto delle istruzioni. I momenti torcenti per bulloni e dadi la cui parte inferiore è zigrinata, come i Tensilock (K 100) e Whizlock, sono superiori del 10%.
- * **HU** A 0,10 súrlódási tényező az olajozott lemezekre, öntöttvasra, edzett felületekre, zsírozott menetre, stb alkalmazható. A 0,13 asmagasabb érték a száraz lemezekre alkalmazható. E táblázat alól kivételt képező tételek az alkatrészeknél és/vagy a gépkönyvekben vannak felsorolva. A meghúzási nyomaték az alsó peremen bordázott csavarok és anyák esetében 10%-kal nagyobb, pl. Tensilock (K100) és Whizlock.

TILSTRAMMINGSMOMENTER / TILSPÆNDINGSMOMENTER/ VRIDMOMENT / VÄÄNTÖMOMENTIT / MOMENTY OBROTOWE / UTAHOVACÍ MOMENTY / PRIVIJALNI MOMENTI / MOMENTE DE TORSIUNE

DA Retningslinier for tilspændingsmomenter i **Nm (ft.lb)** for selvåsende møtrikker, sekskantbolte og møtrikker.

SV Anvisningar för vridmoment i **Nm (ft.lb)** för självåsende muttrar, sexkantiga bultar och muttrar.

PL Wytyczne dotyczące momentów obrotowych w **Nm (ft.lb)** nakrętek samozabezpieczających, śrub z łbem sześciokątnym i nakrętek.

SL Navodila za privijalne (navorne) momente v **Nm (ft.lb)** za matice in vijake.

NO Retningslinjer for tilstrammingsmomenter i **Nm (ft.lb)** for selvåsende muttere, sekskantbolter og muttere.

FI Väätömomentteja koskevat ohjeet **Nm (ft.lb)** itsevarmistaville muttereille, kuusioruuveille ja -muttereille.

CS Směrnice pro utahovací momenty v **Nm (ft.lb)** pro samosvorné matice, šrouby a matice s šestihran hlavou

RO Prevederi privind momentele de torsiune **Nm (ft.lb)** pentru piulițele cu autoblocare, șuruburile și piulițele hexagonale.

Kvalitet / Laatu / Jakość / Jakost / Kvaliteta / Calitate	4.6				8.8				10.9				12.9			
	0,10		0,13		0,10		0,13		0,10		0,13		0,10		0,13	
Friktion / Friksjon / Kitka / Tarcie / Třeni / Trenje / Frezare *	0,10		0,13		0,10		0,13		0,10		0,13		0,10		0,13	
Gevind / Skruegjenge / Gänga / Kierre / Gwint / Závít / Navoj / Filet	Nm	ft.lb	Nm	ft.lb	Nm	ft.lb	Nm	ft.lb	Nm	ft.lb	Nm	ft.lb	Nm	ft.lb	Nm	ft.lb
M5	1,7	1,3	2	1,5	5	4	6	4	7	5	9	6	8	7	10	7
M6	3	2	4	3	9	7	10	7	13	10	15	11	15	11	18	13
M8	8	6	9	7	21	15	25	18	31	23	36	27	36	27	42	31
M10	16	12	19	14	40	30	50	37	60	44	70	52	70	52	85	63
M12	27	20	32	24	70	52	85	63	105	77	120	89	120	89	145	107
M14	42	31	50	37	115	85	135	100	165	122	195	144	195	144	230	170
M16	65	48	76	56	175	129	210	155	260	192	300	221	300	221	350	258
M18	90	66	110	81	250	185	290	214	350	258	420	310	410	303	490	362
M20	125	92	150	111	350	258	420	310	500	369	600	443	580	428	700	517
M22	170	125	200	148	470	347	560	413	670	494	800	590	780	576	930	686
M24	210	155	250	185	600	443	710	524	860	635	1020	753	1000	738	1180	871

* **DA** Friktionskoefficienten på 0,10 gælder for smurte flader, støbejern, hærdede overflader, fedtholdige gevind etc. Den højere værdi på 0,13 gælder for tørre flader. Undtagelser til tabellen er angivet i reservedels- og/eller instruktionsbog. Når det drejer sig om momenter for bolte og møtrikker med en riflet underside, som Tensilock (K100) og Whizlock, skal der tilføjes 10% ekstra.

* **NO** Friksjonskoeffisienten på 0,10 gjelder for smurt plate, støpejern, herdete flater, innfettete gjenger etc. Den høyere verdien på 0,13 gjelder for tørr plate. Unntak fra denne tabellen er angitt i deleboken og/eller i instruksjonsboken. Tiltrekkingsmomenter for skruer og mutre med riflet underkant, som Tensilock (K100) og Whizlock 10% tillegg.

* **SV** Friktionskoefficienten 0,10 gäller oljad plåt, gjutjärn, härdade ytor, smorda gängor etc. Det högre värdet 0,13 gäller torr plåt. Undantag från denna tabell anges i reservedels- och/eller instruktionsboken. Åtdragningsmoment för räfflade bultar och muttar, som Tensilock och Whizlock 10% extra.

* **FI** Kitkakerroin 0,10 koskee öljytyjä pintoja, valurautaa, karkaistuja pintoja, rasvattuja kierteitä jne. Korkeampi arvo 0,13 koskee kuivia pintoja. Poikkeukset tästä taulukosta löytyvät varaosaletisistä ja/tai käyttöohjeista. Ruuvien ja muttereiden, joissa on pyälletty alapuoli, kuten Tensilock ja Whizlock, väätömomentteihin lisätään 10 %.

* **PL** Współczynnik tarcia 0,10 dotyczy płyty oliwonej, żeliwa, powierzchni hartowanych, nasmarowanych gwintów, itp. Wyższy współczynnik 0,13 dotyczy płyty suchej. Wyjątki od niniejszej tabeli podano w katalogu części i/lub instrukcji. Momenty obrotowe zwiększają się o dodatkowe 10% w przypadku śrub i nakrętek z radełkowanym spodem, jak na przykład, Tensilock (K100) o Whizlock.

* **CS** Koeficient třeni 0.10 platí pro naolejovaný plech, litinu, kalené povrchy, namazaný závít a tak dále. Vyšší hodnota 0.13 platí pro suchý plech. Výjimky z této tabulky jsou uvedeny v seznamu náhradních dílů a/nebo v provozním návodu. Utahovací momenty pro šrouby a matice s rýhovanou spodní stranou 10% navíc, jako např. Tensilock (K100), Whizlock.

* **SL** Koeficient trenja 0,10 velja za naoljene površine, litino, kovane površine, namazane navoje itd. Višja vrednost 0,13 velja za suhe površine. Izjeme v tej tabeli so v zvezku rezervnih delov ali pa v navodilu o uporabi navedene. Navornim momentom za vijake in matice z naribano spodnjo površino, kot so Tensilock (K100) in Whizlock, dodamo 10%.

* **RO** Coeficientul de frecare de 0,10 este valabil în cazul suprafețelor lubrificate, fontei, suprafețelor întărite, filetelor lubrificate etc. Valoarea mai mare, de 0,13, este valabilă pentru suprafețe uscate. Excepțiile de la valorile descrise în acest tabel sunt menționate în manualul cu privire la componente sau în manualul de instrucțiuni. Momentele de torsiune pentru șuruburi și piulițe cu partea inferioară canelată, de exemplu Tensilock și Whizlock - 10% în plus.

МОМЕНТ ЗАТЯГИВАНИЯ / PÖÖRDEMOMENDID / SUKIMO MOMENTAI / PIEVILKŠANAS GRIEZES MOMENTA VĒRTĪBAS

RU Указания для моментов затягивая в **Nm (ft.lb)** для самоблокирующихся гаек, шестигранных болтов и гаек. **ET** Iselukustuvate mutrite, kuuskantpoltide ja mutrite soovituslikud pöördemomendid **Nm (ft.lb)**.

LT Nurodymai dėl savaimė fiksuojamų, šešiakampių varžtų ir veržlių sukimo momentų **Nm (ft.lb)**.

LV Vadlīnijas pašbloķējošu uzgriežņu, sešskaldņu skrūvju un uzgriežņu pievilksanas griezes momenta vērtībām **Nm (ft.lb)**.

Качество / Kvaliteet / Kokybė / Kvalitāte	4.6				8.8				10.9				12.9			
	0,10		0,13		0,10		0,13		0,10		0,13		0,10		0,13	
Трение / Hõõrdetegur / Trintis / Berze *																
Резьба / Keere / Sriegis / Vītne	Nm	ft.lb	Nm	ft.lb	Nm	ft.lb	Nm	ft.lb	Nm	ft.lb	Nm	ft.lb	Nm	ft.lb	Nm	ft.lb
M5	1,7	1,3	2	1,5	5	4	6	4	7	5	9	6	8	7	10	7
M6	3	2	4	3	9	7	10	7	13	10	15	11	15	11	18	13
M8	8	6	9	7	21	15	25	18	31	23	36	27	36	27	42	31
M10	16	12	19	14	40	30	50	37	60	44	70	52	70	52	85	63
M12	27	20	32	24	70	52	85	63	105	77	120	89	120	89	145	107
M14	42	31	50	37	115	85	135	100	165	122	195	144	195	144	230	170
M16	65	48	76	56	175	129	210	155	260	192	300	221	300	221	350	258
M18	90	66	110	81	250	185	290	214	350	258	420	310	410	303	490	362
M20	125	92	150	111	350	258	420	310	500	369	600	443	580	428	700	517
M22	170	125	200	148	470	347	560	413	670	494	800	590	780	576	930	686
M24	210	155	250	185	600	443	710	524	860	635	1020	753	1000	738	1180	871

* **RU** Коэффициент трения в 0,10 относится к смазанным плитам, чугуны, затвердевшим поверхностям резьбе с нанесенной смазкой и т.д. Более высокое значение в 0,13 относится к сухим плитам. Исключения для данной таблицы указаны в брошюре с описанием рабочих деталей и/или инструкции по эксплуатации. Моменты затягивания для болтов и гаек с зазубренной стороной выше на 10% для таких как, Tensilock (k 100) и Whizlock.

* **ET** Hõõrdetegur 0,10 kehtib õlitatud plaatide, valuraua, tugevdatud pindade, määrdega keermete jne kohta. Kõrgem väärtus 0,13 kehtib kuivadele plaatidele. Erinevused sellest tabelist on kirjas osade nimistus ja/või kasutusjuhendis. Rihveldatud alaosa poltide ja mutrite, näiteks Tensilock ja Whizlock, pöördemomendid on 10% suuremad.

* **LT** Trinties koeficientas 0,10 taikomas suteptiems lakštams, ketui, grūdintiems paviršiams, suteptiems sriegiams ir t.t. Didesnė vertė (0,13) taikoma sausai skardai. Šios lentelės išimty nurodytos dalių knygelėje ir (arba) instrukcijoje. Varžtų ir veržlių su sraigine įraiža (pvz., „Tensilock“ ir „Whizlock“) sukimo momentai didesni 10 %.

* **LV** Berzes koeficients 0,10 attiecas uz eļļotām plāksnēm, čugunu, rūdītām virsmām, eļļotām vītņēm utt. Augstāks koeficients 0,13 attiecas uz sausām plāksnēm. Atkāpes no tabulā norādītājām vērtībām ir norādītas rezerves daļu sarakstā un/vai rokasgrāmatā. Skrūvju un uzgriežņu ar rievotu apakšējo daļu pievilksanas griezes momenta vērtības jāpalielina par papildu 10 %.



Замовлення запчастин

(050)-407-68-47

(050)-407-68-45



RO-XXL GEO

01001 < Mach. ID <=

Kverneland Group Nieuw-Venep
Kverneland Group Nieuw-Venep BV
Hoofdweg 1278
2153 LR Nieuw-Venep
Netherlands
+31 252 662244
+31 252 662173



Замовлення запчастин

(050)-407-68-47

(050)-407-68-45

© Kverneland Group

All rights reserved. No parts of this book may be reproduced, stored in a database or retrieval system, or published in any form or in any way, electronically, mechanically, optically, by print, photo print, microfilm (including micro and macro fiche), or any other means, including all video and CD systems, without prior written permission from the publisher.

Print date: 2016-01-08

