

Аграрі
Agro
Замовлення запчастин
RO-XL
(050)-407-68-47
(050)-407-68-45

Spare Parts Manual

Article number:	VN70009951-3
Language:	EN
Production year (from):	2011
Prod. Series nr (from):	VN20703
01987 < Mach. ID <=	



Замовлення запчастин

(050)-407-68-47

(050)-407-68-45

RO-XL / Table of Contents



PosNo.	Assembly group	Page
1	FRAME	1
2	PROTECTION	2
2	PROTECTION	3
3	HOPPER AND SIEVE (1500 L)	4
3	HOPPER AND SIEVE (1875 L)	5
4	LIGHTING	6
5	DRIVE	7
6	DOSAGE	8
7	DISC, BROADCASTER	9
8	CONTROL, HYDRAULIC	10
9	COMFORT CONTROL	11
9	COMFORT CONTROL	12
12	UNIV. JOINT SHAFT	13
13	DECAL SCHEMATIC	14
13	DECAL SCHEMATIC	15
99	ACCESSORIES	16
99	HOPPER EXTENSION (1500 L)	17
99	HOPPER EXTENSION (1875 L)	18
99	TARPAULIN (1500 L)	19
99	TARPAULIN (1875 L)	20
99	HOPPER EMPTYING SET	21
99	SCOOP SET	22
99	LADDERSET	23
99	WHEELSET	24
99	CALIBRATION CONTAINER	25
99	BOUNDARY SPREADING PLATE	26
99	TRIMFLOW	27
99	FEELER GAUGE	28
99	SPREADING PATTERN CONTROLSET	29
99	HOSE SET	30
99	2X2 DIRECTION TAP SET	31
99	SPREADING DISC RPM SENSOR SET	32
99	WHEELRINGS	33
99	SENSORS AND CABLES	34
99	RADARCABLES	35

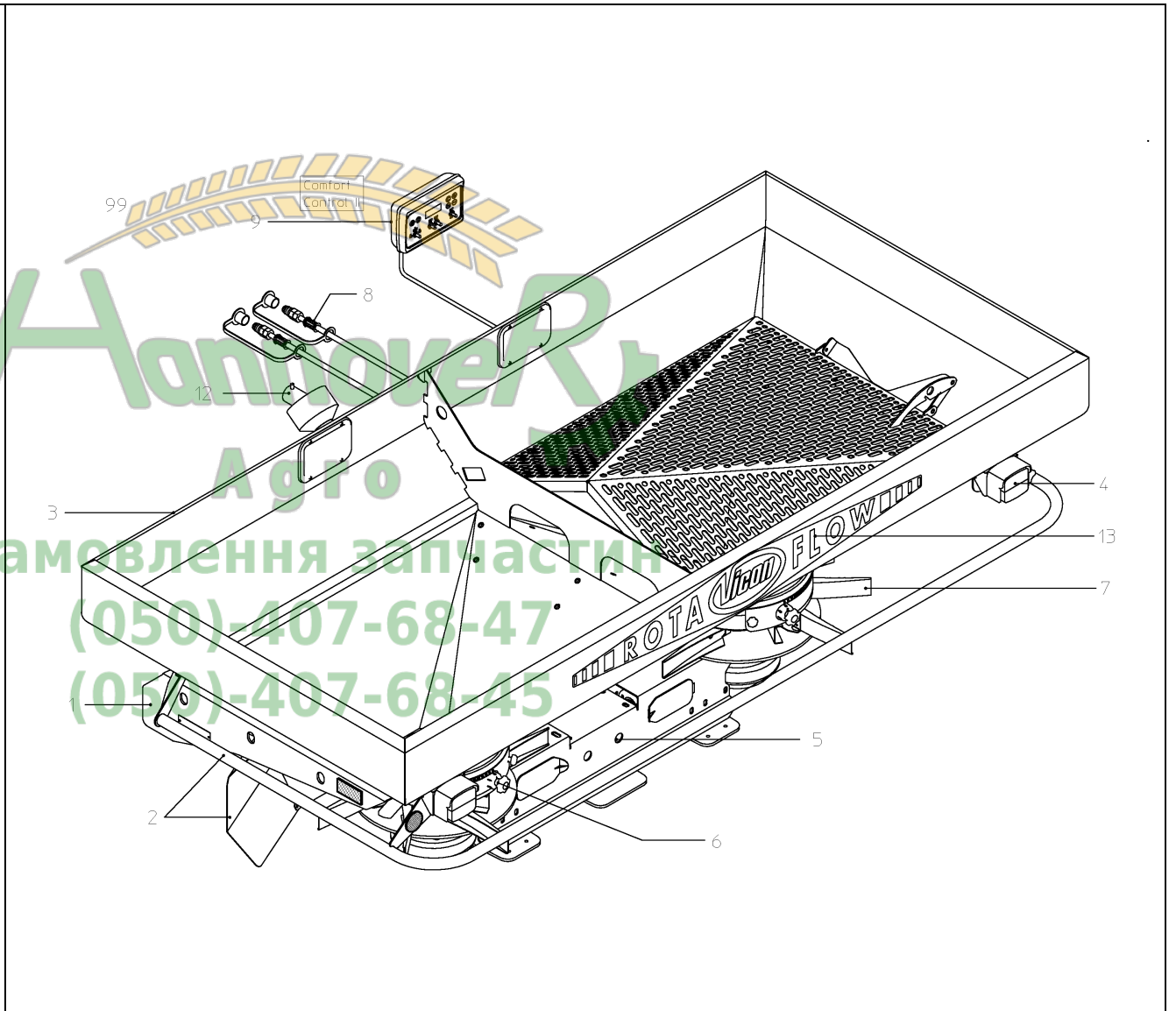

RO-XL / FRAME



PosNo.	Part No.	Qty.
1	VNB4277086	1
2	VNB1599794	1
3	VNB0897393	1
4	VNB0870178	1
5	VNB4077402	1
6	KG00500900	1
7	KG01070100	2
8	VNB2332694	1
9	KG01901600	2
10	KG00501100	1
11	VNB2003102	1
12	VNB1599994	2
13	VNB0765193	2
14	VN30128821	2
15	VN37601011	2
16	KG01069900	2
17	VNB2003294	1
18	VNB2003302	1
19	KG00495200	1
20	KG01901300	2
21	KG01069800	1

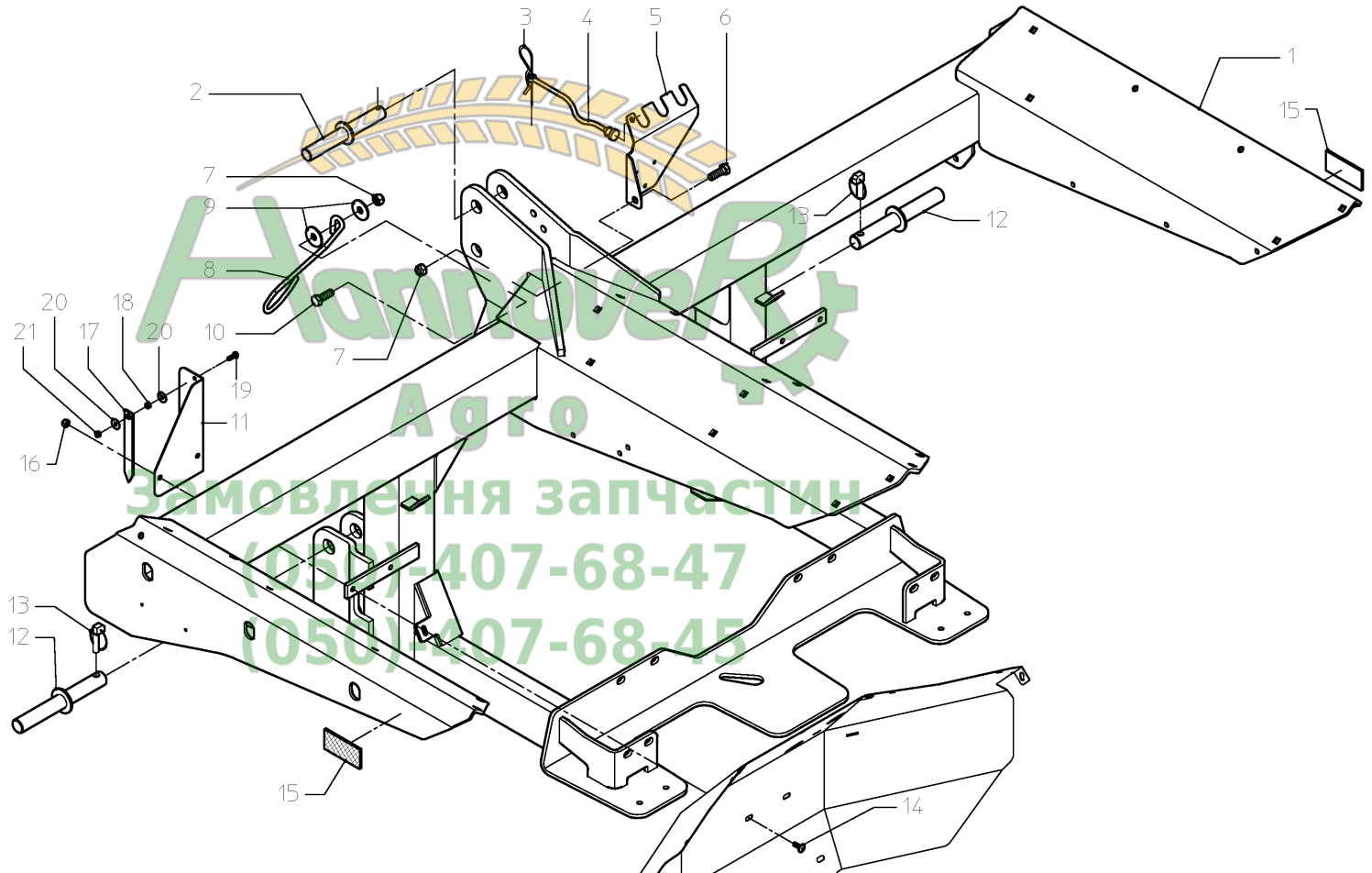

ROXL_VN20702_N01

RO-XL / PROTECTION



PosNo.	Part No.	Qty.
1	VNB4344486	1
2	VNB4253078	2
5	VN37601015	2
6	KG00501000	8
7	KG01070100	8
9	KG01264100	16
11	VNB4630594	1
14	KG00739400	4
15	KG01263900	4
17	KG00498700	2
18	KG01264000	2
19	KG01070000	2

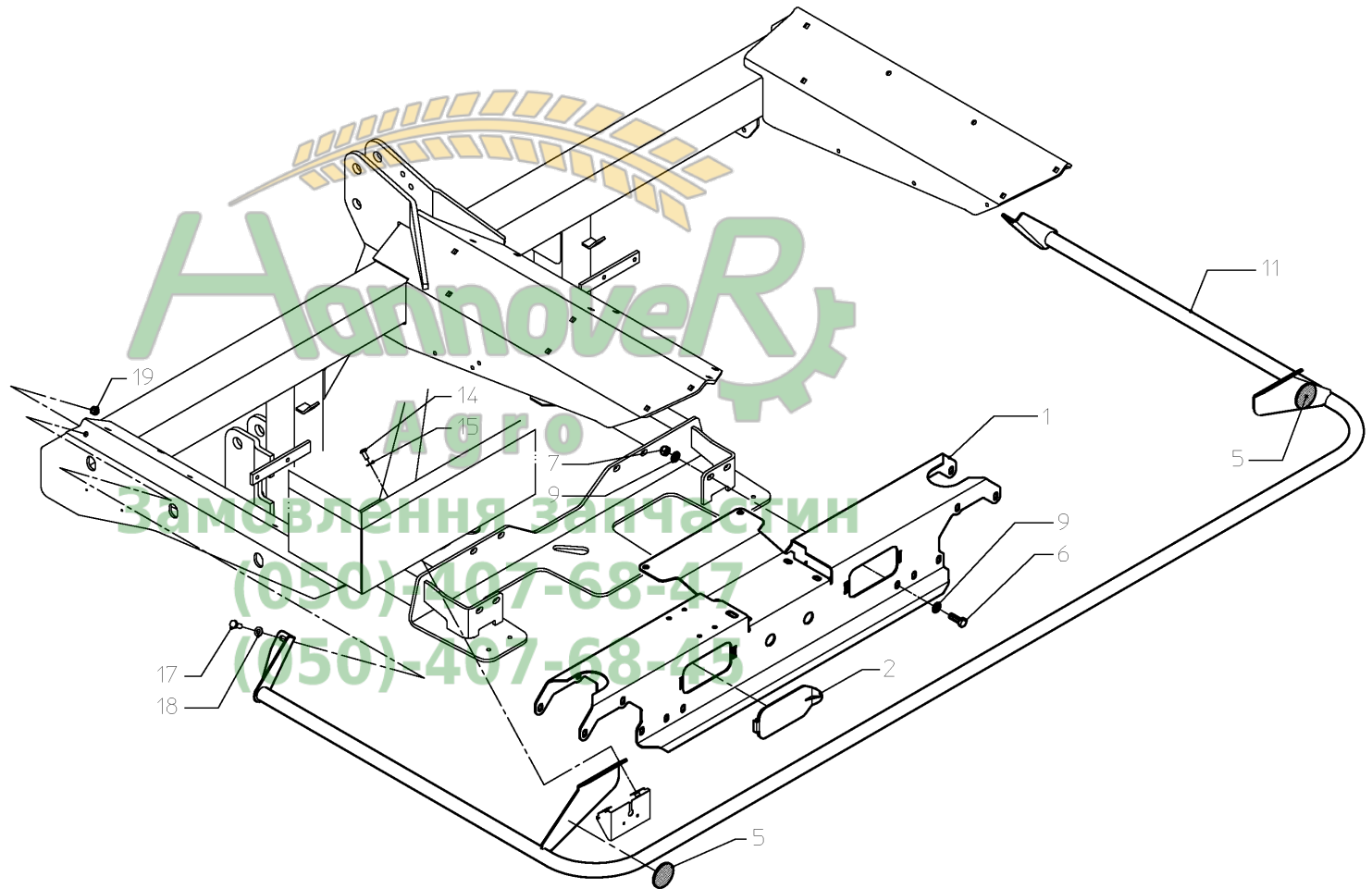

ROXL_VN20703_P02

RO-XL / PROTECTION



PosNo.	Part No.	Qty.
2	VN30128821	8
3	KG01901400	8
4	KG01069900	8
12	KG00494900	6
13	KG01059600	6
14	VNB4381202	1
15	VNB4381302	1
16	VNB4780478	2

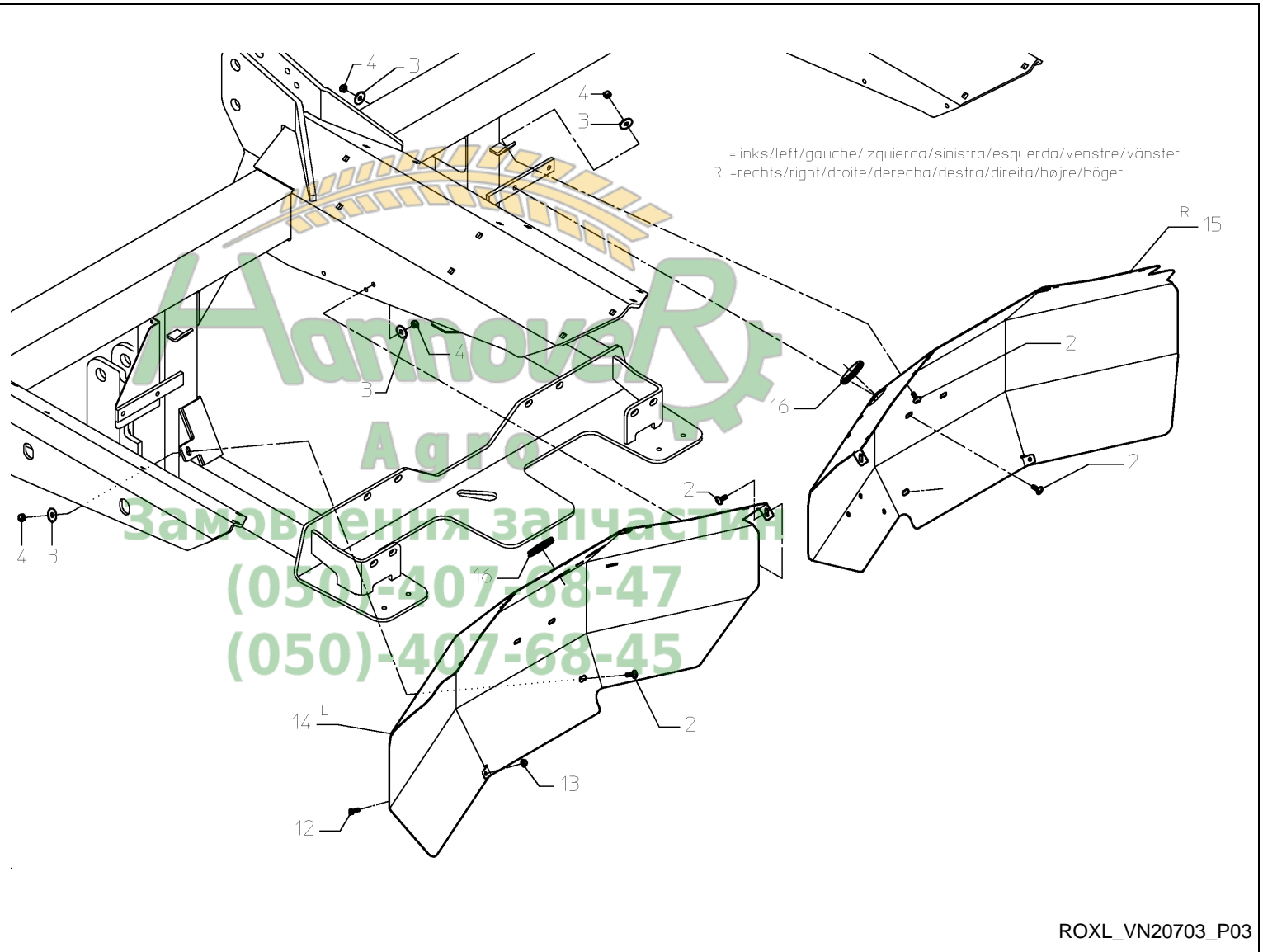

Агросервис
Замовлення запчастин
(050)-407-68-47
(050)-407-68-45

ROXL_VN20703_P03

RO-XL / HOPPER AND SIEVE (1500 L)



PosNo.	Part No.	Qty.
1	VNB4261394	1
2	VNB4277786	2
3	VNB4277994	1
4	VNB4278094	1
5	KG00498700	6
6	KG01264000	6
7	KG01070000	6
8	VN30117100	20
9	KG01053800	20
10	KG00654400	20
11	VNB2068778	4
12	VNB2760978	4
13	VN30143310	16
14	VNB4319078	2
16	VNB4627794	2
17	KG00497100	6
18	KG01901400	6
19	VNB4270602	6
20	KG01069900	6
21	VNB4627578	2
22	KG00870000	6
23	KG01069800	6
24	KG01901500	2

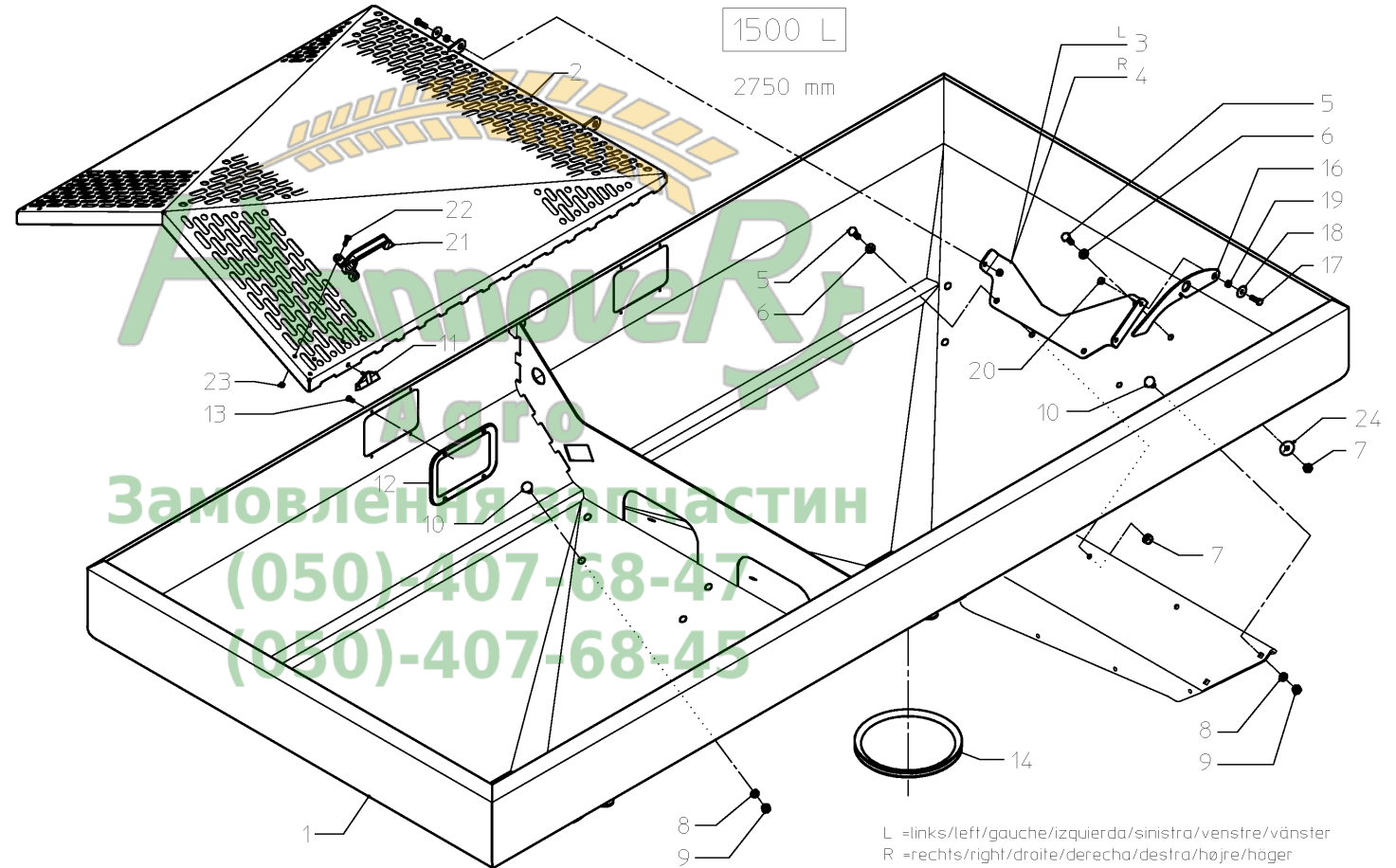

ROXL_VN20702_N04

RO-XL / HOPPER AND SIEVE (1875 L)



PosNo.	Part No.	Qty.
1	VNB4328594	1
2	VNB4277786	2
3	VNB4277994	1
4	VNB4278094	1
5	KG00498700	6
6	KG01264000	6
7	KG01070000	6
8	VN30117100	20
9	KG01053800	20
10	KG00654400	20
11	VNB2068778	4
12	VNB2760978	4
13	VN30143310	16
14	VNB4319078	2
16	VNB4627794	2
17	KG00497100	6
18	KG01901400	6
19	VNB4270602	6
20	KG01069900	6
21	VNB4627578	2
22	KG00870000	6
23	KG01069800	6
24	KG01901500	2

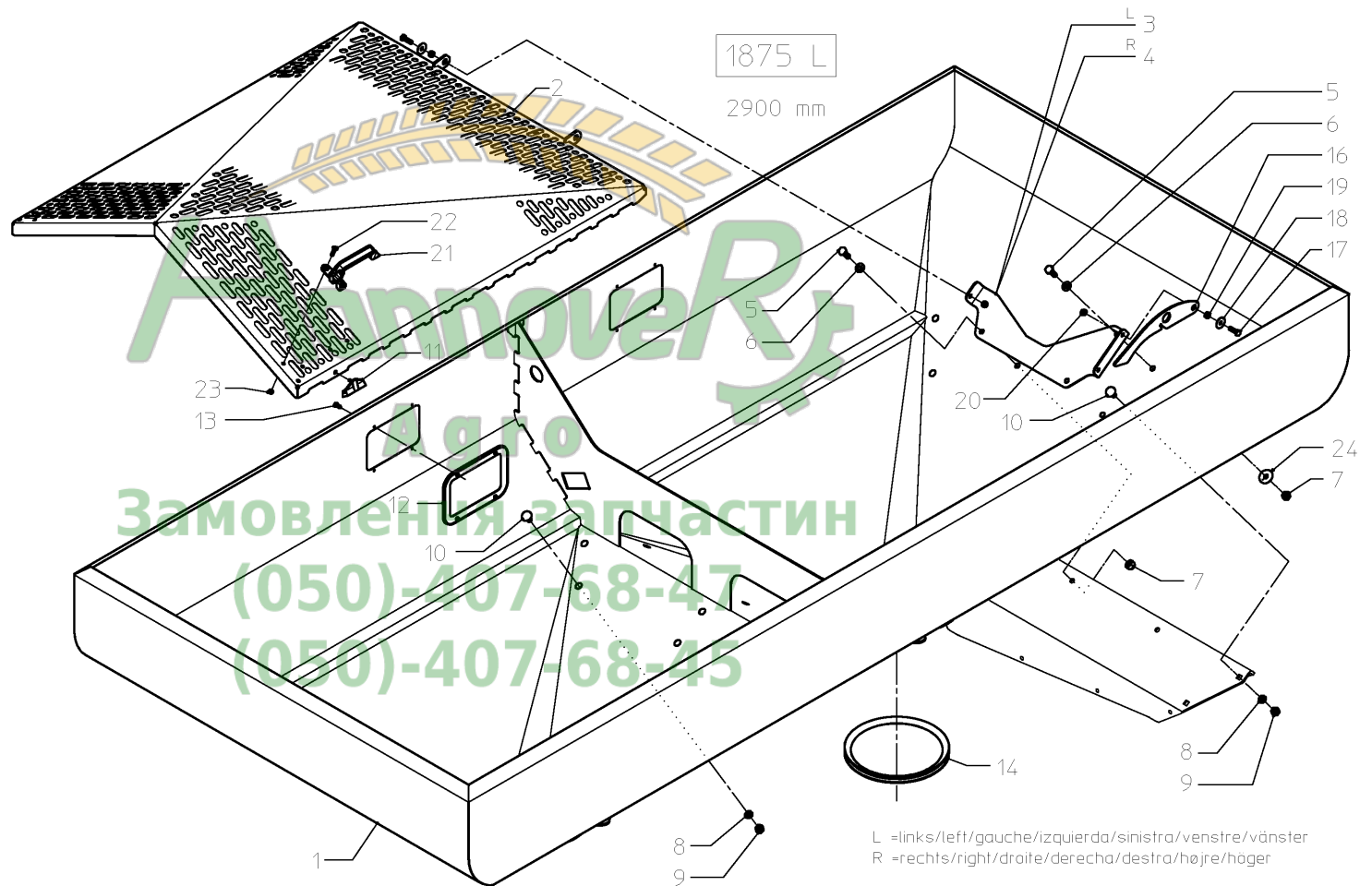

ROXL_VN20702_N05

RO-XL / LIGHTING



PosNo.	Part No.	Qty.
1	VNB4692078	2
3	VN48101007	1
4	VN48523002	4
5	VN48523001	2
6	VNB3620578	2
7	KG01283000	7
8	KG01053400	7
9	VNB4255678	1
10	VN80504003	12
11	VN80504001	2
12	VNB0341273	1
13	KG00714100	3
19	VNB3452478	1
20	VNB3452378	1

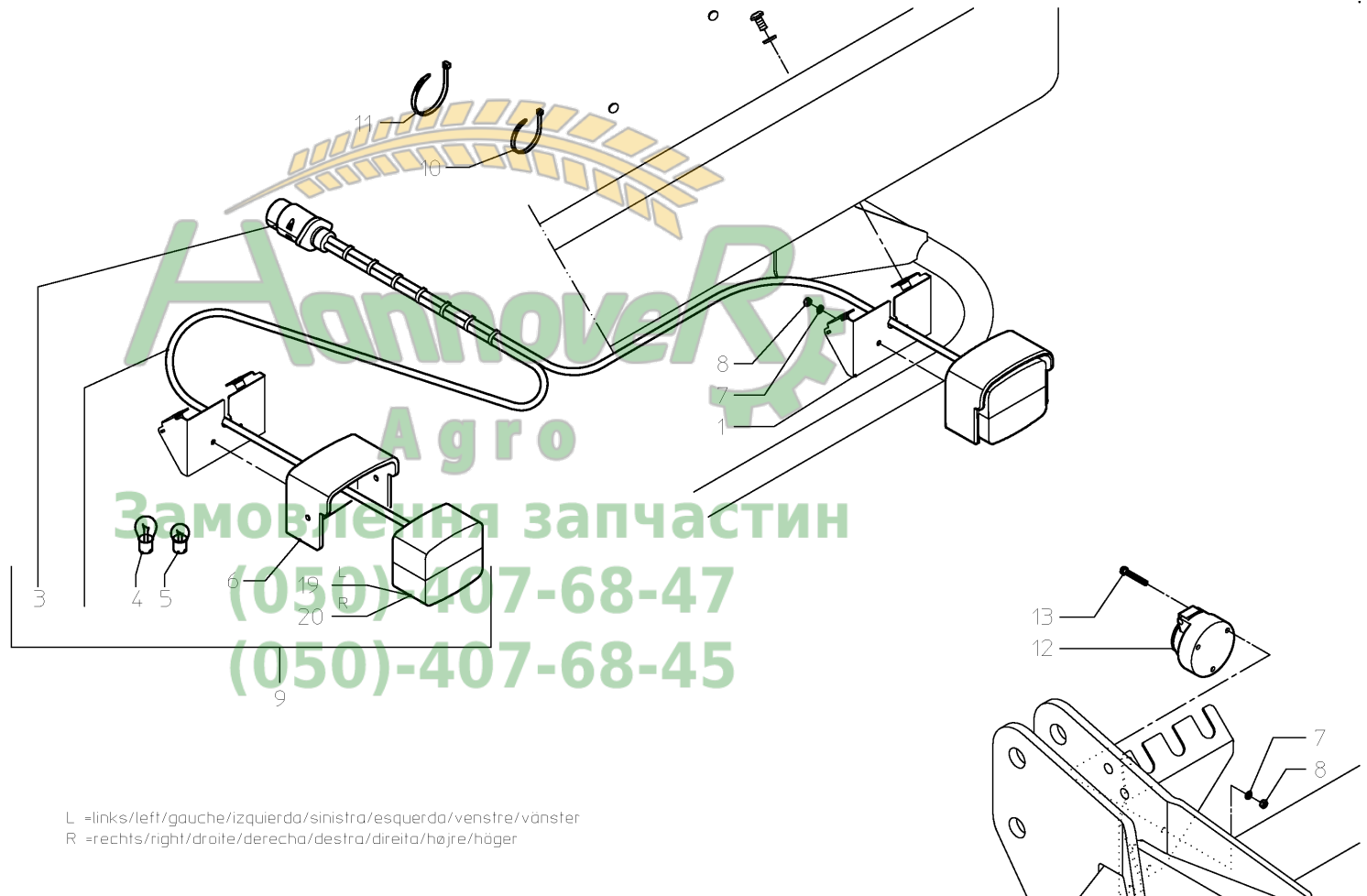

L =links/left/gauche/izquierda/sinistra/esquerda/venstre/vänster
 R =rechts/right/droite/derecha/destra/direita/højre/höger

ROXL_VN20703_P06

RO-XL / DRIVE



PosNo.	Part No.	Qty.
2	KG01264100	20
4	KG01070100	10
5	VNB4064878	1
6	VNB4064978	1
7	KG00399800	6
9	KG00739600	12
10	VNB4668593	4
11	VNB2417578	4
12	VNB2417602	24
13	KG01263900	12
14	KG01069900	28
15	VNB4347993	2
16	VNB4348393	2
17	VNB4348193	2
18	VNB4341978	1
19	KG00399400	4
21	VNB0682993	2
22	VNB4466478	2
23	VNB3550678	1
25	VNB3588378	4
26	VNB3588478	4
36	VNB4348493	4
38	VNB4466678	1
40	RG00050664	12
41	VNB3910902	4

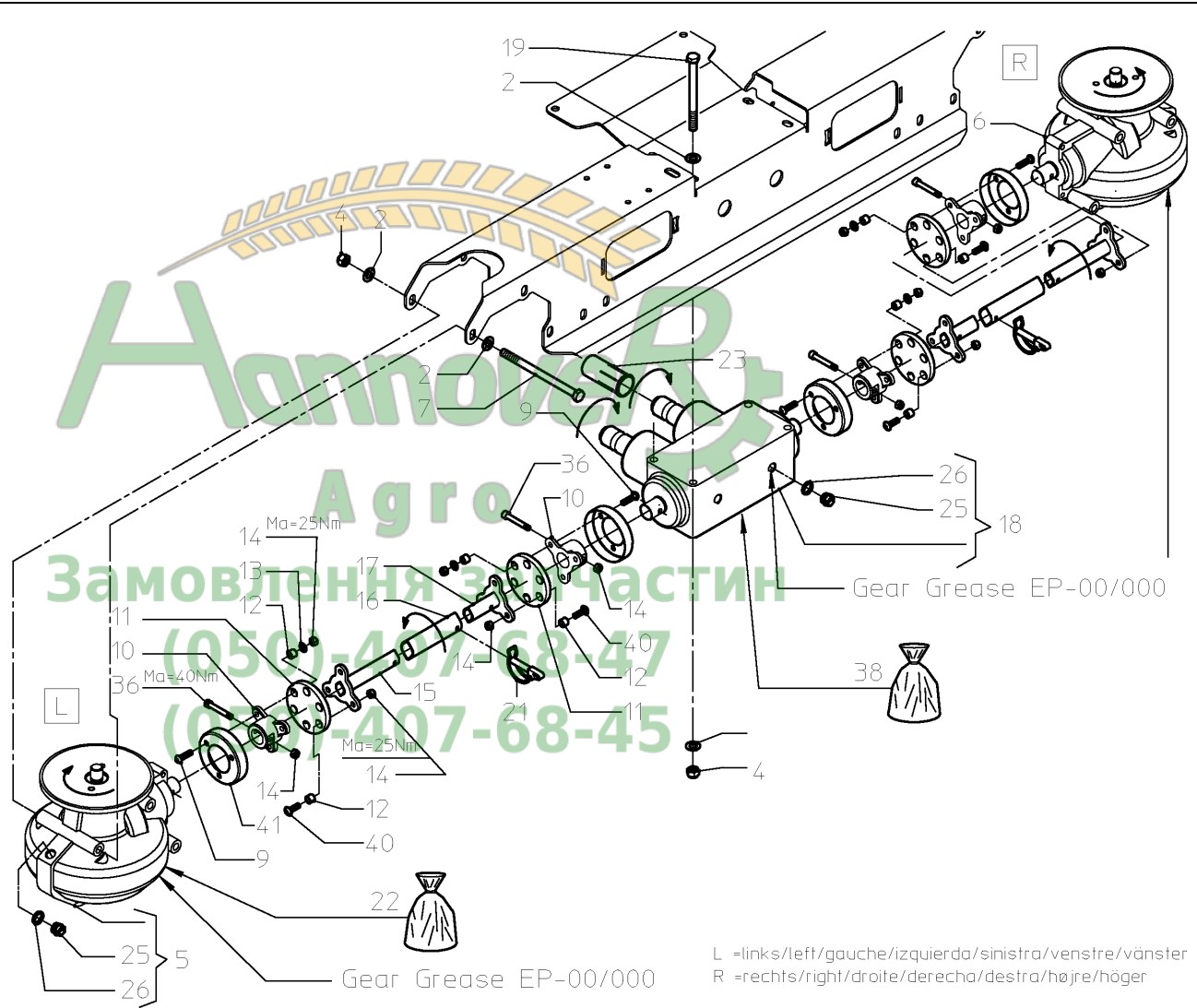

L =links/left/gauche/izquierda/sinistra/venstre/vänster
 R =rechts/right/droite/derecha/destra/højre/höger

ROXL_VN20702_N07

RO-XL / DOSAGE



PosNo.	Part No.	Qty.
1	VNB3317278	2
2	KG00738100	6
3	VNB4061702	2
4	VNB3969702	1
5	VNB3969802	1
6	VNB3957302	1
7	VNB3957402	1
8	VNB4073178	2
9	KG00870200	6
10	KG01069800	18
11	KG00499500	8
12	VN30117100	8
13	KG01053800	16
14	KG01044900	8
15	VNB4042702	16
16	VNB3967598	1
17	VNB3967698	1
18	VNB4239702	2
19	VN36112005	4
20	VNB4060978	2
21	KG01421400	4
22	VNB4225402	2
23	VNB4023502	2
24	KG01107862	2
25	KG00562400	6
26	VNB3957502	2
27	KG00870000	6
28	VNB3559902	4
29	VNB4042498	1
30	VNB4042598	1
31	VNB4059402	2
32	VNB4061978	2
33	KG01283000	6
34	VNB3958278	4
37	VNB3970002	4
38	KG00747600	8
39	VNB4077378	6

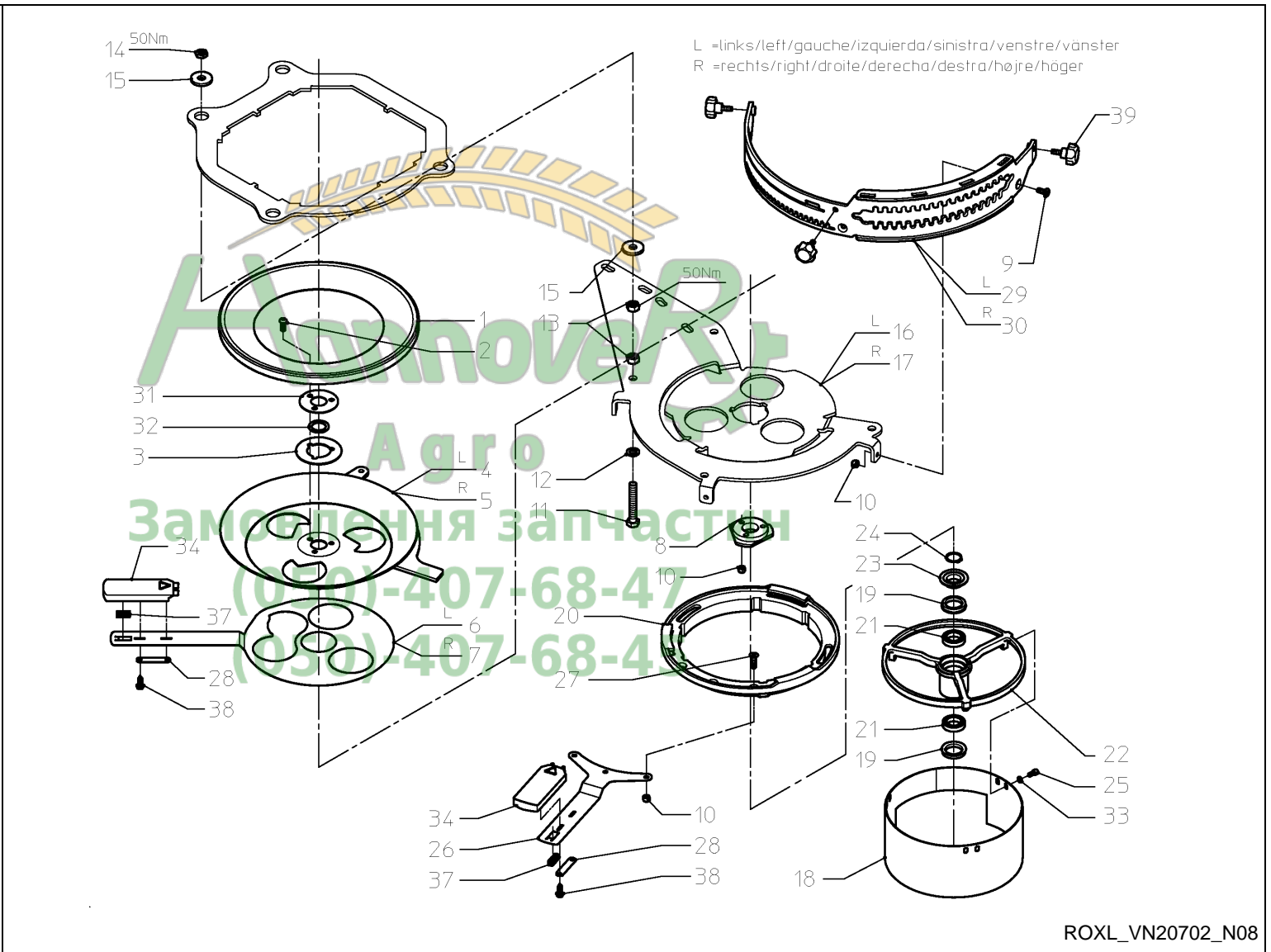

ROXL_VN20702_N08

RO-XL / DISC, BROADCASTER



PosNo.	Part No.	Qty.
1	VNB3414002	1
2	VNB1194874	1
3	VNB3414102	1
4	VNB1181374	1
5	VNB3388365	2
6	KG00498800	4
7	VNB3388402	2
8	VNB4077502	1
9	VNB4077602	1
10	VNB3717802	2
11	KG00565700	2
12	KG01069900	2
13	VNB1082102	12
14	VNB1060002	12
15	VN36112032	2
16	VN30130800	4
17	KG01283300	4
28	VN79771219	1

L =links/left/gauche/izquierda/sinistra/venstre/vänster
 R =rechts/right/droite/derecha/destra/højre/höger

Smeren : Dagelijks en na het schoonmaken
 Lubricate : Daily and after cleaning
 Graisser : Quotidien et après nettoyage
 Schmierer: Täglich und nach dem Reinmachen
 Lubricacion:Diara y despues limpieza

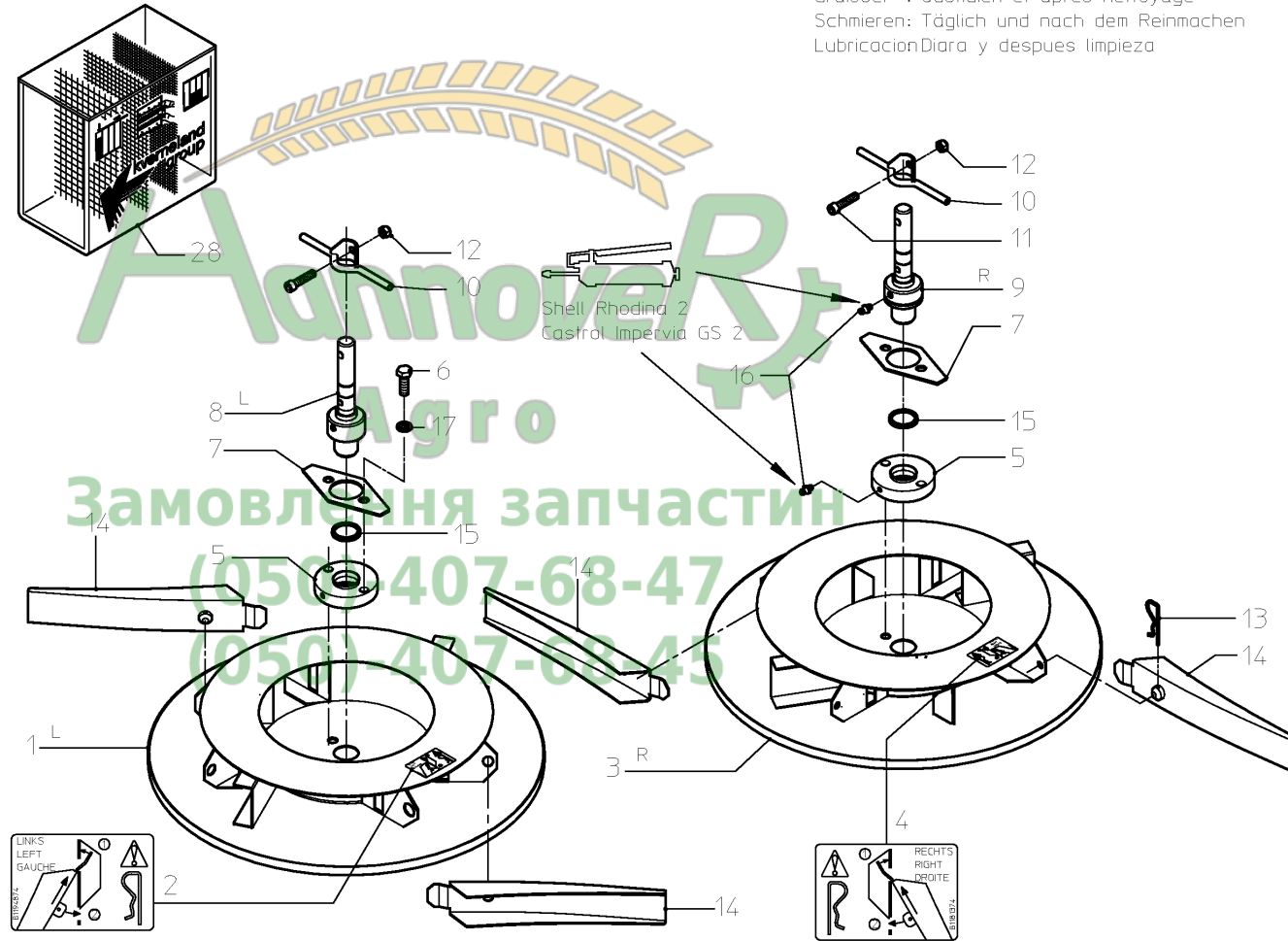

ROXL_VN20702_N09

RO-XL / CONTROL, HYDRAULIC



PosNo.	Part No.	Qty.
1	VNB3322494	2
2	VNB4423078	2
3	VNB4808602	2
4	VNB4808702	2
5	KG01069900	4
6	KG00498700	4
7	KG01901500	4
8	KG01070000	4
9	VNB4297178	4
10	VNB4297702	2
11	VN80504001	4
12	VNB4253278	2
13	KG01901300	2
14	AC351803	1
16	RG00048610	2
17	VN38854581	2
18	VNB4381694	2
19	VNB2003302	2
20	VNB3957778	2
21	VNB3957678	2
22	VNB4292878	2
23	VNB3957878	1
24	VNB3957978	1
25	VNB3958078	1
26	VNB3958178	1
27	VNB4292978	2
28	KG00803400	4
29	VNB3962278	1
30	VNB3962378	1
31	KG00495200	2
32	VNB4239578	2
33	KG01069800	2
34	KG00679700	2
35	KG01901100	2
36	KG01264000	2
37	VNB4743202	2

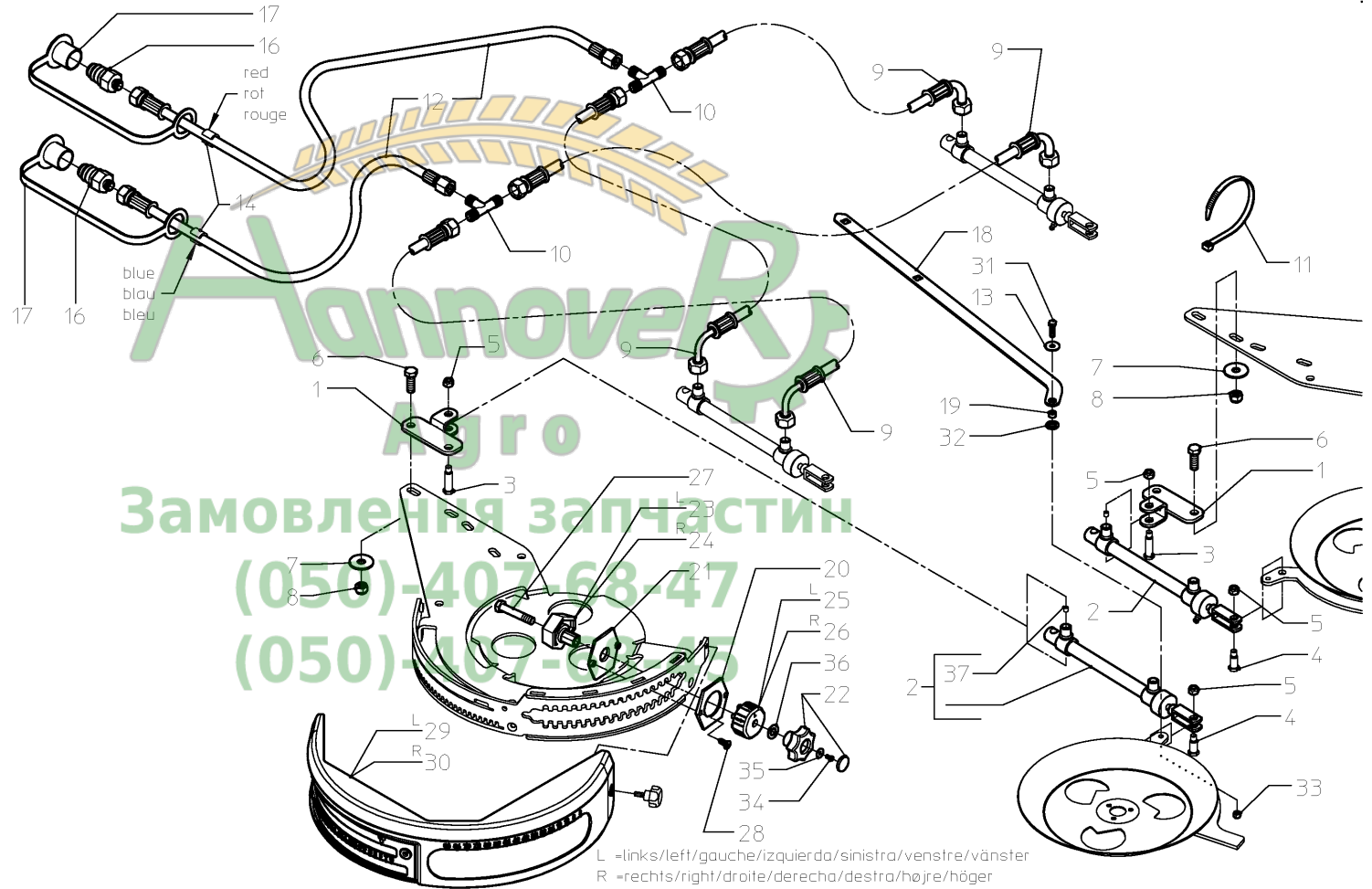

ROXL_VN20703_P10

RO-XL / COMFORT CONTROL



PosNo.	Part No.	Qty.
1	VNB0563773	1
2	VNB0548173	1
3	VNB0374873	1
4	VNB3872902	1

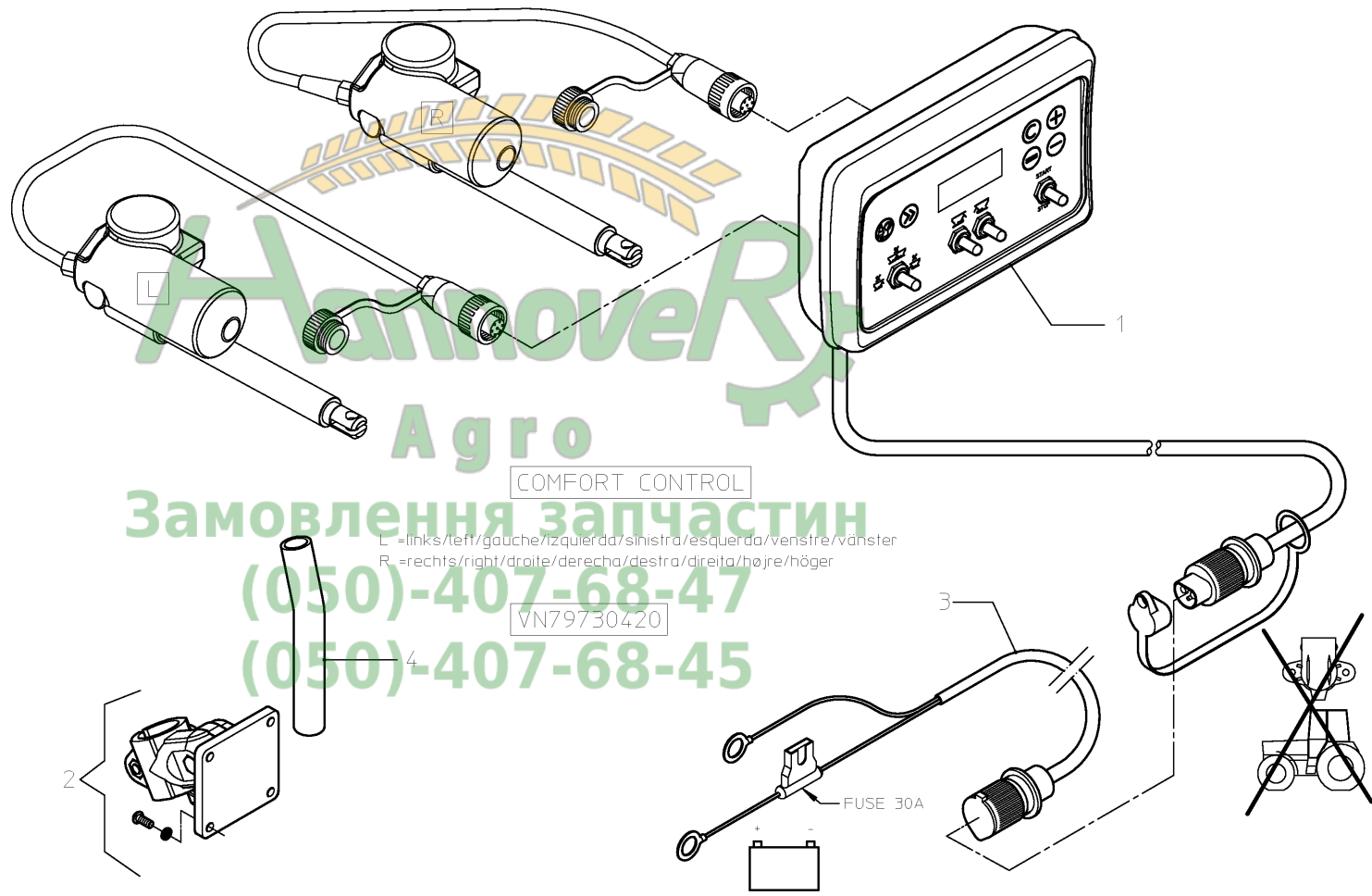

Замовлення запчастин
 (050)-407-68-47
 (050)-407-68-45

ROXL_VN20702_N11

RO-XL / COMFORT CONTROL



PosNo.	Part No.	Qty.
1	VNB4713902	2
2	VNB3317378	2
3	VN36107317	2
4	KG00945900	2
5	VN30130800	2
6	VNB4808502	4
7	KG01069900	4
8	KG00498700	4
9	KG01901500	4
10	KG01070000	4
11	VN80504001	2
13	VNB4063078	1
14	VNB4063178	1
17	VNB0550373	2
18	VNB2235978	8
19	VNB0566173	1

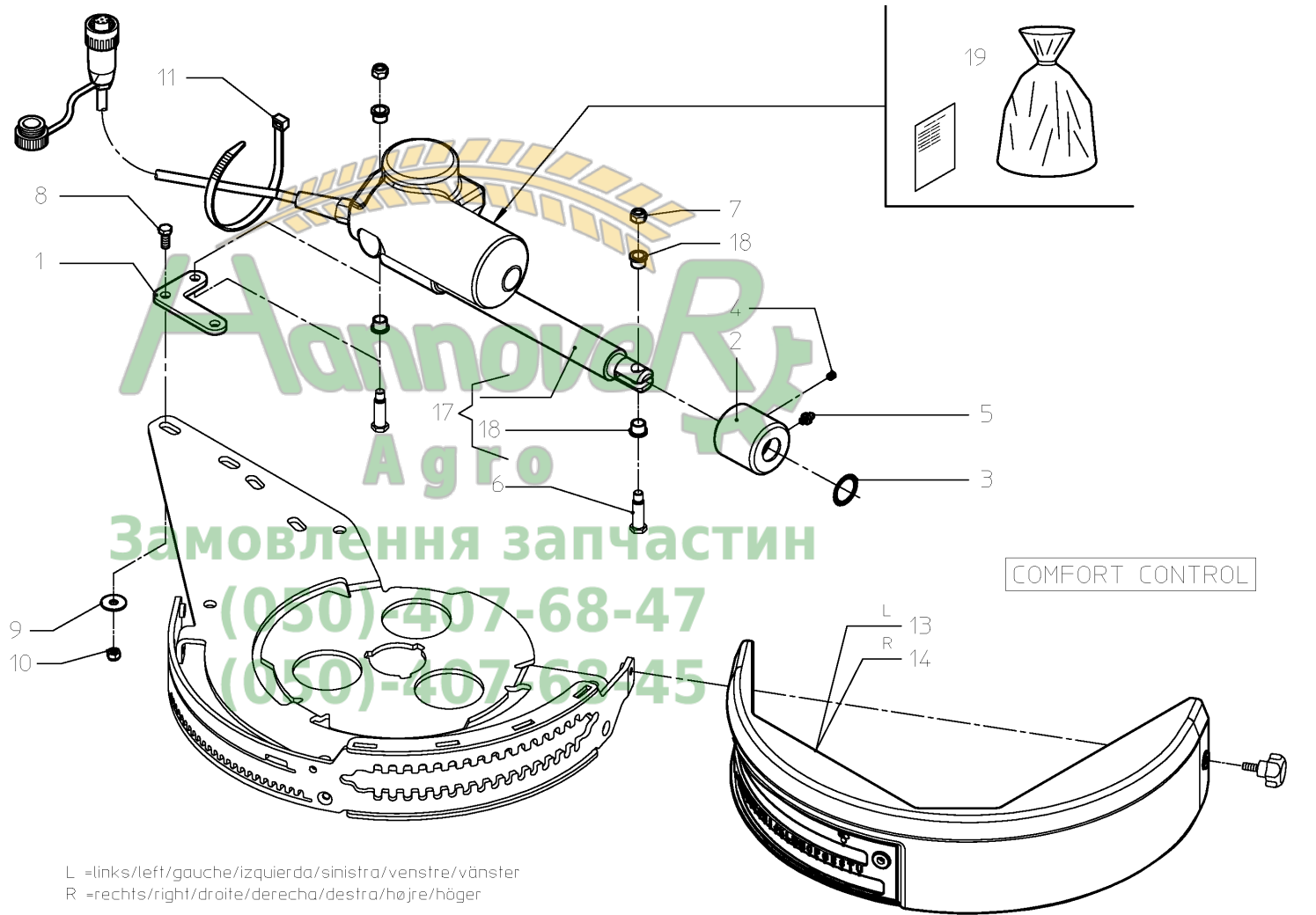

L =links/left/gauche/izquierda/sinistra/venstre/vänster
 R =rechts/right/droite/derecha/destra/højre/höger

ROXL_VN20703_P12

RO-XL / UNIV. JOINT SHAFT



PosNo.	Part No.	Qty.
1	VN46120092	1
4	VG85.005	1
5	VG85.004	1
11	VG10.83.40	1
12	VGAGRASET173	1
13	VG56.117.19	1
21	VG10.01.00	2
22	VGND98026V	2
23	VG10.48.00	1
24	KG01192062	2
25	VG75.02.15	1
26	VG75.06.15	1
27	VG10.49.00	1
51	VG83.09.01	2
52	VG85.05.06	2
53	VG365305	2
54	VG83.10.03	2
55	VG82.36.03	2
90	VGAGRASET207	1

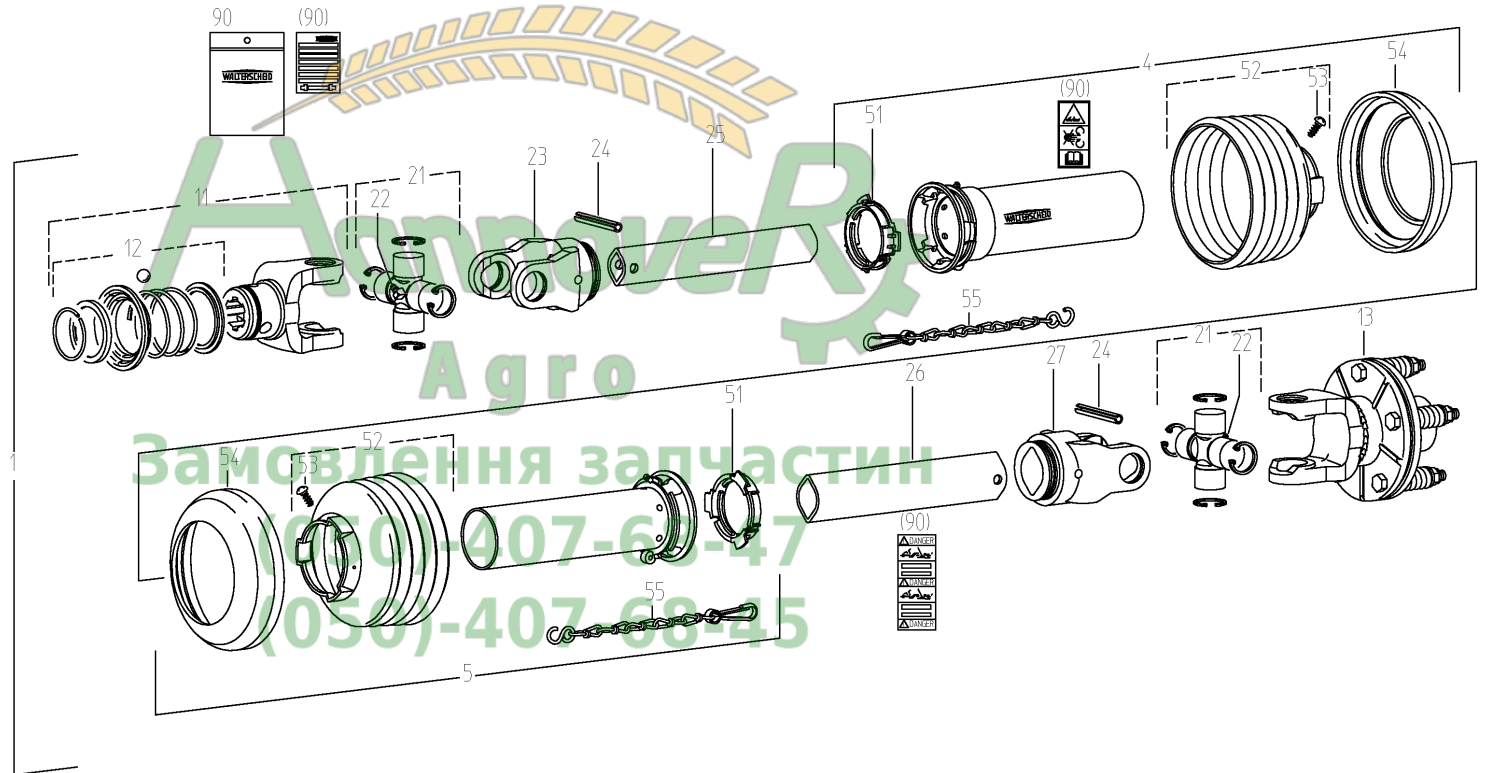

ROXL_VN20702_C01

RO-XL / DECAL SCHEMATIC

PosNo. Part No. Qty.

1	VNB4053074	1
2	VNB4105274	1
3	VNB4377074	1
4	VNB4493474	1
5	VNB4376974	2
6	VNB4377174	1
7	VNB3444974	1
8	VNB4105474	2
9	VNB4366374	2
10	VNB1194874	1
11	VNB1181374	1
12	VNB4105674	2
13	VNB4377474	2
14	VNB4377574	2
18	VNB2822600	1

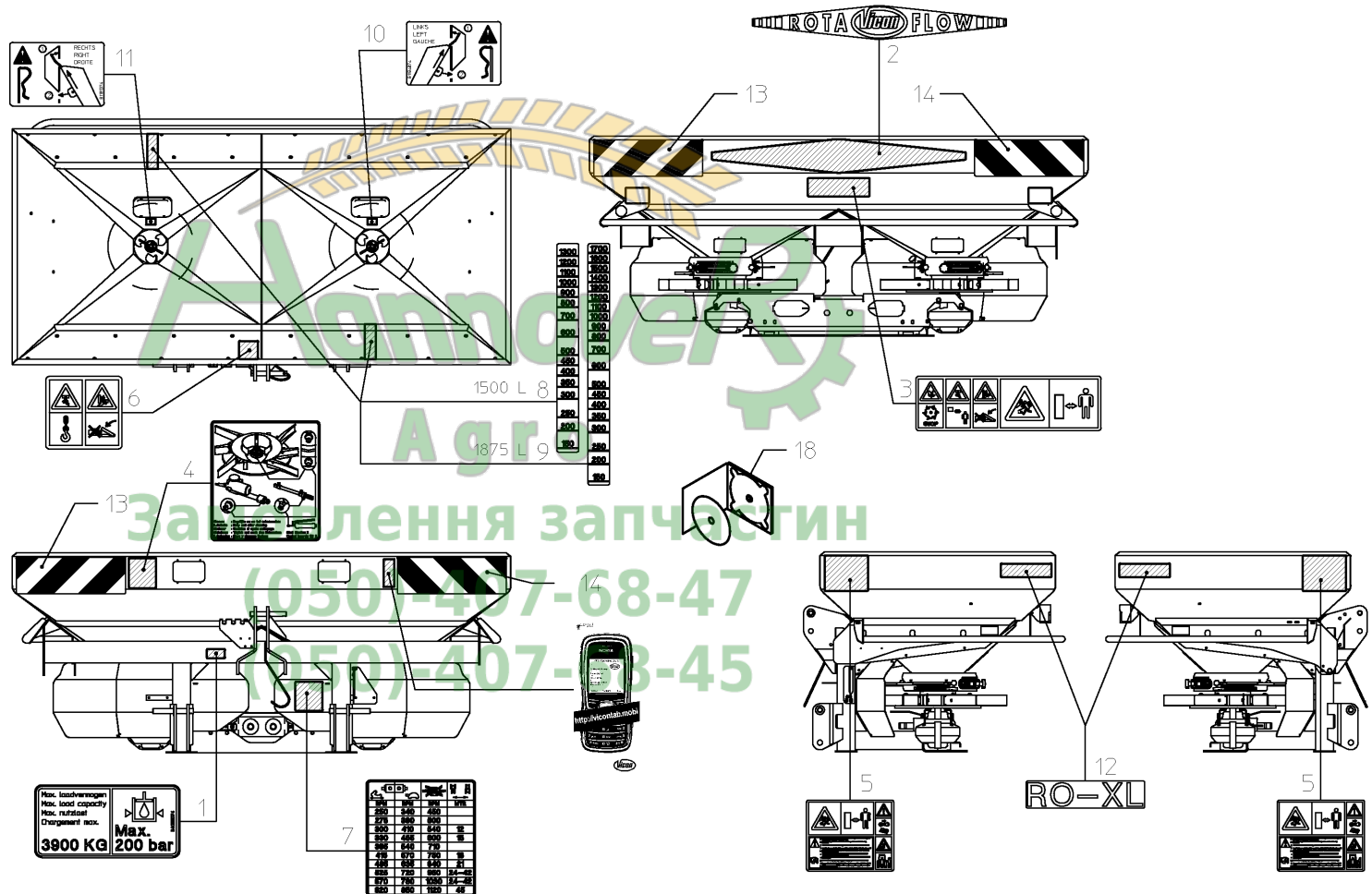

ROXL_VN20702_C11

RO-XL / DECAL SCHEMATIC



PosNo.	Part No.	Qty.
16	VNB4377474	1
17	VNB4377574	1

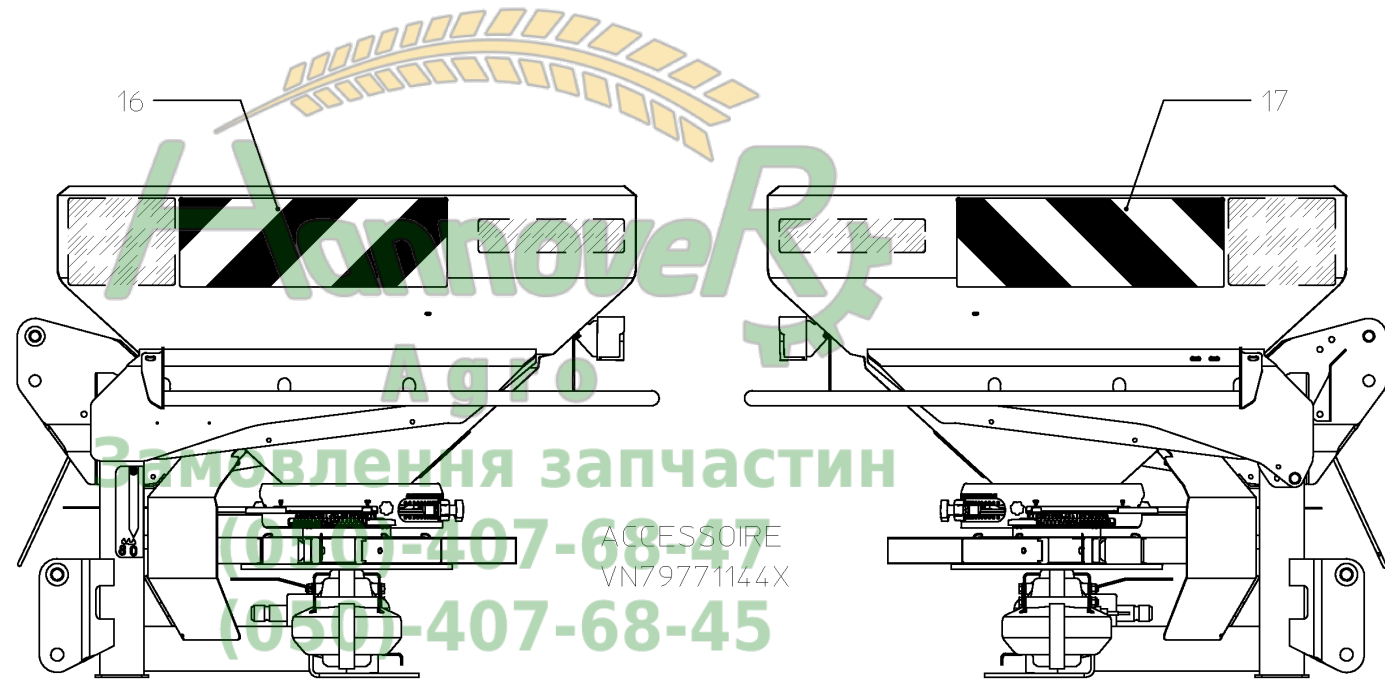

ROXL_VN20702_C12

RO-XL / ACCESSORIES



PosNo. Part No. Qty.

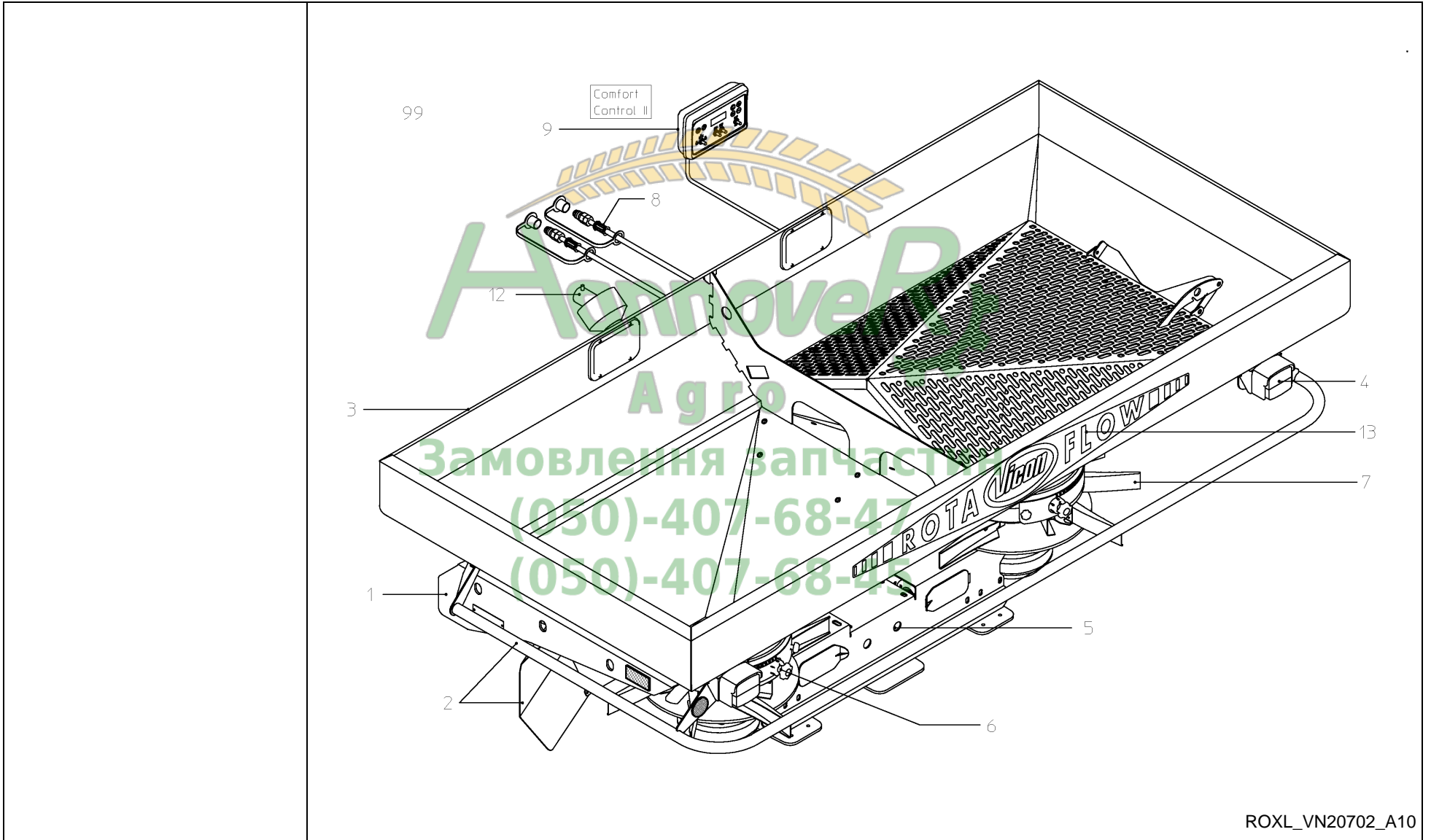

ROXL_VN20702_A10

RO-XL / HOPPER EXTENSION (1500 L)



PosNo.	Part No.	Qty.
1	VNB4675602	2
2	VNB4675502	2
3	VNB3984186	4
4	VNB4218178	16
5	VNB4014778	4
6	VNB4053474	8

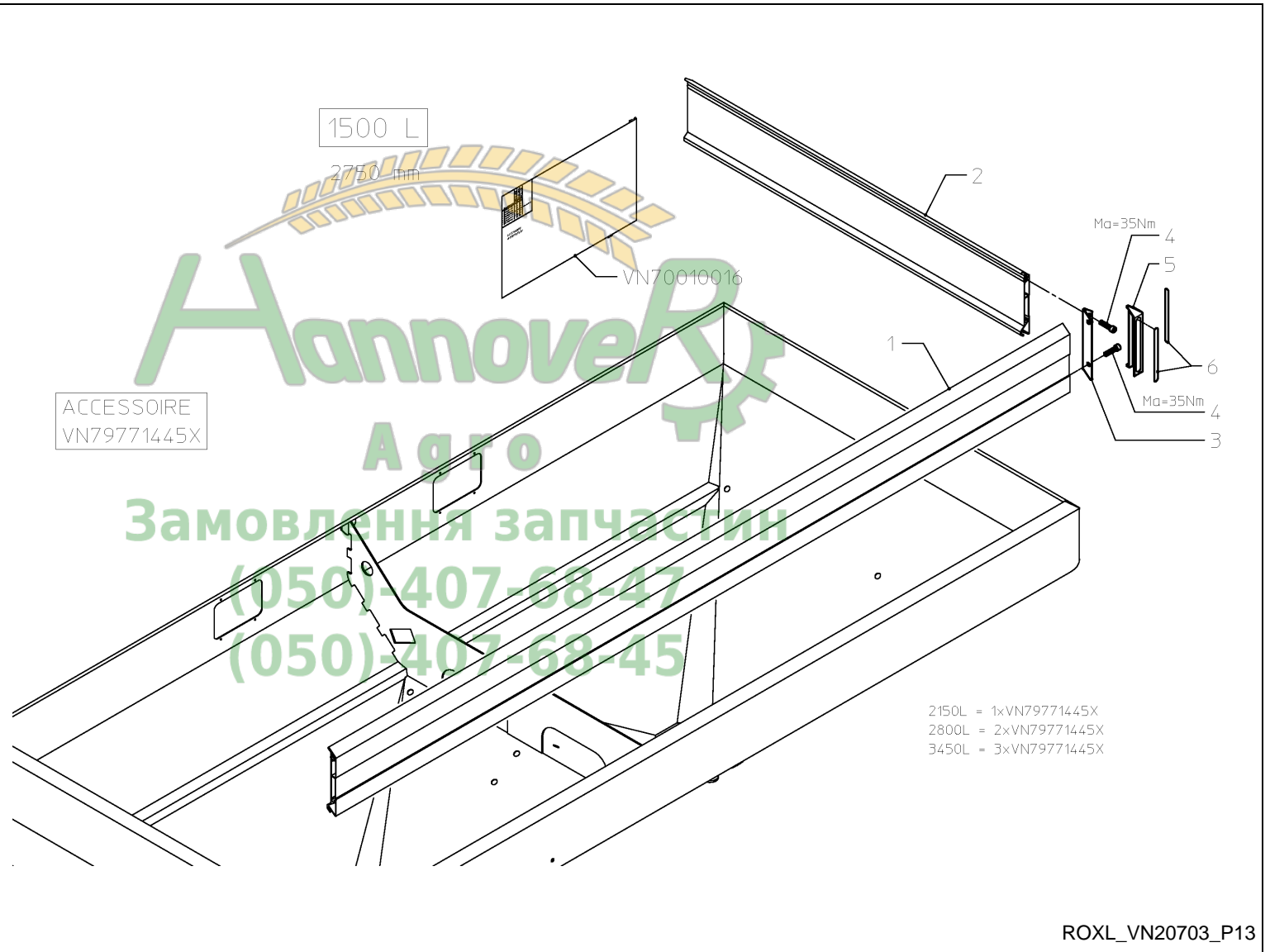

RO-XL / HOPPER EXTENSION (1875 L)



PosNo.	Part No.	Qty.
1	VNB4675702	2
2	VNB4675502	2
3	VNB3984186	4
4	VNB4218178	16
5	VNB4014778	4
6	VNB4053474	8

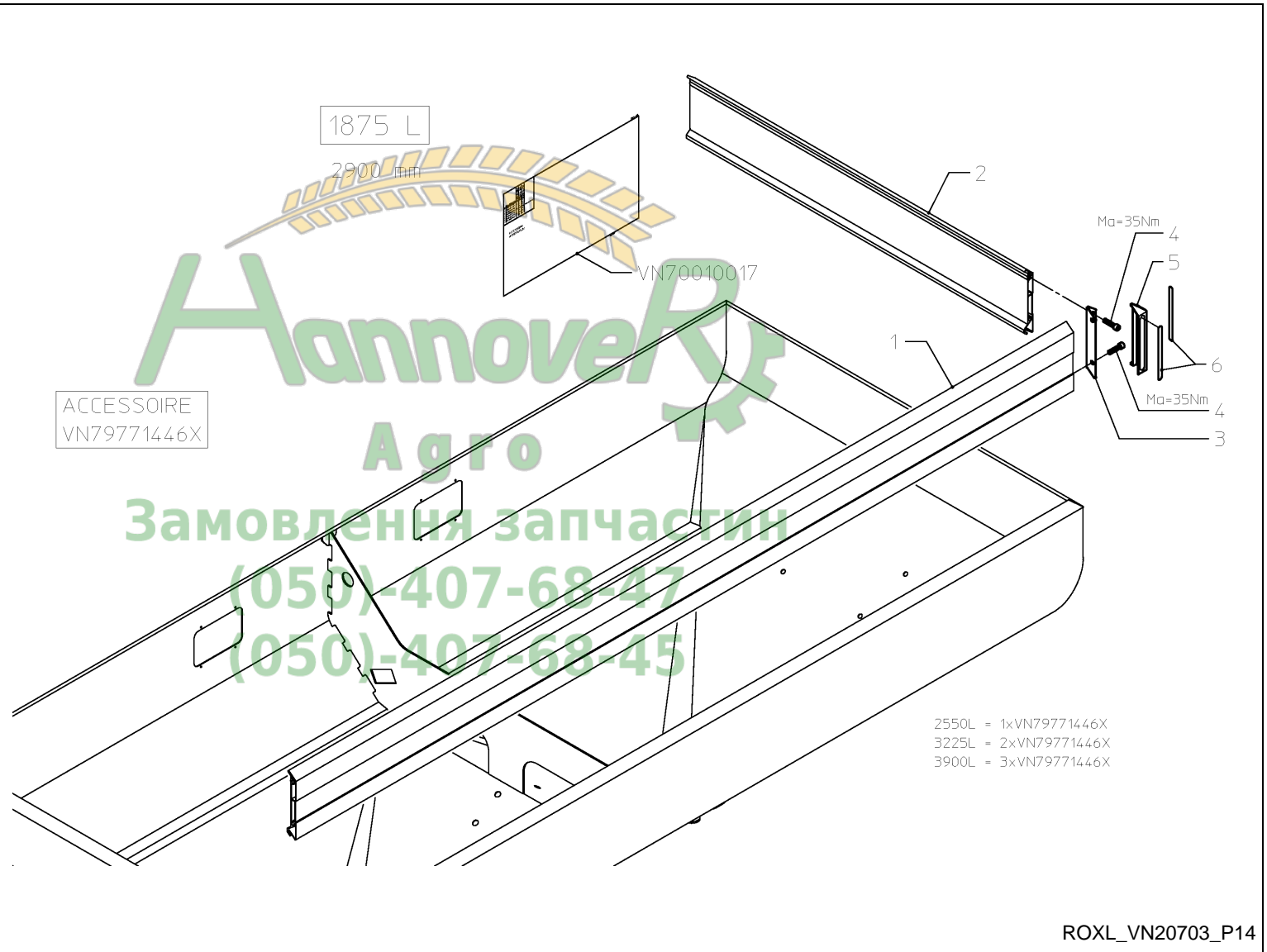

RO-XL / TARPAULIN (1500 L)



PosNo.	Part No.	Qty.
1	KG01053700	8
2	KG01263900	8
3	KG00738100	2
4	KG00652900	12
5	KG00739600	10
6	KG01053500	2
7	KG01069900	22
8	KG01901500	8
9	KG00712600	1
10	KG01901400	10
11	VNB2092402	4
12	VNB3443478	4
13	VNB3602694	1
14	VNB3602794	1
15	VNB3603194	2
16	VNB4306994	1
17	VNB3603394	1
18	VNB3708094	1
19	VNB3603594	1
20	VNB4487278	10
21	RG00040217	1
22	VGTR2059	1
23	VNB4306794	1
24	VNB4306894	1
25	VNB4309102	8
26	KG00497600	8
27	KG00497200	8
28	KG01263600	1
29	VNB3447178	1
30	KG01069600	1
31	VNB3707494	3
32	VNB4079778	1

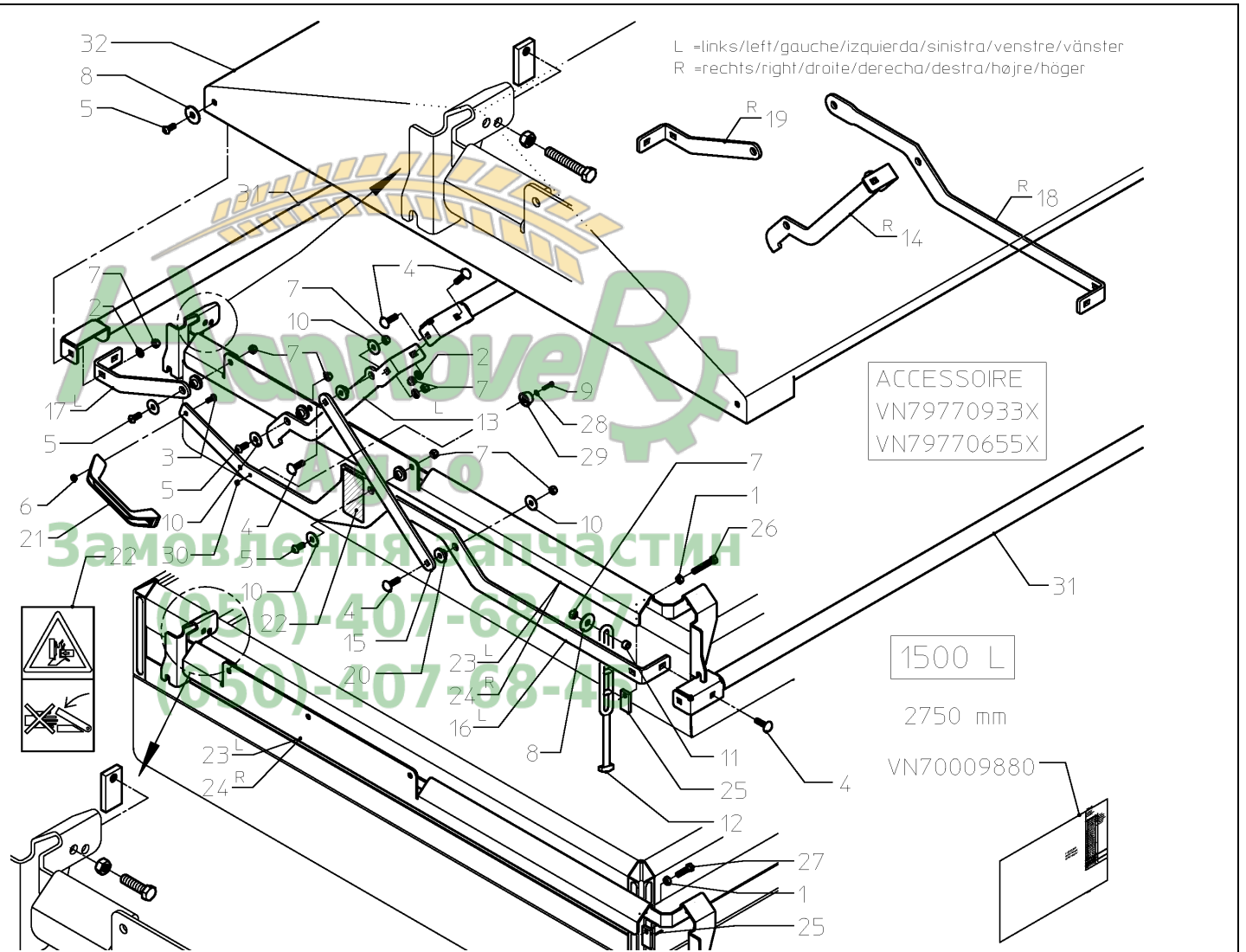

ROXL_VN20702_N16

RO-XL / TARPAULIN (1875 L)



PosNo.	Part No.	Qty.
1	KG01053700	8
2	KG01263900	8
3	KG00738100	2
4	KG00652900	12
5	KG00739600	10
6	KG01053500	2
7	KG01069900	22
8	KG01901500	8
9	KG00712600	1
10	KG01901400	10
11	VNB2092402	4
12	VNB3443478	4
13	VNB3602694	1
14	VNB3602794	1
15	VNB3603194	2
16	VNB4306994	1
17	VNB3603394	1
18	VNB3708094	1
19	VNB3603594	1
20	VNB4487278	10
21	RG00040217	1
22	VGTR2059	1
23	VNB4306794	1
24	VNB4306894	1
25	VNB4309102	8
26	KG00497600	8
27	KG00497200	8
28	KG01263600	1
29	VNB3447178	1
30	KG01069600	1
31	VNB4373494	3
32	VNB4283878	1

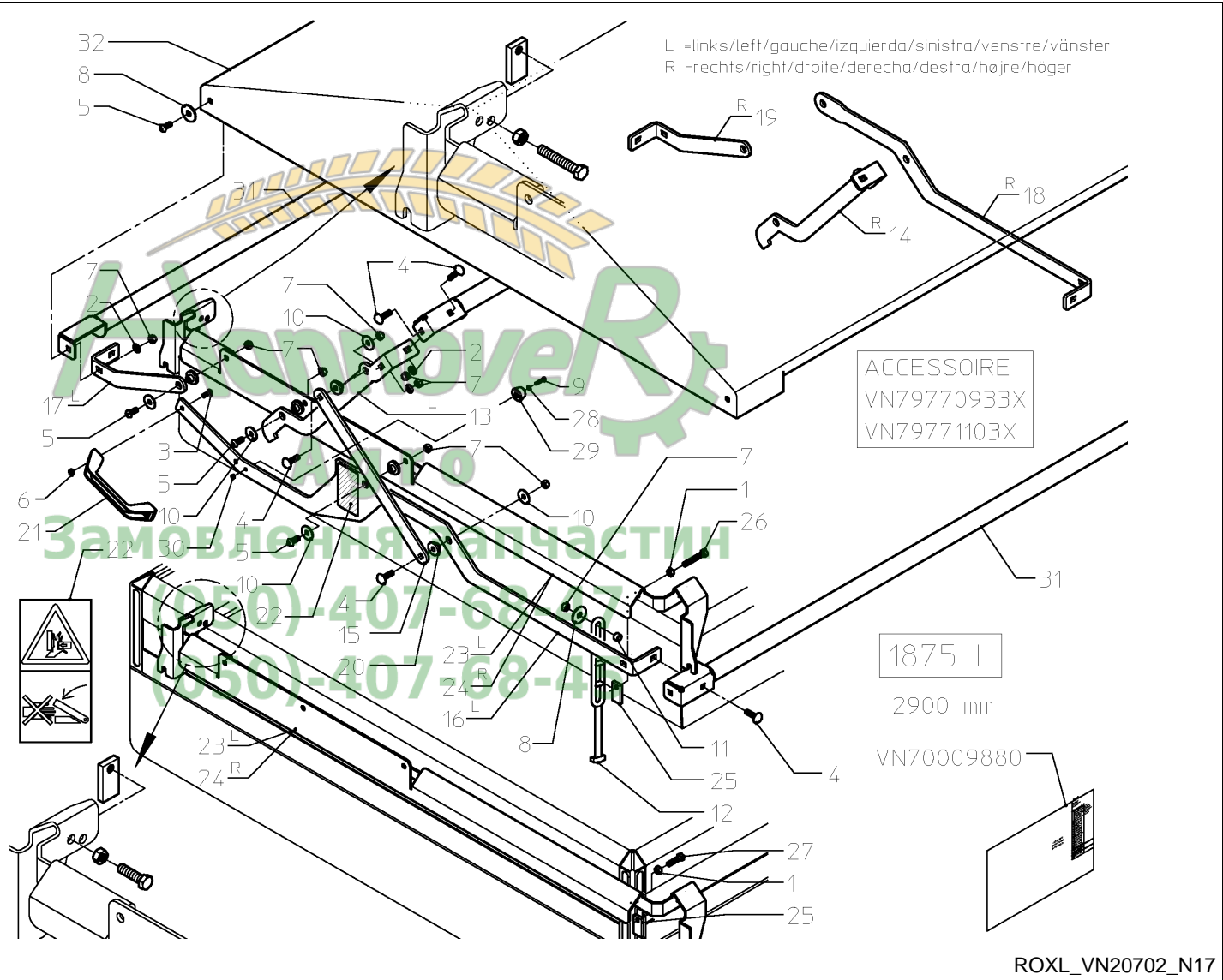

RO-XL / HOPPER EMPTYING SET



PosNo.	Part No.	Qty.
1	VNB4407802	2
2	KG00679900	8
3	KG01263600	8
4	VN30105400	8
5	VNB4408202	2
6	KG00738300	6
7	VNB4423502	6
8	VNB4451002	6
9	KG01264000	6
10	KG01069800	6
11	VNB4334578	4
12	KG00738100	4
13	VNB4408302	2
14	KG01901300	2

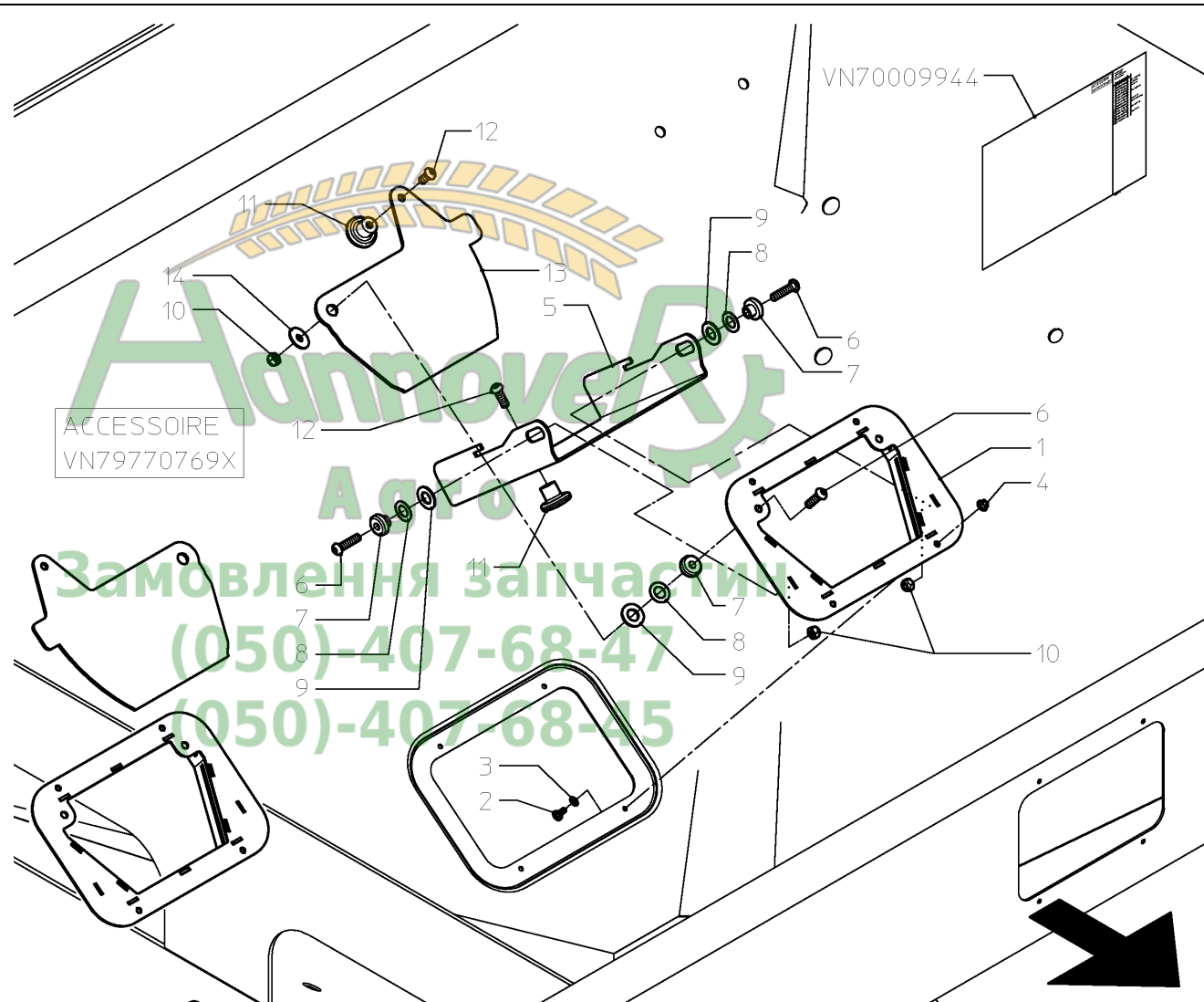

ACCESSOIRE
VN79770769X

VN70009944

Аграрне
Замовлення запчастин
(050)-407-68-47
(050)-407-68-45

ROXL_VN20702_N18

RO-XL / SCOOP SET



PosNo.	Part No.	Qty.
1	VNB1082102	12
2	VNB4769365	12



АннаовеАгро
 Замовлення запчастин
 (050)-407-68-47
 (050)-407-68-45

SPM\N000331

VN70010031

VN79771450

RO-XL / LADDERSET



PosNo.	Part No.	Qty.
1	KG00497100	7
2	KG00654400	1
3	KG00868600	6
4	KG00870200	6
5	KG01069700	6
6	KG01069800	6
7	KG01069900	7
8	KG01901400	7
9	VNB4442278	1
10	VNB4450578	2
11	VNB4451194	1
12	VNB4451294	2
13	VNB4451394	7
14	VNB4451494	1
15	VNB4451978	1
16	VNB4473502	1
17	VNB4743378	3

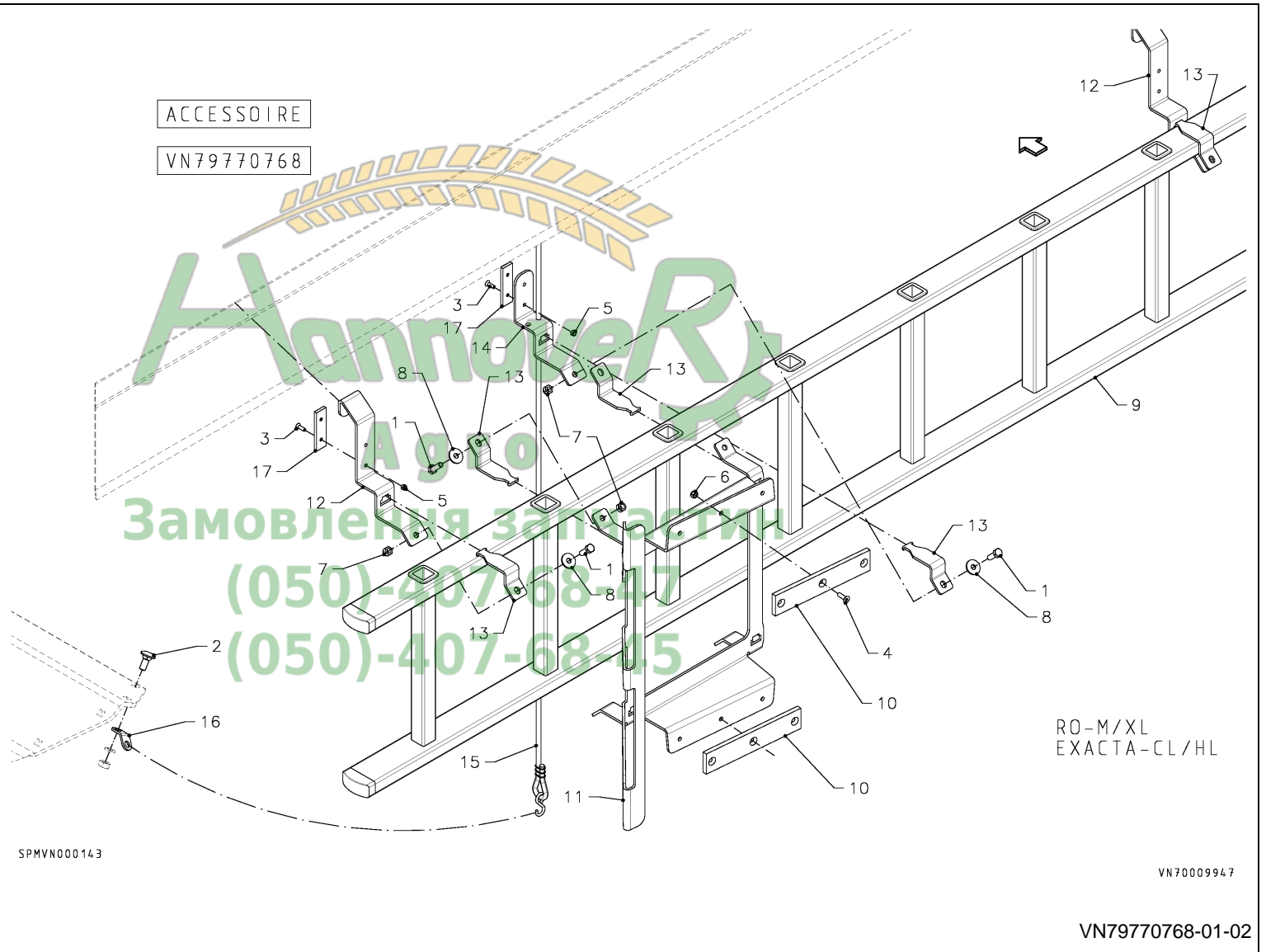

RO-XL / WHEELSET



PosNo.	Part No.	Qty.
1	VNB0765393	4
2	VNB1380878	2
3	VNB1402486	2
4	VNB1907978	2
5	VNB3770294	4
6	VNB3843994	2
7	VNB4376594	2
8	VNB3876594	2
9	VNB3876694	2
10	KG00397100	2
11	KG00496900	26
13	KG01069900	22
14	KG01070000	2
15	KG01901400	12
16	KG01059700	4

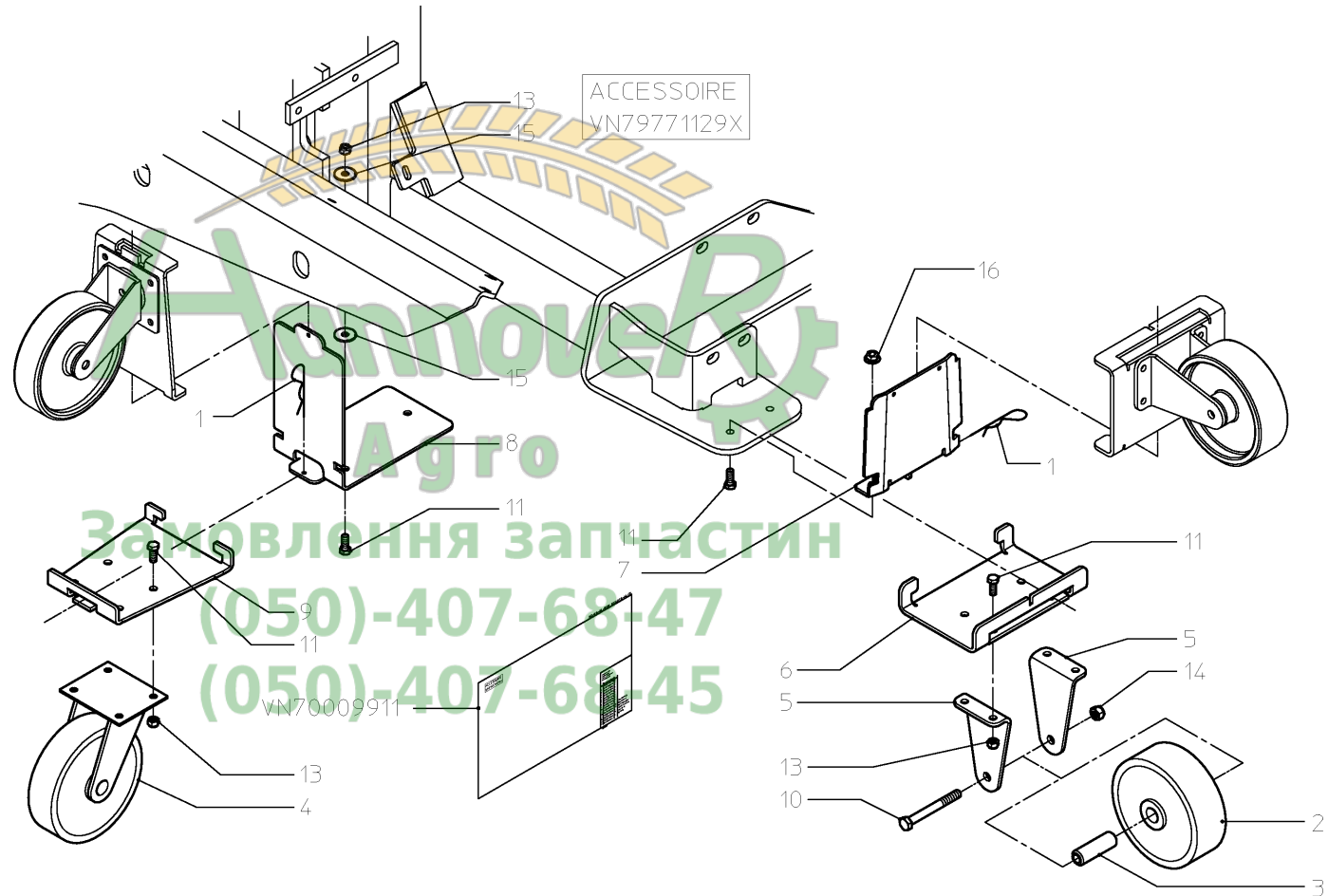

ROXL_VN20702_N20

RO-XL / CALIBRATION CONTAINER



PosNo.	Part No.	Qty.
2	VNB4332994	1
3	VNB4334578	1
4	KG01059600	2
5	KG00495300	1
10	VNB4332194	1
11	VNB4332094	1
12	RG00040217	2
13	KG00495100	4
14	KG01069800	4
15	VNB2760978	1
16	VN30143310	4
17	VNB1100802	2
18	KG00493700	4
19	KG01901200	4
20	KG01069700	4
21	VNB3708174	1
22	VGTR2023	1

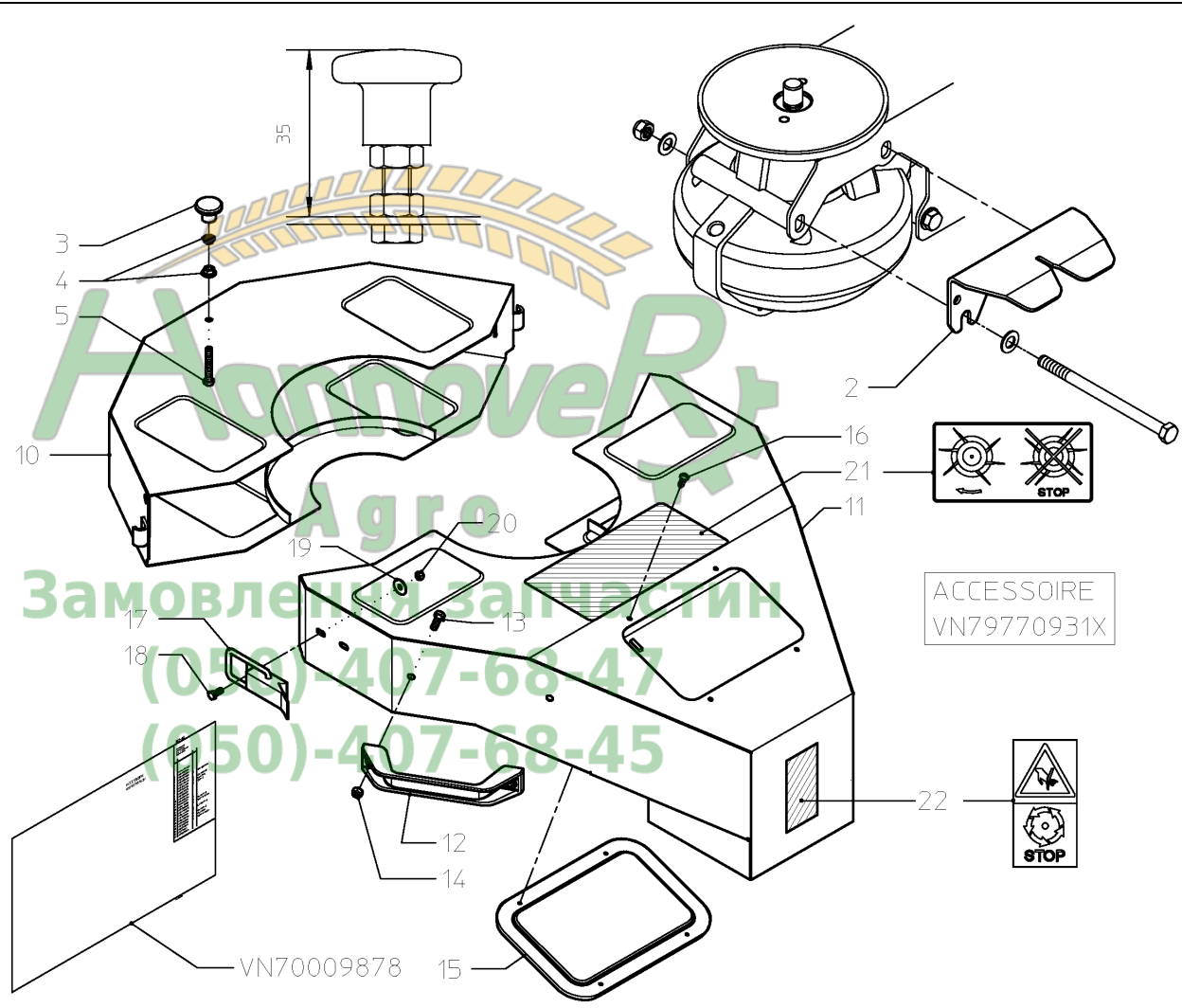

ROXL_VN20702_N21

RO-XL / BOUNDARY SPREADING PLATE



PosNo.	Part No.	Qty.
1	VNB3428494	1
2	KG00496900	4
3	KG01059700	4
4	VNB3428094	1
5	VN17856588	1
6	VNB3428594	1
7	KG00654400	2

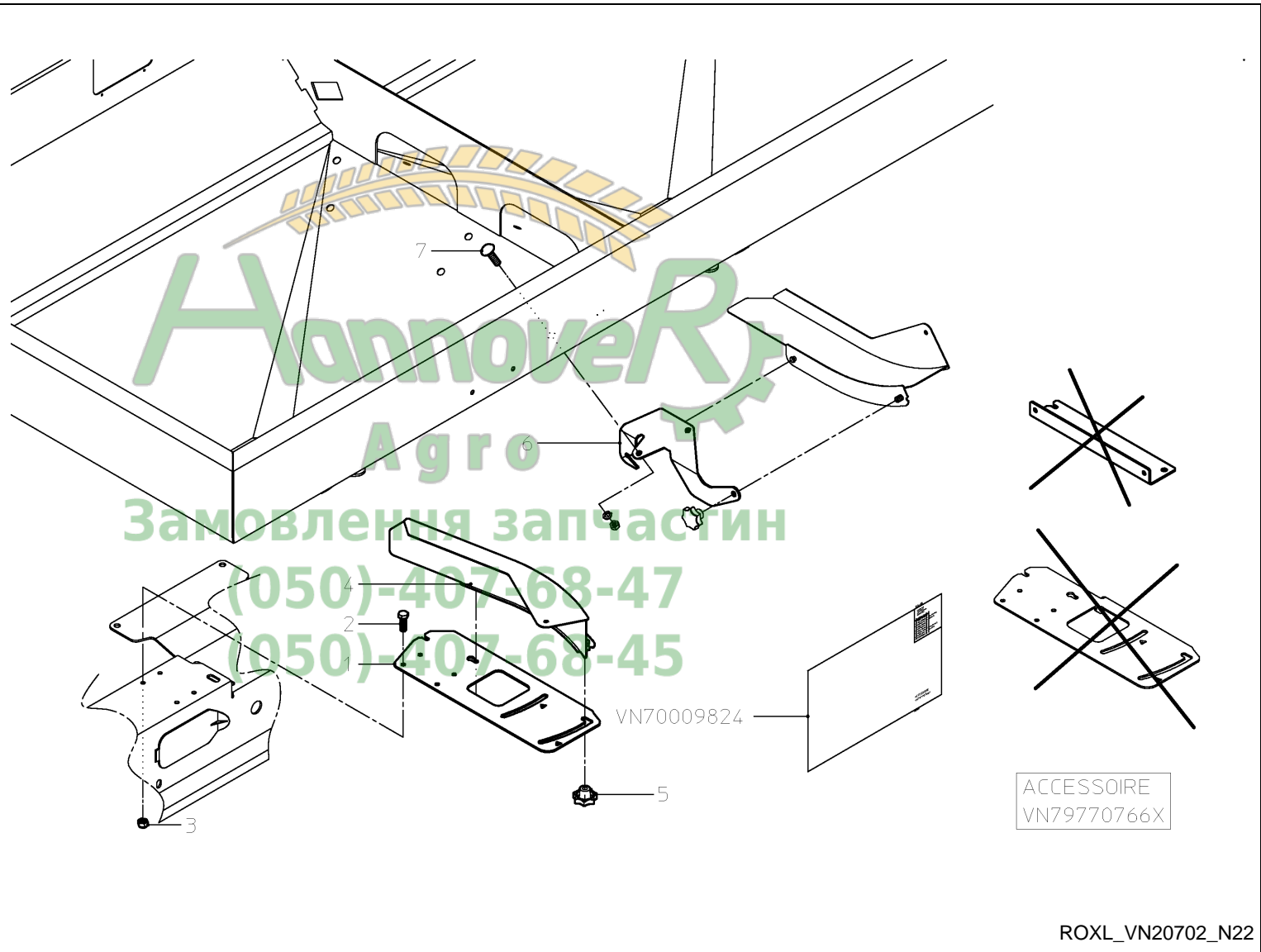

RO-XL / TRIMFLOW



PosNo.	Part No.	Qty.
1	VNB4580502	1
2	VNB4482694	1
3	VN17856588	2
4	KG01070000	7
5	KG01264000	2
6	KG00498700	1
7	KG00495200	1
8	KG00498800	3
9	VNB4372394	1
10	VNB4008194	1
11	VNB4808802	1
12	VNB4808502	1
13	VNB4011494	1
14	VNB4288302	1
15	VNB3085978	2
16	VNB3913093	1
17	KG00497100	1
18	KG01263900	1
19	KG01069900	3
20	VN80504003	5
21	VN30130800	1
22	VN30117100	3
23	VNB2003302	1
24	VNB4297478	1
25	KG01069700	2
26	VN38854581	1
27	RG00048610	1
28	VN31419900	2
29	VN90007711	1
30	VNB4288402	1
31	KG01901300	1
32	VNB4769578	8
33	VGTR2059	1
34	VNB4239578	1
35	KG01901500	2
36	KG01069800	1
37	VN79771437	1
39	KG00868600	2
40	VNB4743378	1

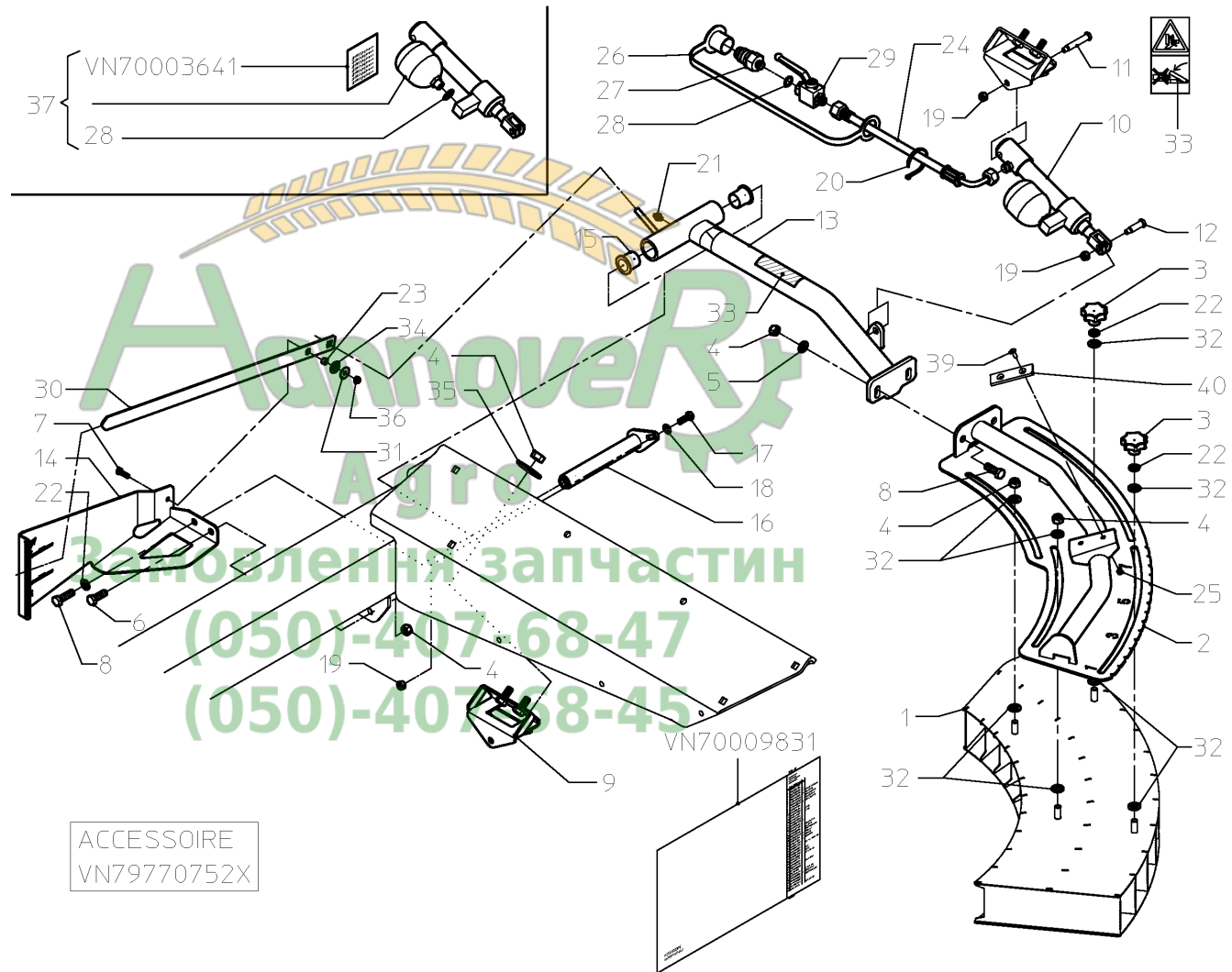

ROXL_VN20703_P23

RO-XL / FEELER GAUGE



PosNo.	Part No.	Qty.
17	VNB1709302	1
18	VNB1754278	1

ACCESSOIRE
VN79770216X

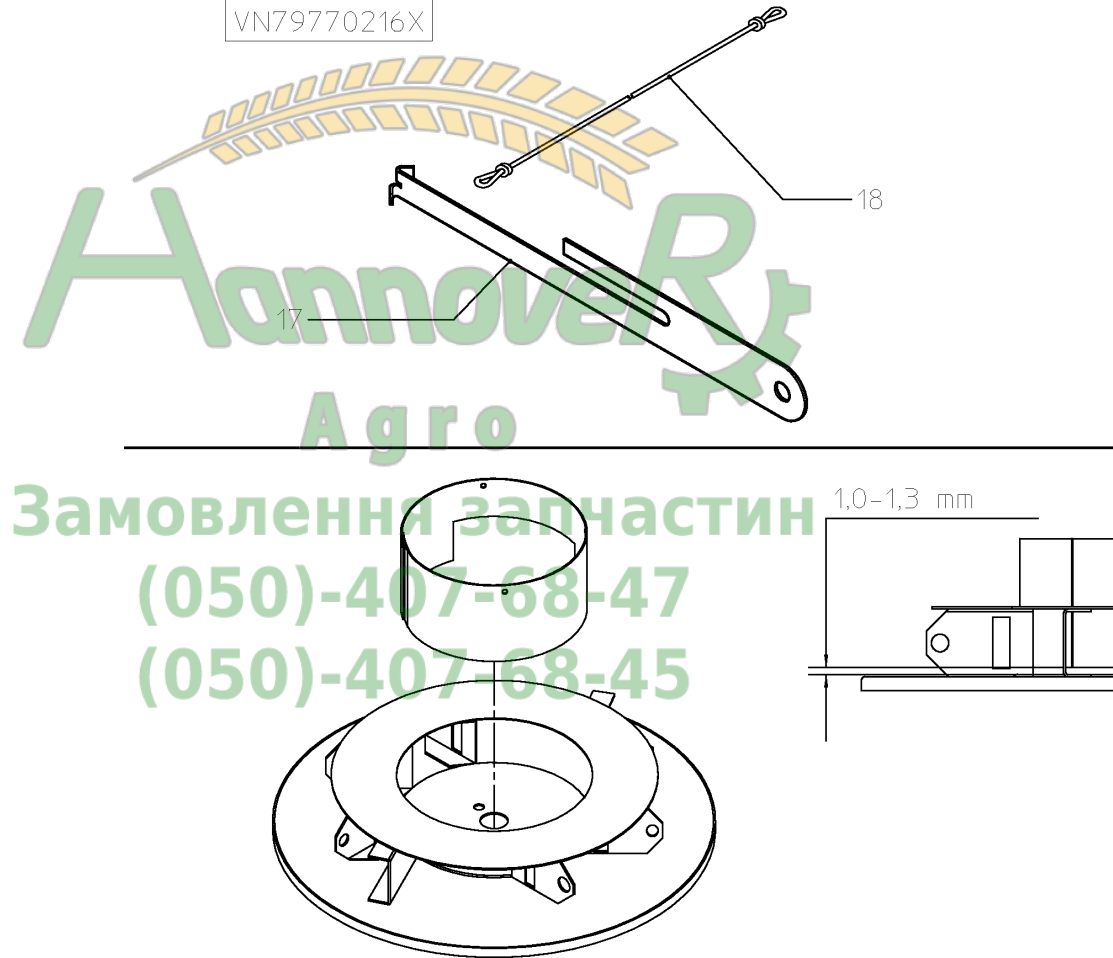

RO-XL / SPREADING PATTERN CONTROLSET



PosNo.	Part No.	Qty.
1	VN79771400	1
2	AC353924	1
3	VN79771219	1

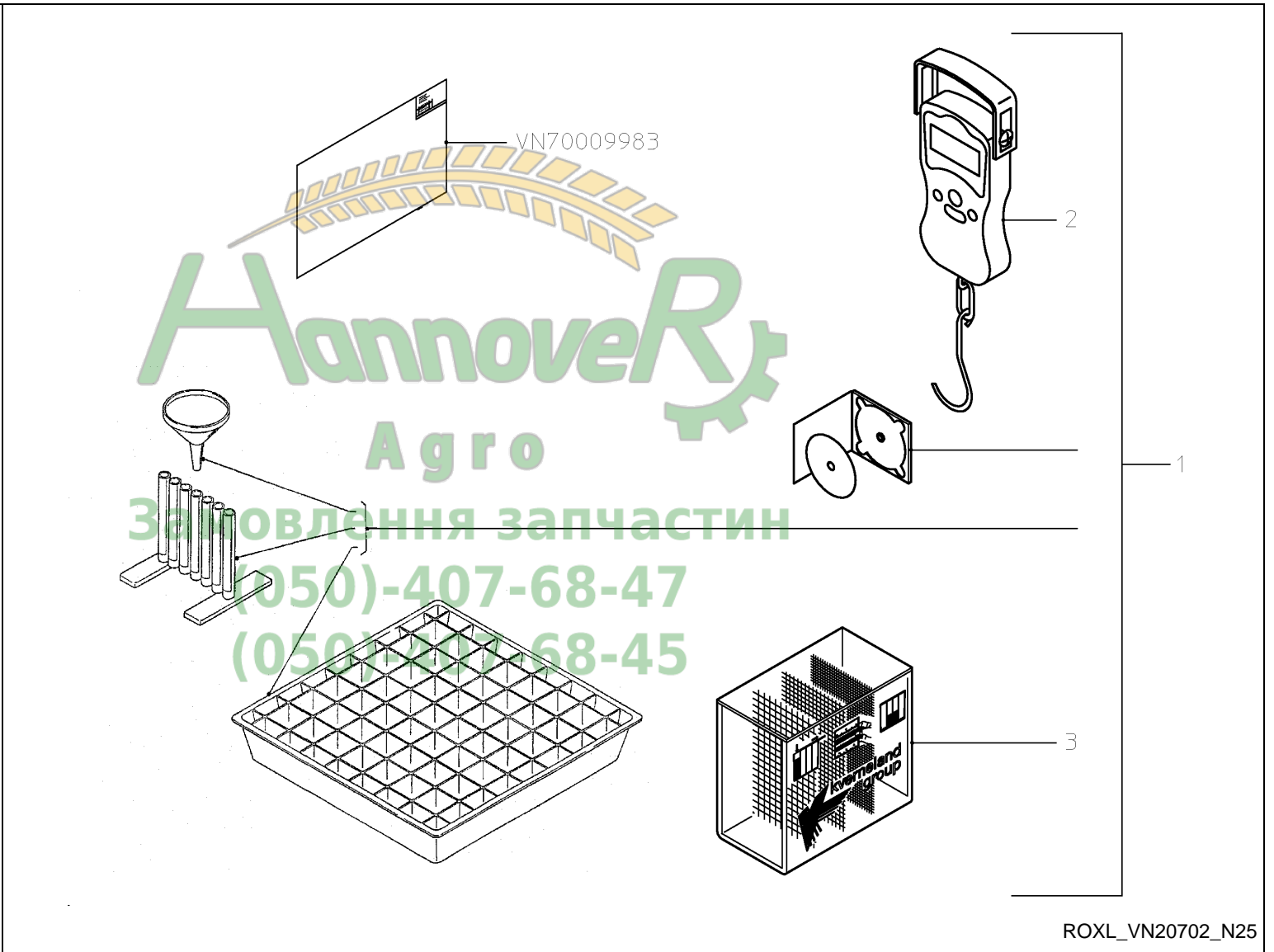

ROXL_VN20702_N25

RO-XL / HOSE SET

PosNo.	Part No.	Qty.
1	VNB4253278	2
2	AC351803	1
5	RG00048610	2
6	VN38854586	2
7	VNB4297802	4
11	VN31419900	2
12	VN17895704	1
13	VN38820225	1
14	VNB3083893	1
15	VNB1306893	1

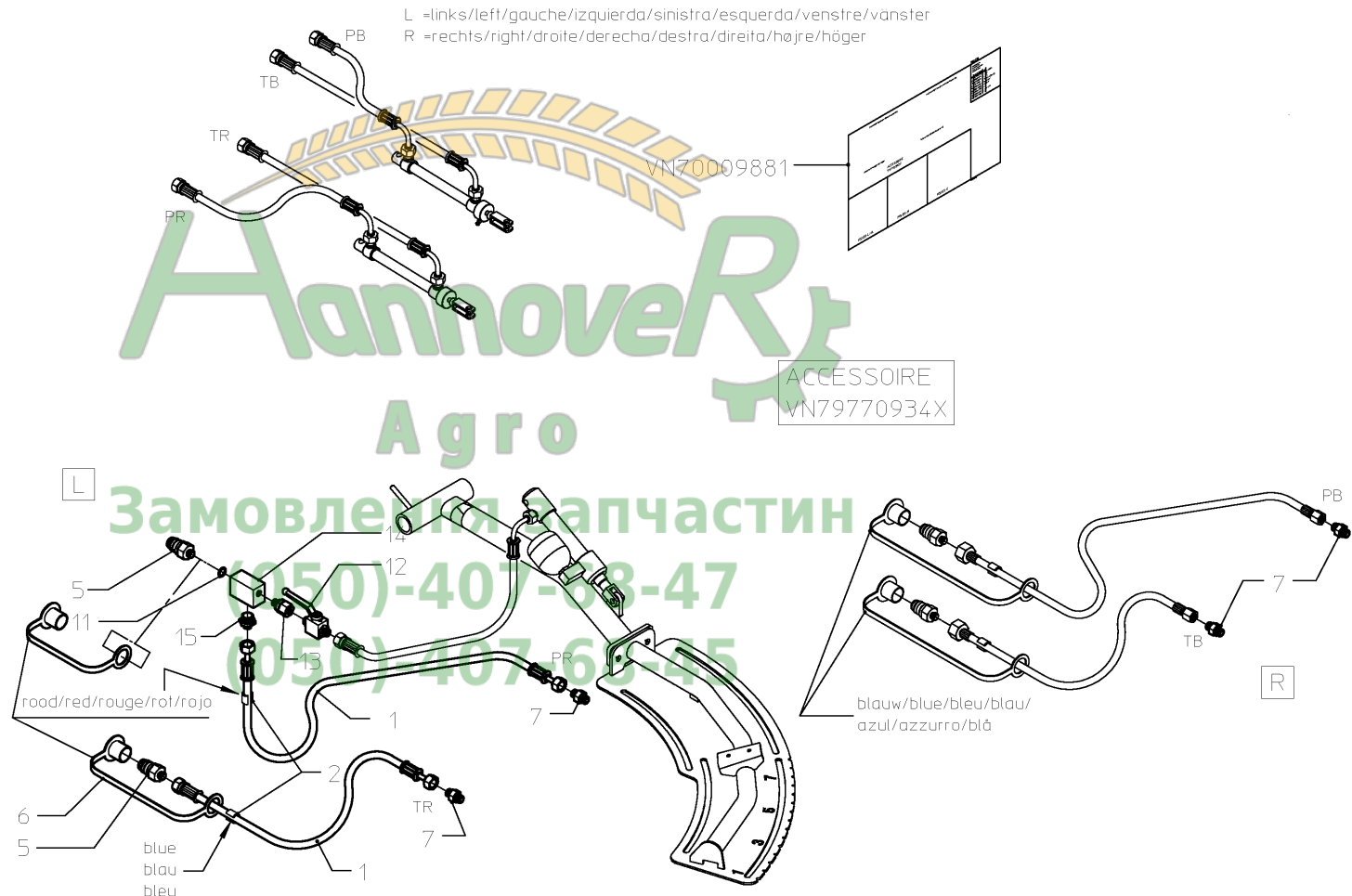

RO-XL / 2X2 DIRECTION TAP SET

PosNo.	Part No.	Qty.
1	VNB1840194	1
2	VNB0854378	1
3	KG00501000	2
4	VN30598012	2
5	KG00498500	1
6	VNB1308693	1
8	VN38820225	2
9	VN38820194	1
10	VN17895704	1
11	VN17895703	1
12	VNB4297378	2
15	VN80504001	4
16	VNB1727574	1
18	VNB4297802	2
19	KG01264100	2

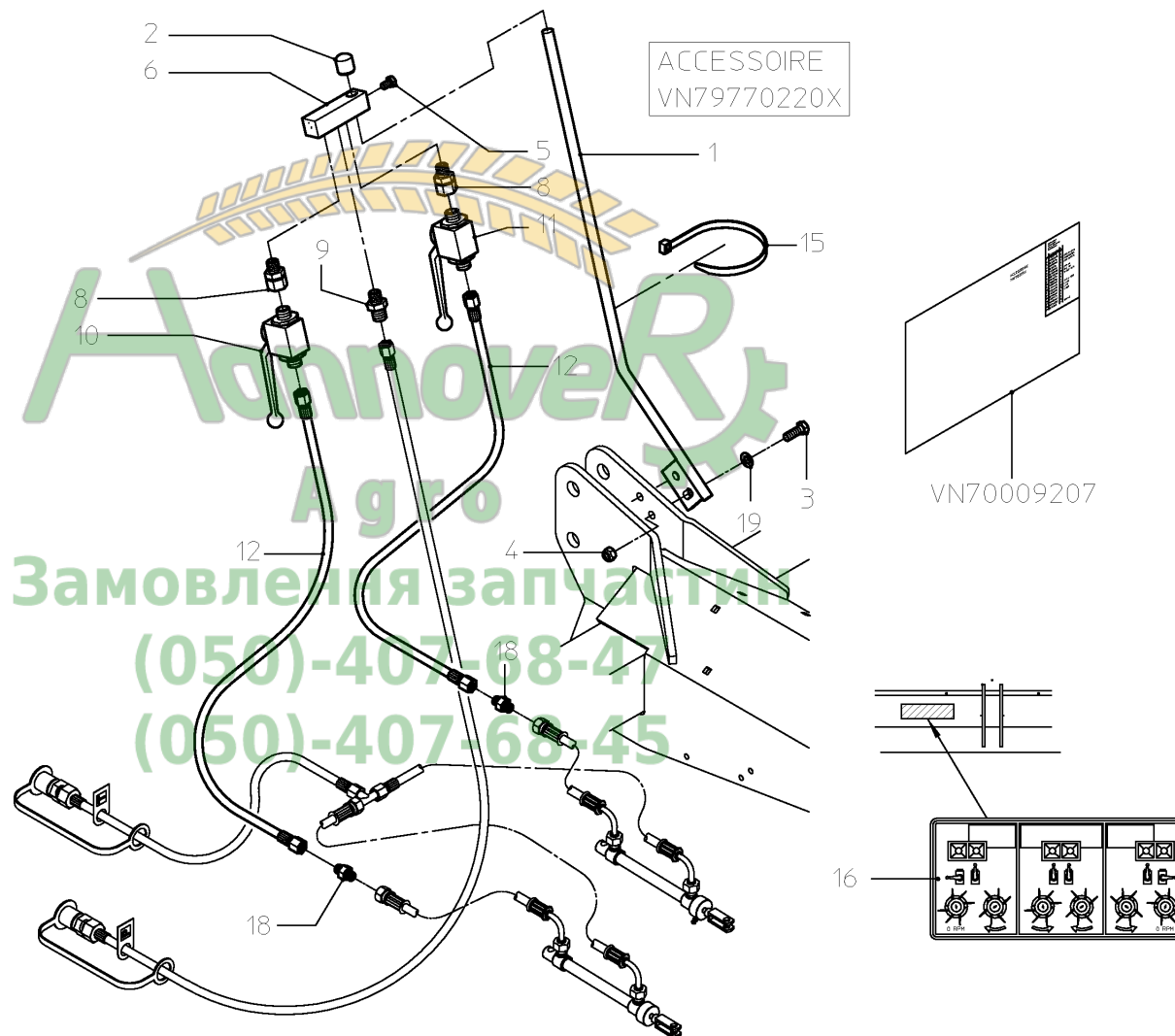

ROXL_VN20702_N27

RO-XL / SPREADING DISC RPM SENSOR SET



PosNo.	Part No.	Qty.
1	VNB0266873	1
2	KG01069900	2
3	VNB4256202	1
4	KG00496900	2
5	VN31903304	1
6	VN80504001	3
7	VN80504003	3
9	KG01263900	2

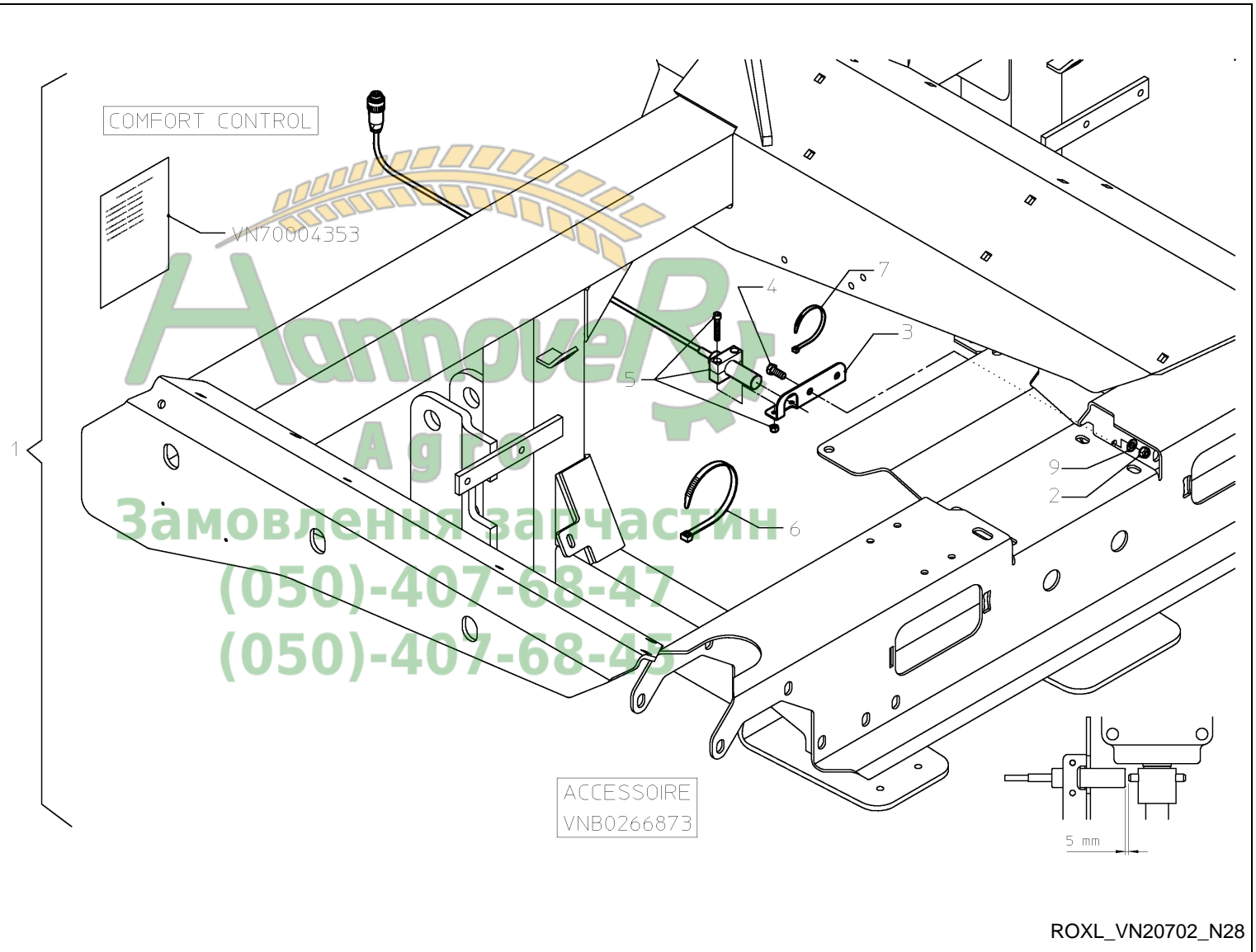

RO-XL / WHEELRINGS



PosNo.	Part No.	Qty.
3	VNB1517586	1
4	KG00872200	4
5	VNB1153493	4
7	KG01263900	4
8	KG01069900	4
9	VNB2928086	2
10	KG00871700	2

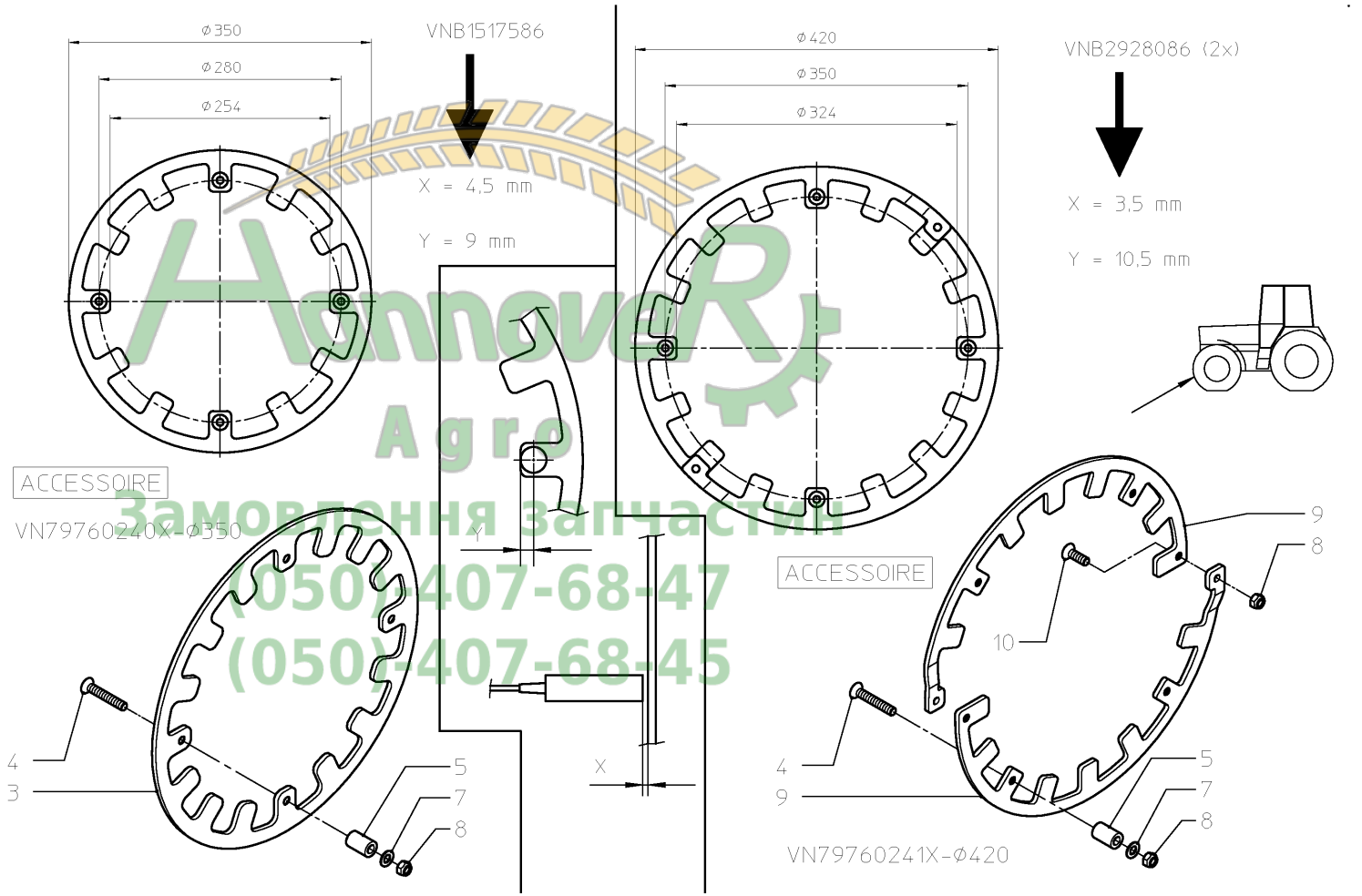

RO-XL / SENSORS AND CABLES

PosNo.	Part No.	Qty.
11	VNB0304073	1
12	VNB0326573	1
15	VNB0430273	1

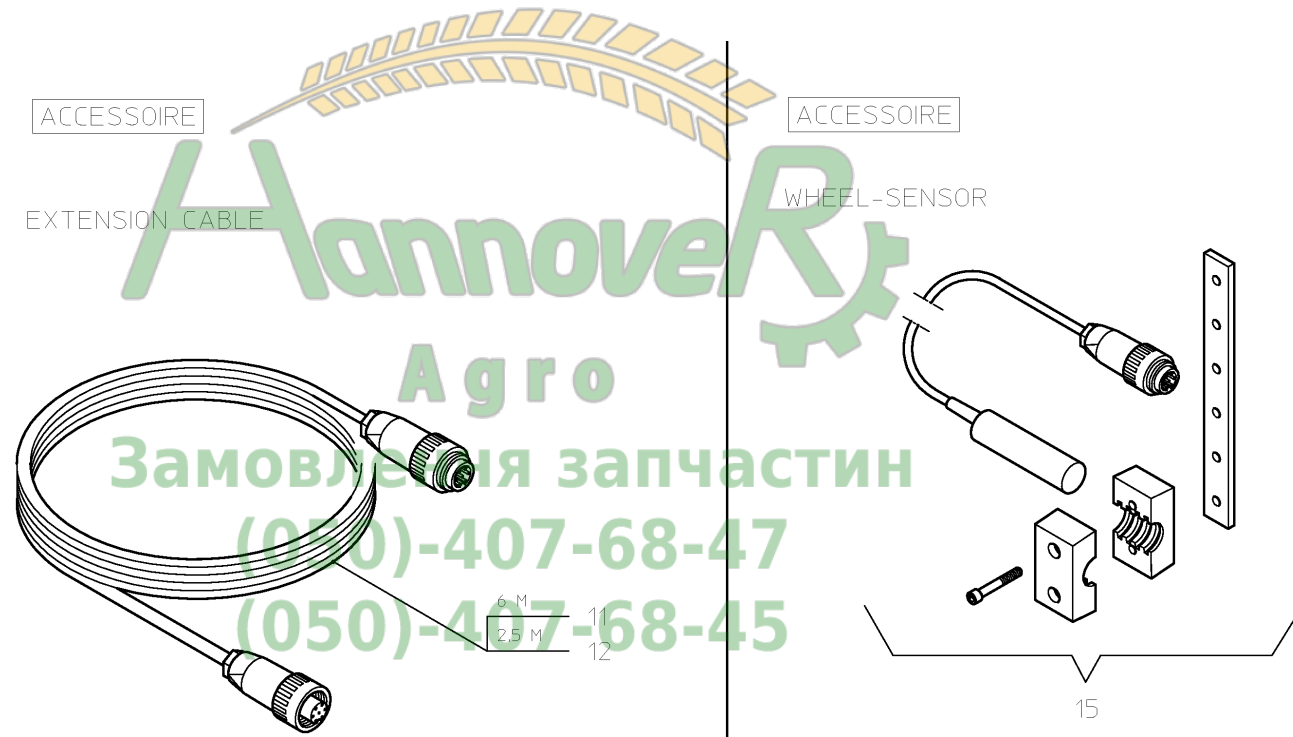

Hannover
 Agro
 Заповнення запчастин
 (050)-407-68-47
 (050)-407-68-45

RO-XL / RADARCABLES



PosNo.	Part No.	Qty.
1	VNB0303973	1
4	VNB0305973	1
5	VNB0386773	1
6	VNB0540173	1
7	VNB0391073	1

CABLE FOR RADAR SENSOR TRACTOR

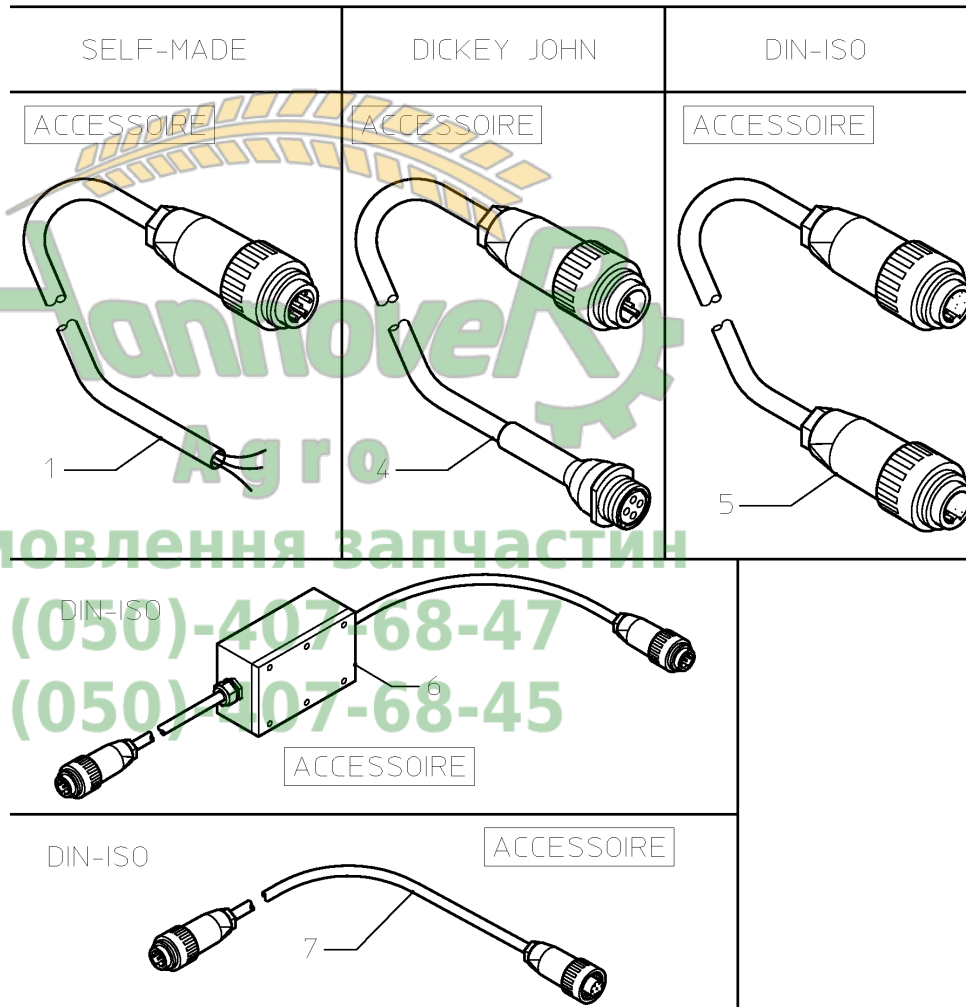

Антонов
Агро
Замовлення запчастин
(050)-407-68-47
(050)-407-68-45

ROXL_VN20702_N31

RO-XL / Part No Index



Part No.	Page	Pos No	Part No.	Page	Pos No	Part No.	Page	Pos No	Part No.	Page	Pos No
AC351803	10	14	KG00499500	8	11	KG00870000	8	27	KG01069900	1	16
AC351803	30	2	KG00500900	1	6	KG00870200	8	9	KG01069900	3	4
AC353924	29	2	KG00501000	2	6	KG00870200	23	4	KG01069900	4	20
KG00397100	24	10	KG00501000	31	3	KG00871700	33	10	KG01069900	5	20
KG00399400	7	19	KG00501100	1	10	KG00872200	33	4	KG01069900	7	14
KG00399800	7	7	KG00562400	8	25	KG00945900	12	4	KG01069900	9	12
KG00493700	25	18	KG00565700	9	11	KG01044900	8	14	KG01069900	10	5
KG00494900	3	12	KG00652900	19	4	KG01053400	6	8	KG01069900	12	7
KG00495100	25	13	KG00652900	20	4	KG01053500	19	6	KG01069900	19	7
KG00495200	1	19	KG00654400	4	10	KG01053500	20	6	KG01069900	20	7
KG00495200	10	31	KG00654400	5	10	KG01053700	19	1	KG01069900	23	7
KG00495200	27	7	KG00654400	23	2	KG01053700	20	1	KG01069900	24	13
KG00495300	25	5	KG00654400	26	7	KG01053800	4	9	KG01069900	27	19
KG00496900	24	11	KG00679700	10	34	KG01053800	5	9	KG01069900	32	2
KG00496900	26	2	KG00679900	21	2	KG01053800	8	13	KG01069900	33	8
KG00496900	32	4	KG00712600	19	9	KG01059600	3	13	KG01070000	2	19
KG00497100	4	17	KG00712600	20	9	KG01059600	25	4	KG01070000	4	7
KG00497100	5	17	KG00714100	6	13	KG01059700	24	16	KG01070000	5	7
KG00497100	23	1	KG00738100	8	2	KG01059700	26	3	KG01070000	10	8
KG00497100	27	17	KG00738100	19	3	KG01069600	19	30	KG01070000	12	10
KG00497200	19	27	KG00738100	20	3	KG01069600	20	30	KG01070000	24	14
KG00497200	20	27	KG00738100	21	12	KG01069700	23	5	KG01070000	27	4
KG00497600	19	26	KG00738300	21	6	KG01069700	25	20	KG01070100	1	7
KG00497600	20	26	KG00739400	2	14	KG01069700	27	25	KG01070100	2	7
KG00498500	31	5	KG00739600	7	9	KG01069800	1	21	KG01070100	7	4
KG00498700	2	17	KG00739600	19	5	KG01069800	4	23	KG01107862	8	24
KG00498700	4	5	KG00739600	20	5	KG01069800	5	23	KG01192062	13	24
KG00498700	5	5	KG00747600	8	38	KG01069800	8	10	KG01263600	19	28
KG00498700	10	6	KG00803400	10	28	KG01069800	10	33	KG01263600	20	28
KG00498700	12	8	KG00868600	23	3	KG01069800	21	10	KG01263600	21	3
KG00498700	27	6	KG00868600	27	39	KG01069800	23	6	KG01263900	2	15
KG00498800	9	6	KG00870000	4	22	KG01069800	25	14	KG01263900	7	13
KG00498800	27	8	KG00870000	5	22	KG01069800	27	36	KG01263900	19	2

RO-XL / Part No Index



Part No.	Page	Pos No	Part No.	Page	Pos No	Part No.	Page	Pos No	Part No.	Page	Pos No
KG01263900	20	2	KG01901500	12	9	VN17856588	26	5	VN46120092	13	1
KG01263900	27	18	KG01901500	19	8	VN17856588	27	3	VN48101007	6	3
KG01263900	32	9	KG01901500	20	8	VN17895703	31	11	VN48523001	6	5
KG01263900	33	7	KG01901500	27	35	VN17895704	30	12	VN48523002	6	4
KG01264000	2	18	KG01901600	1	9	VN17895704	31	10	VN79771219	9	28
KG01264000	4	6	RG00040217	19	21	VN30105400	21	4	VN79771219	29	3
KG01264000	5	6	RG00040217	20	21	VN30117100	4	8	VN79771400	29	1
KG01264000	10	36	RG00040217	25	12	VN30117100	5	8	VN79771437	27	37
KG01264000	21	9	RG00048610	10	16	VN30117100	8	12	VN80504001	6	11
KG01264000	27	5	RG00048610	27	27	VN30117100	27	22	VN80504001	10	11
KG01264100	2	9	RG00048610	30	5	VN30128821	1	14	VN80504001	12	11
KG01264100	7	2	RG00050664	7	40	VN30128821	3	2	VN80504001	31	15
KG01264100	31	19	VG10.01.00	13	21	VN30130800	9	16	VN80504001	32	6
KG01283000	6	7	VG10.48.00	13	23	VN30130800	12	5	VN80504003	6	10
KG01283000	8	33	VG10.49.00	13	27	VN30130800	27	21	VN80504003	27	20
KG01283300	9	17	VG10.83.40	13	11	VN30143310	4	13	VN80504003	32	7
KG01421400	8	21	VG365305	13	53	VN30143310	5	13	VN90007711	27	29
KG01901100	10	35	VG56.117.19	13	13	VN30143310	25	16	VNB0266873	32	1
KG01901200	25	19	VG75.02.15	13	25	VN30598012	31	4	VNB0303973	35	1
KG01901300	1	20	VG75.06.15	13	26	VN31419900	27	28	VNB0304073	34	11
KG01901300	10	13	VG82.36.03	13	55	VN31419900	30	11	VNB0305973	35	4
KG01901300	21	14	VG83.09.01	13	51	VN31903304	32	5	VNB0326573	34	12
KG01901300	27	31	VG83.10.03	13	54	VN36107317	12	3	VNB0341273	6	12
KG01901400	3	3	VG85.004	13	5	VN36112005	8	19	VNB0374873	11	3
KG01901400	4	18	VG85.005	13	4	VN36112032	9	15	VNB0386773	35	5
KG01901400	5	18	VG85.05.06	13	52	VN37601011	1	15	VNB0391073	35	7
KG01901400	19	10	VGAGRASET173	13	12	VN37601015	2	5	VNB0430273	34	15
KG01901400	20	10	VGAGRASET207	13	90	VN38820194	31	9	VNB0540173	35	6
KG01901400	23	8	VGND98026V	13	22	VN38820225	30	13	VNB0548173	11	2
KG01901400	24	15	VGTR2023	25	22	VN38820225	31	8	VNB0550373	12	17
KG01901500	4	24	VGTR2059	19	22	VN38854581	10	17	VNB0563773	11	1
KG01901500	5	24	VGTR2059	20	22	VN38854581	27	26	VNB0566173	12	19
KG01901500	10	7	VGTR2059	27	33	VN38854586	30	6	VNB0682993	7	21

RO-XL / Part No Index



Part No.	Page	Pos No	Part No.	Page	Pos No	Part No.	Page	Pos No	Part No.	Page	Pos No
VNB0765193	1	13	VNB2092402	19	11	VNB3588478	7	26	VNB3958278	8	34
VNB0765393	24	1	VNB2092402	20	11	VNB3602694	19	13	VNB3962278	10	29
VNB0854378	31	2	VNB2235978	12	18	VNB3602694	20	13	VNB3962378	10	30
VNB0870178	1	4	VNB2332694	1	8	VNB3602794	19	14	VNB3967598	8	16
VNB0897393	1	3	VNB2417578	7	11	VNB3602794	20	14	VNB3967698	8	17
VNB1060002	9	14	VNB2417602	7	12	VNB3603194	19	15	VNB3969702	8	4
VNB1082102	9	13	VNB2760978	4	12	VNB3603194	20	15	VNB3969802	8	5
VNB1082102	22	1	VNB2760978	5	12	VNB3603394	19	17	VNB3970002	8	37
VNB1100802	25	17	VNB2760978	25	15	VNB3603394	20	17	VNB3984186	17	3
VNB1153493	33	5	VNB2822600	14	18	VNB3603594	19	19	VNB3984186	18	3
VNB1181374	9	4	VNB2928086	33	9	VNB3603594	20	19	VNB4008194	27	10
VNB1181374	14	11	VNB3083893	30	14	VNB3620578	6	6	VNB4011494	27	13
VNB1194874	9	2	VNB3085978	27	15	VNB3707494	19	31	VNB4014778	17	5
VNB1194874	14	10	VNB3317278	8	1	VNB3708094	19	18	VNB4014778	18	5
VNB1306893	30	15	VNB3317378	12	2	VNB3708094	20	18	VNB4023502	8	23
VNB1308693	31	6	VNB3322494	10	1	VNB3708174	25	21	VNB4042498	8	29
VNB1380878	24	2	VNB3388365	9	5	VNB3717802	9	10	VNB4042598	8	30
VNB1402486	24	3	VNB3388402	9	7	VNB3770294	24	5	VNB4042702	8	15
VNB1517586	33	3	VNB3414002	9	1	VNB3843994	24	6	VNB4053074	14	1
VNB1599794	1	2	VNB3414102	9	3	VNB3872902	11	4	VNB4053474	17	6
VNB1599994	1	12	VNB3428094	26	4	VNB3876594	24	8	VNB4053474	18	6
VNB1709302	28	17	VNB3428494	26	1	VNB3876694	24	9	VNB4059402	8	31
VNB1727574	31	16	VNB3428594	26	6	VNB3910902	7	41	VNB4060978	8	20
VNB1754278	28	18	VNB3443478	19	12	VNB3913093	27	16	VNB4061702	8	3
VNB1840194	31	1	VNB3443478	20	12	VNB3957302	8	6	VNB4061978	8	32
VNB1907978	24	4	VNB3444974	14	7	VNB3957402	8	7	VNB4063078	12	13
VNB2003102	1	11	VNB3447178	19	29	VNB3957502	8	26	VNB4063178	12	14
VNB2003294	1	17	VNB3447178	20	29	VNB3957678	10	21	VNB4064878	7	5
VNB2003302	1	18	VNB3452378	6	20	VNB3957778	10	20	VNB4064978	7	6
VNB2003302	10	19	VNB3452478	6	19	VNB3957878	10	23	VNB4073178	8	8
VNB2003302	27	23	VNB3550678	7	23	VNB3957978	10	24	VNB4077378	8	39
VNB2068778	4	11	VNB3559902	8	28	VNB3958078	10	25	VNB4077402	1	5
VNB2068778	5	11	VNB3588378	7	25	VNB3958178	10	26	VNB4077502	9	8

RO-XL / Part No Index



Part No.	Page	Pos No	Part No.	Page	Pos No	Part No.	Page	Pos No	Part No.	Page	Pos No
VNB4077602	9	9	VNB4297478	27	24	VNB4377474	14	13	VNB4668593	7	10
VNB4079778	19	32	VNB4297702	10	10	VNB4377474	15	16	VNB4675502	17	2
VNB4105274	14	2	VNB4297802	30	7	VNB4377574	14	14	VNB4675502	18	2
VNB4105474	14	8	VNB4297802	31	18	VNB4377574	15	17	VNB4675602	17	1
VNB4105674	14	12	VNB4306794	19	23	VNB4381202	3	14	VNB4675702	18	1
VNB4218178	17	4	VNB4306794	20	23	VNB4381302	3	15	VNB4692078	6	1
VNB4218178	18	4	VNB4306894	19	24	VNB4381694	10	18	VNB4713902	12	1
VNB4225402	8	22	VNB4306894	20	24	VNB4407802	21	1	VNB4743202	10	37
VNB4239578	10	32	VNB4306994	19	16	VNB4408202	21	5	VNB4743378	23	17
VNB4239578	27	34	VNB4306994	20	16	VNB4408302	21	13	VNB4743378	27	40
VNB4239702	8	18	VNB4309102	19	25	VNB4423078	10	2	VNB4769365	22	2
VNB4253078	2	2	VNB4309102	20	25	VNB4423502	21	7	VNB4769578	27	32
VNB4253278	10	12	VNB4319078	4	14	VNB4442278	23	9	VNB4780478	3	16
VNB4253278	30	1	VNB4319078	5	14	VNB4450578	23	10	VNB4808502	12	6
VNB4255678	6	9	VNB4328594	5	1	VNB4451002	21	8	VNB4808502	27	12
VNB4256202	32	3	VNB4332094	25	11	VNB4451194	23	11	VNB4808602	10	3
VNB4261394	4	1	VNB4332194	25	10	VNB4451294	23	12	VNB4808702	10	4
VNB4270602	4	19	VNB4332994	25	2	VNB4451394	23	13	VNB4808802	27	11
VNB4270602	5	19	VNB4334578	21	11	VNB4451494	23	14			
VNB4277086	1	1	VNB4334578	25	3	VNB4451978	23	15			
VNB4277786	4	2	VNB4341978	7	18	VNB4466478	7	22			
VNB4277786	5	2	VNB4344486	2	1	VNB4466678	7	38			
VNB4277994	4	3	VNB4347993	7	15	VNB4473502	23	16			
VNB4277994	5	3	VNB4348193	7	17	VNB4482694	27	2			
VNB4278094	4	4	VNB4348393	7	16	VNB4487278	19	20			
VNB4278094	5	4	VNB4348493	7	36	VNB4487278	20	20			
VNB4283878	20	32	VNB4366374	14	9	VNB4493474	14	4			
VNB4288302	27	14	VNB4372394	27	9	VNB4580502	27	1			
VNB4288402	27	30	VNB4373494	20	31	VNB4627578	4	21			
VNB4292878	10	22	VNB4376594	24	7	VNB4627578	5	21			
VNB4292978	10	27	VNB4376974	14	5	VNB4627794	4	16			
VNB4297178	10	9	VNB4377074	14	3	VNB4627794	5	16			
VNB4297378	31	12	VNB4377174	14	6	VNB4630594	2	11			

AANHAALMOMENTEN / TORQUES / ANZUGSMOMENTE / COUPLES DE SERRAGE / PARES DE APRIETE / MOMENTI DI TORSIONE / BINÁRIOS DE APERTO / TILSTRAMMINGSMOMENTER / TILSPÆNDINGSMOMENTER

NL Richtlijnen voor aanhaalmomenten (in Nm) voor zelfborgende moeren, zeskantbouten en moeren.
DE Richtlinien für Anzugsmomente (in Nm) für selbstsichernde Muttern, Sechskantschrauben und -mutter.
ES Directrices para los pares de apriete (en Nm) para las tuercas autoblocantes, los tornillos hexagonales y las tuercas.
IT Direttive per momenti di torsione (espressi in Nm) per dadi autobloccanti, bulloni esagonali e dadi.
NO Retningslinjer for tilstrammingsmomenter (i Nm) for selvlåsende muttere, sekskantbolter og muttere.

EN Guidelines for torques (in Nm) for self-locking nuts, hexagon bolts and nuts.
FR Directives pour les couples de serrage (en Nm) pour écrous à autobloquants, boulons à six pans et écrous.
PT Directrizes para os binários de aperto (em Nm) para porcas autobloqueadoras, parafusos hexagonais e porcas.
DA Retningslinier for tilspændingsmomenter (i Nm) for selvlåsende møtrikker, sekskantbolte og møtrikker.

Kwaliteit / Quality / Qualität / Qualité / Calidad / Qualidade / Qualità / Kvalitet	4.6		8.8		10.9		12.9	
	0,10	0,13	0,10	0,13	0,10	0,13	0,10	0,13
Wrijving / Friction / Reibung / Fricción / Atrito / Attrito / Friktion /Friksjon *								
Schroefdraad / Thread / Gewinde / Filetage Rosca / Filettatura / Gevind / Skruegjenge								
M5	1,7	2	5	6	7	9	8	10
M6	3	4	9	10	13	15	15	18
M8	8	9	21	25	31	36	36	42
M10	16	19	40	50	60	70	70	85
M12	27	32	70	85	105	120	120	145
M14	42	50	115	135	165	195	195	230
M16	65	76	175	210	260	300	300	350
M18	90	110	250	290	350	420	410	490
M20	125	150	350	420	500	600	580	700
M22	170	200	470	560	670	800	780	930
M24	210	250	600	710	860	1020	1000	1180

- * **NL** De wrijvingscoëfficiënt van 0,10 geldt voor geoliede plaat, gietijzer, geharde vlakken, vette schroefdraad, etc. De hogere waarde van 0,13 geldt voor een droge plaat. Uitzonderingen op deze tabel zijn vermeld in het onderdelen- en/of instructieboek. Aanhaalmomenten voor bouten en moeren met gekartelde onderkant, zoals Tensilock en Whizlock, 10% extra.
- * **EN** The friction coefficient of 0.10 applies to oiled sheet, cast iron, hardened surfaces, greasy thread, etc. The higher value of 0.13 applies to dry sheet. Exceptions to this table are stated in the parts- and /or instruction manual. Torques for bolts and nuts with a knurled underside, like Tensilock and Whizlock, 10% extra.
- * **DE** Der Reibungskoeffizient von 0,10 gilt für geölte Flächen, Gußeisen, gehärtete Flächen, gefettetes Gewinde usw. Der höhere Wert von 0,13 gilt für trockene Flächen. Ausnahmen zu dieser Tabelle sind im Ersatzteilhft und/oder in der Betriebsanleitung. Anzugsmomente für Schrauben und Muttern mit gerändelter Unterseite, wie Tensilock und Whizlock, zuzüglich 10% extra.
- * **FR** Le coefficient de frottement de 0,10 s'applique aux surfaces huilées, à la fonte, aux surfaces trempées, aux filetages graissés etc. Le coefficient de 0,13 aux surfaces sèches. Les exceptions à se tableau sont mentionnées dans la nomenclature des pièces et/ou dans le manuel d'emploi. Ajoutez 10% pour les boulons et écrous à partie inférieure crénelée, comme les Tensilock et les Whizlock.
- * **ES** El coeficiente de fricción de 0,10 es indicado para planchas lubricadas, hierro fundido, superficies endurecidas, rosca grasienta, etc. El valor más alto de 0,13 es para planchas secas. Las excepciones a este cuadro se mencionan en el libro de repuestos y/o manual de instrucciones. Los pares de apriete para tonillos y tuercas con cara inferior dentada, como los Tensilock y Whizlock, 10% extra.
- * **PT** O coeficiente de atrito de 0.10 aplica-se às superfícies olcadas, ao ferro fundodo, às superfícies temperadas, às roscas emassadas etc. O coeficiente de 0.13 às superfícies secas. As excepções a este quadro estão mencionadas na nomenclatura das peças e/ou no manual de instruções. Os binários de aperto para porcas e parafusos cujas bases sejam serradas (Tensilock, Whizlock) devem ser aumentados em 10%.
- * **IT** Il coefficiente di frizione pari a 0,10 si riferisce a superfici oliate, alla ghisa, a superfici temprate, a filettature spesse ecc. Il valore più alto, npari a 0,13, si riferisce a superfici asciutte. Tutte le eccezioni a quanto riportato in questa tabella, si trovano nel libretto dei pezzi o nel libretto delle istruzioni. I momenti torcenti per bulloni e dadi la cui parte inferiore è zigrinata, come i Tensilock (K 100) e Whizlock, sono superiori del 10%.
- * **DA** Friktionskoefficienten på 0,10 gælder for smurte flader, støbejern, hærkede overflader, fedtholdige gevind etc. Den højere værdi på 0,13 gælder for tørre flader. Undtagelser til tabellen er angivet i reservedels- og/eller instruktionsbog. Når det drejer sig om momenter for bolte og møtrikkers med en riflet underside, som Tensilock (K100) og Whizlock, skal der tilføjes 10% ekstra.
- * **NO** Friksjonskoeffisenten på 0,10 gjelder for smurt plate, støpejern, herdede flater, innfettete gjenger etc. Den høyere verdien på 0,13 gjelder for tørr plate. Unntak fra denne tabellen er angitt i deleboken og/eller i instruksjonsboken. Tiltrekkingsmomenter for skruer og mutre med riflet underkant, som Tensilock (K100) og Whizlock 10% tillegg.

VRIDMOMENT / MOMENTY OBROTOWE / UTAHOVACÍ MOMENTY / МОМЕНТ ЗАТЯГИВАНИЯ / PRIVIJALNI MOMENTI / MEGHÚZÁSI NYOMATÉKOK

SV Anvisningar för vridmoment (i Nm) för självläsande muttrar, sexkantiga bultar och muttrar.

CS Směrnice pro utahovací momenty (v Nm) pro samosvorné matice, šrouby a matice s šestihran hlavou

SL Navodila za privijalne (navorne) momente (v Nm) za matice in vijake.

PL Wytyczne dotyczące momentów obrotowych (w Nm) nakrętek samozabezpieczających, śrub z łbem sześciokątnym i nakrętek.

RU Указания для моментов затягивая (в Nm) для самоблокирующихся гаек, шестигранных болтов и гаек.

HU Előírt meghúzási nyomatékok (Nm-ben) az önzáró anyákhoz, hatlapfejű csavarokhoz és anyákhoz.

Kvalitet / Jakość / Jakost / Качество / Kvaliteta / Minőség	4.6		8.8		10.9		12.9	
Friktion / Tarcie / Třeni / Трение / Trenje / Súrúldás *	0,10	0,13	0,10	0,13	0,10	0,13	0,10	0,13
Gänga / Gwint / Závit / Резьба								
Navoj / Menet								
M5	1,7	2	5	6	7	9	8	10
M6	3	4	9	10	13	15	15	18
M8	8	9	21	25	31	36	36	42
M10	16	19	40	50	60	70	70	85
M12	27	32	70	85	105	120	120	145
M14	42	50	115	135	165	195	195	230
M16	65	76	175	210	260	300	300	350
M18	90	110	250	290	350	420	410	490
M20	125	150	350	420	500	600	580	700
M22	170	200	470	560	670	800	780	930
M24	210	250	600	710	860	1020	1000	1180

* **SV** Friktionskoefficienten 0,10 gäller oljad plåt, gjutjärn, härdade ytor, smorda gängor etc. Det högre värdet 0,13 gäller torr plåt. Undantag från denna tabell anges i reservdels- och/eller instruktionsboken. Åtdragningsmoment för räfflade bultar och muttrar, som Tensilock och Whizlock 10% extra.

* **PL** Współczynnik tarcia 0,10 dotyczy płyty oliwonej, żeliwa, powierzchni hartowanych, nasmarowanych gwintów, itp. Wyższy współczynnik 0,13 dotyczy płyty suchej. Wyjątki od niniejszej tabeli podano w katalogu części i/lub instrukcji. Momenty obrotowe zwiększają się o dodatkowe 10% w przypadku śrub i nakrętek z radełkowanym spodem, jak na przykład, Tensilock (K100) o Whizlock.

* **CS** Koeficient třeni 0.10 platí pro naolejovaný plech, litinu, kalené povrchy, namazaný závit a tak dále. Vyšší hodnota 0.13 platí pro suchý plech. Výjimky z této tabulky jsou uvedeny v seznamu náhradních dílů a/nebo v provozním návodu. Utahovací momenty pro šrouby a matice s rýhovanou spodní stranou 10% navíc, jako např. Tensilock (K100), Whizlock.

* **RU** Коэффициент трения в 0,10 относится к смазанным плитам, чугуны, затвердевшим поверхностям резьбе с нанесенной смазкой и т.д. Более высокое значение в 0,13 относится к сухим плитам. Исключения для данной таблицы указаны в брошюре с описанием рабочих деталей и/или инструкции по эксплуатации. Моменты затягивания для болтов и гаек с зазубренной стороной выше на 10% для таких как, Tensilock (k 100) и Whizlock.

* **SL** Koeficient trenja 0,10 velja za naoljene površine, litino, kovane površine, namazane navoje itd. Višja vrednost 0,13 velja za suhe površine. Izjeme v tej tabeli so v zvezku rezervnih delov ali pa v navodilu o uporabi navedene. Navornim momentom za vijake in matice z naribano spodnjo površino, kot so Tensilock (K100) in Whizlock, dodamo 10%.

* **HU** A 0,10 súrlódási tényező az olajozott lemezekre, öntöttvasra, edzett felületekre, zsírozott menetre, stb alkalmazható. A 0,13 asmagasabb érték a száraz lemezekre alkalmazható. E táblázat alól kivételt képező tételek az alkatrészeknél és/vagy a gépkönyvekben vannak felsorolva. A meghúzási nyomaték az alsó peremen bordázott csavarok és anyák esetében 10%-kal nagyobb, pl. Tensilock (K100) és Whizlock.



RO-XL

01987 < Mach. ID <=

Kverneland Group Nieuw-Venep
Kverneland Group Nieuw-Venep BV
Hoofdweg 1278
2153 LR Nieuw-Venep
Netherlands
+31 252 662244
+31 252 662173



Замовлення запчастин

(050)-407-68-47

(050)-407-68-45

© Kverneland Group

All rights reserved. No parts of this book may be reproduced, stored in a database or retrieval system, or published in any form or in any way, electronically, mechanically, optically, by print, photo print, microfilm (including micro and macro fiche), or any other means, including all video and CD systems, without prior written permission from the publisher.

Print date: 2011-08-23

