



Агро
Замовлення запчастин
RO-M GEO
(050)-407-68-47
(050)-407-68-45

Spare Parts Manual

Article number:	A138376840
Language:	EN
Production year (from):	2016
Prod. Series nr (from):	VN25700
01001 < Mach. ID <=	



Замовлення запчастин

(050)-407-68-47

(050)-407-68-45



RO-M GEO / Table of Contents

PosNo.	Assembly group	Page
1	FRAME	1
2	PROTECTION	2
2	PROTECTION	3
3	PROTECTION	4
3	HOPPER AND SIEVE	5
5	DRIVE	6
6	DOSAGE	7
6	DOSAGE	8
7	DISC, BROADCASTER	9
8	CONTROL, ISO	10
8	CONTROL, ISO	11
12	UNIV. JOINT SHAFT	12
13	DECAL SCHEMATIC ISO (EU/OTHERS)	13
13	DECAL SCHEMATIC ISO (FRANCE)	14
99	HOPPER EXTENSION	15
99	TARPAULIN	16
99	TARPAULIN	17
99	LIGHTING EU/OTHERS	18
99	WARNING TRIANGLE SMV	19
99	HOPPER EMPTYING SET	20
99	LADDERSET	21
99	WHEELSET	22
99	CALIBRATION CONTAINER	23
99	BOUNDARY SPREADING PLATE (2)	24
99	TRIMFLOW	25
99	ELECTRONICS	26
99	28 M/92 FT KIT	27
99	FEELER GAUGE	28
99	SPREADING PATTERN CONTROLSET	29
99	WHEELRINGS	30
99	GPS SPEED SENSOR	31

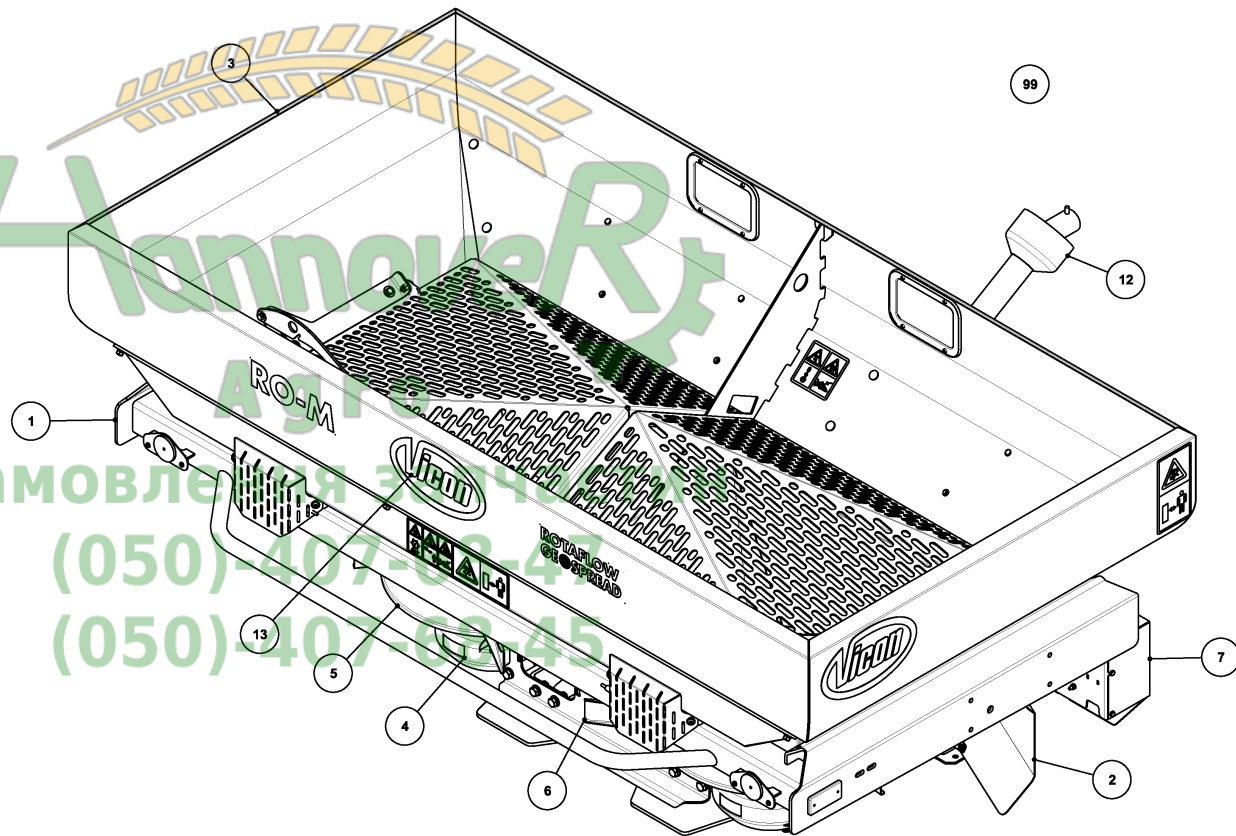

SPHV001692_2/01.001
VNH1000/01.001

RO-M GEO / FRAME



PosNo.	Part No.	Qty.
1	A138227886	1
2	A138369802	2
3	KG00500900	2
4	KG00501100	1
5	KG00738100	4
6	KG01059600	4
7	KG01070100	3
8	KG01901600	2
9	VN37601011	2
10	VN37601015	2
11	VN46120101	1
12	VNB0765193	2
13	VNB0870178	1
14	VNB0897393	1
15	VNB1599786	1
16	VNB1599986	2
17	VNB2332686	1
18	VNB3358786	1

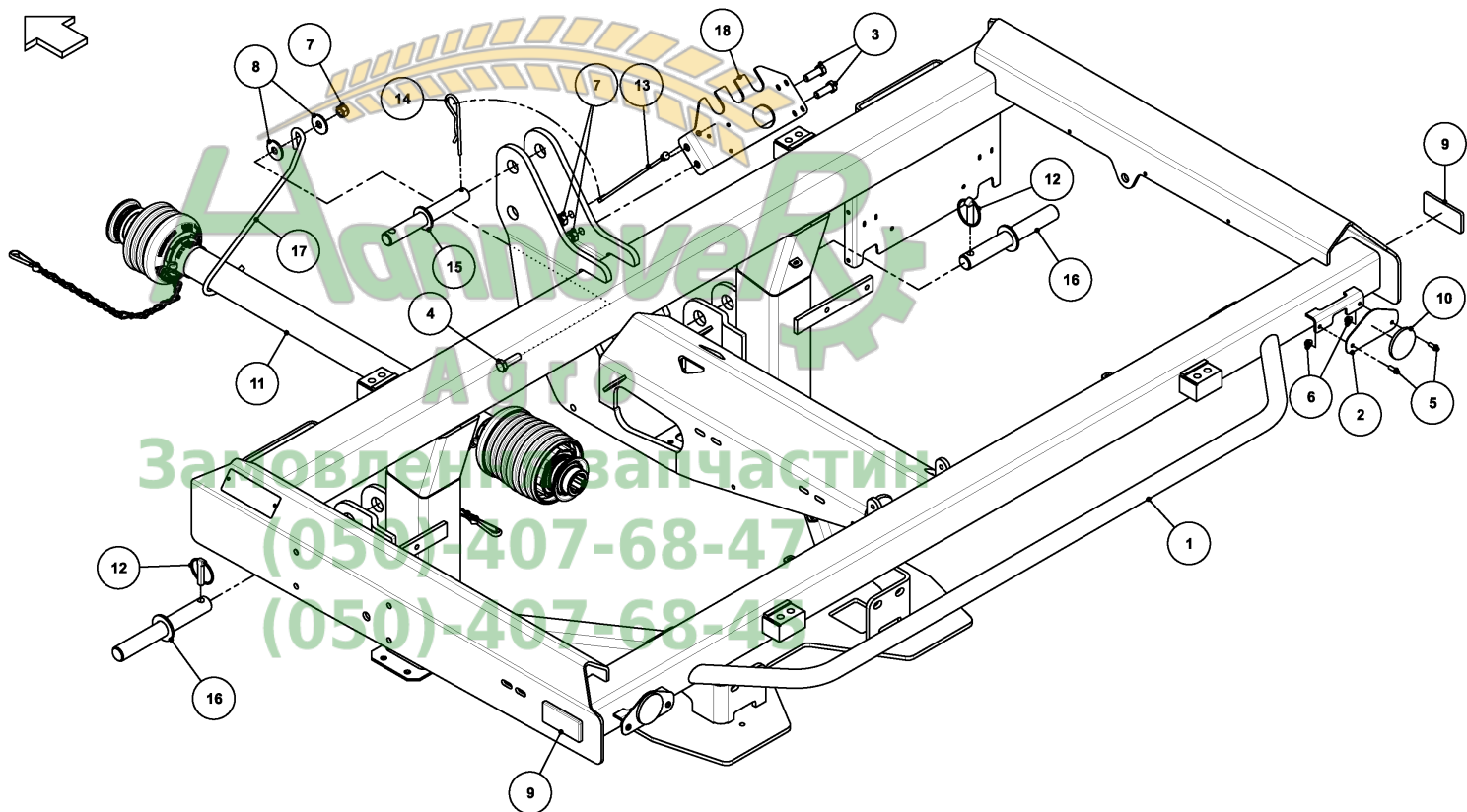

SPHV001800_D/01.001

A138376630-01

RO-M GEO / PROTECTION



PosNo.	Part No.	Qty.
1	A138236002	1
2	A138236186	1
3	A138236402	1
4	KG00494900	4
5	KG00500700	2
6	KG00501000	8
7	KG01059600	4
8	KG01069900	6
9	KG01070100	10
10	KG01264100	18
11	KG01901400	6
12	VN30128821	6
13	VN30143310	2
14	VNB4945378	2

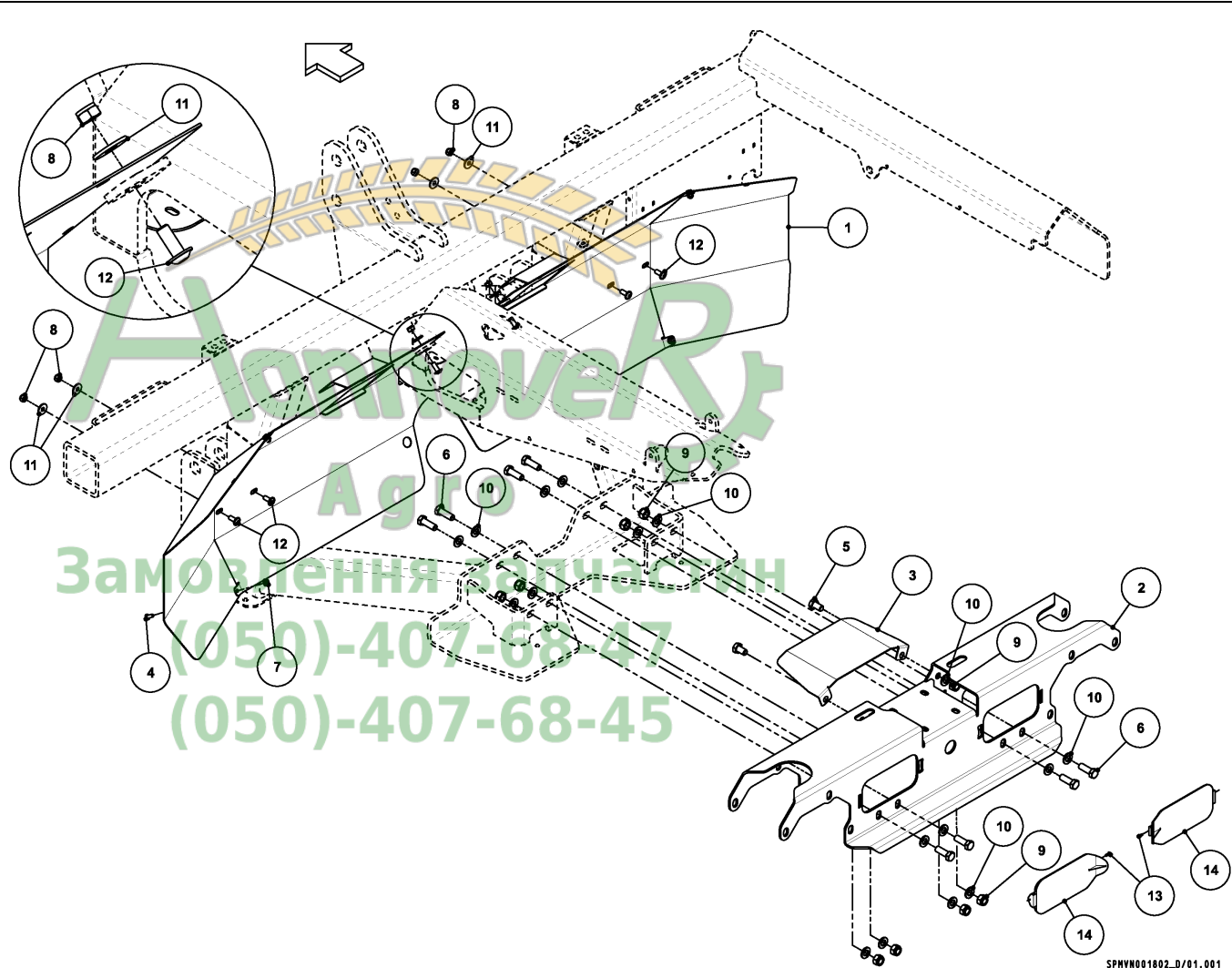

SPHY001802_D/01.001

A138376630-02

RO-M GEO / PROTECTION



PosNo.	Part No.	Qty.
1	KG00494900	4
2	VNB2426674	1
3	VNB4281502	1
4	VNB4708802	4

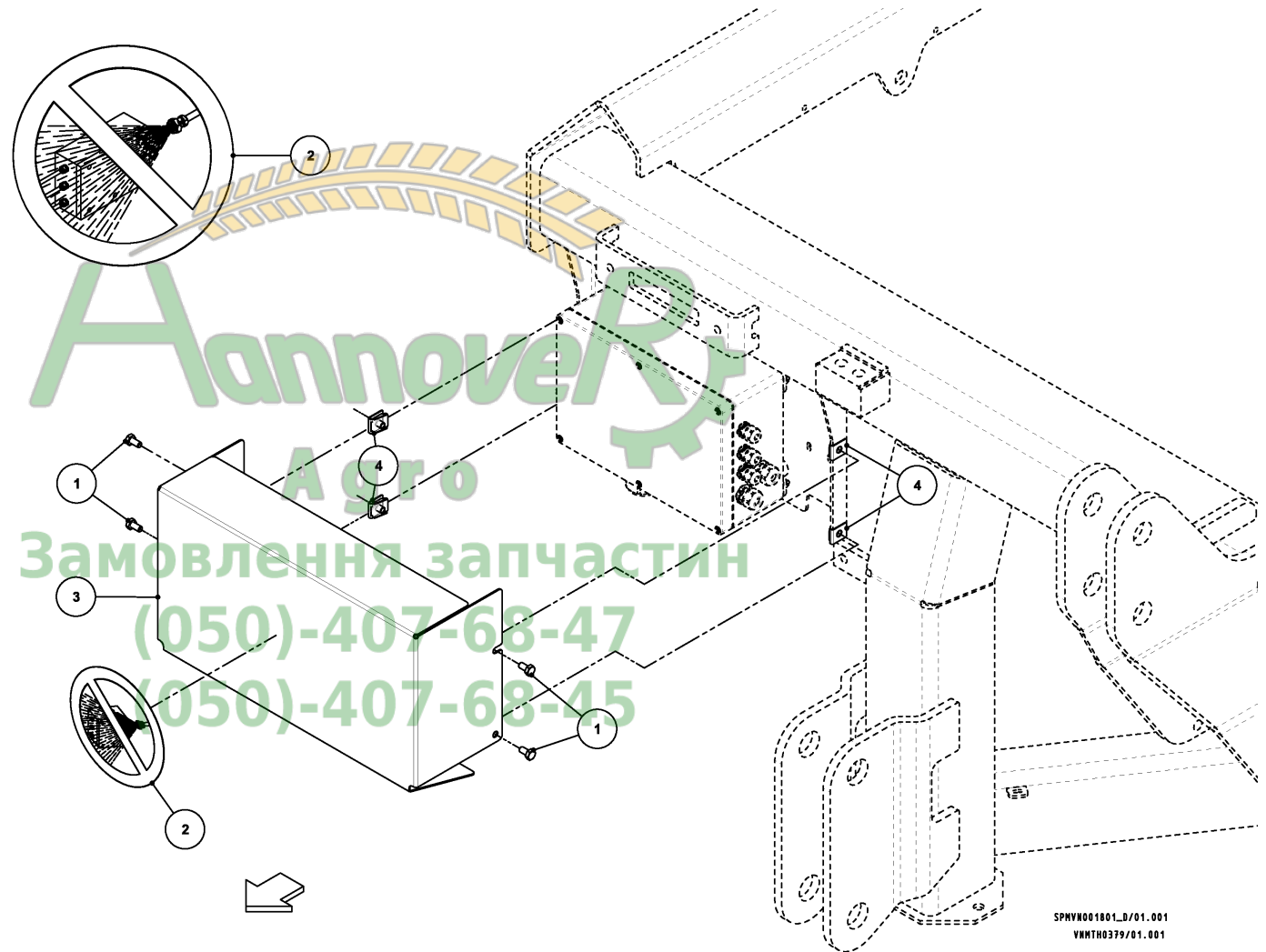

SPVH001801_D/01.001
VNH0379/01.001

A138376630-03

RO-M GEO / PROTECTION



PosNo.	Part No.	Qty.
1	A138231794	2
2	A138234102	4
3	A138234502	1
4	KG00652700	24
5	KG01053700	24
6	KG01059700	8
7	KG01263900	18
8	VN30117800	24
9	VN30128821	8

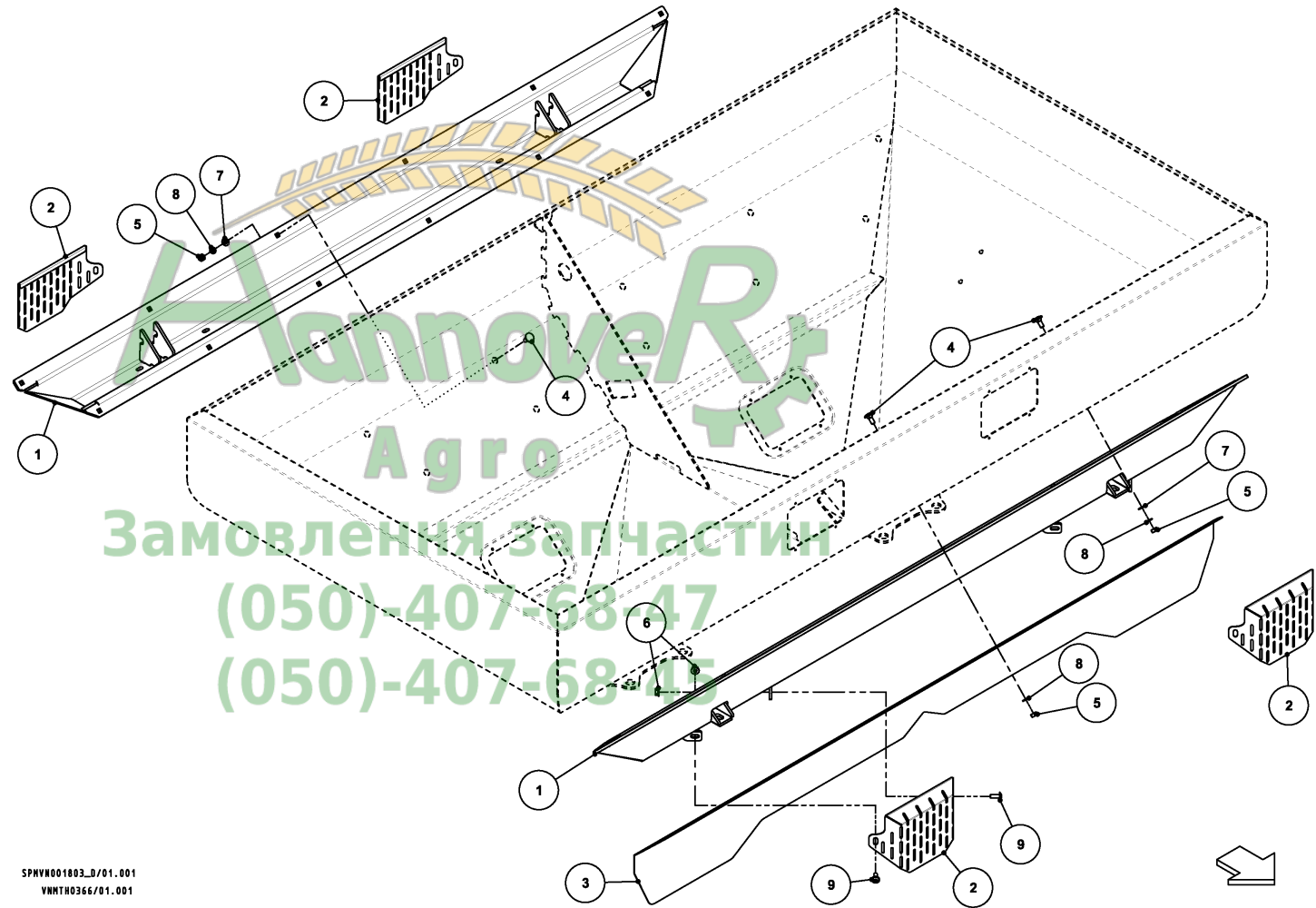

SPHV001803_D/01.001
VWTH0366/01.001

A138376630-04

RO-M GEO / HOPPER AND SIEVE



PosNo.	Part No.	Qty.
1	A138186478	2
2	A138186502	2
3	A138230594	1
4	A138235894	1
5	A138235994	1
6	KG00496900	6
7	KG00497100	6
8	KG00738100	2
9	KG00870000	4
10	KG01069800	6
11	KG01069900	12
12	KG01901400	18
13	VN30143310	16
14	VNB2068778	4
15	VNB2760978	4
16	VNB4270086	2
17	VNB4270602	6
18	VNB4319078	2
19	VNB4627794	2

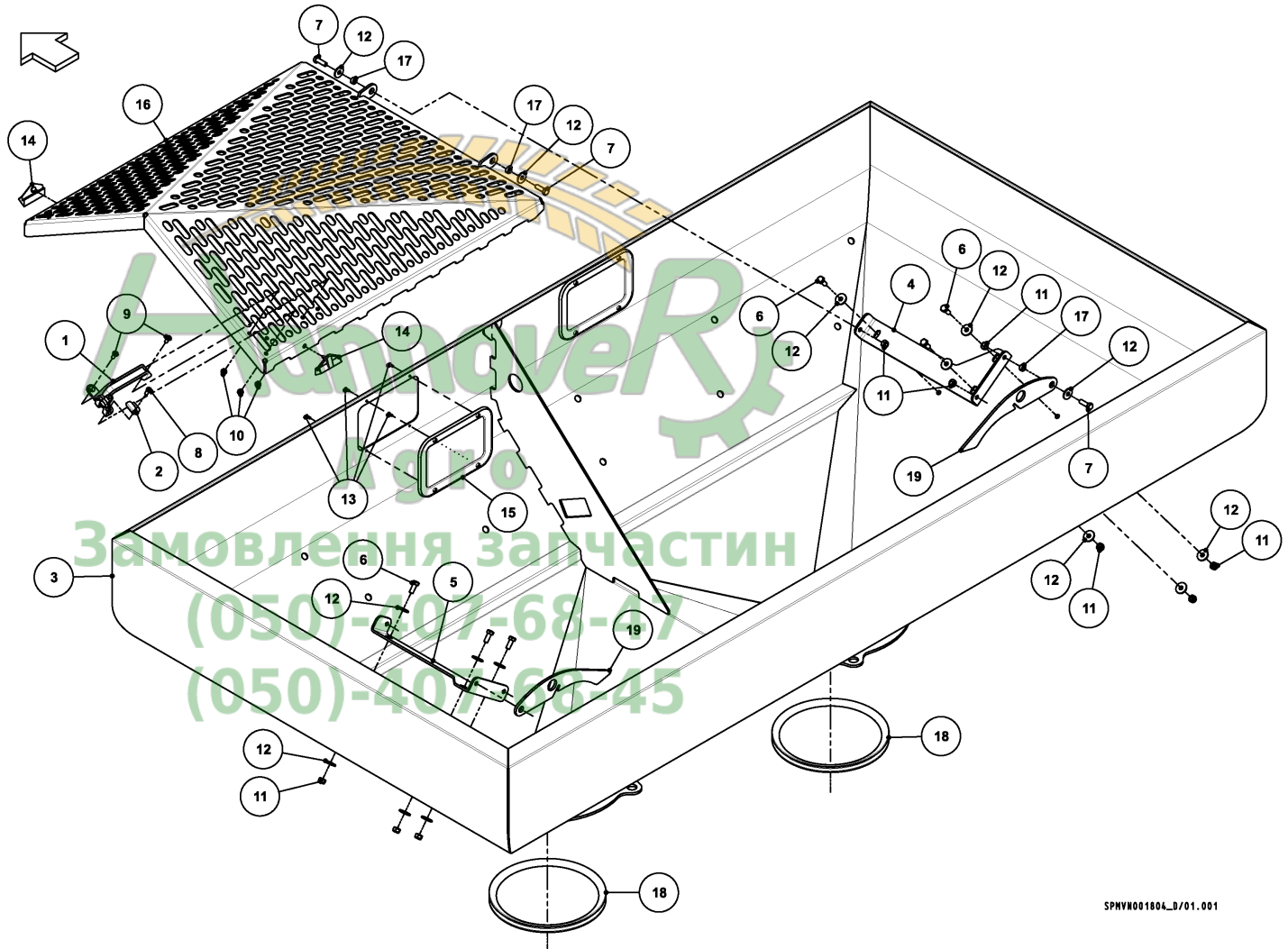

A138376630-05

RO-M GEO / DRIVE



PosNo.	Part No.	Qty.
1	A100014562	1
2	A138083578	2
3	A138201730	1
4	A138266702	2
5	A138310165	2
6	A138310365	2
7	A138310665	2
8	A138310865	2
9	A138315302	1
10	KG00397400	4
11	KG00399800	6
12	KG00565800	12
13	KG01069900	12
14	KG01070000	4
15	KG01070100	6
16	KG01192162	2
17	KG01264000	8
18	KG01264100	12
19	KG01306700	2
20	VNB1082102	2
21	VNB2417578	4
22	VNB3588378	4
23	VNB3588478	5
24	VNB3734878	1
25	VNB4064878	1
26	VNB4064978	1
27	VNB4466478	1
28	VNB5000802	4
29	VNB5000902	12

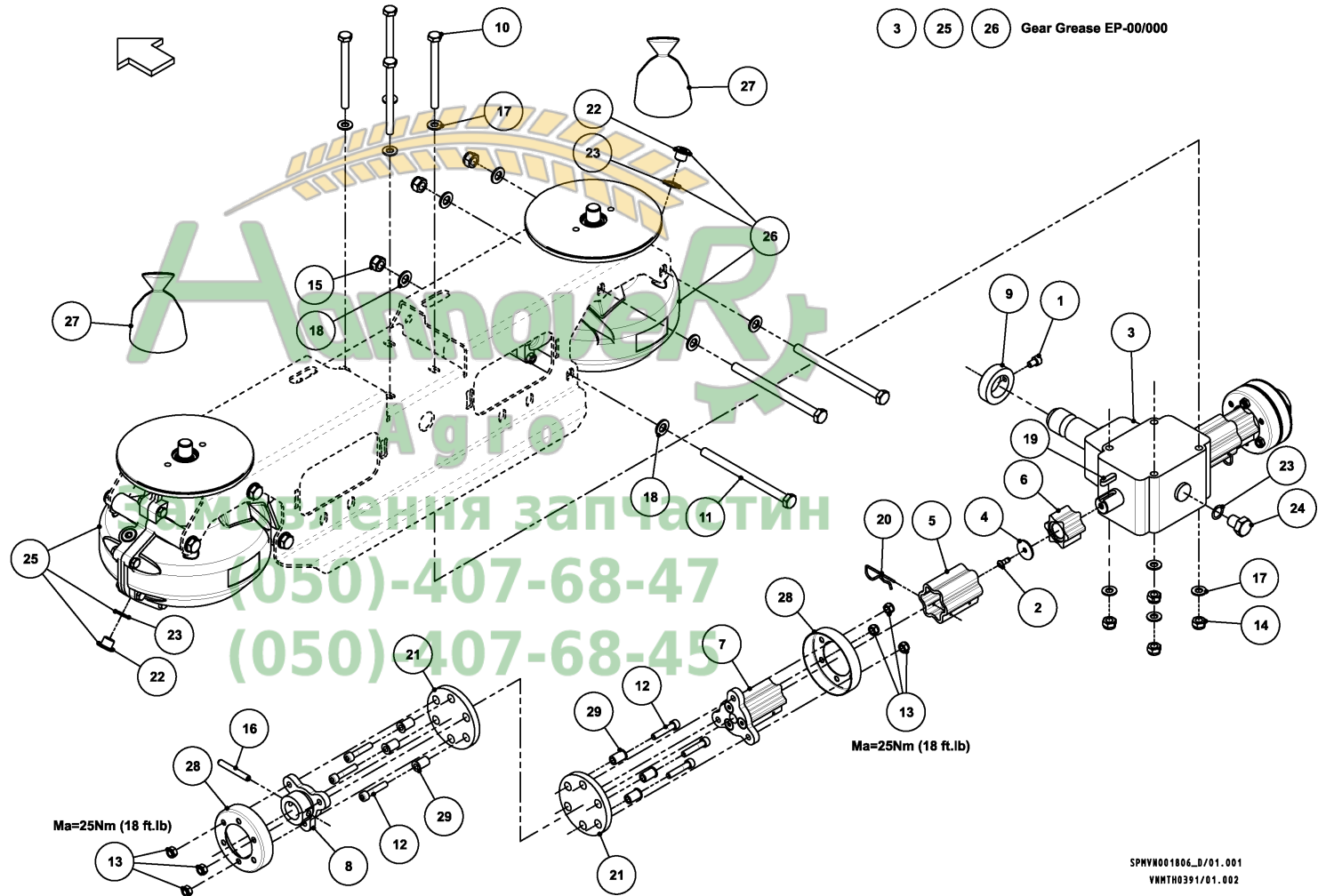

A138376630-06

RO-M GEO / DOSAGE



PosNo.	Part No.	Qty.
1	KG00499500	8
2	KG00562400	6
3	KG00738100	6
4	KG00870200	6
5	KG01044900	8
6	KG01053800	16
7	KG01069800	12
8	KG01107862	2
9	KG01283000	6
10	KG01421400	4
11	VN30117100	8
12	VN30143310	4
13	VN36112005	4
14	VNB3317278	2
15	VNB3559902	2
16	VNB3957302	1
17	VNB3957402	1
18	VNB3958278	2
19	VNB3967598	1
20	VNB3967698	1
21	VNB3970002	2
22	VNB4023502	2
23	VNB4042498	1
24	VNB4042598	1
25	VNB4042702	16
26	VNB4059402	2
27	VNB4060978	2
28	VNB4061702	2
29	VNB4061978	2
30	VNB4073178	2
31	VNB4077378	6
32	VNB4225402	2
33	VNB4239702	2
34	VNB4789802	1
35	VNB4789902	1

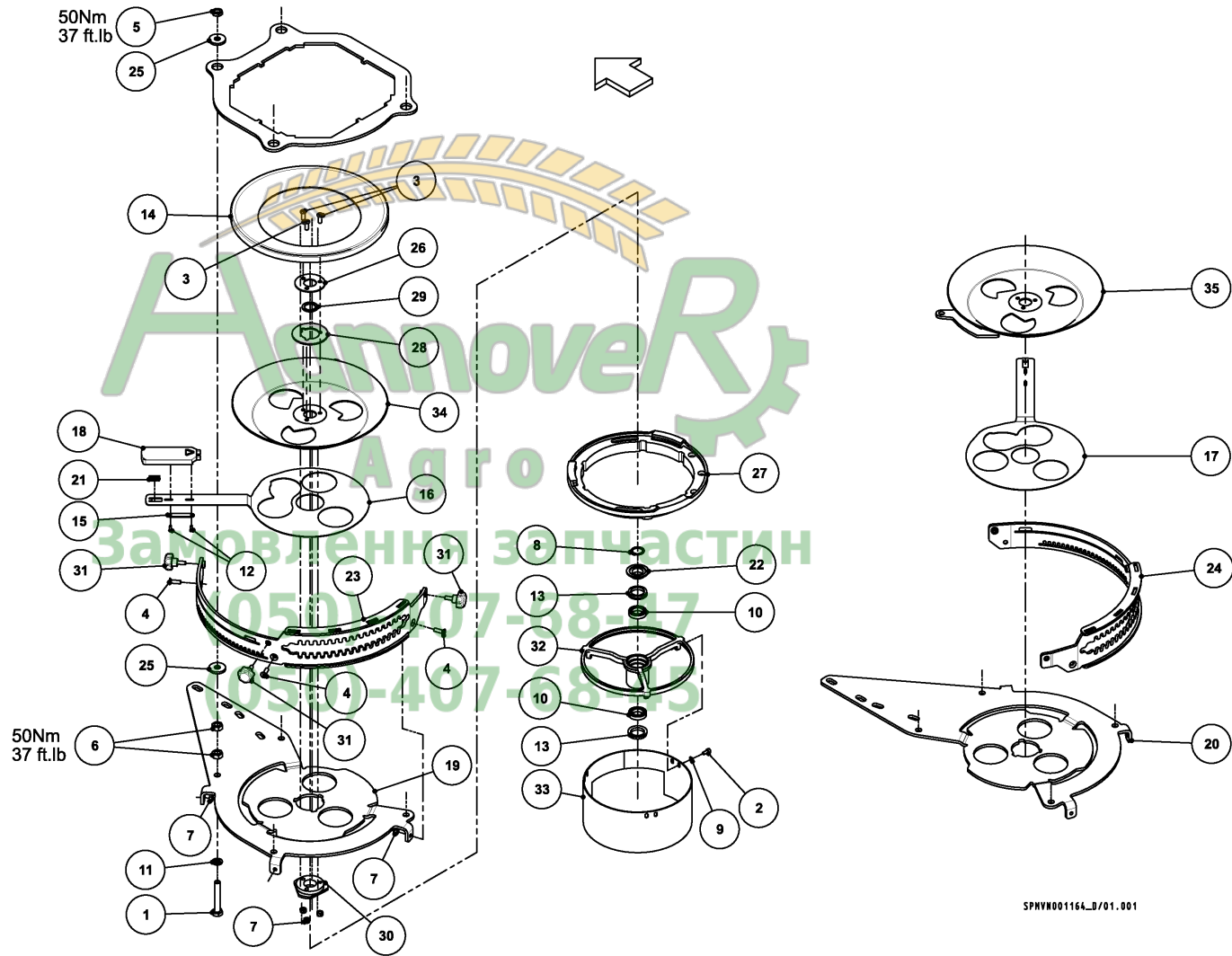

SPHYN001164_D/01.001

VN79771635-08-2016

RO-M GEO / DOSAGE



PosNo.	Part No.	Qty.
1	A138222330	4
2	A138430202	1
3	A138430602	1
4	KG00498700	8
5	KG00870000	6
6	KG00945900	4
7	KG01069800	6
8	KG01069900	8
9	KG01070000	8
10	KG01901500	8
11	VN30130800	4
12	VN36107317	4
13	VNB0566173	1
14	VNB2235978	16
15	VNB3317378	4
16	VNB4063078	1
17	VNB4063178	1
18	VNB4713902	2
19	VNB4790102	1
20	VNB4790202	1
21	VNB4808502	8

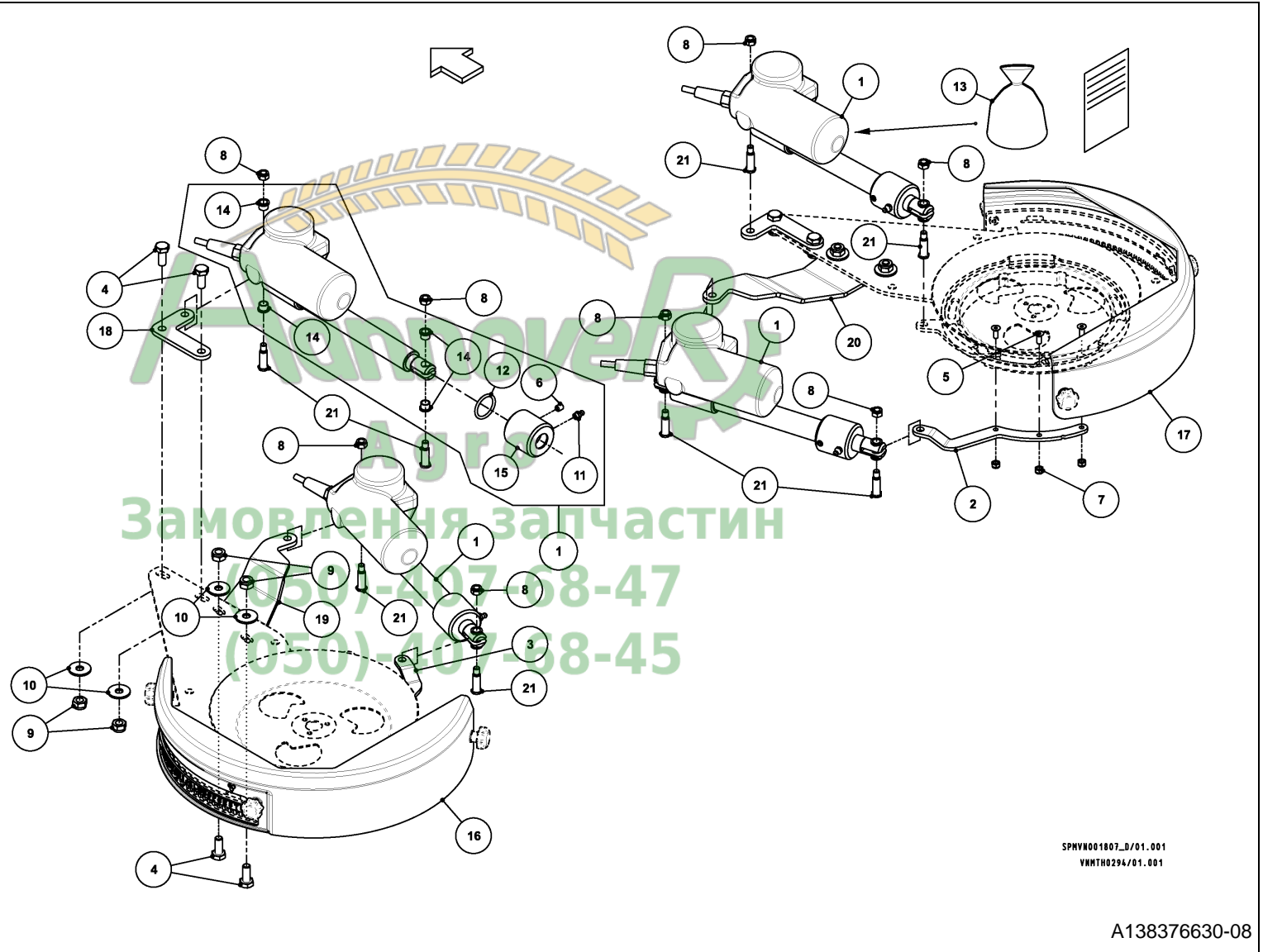

SPVH001807_D/01.001
VNH0294/01.001

A138376630-08

RO-M GEO / DISC, BROADCASTER



PosNo.	Part No.	Qty.
1	A138361530	1
2	KG00498800	4
3	KG00565700	2
4	KG01069900	2
5	KG01283300	4
6	VN30105200	16
7	VN30130800	4
8	VN36112032	2
9	VN79771219	1
10	VNB3388365	2
11	VNB3388402	2
12	VNB3414002	1
13	VNB3414102	1
14	VNB3717802	2
15	VNB4077502	1
16	VNB4077602	1
17	VNB4916674	1
18	VNB4955878	4
19	VNB4955978	4
20	VNB4956078	4
21	VNB4956178	4

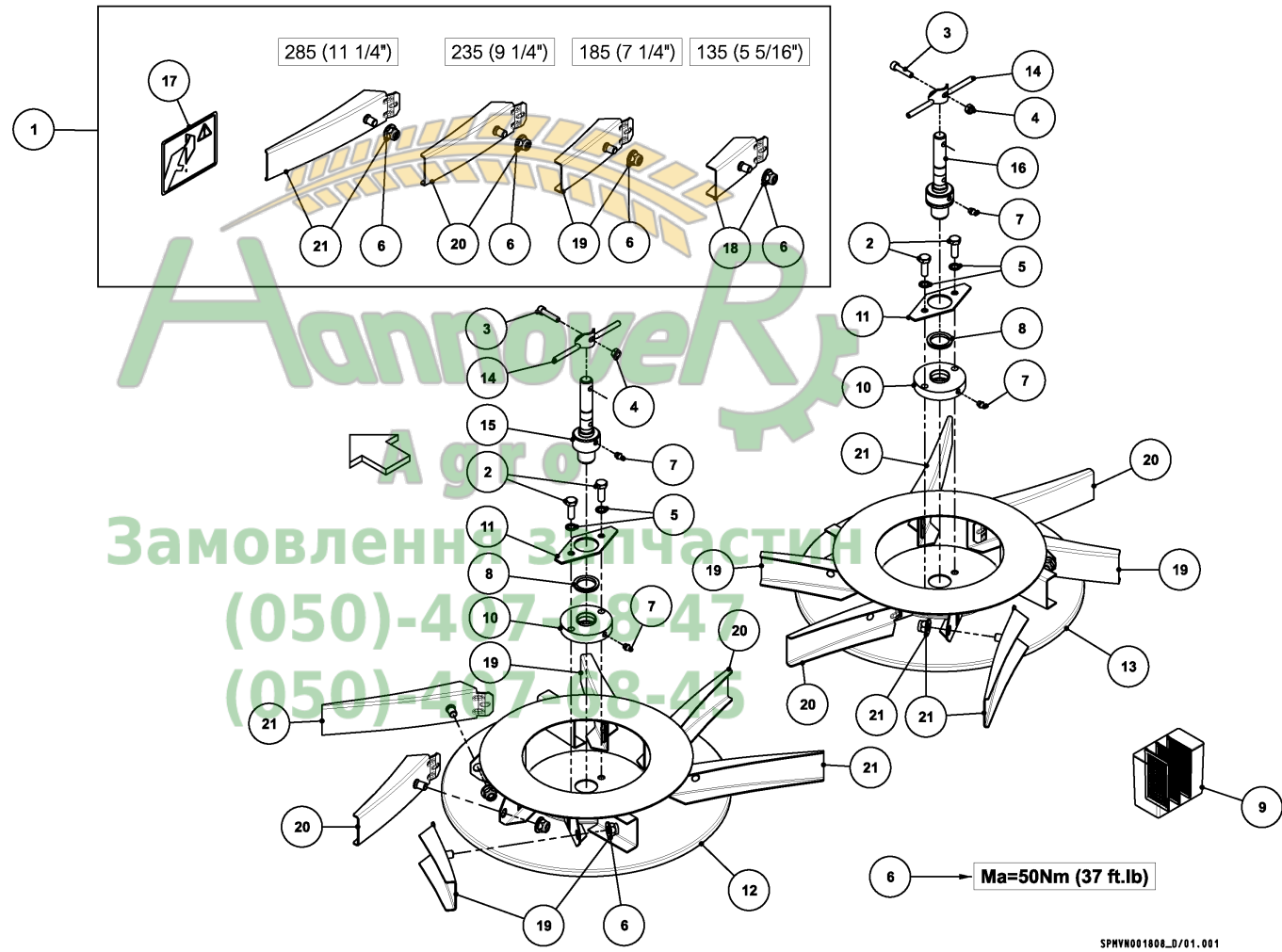

SPHYN001808_D/01.001

A138361530-MGEO

RO-M GEO / CONTROL, ISO



PosNo.	Part No.	Qty.
1	A138233602	4
2	A138233702	4
3	A138233802	8
4	A138233902	4
5	A138234002	4
6	A138361065	12
7	KG00497600	4
8	KG01069900	4
9	MT00001356	1
10	VN80504001	6
11	VNB2336686	1
12	VNB4049902	4
13	VNB4050073	4

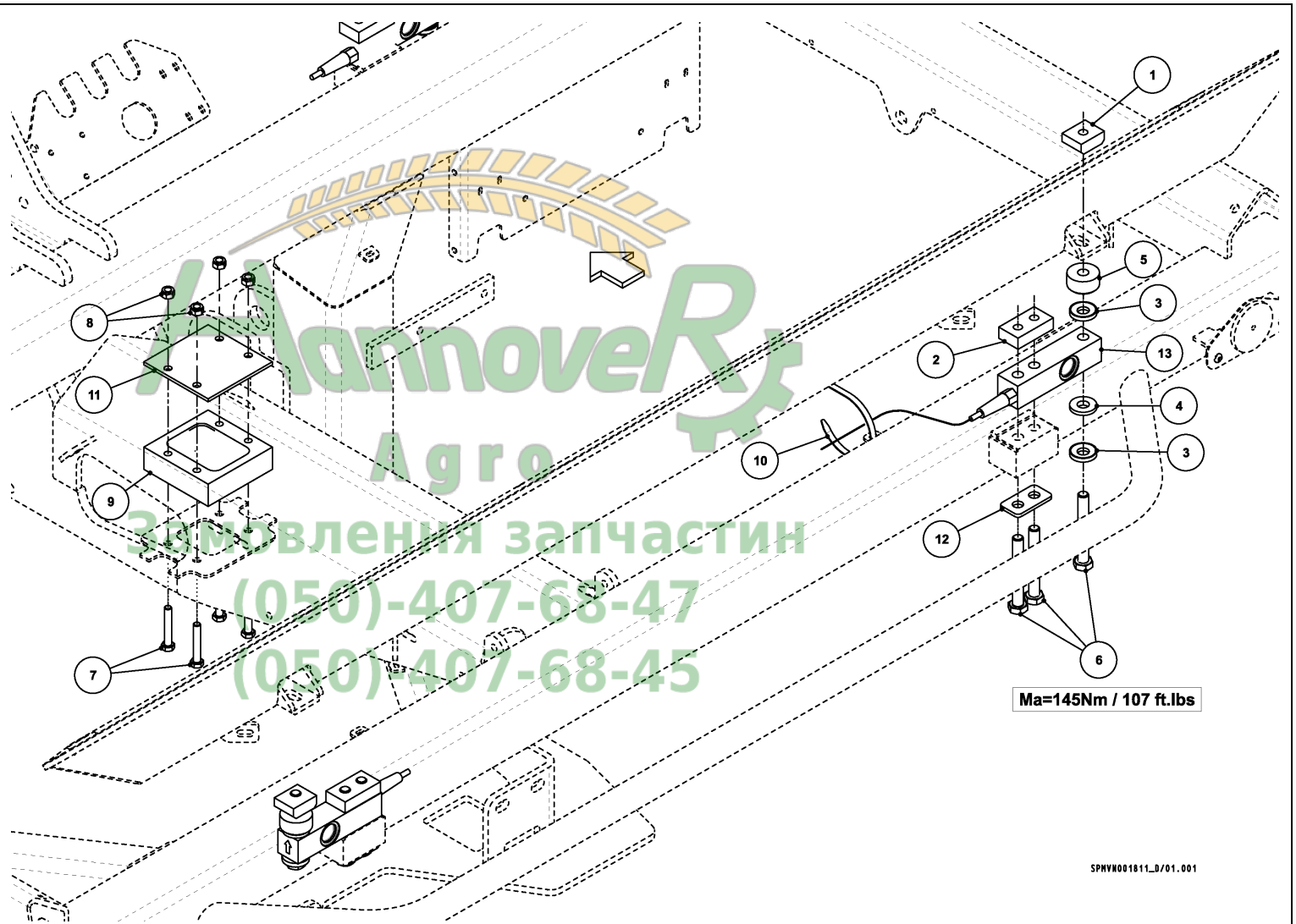

SPHV001811_D/01.001

A138376630-09

RO-M GEO / CONTROL, ISO



PosNo.	Part No.	Qty.
1	A136026300	1
2	A136074900	1
3	A136081400	1
4	A136081500	1
5	A136081700	1
6	A138311802	1
7	KG00496900	2
8	KG01053500	4
9	KG01069900	2
10	KG01263900	2
11	MT00001663	1
12	MT00001688	1
13	MT00002021	1
14	MT00002274	1
15	VN30117600	4
16	VN80504001	12
17	VN80504003	10
18	VNB0253473	1
19	VNB0489473	1
20	VNB0563673	1
21	VNB0578473	1

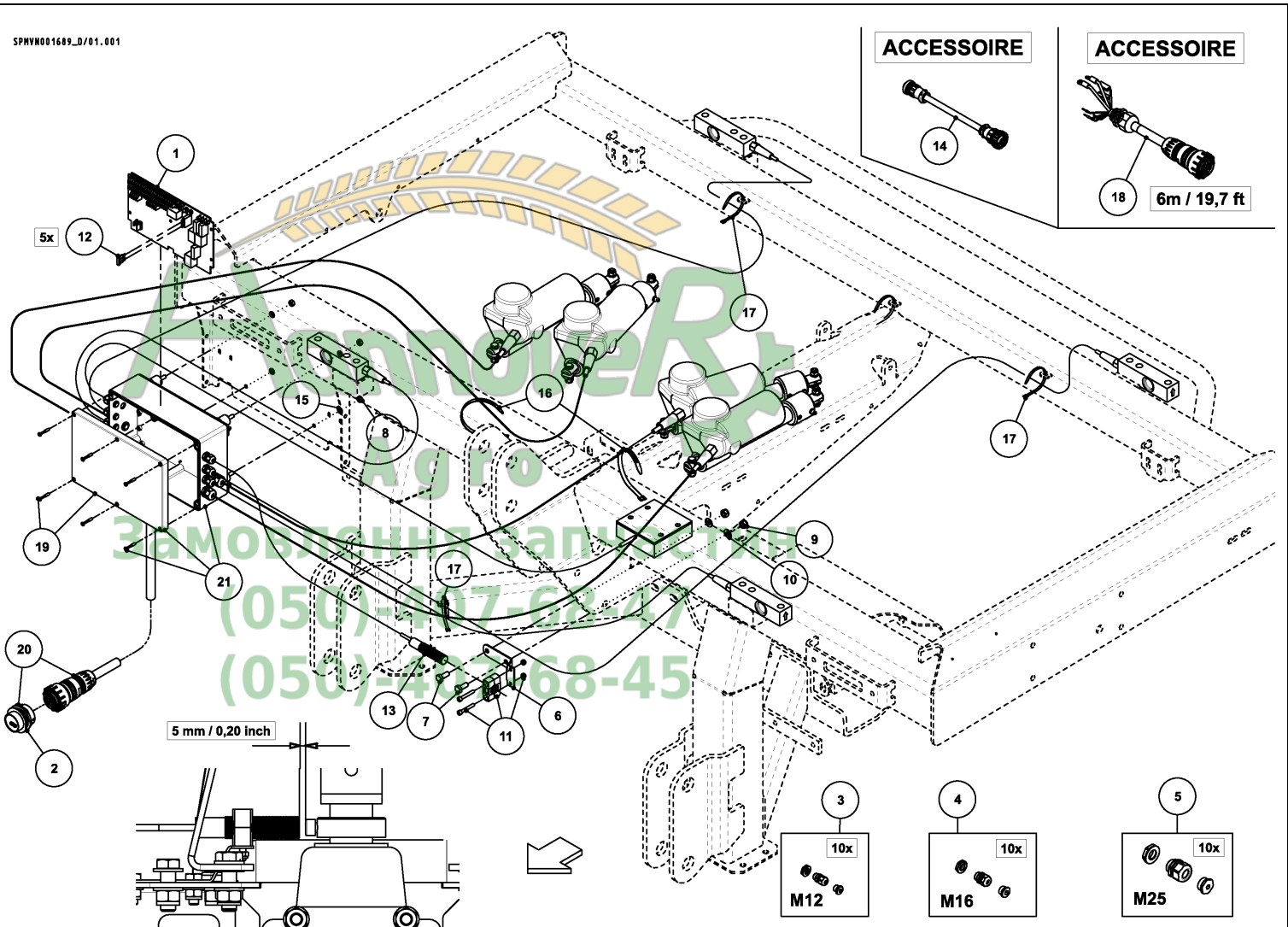

MT00002181-MGEO-2016

RO-M GEO / UNIV. JOINT SHAFT



PosNo.	Part No.	Qty.
1	KG00742063	6
2	KG01192062	2
3	KG02000000	1
4	KG02000100	1
5	KG02000200	1
6	KG02000300	1
7	KG02000400	1
8	KG02000500	2
9	KG02000600	2
10	KG02000700	1
11	KG02000800	1
12	KG02000900	1
13	KG02001000	1
14	KG02001100	2
15	KG02001200	1
16	KG02001300	2
17	KG02001400	1
18	KG02001500	2
19	KG02001600	1
20	KT56968000	1
21	KT56969000	1
22	VF16661794	1
23	VF16661795	1
24	VGTR1029	1

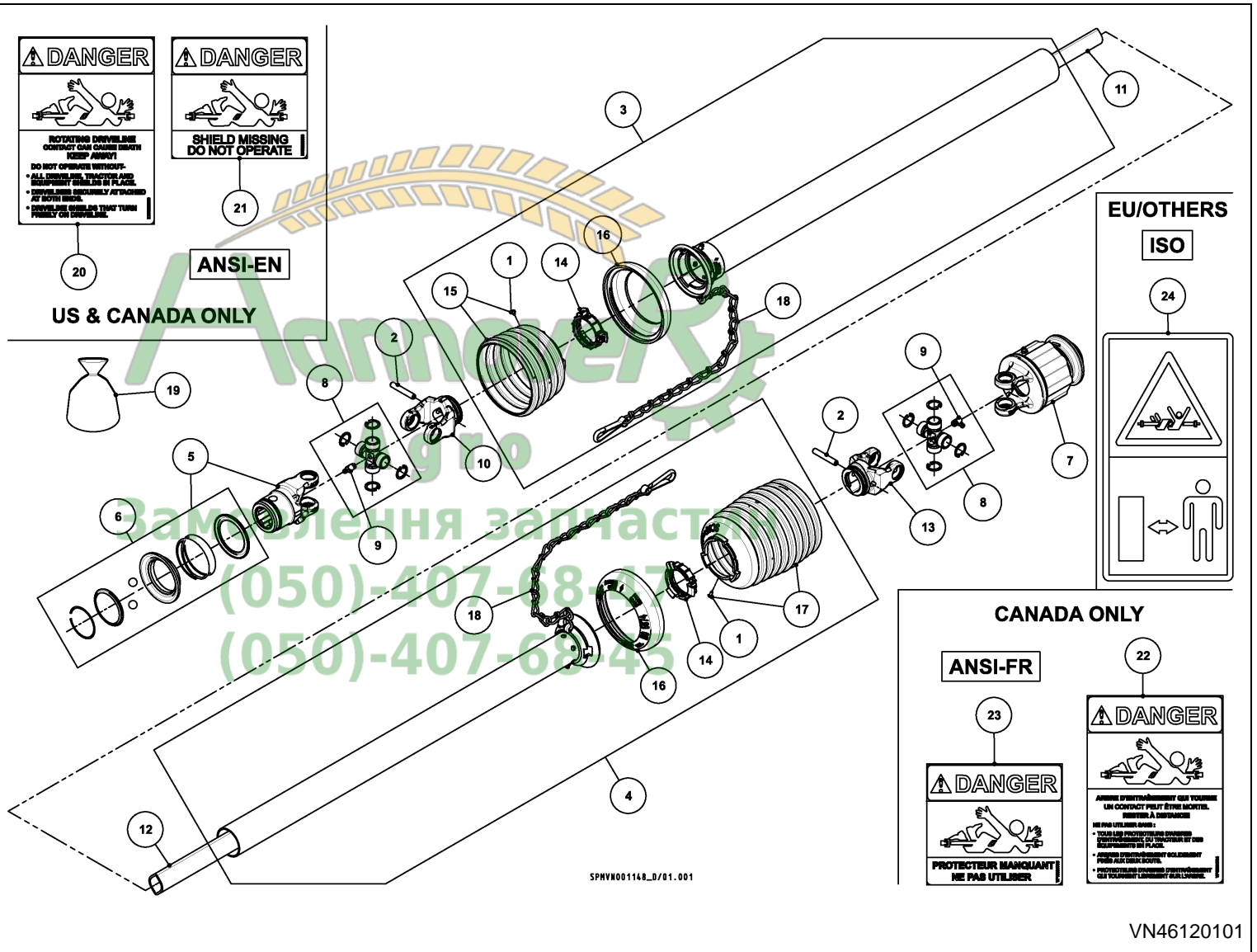

RO-M GEO / DECAL SCHEMATIC ISO (EU/OTHERS)



PosNo.	Part No.	Qty.
1	A138368474	1
2	A138369074	1
3	VNB1310474	1
4	VNB2071674	3
5	VNB2426674	1
6	VNB2822600	1
7	VNB4105374	2
8	VNB4105574	1
9	VNB4376974	2
10	VNB4377174	1
11	VNB4377274	2
12	VNB4493474	1
13	VNB4800374	1
14	VNB4916674	2
15	VNB5049874	2

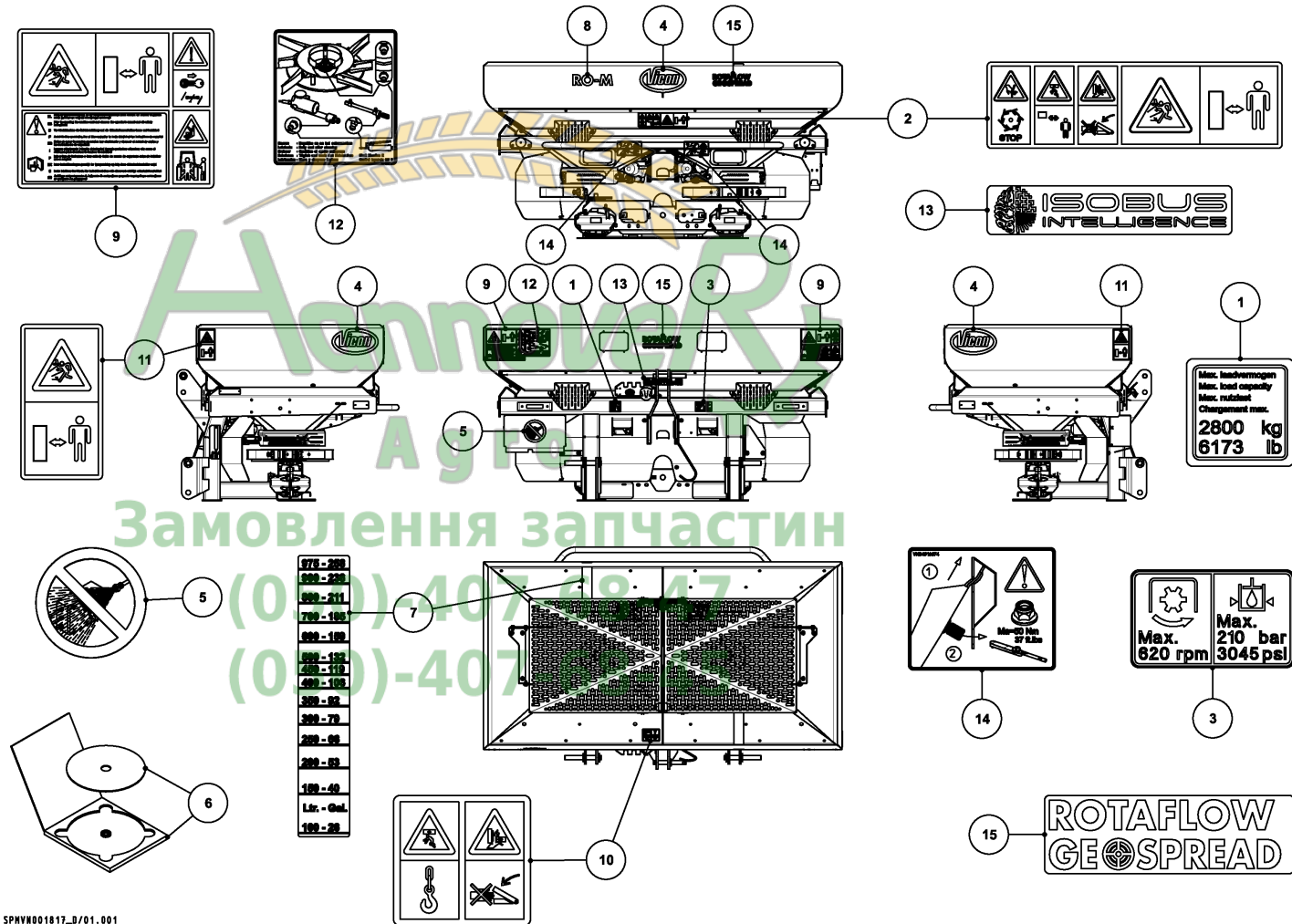

ROMGEO_VN25700_DC1

RO-M GEO / DECAL SCHEMATIC ISO (FRANCE)



PosNo.	Part No.	Qty.
1	VNB4377474	1
2	VNB4377574	1
3	VNB4377674	1
4	VNB4377774	1

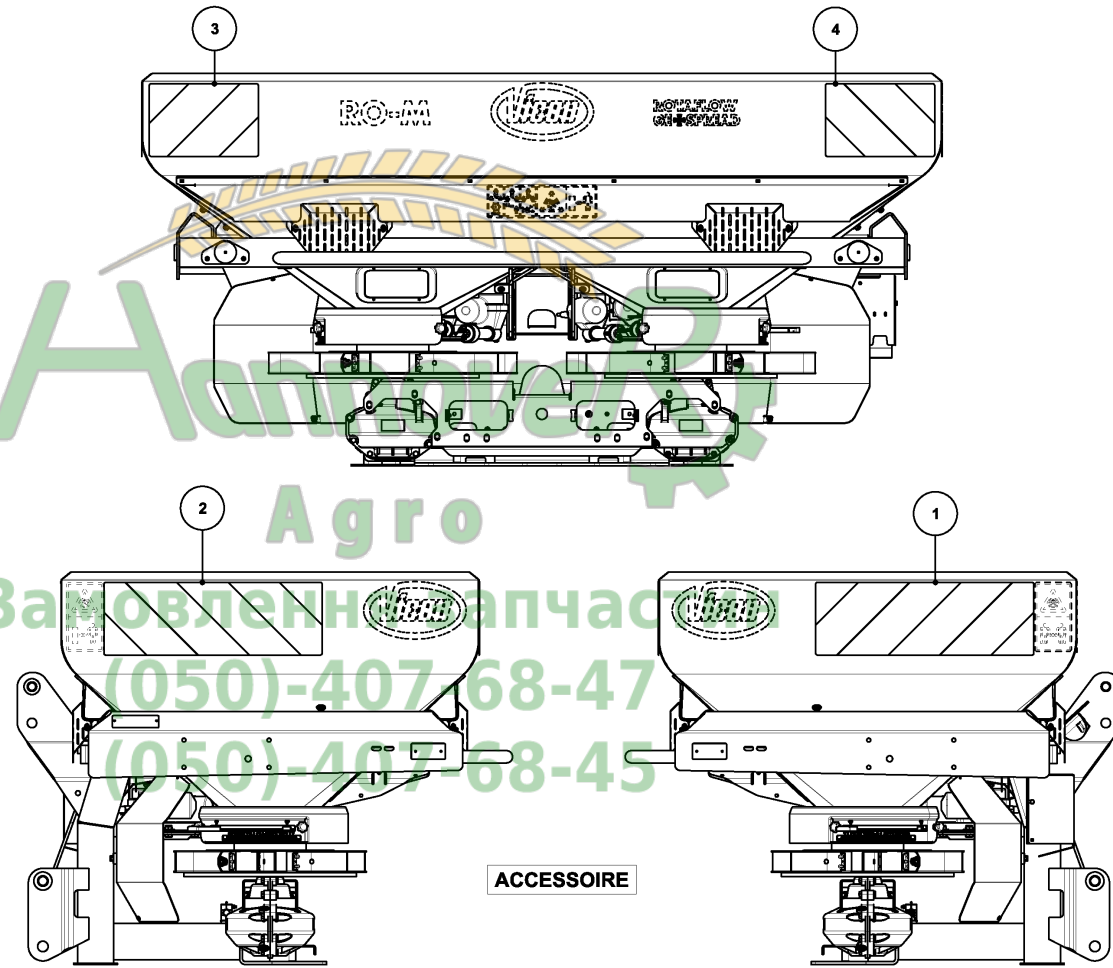

ROMGEO_VN25700_DC2

RO-M GEO / HOPPER EXTENSION



PosNo.	Part No.	Qty.
1	VNB3984186	4
2	VNB4014778	4
3	VNB4053474	8
4	VNB4218178	16
5	VNB4675302	2
6	VNB4675402	2

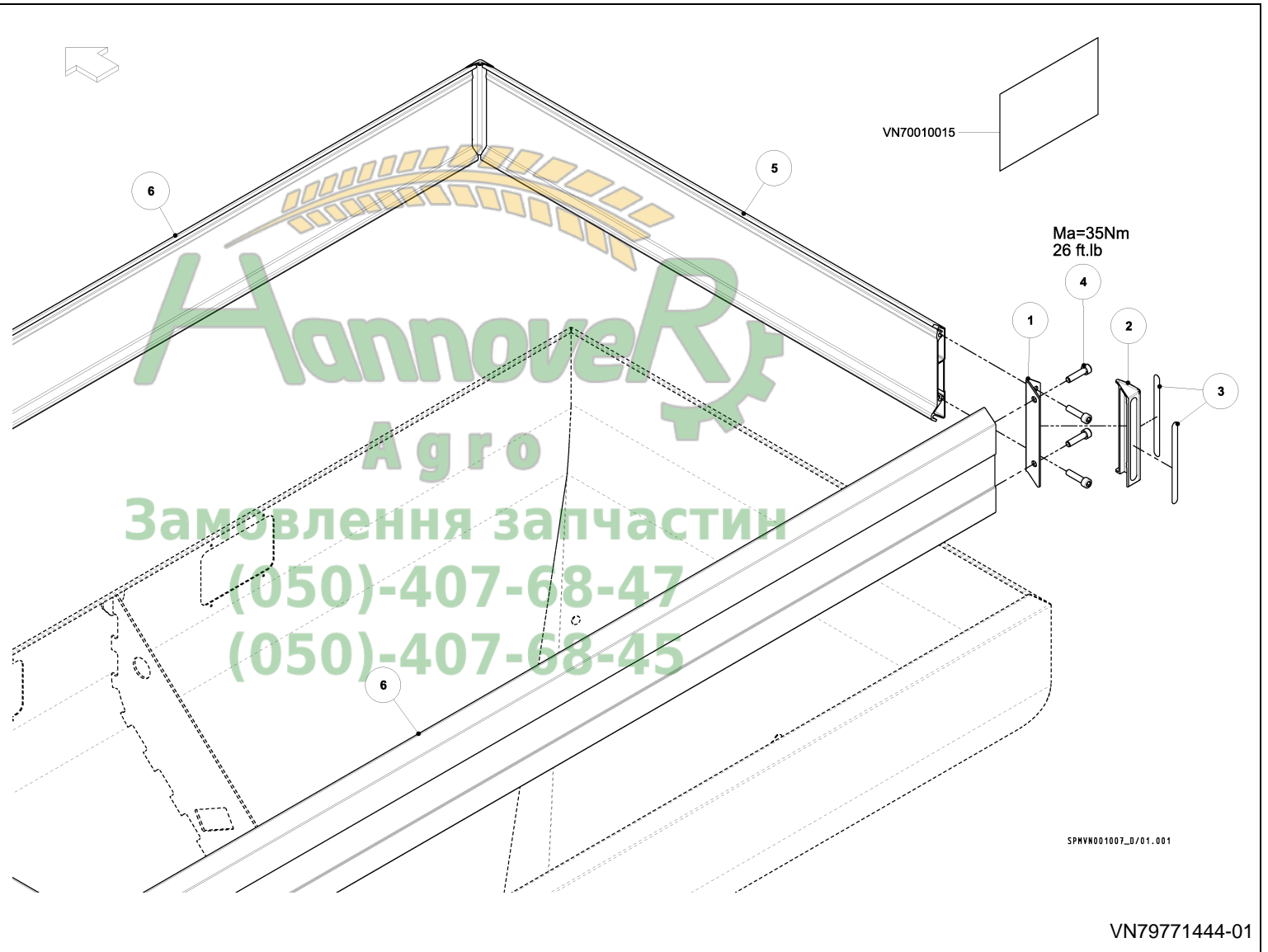

RO-M GEO / TARPAULIN



PosNo.	Part No.	Qty.
1	KG00497200	8
2	KG00497600	8
3	KG00652900	4
4	KG00712400	1
5	KG00738100	2
6	KG00739600	8
7	KG01053500	2
8	KG01053700	8
9	KG01069600	1
10	KG01069900	12
11	KG01263600	1
12	KG01263900	4
13	KG01901400	4
14	KG01901500	8
15	RG00040217	1
16	VF16661496	1
17	VF16661768	1
18	VGTR2059	1
19	VNB2092402	4
20	VNB3443478	4
21	VNB3447178	1
22	VNB3603398	1
23	VNB3603598	1
24	VNB4078798	2
25	VNB4079098	1
26	VNB4306498	2
27	VNB4306598	1
28	VNB4306698	1
29	VNB4309102	8
30	VNB4487278	4
31	VNB4998578	1

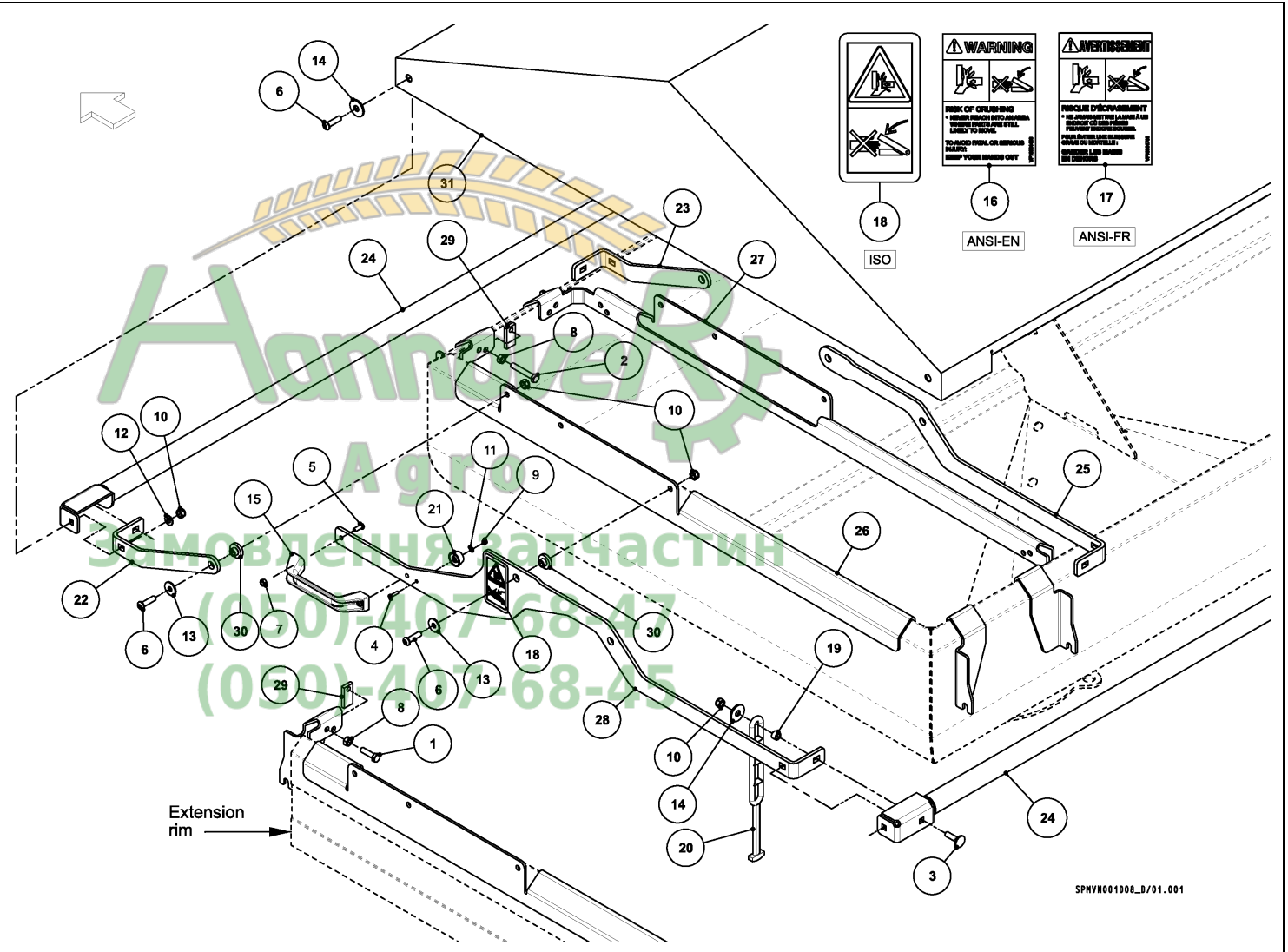

RO-M GEO / TARPAULIN



PosNo.	Part No.	Qty.
1	KG00652900	8
2	KG00739600	2
3	KG01069900	10
4	KG01263900	4
5	KG01901400	6
6	VNB4078798	1
7	VNB4079198	1
8	VNB4079298	1
9	VNB4079398	2
10	VNB4487278	6

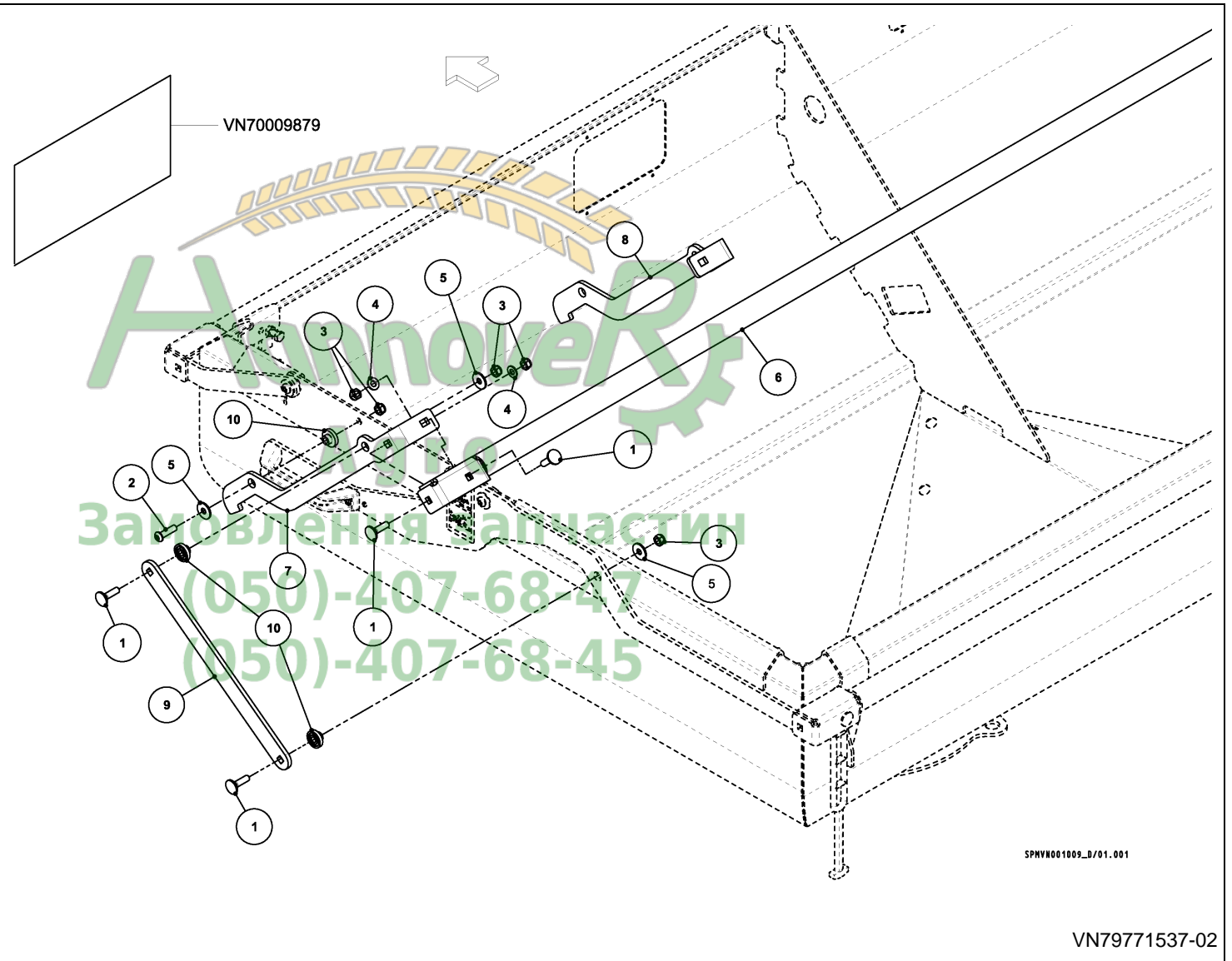

RO-M GEO / LIGHTING EU/OTHERS



PosNo.	Part No.	Qty.
1	KG00563000	3
2	KG01059600	4
3	KG01069700	3
4	VN48101007	1
5	VN80504001	2
6	VN80504003	10
7	VNB0341273	1
8	VNB5007578	2
9	VNB5030178	2

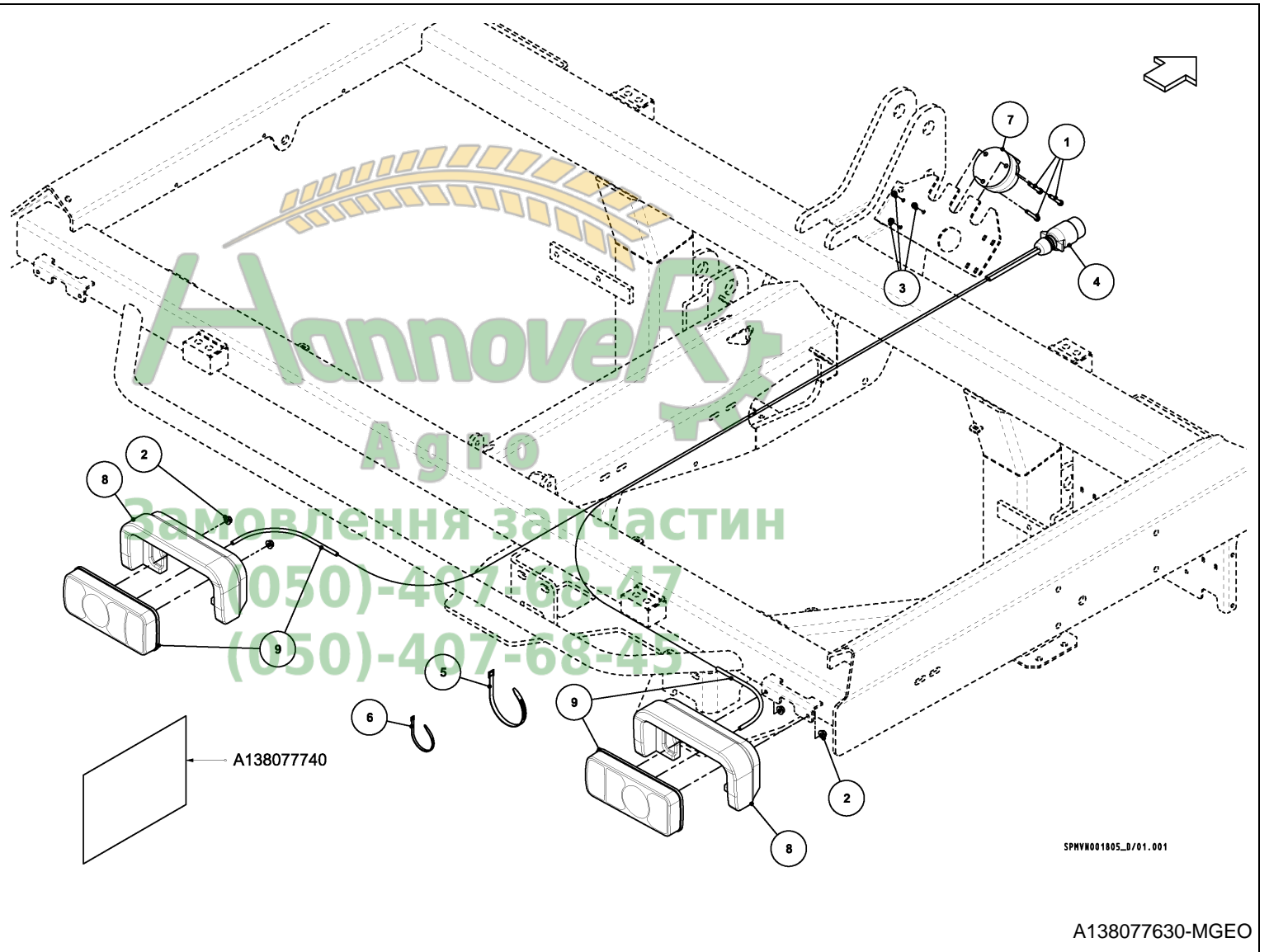

SPHV001805_D/01.001

A138077630-MGEO

RO-M GEO / WARNING TRIANGLE SMV



PosNo.	Part No.	Qty.
1	A138155202	1
2	A138155402	1
3	KG00497100	1
4	KG00738100	2
5	KG01069800	2
6	KG01069900	1
7	KG01901400	1
8	VNB1063478	2
9	VNB1847378	1

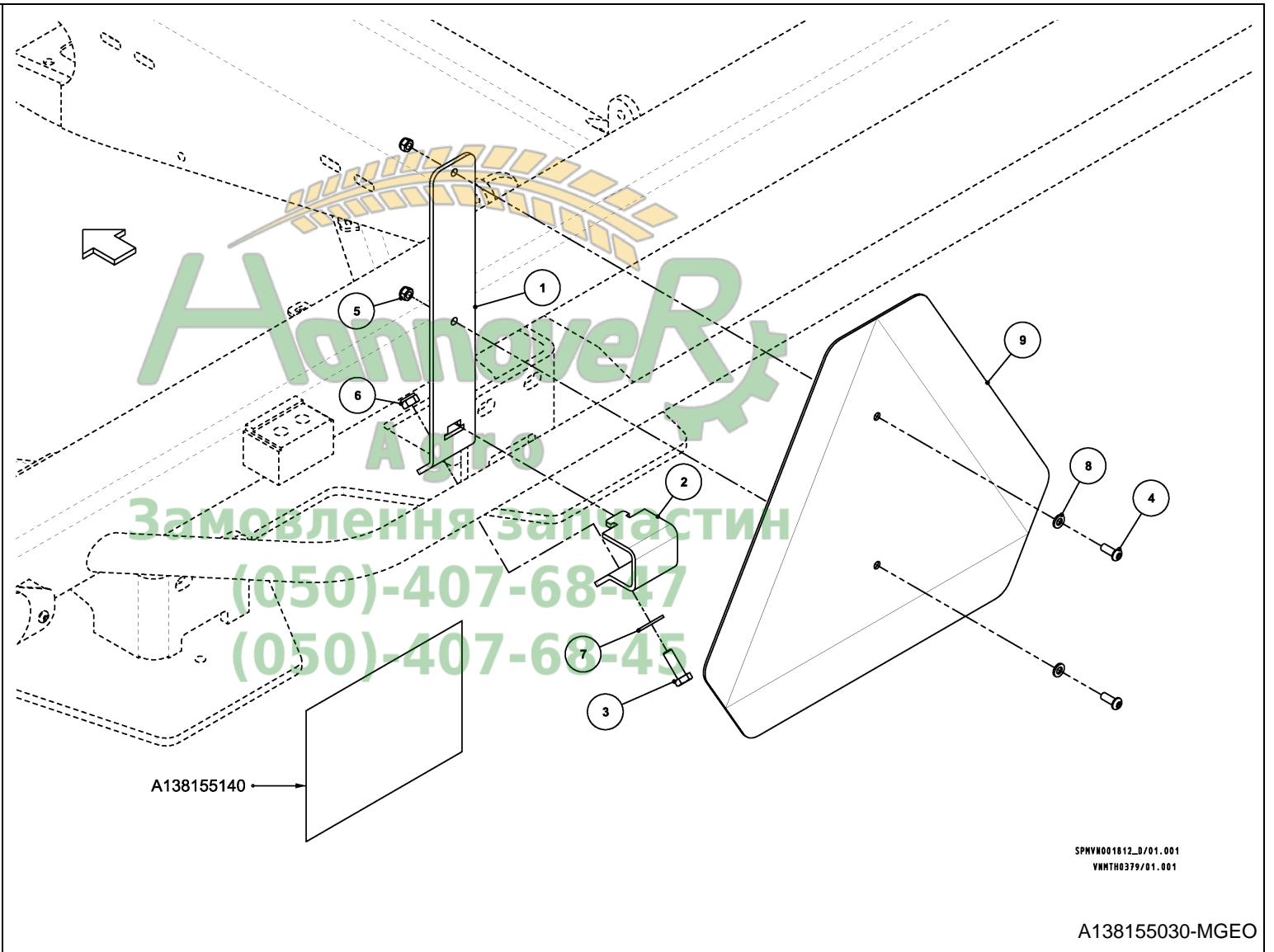

SPMVD01812_D/01.001
VNMTH0379/01.001

A138155030-MGEO

RO-M GEO / HOPPER EMPTYING SET



PosNo.	Part No.	Qty.
1	A138367202	6
2	A138367302	2
3	KG00679900	8
4	KG00738100	4
5	KG00738300	6
6	KG01069800	6
7	KG01263600	8
8	KG01264000	6
9	KG01901300	2
10	VN30105400	8
11	VNB4334578	4
12	VNB4408202	2
13	VNB4408302	2
14	VNB4451002	6
15	VNB4975278	2

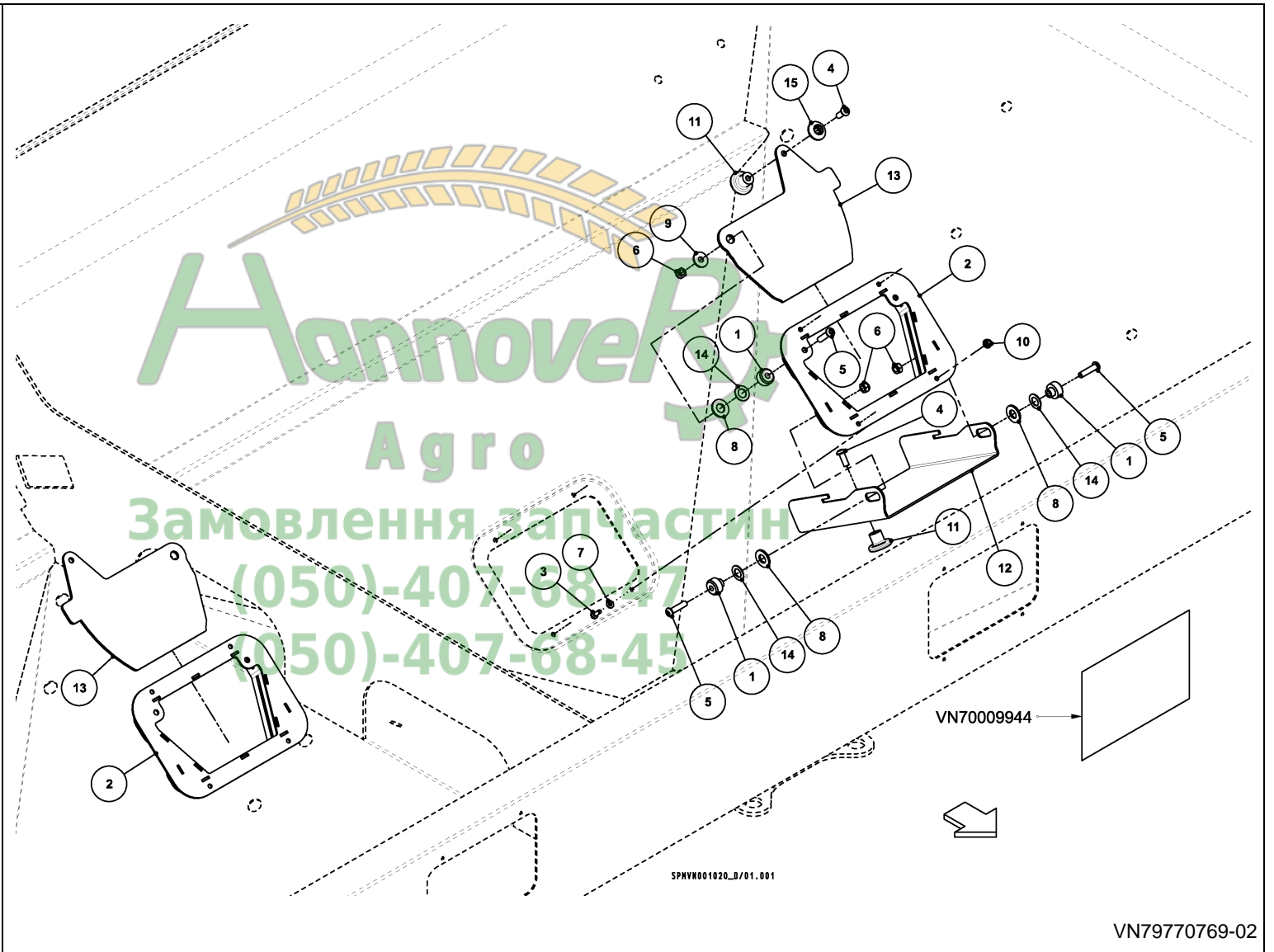

RO-M GEO / LADDERSET



PosNo.	Part No.	Qty.
1	KG00497100	7
2	KG00868600	6
3	KG00870200	6
4	KG01069700	6
5	KG01069800	6
6	KG01069900	7
7	KG01901400	7
8	VNB4442278	1
9	VNB4450578	2
10	VNB4451198	1
11	VNB4451298	2
12	VNB4451398	7
13	VNB4451498	1
14	VNB4451978	1
15	VNB4473502	1
16	VNB4743378	3

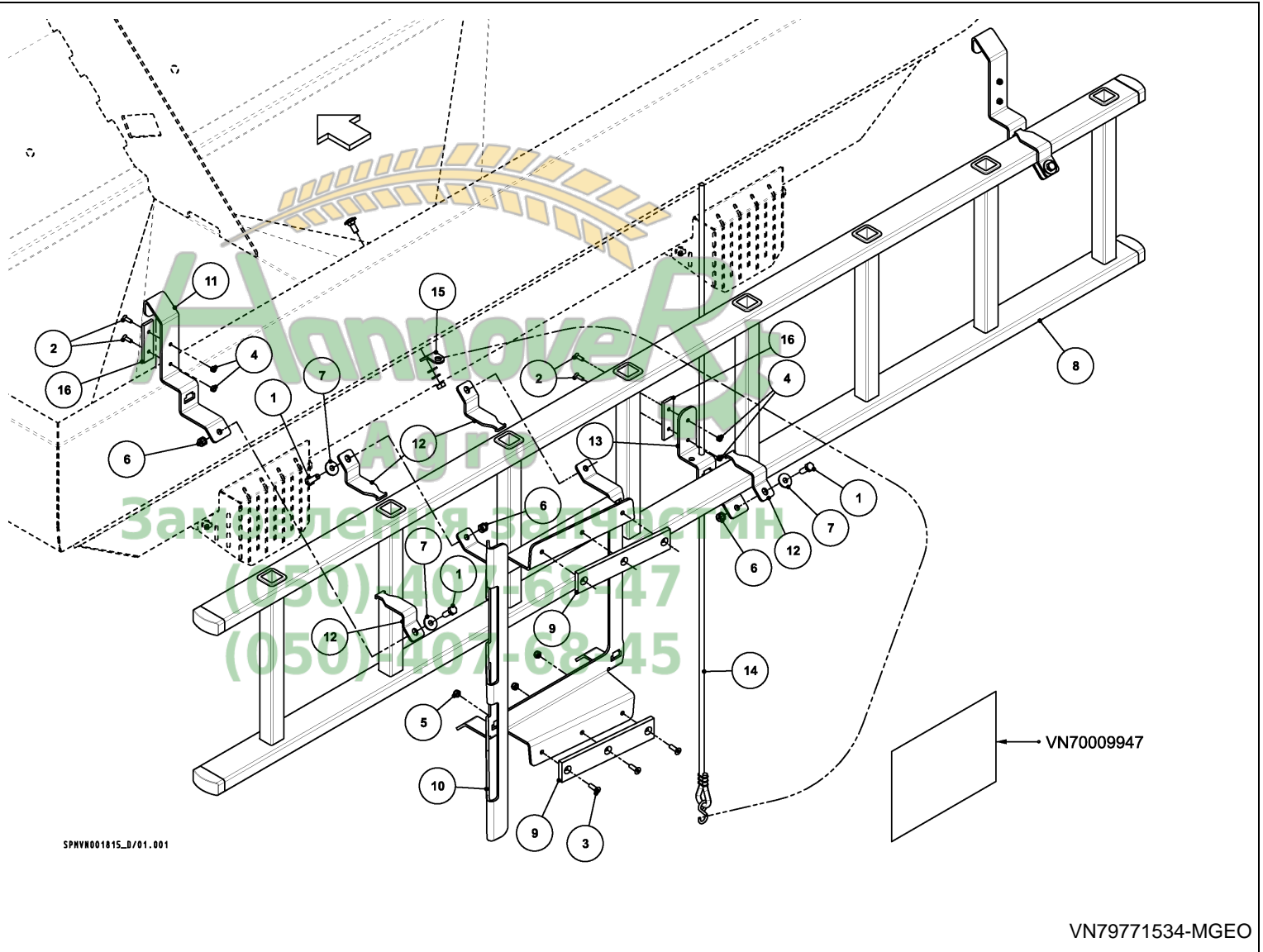

SPHYN001815_D/01.001

VN79771534-MGEO

RO-M GEO / CALIBRATION CONTAINER



PosNo.	Part No.	Qty.
1	KG00493700	4
2	KG00495100	4
3	KG00495300	1
4	KG01059600	2
5	KG01069700	4
6	KG01069800	4
7	KG01901200	4
8	RG00040217	2
9	VF16661510	1
10	VF16661782	1
11	VGTR2023	1
12	VN30143310	4
13	VNB1100802	2
14	VNB2760978	1
15	VNB3708174	1
16	VNB4332098	1
17	VNB4332198	1
18	VNB4332998	1
19	VNB4334578	1

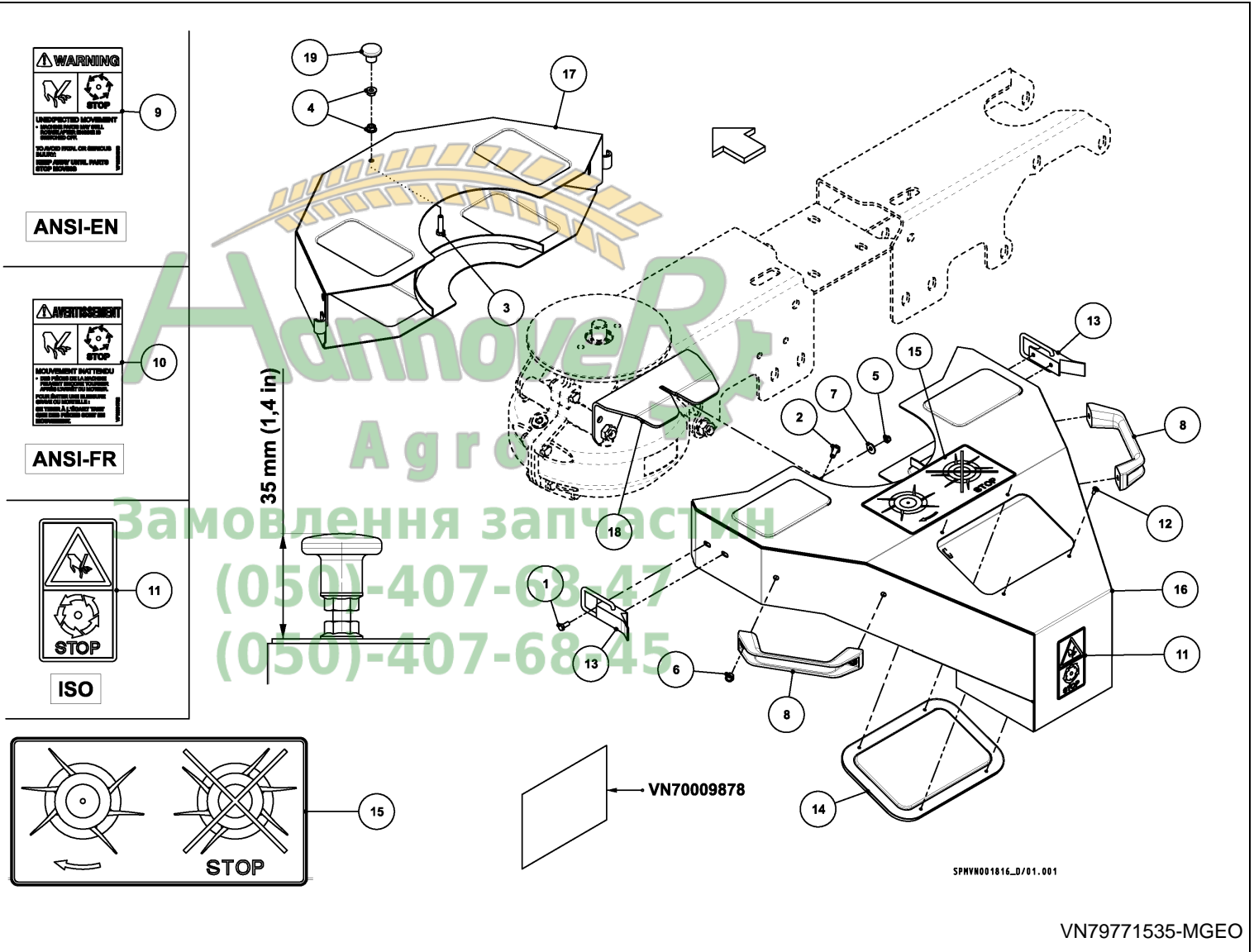

SPHYN001616_D/01.001

VN79771535-MGEO

RO-M GEO / BOUNDARY SPREADING PLATE (2)



PosNo.	Part No.	Qty.
1	A100004700	4
2	A138113078	4
3	A138135402	1
4	A138193002	2
5	A138313594	1
6	A138313694	1
7	A138313894	2
8	A138354530	1
9	KG00497200	8
10	KG00746800	4
11	KG01069800	4
12	KG01069900	16
13	KG01263900	18
14	KG01264000	2
15	KG01901300	4
16	RG00048610	1
17	VF16661496	1
18	VF16661768	1
19	VGTR2059	1
20	VN31419900	2
21	VN38241605	1
22	VN38854581	1
23	VN79771437	1
24	VN80504003	10
25	VNB0450173	1
26	VNB2235978	12
27	VNB4008178	1
28	VNB4808502	1
29	VNB4808802	5
30	VNB5002802	1
31	VNB5003002	2
32	VNB5004394	1

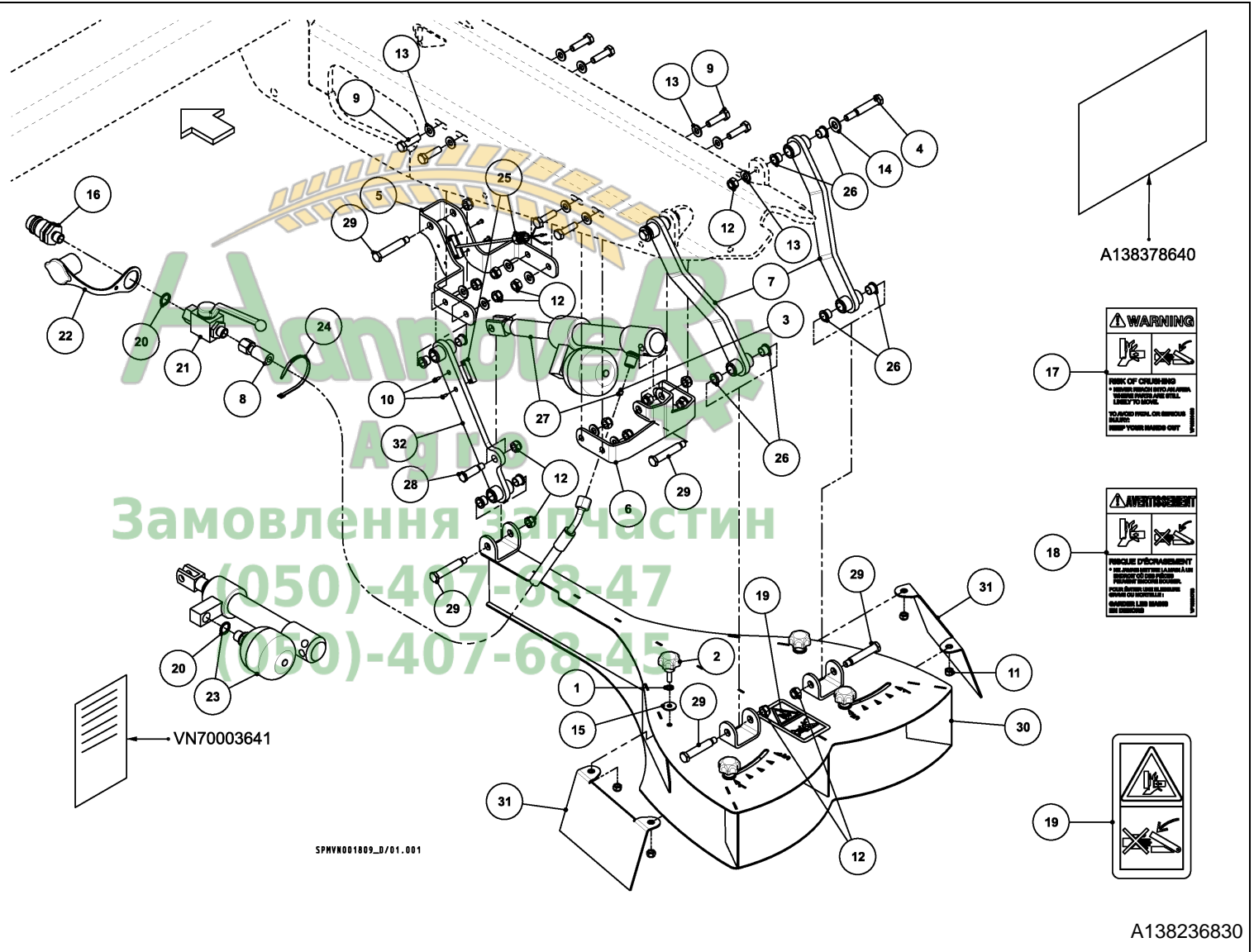

SPHVR001809_0/01.001

A138236830

RO-M GEO / TRIMFLOW



PosNo. Part No. Qty.

1	A138127798	1
2	A138135402	1
3	A138194398	1
4	A138194694	1
5	A138195494	1
6	A138196594	1
7	KG00402500	3
8	KG00402800	1
9	KG00496900	2
10	KG00498800	2
11	KG00746800	4
12	KG00868600	2
13	KG01069700	2
14	KG01069900	3
15	KG01070000	2
16	KG01070300	4
17	KG01263900	2
18	KG01264300	4
19	KG01901500	2
20	RG00048610	1
21	VF16661496	1
22	VF16661768	1
23	VGTR2059	1
24	VN17856588	2
25	VN30117100	2
26	VN31419900	2
27	VN38241605	1
28	VN38854581	1
29	VN79771437	1
30	VN80504003	5
31	VNB0450173	1
32	VNB3281778	8
33	VNB3914302	1
34	VNB4008178	1
35	VNB4192002	1
36	VNB4297478	1
37	VNB4743378	1
38	VNB4769578	8
39	VNB4808802	2

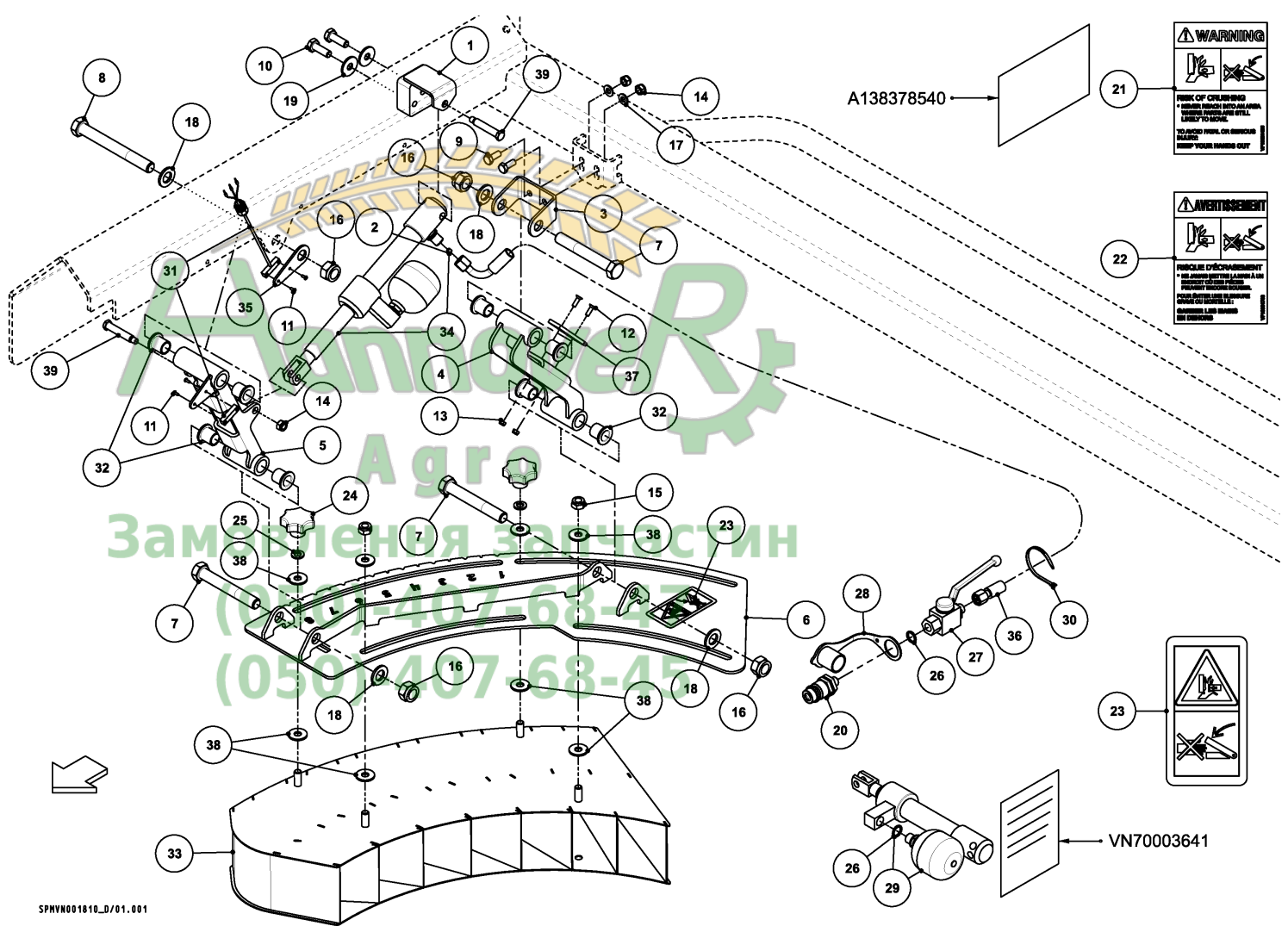

SPM001810_D/01.001

A138236730

RO-M GEO / ELECTRONICS



PosNo.	Part No.	Qty.
1	KG00561500	2
2	KG00562500	3
3	KG01069600	2
4	KG01069700	3
5	MT00002819	1
6	VNB5055402	1

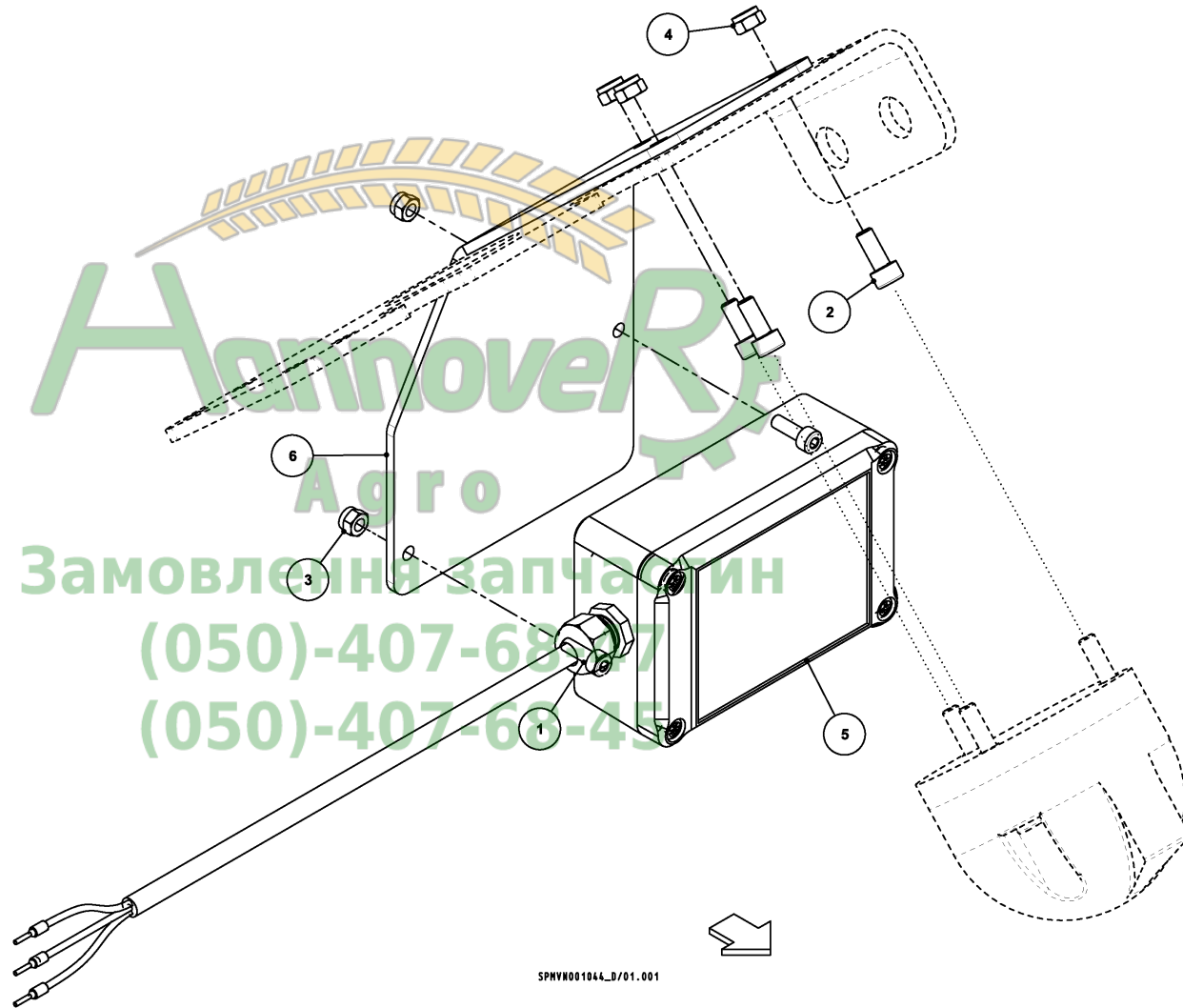

SPHV001044_D/01.001

MT00002817

RO-M GEO / 28 M/92 FT KIT



PosNo.	Part No.	Qty.
1	KG00495200	1
2	KG00497200	2
3	KG01069800	1
4	KG01069900	2
5	KG01901300	2
6	KG01901400	2
7	VN30105200	4
8	VNB2003102	1
9	VNB2003294	1
10	VNB2003302	1
11	VNB4530594	1
12	VNB4956178	4

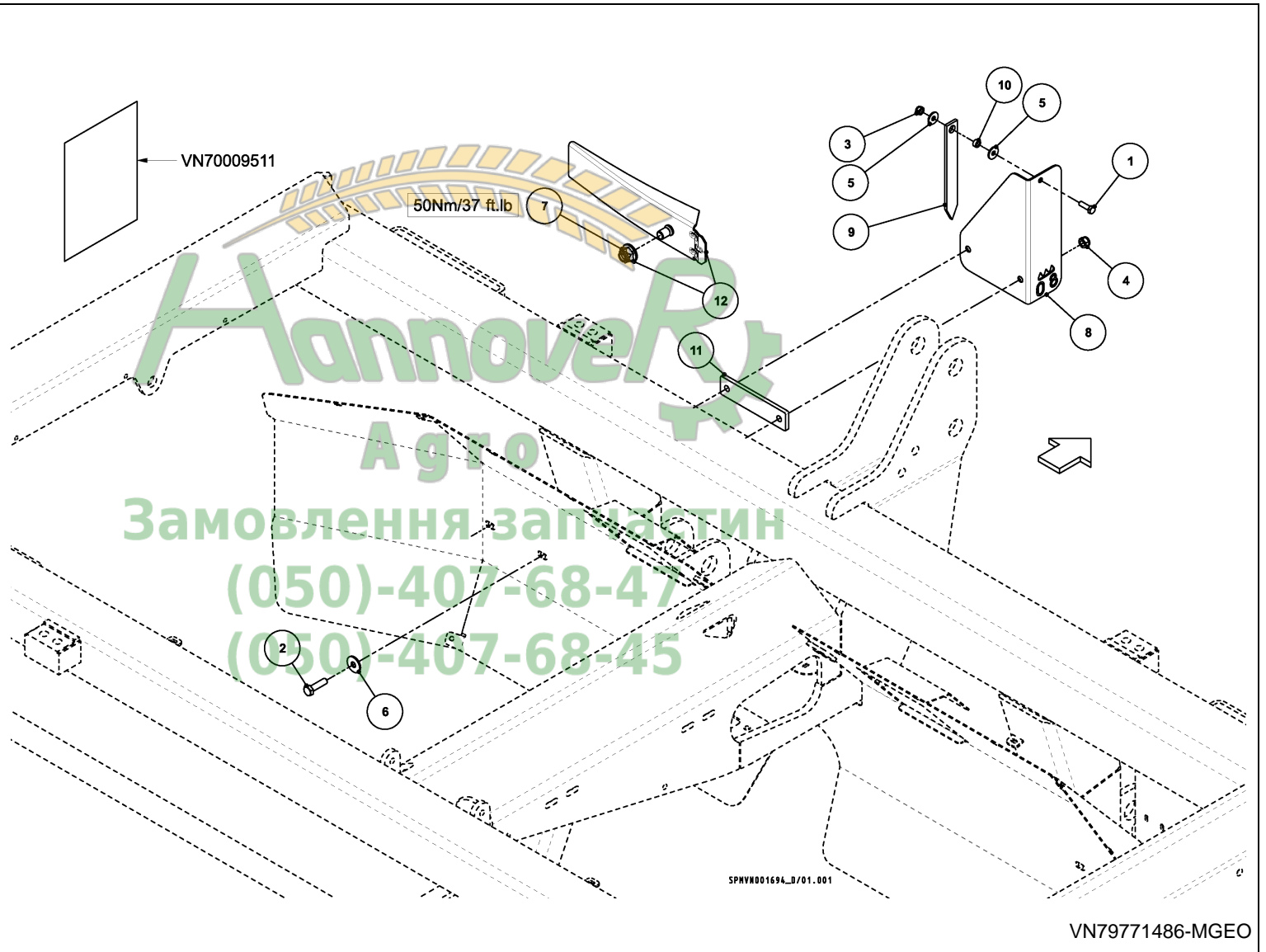

RO-M GEO / FEELER GAUGE



PosNo.	Part No.	Qty.
1	VNB1709302	1
2	VNB1754278	1



SPHYN001042_0/01.001
VN79770216/01.001

VN79770216-01

RO-M GEO / WHEELRINGS



PosNo.	Part No.	Qty.
1	KG00871700	2
2	KG00872200	4
3	KG01069900	6
4	KG01263900	4
5	VNB1153493	4
6	VNB1517586	1
7	VNB2928086	2

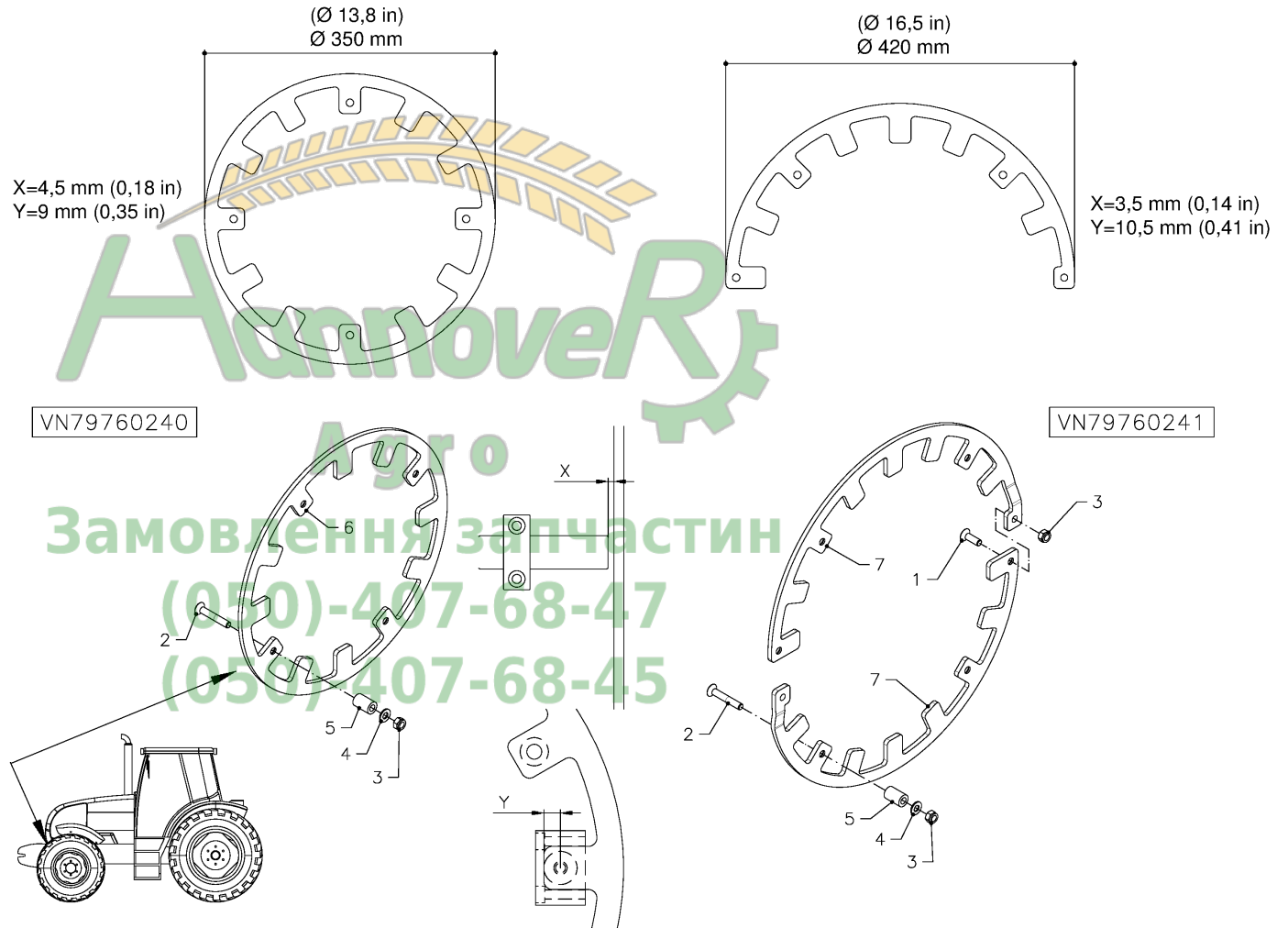

VN79760240-0241

RO-M GEO / GPS SPEED SENSOR



PosNo.	Part No.	Qty.
1	VN79895978	1
2	VNB0305973	1



SPHV000983_D/01.001

VN79895978-VNB0305973

RO-M GEO / Part No Index



Part No.	Page	Pos No	Part No.	Page	Pos No	Part No.	Page	Pos No	Part No.	Page	Pos No
A100004700	24	1	A138234502	4	3	KG00494900	3	1	KG00679900	20	3
A100014562	6	1	A138235894	5	4	KG00495100	23	2	KG00712400	16	4
A136026300	11	1	A138235994	5	5	KG00495200	27	1	KG00738100	1	5
A136074900	11	2	A138236002	2	1	KG00495300	23	3	KG00738100	5	8
A136081400	11	3	A138236186	2	2	KG00496900	5	6	KG00738100	7	3
A136081500	11	4	A138236402	2	3	KG00496900	11	7	KG00738100	16	5
A136081700	11	5	A138266702	6	4	KG00496900	25	9	KG00738100	19	4
A138083578	6	2	A138310165	6	5	KG00497100	5	7	KG00738100	20	4
A138113078	24	2	A138310365	6	6	KG00497100	19	3	KG00738300	20	5
A138127798	25	1	A138310665	6	7	KG00497100	21	1	KG00739600	16	6
A138135402	24	3	A138310865	6	8	KG00497200	16	1	KG00739600	17	2
A138135402	25	2	A138311802	11	6	KG00497200	24	9	KG00742063	12	1
A138155202	19	1	A138313594	24	5	KG00497200	27	2	KG00746800	24	10
A138155402	19	2	A138313694	24	6	KG00497600	10	7	KG00746800	25	11
A138159830	22	1	A138313894	24	7	KG00497600	16	2	KG00868600	21	2
A138186478	5	1	A138315302	6	9	KG00498700	8	4	KG00868600	25	12
A138186502	5	2	A138354530	24	8	KG00498800	9	2	KG00870000	5	9
A138193002	24	4	A138361065	10	6	KG00498800	25	10	KG00870000	8	5
A138194398	25	3	A138361530	9	1	KG00499500	7	1	KG00870200	7	4
A138194694	25	4	A138367202	20	1	KG00500700	2	5	KG00870200	21	3
A138195494	25	5	A138367302	20	2	KG00500900	1	3	KG00871700	30	1
A138196594	25	6	A138368474	13	1	KG00501000	2	6	KG00872200	30	2
A138201730	6	3	A138369074	13	2	KG00501100	1	4	KG00945900	8	6
A138222330	8	1	A138369802	1	2	KG00561500	26	1	KG01044900	7	5
A138227886	1	1	A138430202	8	2	KG00562400	7	2	KG01053500	11	8
A138230594	5	3	A138430602	8	3	KG00562500	26	2	KG01053500	16	7
A138231794	4	1	AC353924	29	1	KG00563000	18	1	KG01053700	4	5
A138233602	10	1	KG00397400	6	10	KG00565700	9	3	KG01053700	16	8
A138233702	10	2	KG00399800	6	11	KG00565800	6	12	KG01053800	7	6
A138233802	10	3	KG00402500	25	7	KG00652700	4	4	KG01059600	1	6
A138233902	10	4	KG00402800	25	8	KG00652900	16	3	KG01059600	2	7
A138234002	10	5	KG00493700	23	1	KG00652900	17	1	KG01059600	18	2
A138234102	4	2	KG00494900	2	4	KG00654300	22	2	KG01059600	23	4

RO-M GEO / Part No Index



Part No.	Page	Pos No	Part No.	Page	Pos No	Part No.	Page	Pos No	Part No.	Page	Pos No
KG01059700	4	6	KG01070000	6	14	KG01901300	27	5	MT00001688	11	12
KG01069600	16	9	KG01070000	8	9	KG01901400	2	11	MT00002021	11	13
KG01069600	26	3	KG01070000	22	4	KG01901400	5	12	MT00002274	11	14
KG01069700	18	3	KG01070000	25	15	KG01901400	16	13	MT00002819	26	5
KG01069700	21	4	KG01070100	1	7	KG01901400	17	5	RG00040217	16	15
KG01069700	23	5	KG01070100	2	9	KG01901400	19	7	RG00040217	23	8
KG01069700	25	13	KG01070100	6	15	KG01901400	21	7	RG00048610	24	16
KG01069700	26	4	KG01070300	25	16	KG01901400	27	6	RG00048610	25	20
KG01069800	5	10	KG01107862	7	8	KG01901500	8	10	RG00050664	22	5
KG01069800	7	7	KG01192062	12	2	KG01901500	16	14	VF16661496	16	16
KG01069800	8	7	KG01192162	6	16	KG01901500	25	19	VF16661496	24	17
KG01069800	19	5	KG01263600	16	11	KG01901600	1	8	VF16661496	25	21
KG01069800	20	6	KG01263600	20	7	KG02000000	12	3	VF16661510	23	9
KG01069800	21	5	KG01263900	4	7	KG02000100	12	4	VF16661768	16	17
KG01069800	23	6	KG01263900	11	10	KG02000200	12	5	VF16661768	24	18
KG01069800	24	11	KG01263900	16	12	KG02000300	12	6	VF16661768	25	22
KG01069800	27	3	KG01263900	17	4	KG02000400	12	7	VF16661782	23	10
KG01069900	2	8	KG01263900	24	13	KG02000500	12	8	VF16661794	12	22
KG01069900	5	11	KG01263900	25	17	KG02000600	12	9	VF16661795	12	23
KG01069900	6	13	KG01263900	30	4	KG02000700	12	10	VGTR1029	12	24
KG01069900	8	8	KG01264000	6	17	KG02000800	12	11	VGTR2023	23	11
KG01069900	9	4	KG01264000	20	8	KG02000900	12	12	VGTR2059	16	18
KG01069900	10	8	KG01264000	24	14	KG02001000	12	13	VGTR2059	24	19
KG01069900	11	9	KG01264100	2	10	KG02001100	12	14	VGTR2059	25	23
KG01069900	16	10	KG01264100	6	18	KG02001200	12	15	VN17856588	25	24
KG01069900	17	3	KG01264300	25	18	KG02001300	12	16	VN30105200	9	6
KG01069900	19	6	KG01283000	7	9	KG02001400	12	17	VN30105200	27	7
KG01069900	21	6	KG01283300	9	5	KG02001500	12	18	VN30105400	20	10
KG01069900	22	3	KG01306700	6	19	KG02001600	12	19	VN30117100	7	11
KG01069900	24	12	KG01421400	7	10	KT56968000	12	20	VN30117100	25	25
KG01069900	25	14	KG01901200	23	7	KT56969000	12	21	VN30117600	11	15
KG01069900	27	4	KG01901300	20	9	MT00001356	10	9	VN30117800	4	8
KG01069900	30	3	KG01901300	24	15	MT00001663	11	11	VN30128821	2	12

RO-M GEO / Part No Index



Part No.	Page	Pos No	Part No.	Page	Pos No	Part No.	Page	Pos No	Part No.	Page	Pos No
VN30128821	4	9	VNB0253473	11	18	VNB2336686	10	11	VNB3970002	7	21
VN30130800	8	11	VNB0305973	31	2	VNB2417578	6	21	VNB3984186	15	1
VN30130800	9	7	VNB0341273	18	7	VNB2426674	3	2	VNB4008178	24	27
VN30143310	2	13	VNB0450173	24	25	VNB2426674	13	5	VNB4008178	25	34
VN30143310	5	13	VNB0450173	25	31	VNB2760978	5	15	VNB4014778	15	2
VN30143310	7	12	VNB0489473	11	19	VNB2760978	23	14	VNB4023502	7	22
VN30143310	23	12	VNB0563673	11	20	VNB2822600	13	6	VNB4042498	7	23
VN31419900	24	20	VNB0566173	8	13	VNB2928086	30	7	VNB4042598	7	24
VN31419900	25	26	VNB0578473	11	21	VNB3281778	25	32	VNB4042702	7	25
VN36107317	8	12	VNB0682965	22	6	VNB3317278	7	14	VNB4049902	10	12
VN36112005	7	13	VNB0765193	1	12	VNB3317378	8	15	VNB4050073	10	13
VN36112032	9	8	VNB0870178	1	13	VNB3358786	1	18	VNB4053474	15	3
VN37601011	1	9	VNB0897393	1	14	VNB3388365	9	10	VNB4059402	7	26
VN37601015	1	10	VNB1063478	19	8	VNB3388402	9	11	VNB4060978	7	27
VN38241605	24	21	VNB1082102	6	20	VNB3405278	29	4	VNB4061702	7	28
VN38241605	25	27	VNB1100802	23	13	VNB3414002	9	12	VNB4061978	7	29
VN38854581	24	22	VNB1153493	30	5	VNB3414102	9	13	VNB4063078	8	16
VN38854581	25	28	VNB1310474	13	3	VNB3443478	16	20	VNB4063178	8	17
VN46120101	1	11	VNB1517586	30	6	VNB3447178	16	21	VNB4064878	6	25
VN48101007	18	4	VNB1599786	1	15	VNB3559902	7	15	VNB4064978	6	26
VN79771219	9	9	VNB1599986	1	16	VNB3588378	6	22	VNB4073178	7	30
VN79771219	29	2	VNB1709302	28	1	VNB3588478	6	23	VNB4077378	7	31
VN79771400	29	3	VNB1754278	28	2	VNB3603398	16	22	VNB4077502	9	15
VN79771437	24	23	VNB1847378	19	9	VNB3603598	16	23	VNB4077602	9	16
VN79771437	25	29	VNB2003102	27	8	VNB3708174	23	15	VNB4078798	16	24
VN79895978	31	1	VNB2003294	27	9	VNB3717802	9	14	VNB4078798	17	6
VN80504001	10	10	VNB2003302	27	10	VNB3734878	6	24	VNB4079098	16	25
VN80504001	11	16	VNB2068778	5	14	VNB3914302	25	33	VNB4079198	17	7
VN80504001	18	5	VNB2071674	13	4	VNB3957302	7	16	VNB4079298	17	8
VN80504003	11	17	VNB2092402	16	19	VNB3957402	7	17	VNB4079398	17	9
VN80504003	18	6	VNB2235978	8	14	VNB3958278	7	18	VNB4105374	13	7
VN80504003	24	24	VNB2235978	24	26	VNB3967598	7	19	VNB4105574	13	8
VN80504003	25	30	VNB2332686	1	17	VNB3967698	7	20	VNB4192002	25	35



RO-M GEO / Part No Index

Part No.	Page	Pos No	Part No.	Page	Pos No	Part No.	Page	Pos No
VNB4218178	15	4	VNB4451978	21	14	VNB4998578	16	31
VNB4225402	7	32	VNB4466478	6	27	VNB5000802	6	28
VNB4239702	7	33	VNB4473502	21	15	VNB5000902	6	29
VNB4270086	5	16	VNB4487278	16	30	VNB5002802	24	30
VNB4270602	5	17	VNB4487278	17	10	VNB5003002	24	31
VNB4281502	3	3	VNB4493474	13	12	VNB5004394	24	32
VNB4297478	25	36	VNB4530594	27	11	VNB5007578	18	8
VNB4306498	16	26	VNB4627794	5	19	VNB5010086	22	7
VNB4306598	16	27	VNB4675302	15	5	VNB5014002	22	8
VNB4306698	16	28	VNB4675402	15	6	VNB5014502	22	9
VNB4309102	16	29	VNB4708802	3	4	VNB5030178	18	9
VNB4319078	5	18	VNB4713902	8	18	VNB5049874	13	15
VNB4332098	23	16	VNB4743378	21	16	VNB5055402	26	6
VNB4332198	23	17	VNB4743378	25	37			
VNB4332998	23	18	VNB4769578	25	38			
VNB4334578	20	11	VNB4789802	7	34			
VNB4334578	23	19	VNB4789902	7	35			
VNB4376974	13	9	VNB4790102	8	19			
VNB4377174	13	10	VNB4790202	8	20			
VNB4377274	13	11	VNB4800374	13	13			
VNB4377474	14	1	VNB4808502	8	21			
VNB4377574	14	2	VNB4808502	24	28			
VNB4377674	14	3	VNB4808802	24	29			
VNB4377774	14	4	VNB4808802	25	39			
VNB4408202	20	12	VNB4916674	9	17			
VNB4408302	20	13	VNB4916674	13	14			
VNB4442278	21	8	VNB4945378	2	14			
VNB4450578	21	9	VNB4955878	9	18			
VNB4451002	20	14	VNB4955978	9	19			
VNB4451198	21	10	VNB4956078	9	20			
VNB4451298	21	11	VNB4956178	9	21			
VNB4451398	21	12	VNB4956178	27	12			
VNB4451498	21	13	VNB4975278	20	15			

AANHAALMOMENTEN / TORQUES / ANZUGSMOMENTE / COUPLES DE SERRAGE / PARES DE APRIETE / BINÁRIOS DE APERTO / MOMENTI DI TORSIONE / MEGHÚZÁSI NYOMATÉKOK

NL Richtlijnen voor aanhaalmomenten in **Nm (ft.lb)** voor zelfborgende moeren, zeskantbouten en moeren.
DE Richtlinien für Anzugsmomente in **Nm (ft.lb)** für selbstsichernde Muttern, Sechskantschrauben und -mutter.
ES Directrices para los pares de apriete en **Nm (ft.lb)** para las tuercas autoblocantes, los tornillos hexagonales y las tuercas.
IT Direttive per momenti di torsione espressi in **Nm (ft.lb)** per dadi autobloccanti, bulloni esagonali e dadi.

EN Guidelines for torques in **Nm (ft.lb)** for self-locking nuts, hexagon bolts and nuts.
FR Directives pour les couples de serrage en **Nm (ft.lb)** pour écrous à autobloquants, boulons à six pans et écrous.
PT Directrizes para os binários de aperto em **Nm (ft.lb)** para porcas autobloqueadoras, parafusos hexagonais e porcas.
HU Előírt meghúzási nyomatékok **Nm-ben (ft.lb)** az önzáró anyákhoz, hatlapfejű csavarokhoz és anyákhoz

Kwaliteit / Quality / Qualität / Qualité / Calidad / Qualidade / Qualità / Minőség	4.6				8.8				10.9				12.9			
	0,10		0,13		0,10		0,13		0,10		0,13		0,10		0,13	
Wrijving / Friction / Reibung / Fricción / Atrito / Attrito / Súrlódás *	0,10		0,13		0,10		0,13		0,10		0,13		0,10		0,13	
Schroefdraad / Thread / Gewinde / Filetage Rosca / Filettatura / Menet	Nm	ft.lb	Nm	ft.lb	Nm	ft.lb	Nm	ft.lb	Nm	ft.lb	Nm	ft.lb	Nm	ft.lb	Nm	ft.lb
M5	1,7	1,3	2	1,5	5	4	6	4	7	5	9	6	8	7	10	7
M6	3	2	4	3	9	7	10	7	13	10	15	11	15	11	18	13
M8	8	6	9	7	21	15	25	18	31	23	36	27	36	27	42	31
M10	16	12	19	14	40	30	50	37	60	44	70	52	70	52	85	63
M12	27	20	32	24	70	52	85	63	105	77	120	89	120	89	145	107
M14	42	31	50	37	115	85	135	100	165	122	195	144	195	144	230	170
M16	65	48	76	56	175	129	210	155	260	192	300	221	300	221	350	258
M18	90	66	110	81	250	185	290	214	350	258	420	310	410	303	490	362
M20	125	92	150	111	350	258	420	310	500	369	600	443	580	428	700	517
M22	170	125	200	148	470	347	560	413	670	494	800	590	780	576	930	686
M24	210	155	250	185	600	443	710	524	860	635	1020	753	1000	738	1180	871

- * **NL** De wrijvingscoëfficiënt van 0,10 geldt voor geoliede plaat, gietijzer, geharde vlakken, vette schroefdraad, etc. De hogere waarde van 0,13 geldt voor een droge plaat. Uitzonderingen op deze tabel zijn vermeld in het onderdelen- en/of instructieboek. Aanhaalmomenten voor bouten en moeren met gekartelde onderkant, zoals Tensilock en Whizlock, 10% extra.
- * **EN** The friction coefficient of 0.10 applies to oiled sheet, cast iron, hardened surfaces, greasy thread, etc. The higher value of 0.13 applies to dry sheet. Exceptions to this table are stated in the parts- and /or instruction manual. Torques for bolts and nuts with a knurled underside, like Tensilock and Whizlock, 10% extra.
- * **DE** Der Reibungskoeffizient von 0,10 gilt für geölte Flächen, Gusseisen, gehärtete Flächen, gefettetes Gewinde usw. Der höhere Wert von 0,13 gilt für trockene Flächen. Ausnahmen zu dieser Tabelle sind im Ersatzteilheft und/oder in der Betriebsanleitung. Anzugsmomente für Schrauben und Muttern mit gerändelter Unterseite, wie Tensilock und Whizlock, zuzüglich 10% extra.
- * **FR** Le coefficient de frottement de 0,10 s'applique aux surfaces huilées, à la fonte, aux surfaces trempées, aux filetages graissés etc. Le coefficient de 0,13 aux surfaces sèches. Les exceptions à se tableau sont mentionnées dans la nomenclature des pièces et/ou dans le manuel d'emploi. Ajoutez 10% pour les boulons et écrous à partie inférieure crnelée, comme les Tensilock et les Whizlock.
- * **ES** El coeficiente de fricción de 0,10 es indicado para planchas lubricadas, hierro fundido, superficies endurecidas, rosca grasienta, etc. El valor más alto de 0,13 es para planchas secas. Las excepciones a este cuadro se mencionan en el libro de repuestos y/o manual de instrucciones. Los pares de apriete para tornillos y tuercas con cara inferior dentada, como los Tensilock y Whizlock, 10% extra.
- * **PT** O coeficiente de atrito de 0.10 aplica-se às superfícies olcadas, ao ferro fundado, às superfícies temperadas, às roscas emassadas etc. O coeficiente de 0.13 às superfícies secas. As exceções a este quadro estão mencionadas na nomenclatura das peças e/ou no manual de instruções. Os binarios de aperto para porcas e parafusos cujas bases sejam serradas (Tensilock, Whizlock) devem ser aumentados em 10%.
- * **IT** Il coefficiente di frizione pari a 0,10 si riferisce a superfici oliate, alla ghisa, a superfici temprate, a filettature spesse ecc. Il valore più alto, npari a 0,13, si riferisce a superfici asciutte. Tutte le eccezioni a quanto riportato in questa tabella, si trovano nel libretto dei pezzi o nel libretto delle istruzioni. I momenti torcenti per bulloni e dadi la cui parte inferiore è zigrinata, come i Tensilock (K 100) e Whizlock, sono superiori del 10%.
- * **HU** A 0,10 súrlódási tényező az olajozott lemezekre, öntöttvasra, edzett felületekre, zsírozott menetre, stb alkalmazható. A 0,13 asmagasabb érték a száraz lemezekre alkalmazható. E táblázat alól kivételt képező tételek az alkatrészeknél és/vagy a gépkönyvekben vannak felsorolva. A meghúzási nyomaték az alsó peremen bordázott csavarok és anyák esetében 10%-kal nagyobb, pl. Tensilock (K100) és Whizlock.

TILSTRAMMINGSMOMENTER / TILSPÆNDINGSMOMENTER/ VRIDMOMENT / VÄÄNTÖMOMENTIT / MOMENTY OBROTOWE / UTAHOVACÍ MOMENTY / PRIVIJALNI MOMENTI / MOMENTE DE TORSIUNE

DA Retningslinier for tilspændingsmomenter i **Nm (ft.lb)** for selvåsende møtrikker, sekskantbolte og møtrikker.

SV Anvisningar för vridmoment i **Nm (ft.lb)** för självåsende muttrar, sexkantiga bultar och muttrar.

PL Wytyczne dotyczące momentów obrotowych w **Nm (ft.lb)** nakrętek samozabezpieczających, śrub z łbem sześciokątnym i nakrętek.

SL Navodila za privijalne (navorne) momente v **Nm (ft.lb)** za matice in vijake.

NO Retningslinjer for tilstrammingsmomenter i **Nm (ft.lb)** for selvåsende muttere, sekskantbolter og muttere.

FI Väätömomentteja koskevat ohjeet **Nm (ft.lb)** itsevarmistaville muttereille, kuusioruuveille ja -muttereille.

CS Směrnice pro utahovací momenty v **Nm (ft.lb)** pro samosvorné matice, šrouby a matice s šestihran hlavou

RO Prevederi privind momentele de torsiune **Nm (ft.lb)** pentru piulițele cu autoblocare, șuruburile și piulițele hexagonale.

Kvalitet / Laatu / Jakość / Jakost / Kvaliteta / Calitate	4.6				8.8				10.9				12.9			
	0,10		0,13		0,10		0,13		0,10		0,13		0,10		0,13	
Friktion / Friksjon / Kitka / Tarcie / Třeni / Trenje / Frezare *	0,10		0,13		0,10		0,13		0,10		0,13		0,10		0,13	
Gevind / Skruegjenge / Gänga / Kierre / Gwint / Závít / Navoj / Filet	Nm	ft.lb	Nm	ft.lb	Nm	ft.lb	Nm	ft.lb	Nm	ft.lb	Nm	ft.lb	Nm	ft.lb	Nm	ft.lb
M5	1,7	1,3	2	1,5	5	4	6	4	7	5	9	6	8	7	10	7
M6	3	2	4	3	9	7	10	7	13	10	15	11	15	11	18	13
M8	8	6	9	7	21	15	25	18	31	23	36	27	36	27	42	31
M10	16	12	19	14	40	30	50	37	60	44	70	52	70	52	85	63
M12	27	20	32	24	70	52	85	63	105	77	120	89	120	89	145	107
M14	42	31	50	37	115	85	135	100	165	122	195	144	195	144	230	170
M16	65	48	76	56	175	129	210	155	260	192	300	221	300	221	350	258
M18	90	66	110	81	250	185	290	214	350	258	420	310	410	303	490	362
M20	125	92	150	111	350	258	420	310	500	369	600	443	580	428	700	517
M22	170	125	200	148	470	347	560	413	670	494	800	590	780	576	930	686
M24	210	155	250	185	600	443	710	524	860	635	1020	753	1000	738	1180	871

* **DA** Friktionskoefficienten på 0,10 gælder for smurte flader, støbejern, hærdede overflader, fedtholdige gevind etc. Den højere værdi på 0,13 gælder for tørre flader. Undtagelser til tabellen er angivet i reservedels- og/eller instruktionsbog. Når det drejer sig om momenter for bolte og møtrikker med en riflet underside, som Tensilock (K100) og Whizlock, skal der tilføjes 10% ekstra.

* **NO** Friksjonskoeffisienten på 0,10 gjelder for smurt plate, støpejern, herdete flater, innfettete gjenger etc. Den høyere verdien på 0,13 gjelder for tørr plate. Unntak fra denne tabellen er angitt i deleboken og/eller i instruksjonsboken. Tiltrekkingsmomenter for skruer og mutre med riflet underkant, som Tensilock (K100) og Whizlock 10% tillegg.

* **SV** Friktionskoefficienten 0,10 gäller oljad plåt, gjutjärn, härdade ytor, smorda gängor etc. Det högre värdet 0,13 gäller torr plåt. Undantag från denna tabell anges i reservedels- och/eller instruktionsboken. Åtdragningsmoment för räfflade bultar och muttar, som Tensilock och Whizlock 10% extra.

* **FI** Kitkakerroin 0,10 koskee öljytyyjä pintoja, valurautaa, karkaistuja pintoja, rasvattuja kierteitä jne. Korkeampi arvo 0,13 koskee kuivia pintoja. Poikkeukset tästä taulukosta löytyvät varaosaletisistä ja/tai käyttöohjeista. Ruuvien ja muttereiden, joissa on pyälletty alapuoli, kuten Tensilock ja Whizlock, väätömomentteihin lisätään 10 %.

* **PL** Współczynnik tarcia 0,10 dotyczy płyty oliwonej, żeliwa, powierzchni hartowanych, nasmarowanych gwintów, itp. Wyższy współczynnik 0,13 dotyczy płyty suchej. Wyjątki od niniejszej tabeli podano w katalogu części i/lub instrukcji. Momenty obrotowe zwiększają się o dodatkowe 10% w przypadku śrub i nakrętek z radełkowanym spodem, jak na przykład, Tensilock (K100) o Whizlock.

* **CS** Koeficient třeni 0.10 platí pro naolejovaný plech, litinu, kalené povrchy, namazaný závít a tak dále. Vyšší hodnota 0.13 platí pro suchý plech. Výjimky z této tabulky jsou uvedeny v seznamu náhradních dílů a/nebo v provozním návodu. Utahovací momenty pro šrouby a matice s rýhovanou spodní stranou 10% navíc, jako např. Tensilock (K100), Whizlock.

* **SL** Koeficient trenja 0,10 velja za naoljene površine, litino, kovane površine, namazane navoje itd. Višja vrednost 0,13 velja za suhe površine. Izjeme v tej tabeli so v zvezku rezervnih delov ali pa v navodilu o uporabi navedene. Navornim momentom za vijake in matice z naribano spodnjo površino, kot so Tensilock (K100) in Whizlock, dodamo 10%.

* **RO** Coeficientul de frecare de 0,10 este valabil în cazul suprafețelor lubrificate, fontei, suprafețelor întărite, filetelor lubrificate etc. Valoarea mai mare, de 0,13, este valabilă pentru suprafețe uscate. Excepțiile de la valorile descrise în acest tabel sunt menționate în manualul cu privire la componente sau în manualul de instrucțiuni. Momentele de torsiune pentru șuruburi și piulițe cu partea inferioară canelată, de exemplu Tensilock și Whizlock - 10% în plus.

МОМЕНТ ЗАТЯГИВАНИЯ / PÖÖRDEMOMENDID / SUKIMO MOMENTAI / PIEVILKŠANAS GRIEZES MOMENTA VĒRTĪBAS

RU Указания для моментов затягивая в **Nm (ft.lb)** для самоблокирующихся гаек, шестигранных болтов и гаек. **ET** Iselukustuvate mutrite, kuuskantpoltide ja mutrite soovituslikud pöördemomendid **Nm (ft.lb)**.

LT Nurodymai dėl savaimė fiksuojamų, šešiakampių varžtų ir veržlių sukimo momentų **Nm (ft.lb)**.

LV Vadlīnijas pašbloķējošu uzgriežņu, sešskaldņu skrūvju un uzgriežņu pievilksanas griezes momenta vērtībām **Nm (ft.lb)**.

Качество / Kvaliteet / Kokybė / Kvalitāte	4.6				8.8				10.9				12.9			
	0,10		0,13		0,10		0,13		0,10		0,13		0,10		0,13	
Трение / Hõõrdetegur / Trintis / Berze *																
Резьба / Keere / Sriegis / Vītne	Nm	ft.lb	Nm	ft.lb	Nm	ft.lb	Nm	ft.lb	Nm	ft.lb	Nm	ft.lb	Nm	ft.lb	Nm	ft.lb
M5	1,7	1,3	2	1,5	5	4	6	4	7	5	9	6	8	7	10	7
M6	3	2	4	3	9	7	10	7	13	10	15	11	15	11	18	13
M8	8	6	9	7	21	15	25	18	31	23	36	27	36	27	42	31
M10	16	12	19	14	40	30	50	37	60	44	70	52	70	52	85	63
M12	27	20	32	24	70	52	85	63	105	77	120	89	120	89	145	107
M14	42	31	50	37	115	85	135	100	165	122	195	144	195	144	230	170
M16	65	48	76	56	175	129	210	155	260	192	300	221	300	221	350	258
M18	90	66	110	81	250	185	290	214	350	258	420	310	410	303	490	362
M20	125	92	150	111	350	258	420	310	500	369	600	443	580	428	700	517
M22	170	125	200	148	470	347	560	413	670	494	800	590	780	576	930	686
M24	210	155	250	185	600	443	710	524	860	635	1020	753	1000	738	1180	871

* **RU** Коэффициент трения в 0,10 относится к смазанным плитам, чугуноу, затвердевшим поверхностям резьбе с нанесенной смазкой и т.д. Более высокое значение в 0,13 относится к сухим плитам. Исключения для данной таблицы указаны в брошюре с описанием рабочих деталей и/или инструкции по эксплуатации. Моменты затягивания для болтов и гаек с зазубренной стороной выше на 10% для таких как, Tensilock (k 100) и Whizlock.

* **ET** Hõõrdetegur 0,10 kehtib õlitatud plaatide, valuraua, tugevdatud pindade, määrdega keermete jne kohta. Kõrgem väärtus 0,13 kehtib kuivadele plaatidele. Erinevused sellest tabelist on kirjas osade nimistus ja/või kasutusjuhendis. Rihveldatud alaosa poltide ja mutrite, näiteks Tensilock ja Whizlock, pöördemomendid on 10% suuremad.

* **LT** Trinties koeficientas 0,10 taikomas suteptiems lakštams, ketui, grūdintiems paviršiams, suteptiems sriegiams ir t.t. Didesnė vertė (0,13) taikoma sausai skardai. Šios lentelės išimty nurodytos dalių knygelėje ir (arba) instrukcijoje. Varžtų ir veržlių su sraigine įraiža (pvz., „Tensilock“ ir „Whizlock“) sukimo momentai didesni 10 %.

* **LV** Berzes koeficients 0,10 attiecas uz eļļotām plāksnēm, čugunu, rūdītām virsmām, eļļotām vītņēm utt. Augstāks koeficients 0,13 attiecas uz sausām plāksnēm. Atkāpes no tabulā norādītājām vērtībām ir norādītas rezerves daļu sarakstā un/vai rokasgrāmatā. Skrūvju un uzgriežņu ar rievotu apakšējo daļu pievilksanas griezes momenta vērtības jāpalielina par papildu 10 %.



Замовлення запчастин

(050)-407-68-47

(050)-407-68-45



RO-M GEO

01001 < Mach. ID <=

Kverneland Group Nieuw-Venep
Kverneland Group Nieuw-Venep BV
Hoofdweg 1278
2153 LR Nieuw-Venep
Netherlands
+31 252 662244
+31 252 662173



Замовлення запчастин

(050)-407-68-47

(050)-407-68-45

© Kverneland Group

All rights reserved. No parts of this book may be reproduced, stored in a database or retrieval system, or published in any form or in any way, electronically, mechanically, optically, by print, photo print, microfilm (including micro and macro fiche), or any other means, including all video and CD systems, without prior written permission from the publisher.

Print date: 2016-01-06

