

Замовлення запчастин
RO-EDW GEO
(050)-407-68-47
(050)-407-68-45

Spare Parts Manual

Article number: VN70010046
Language: EN
Production year (from): 2011
Prod. Series nr (from): VN22100
01001 < Mach. ID <=



Замовлення запчастин

(050)-407-68-47

(050)-407-68-45

RO-EDW GEO / Table of Contents



PosNo.	Assembly group	Page
1	FRAME	1
2	PROTECTION	2
2	PROTECTION	3
3	HOPPER AND SIEVE (1500 L)	4
3	HOPPER AND SIEVE (1875 L)	5
4	LIGHTING	6
5	DRIVE	7
6	DOSAGE	8
7	DISC, BROADCASTER	9
8	CONTROL, ISO	10
8	CONTROL, ISO	11
12	UNIV. JOINT SHAFT	12
13	DECAL SCHEMATIC	13
13	DECAL SCHEMATIC	14
99	ACCESSORIES	15
99	HOPPER EXTENSION (1500 L)	16
99	HOPPER EXTENSION (1875 L)	17
99	TARPAULIN (1500 L)	18
99	TARPAULIN (1875 L)	19
99	HOPPER EMPTYING SET	20
99	SCOOP SET	21
99	LADDERSET	22
99	WHEELSET	23
99	CALIBRATION CONTAINER	24
99	BOUNDARY SPREADING PLATE	25
99	TRIMFLOW	26
99	FEELER GAUGE	27
99	SPREADING PATTERN CONTROLSET	28

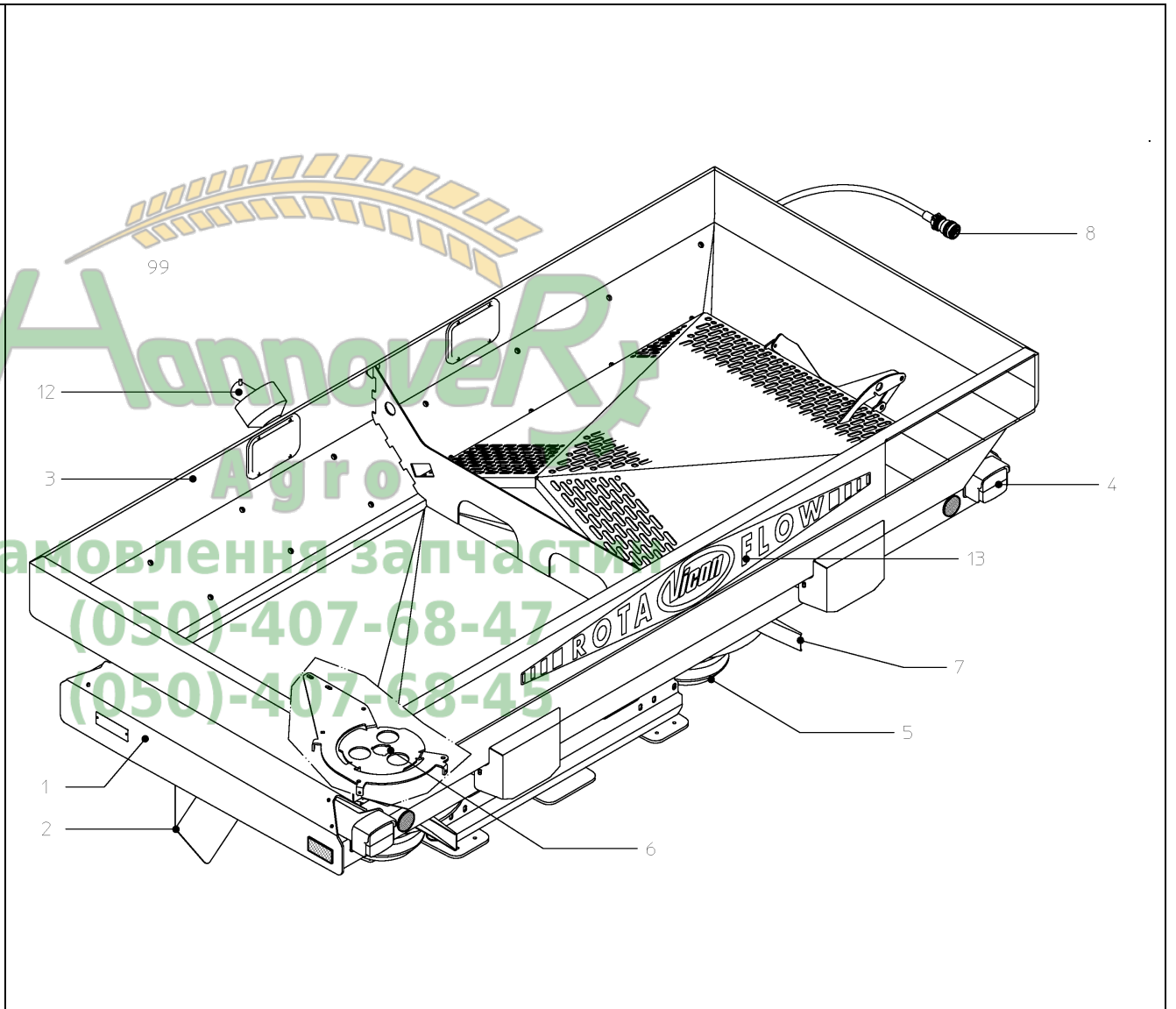

RO-EDW GEO / FRAME



PosNo.	Part No.	Qty.
1	VNB4281086	1
2	VNB1599794	1
3	VNB0897393	1
4	VNB0870178	1
5	VNB3358794	1
6	KG00501000	2
7	KG01070100	3
8	VNB2332694	1
9	KG01901600	2
10	KG00501200	1
11	KG01069800	1
12	VNB1599994	2
13	VNB0765193	2
14	VN30128821	2
15	VN37601011	2
16	KG01069900	2
17	VNB2003102	1
18	KG00495200	1
19	KG01901300	2
20	VNB2003302	1
21	VNB2003294	1
22	VN37601015	2

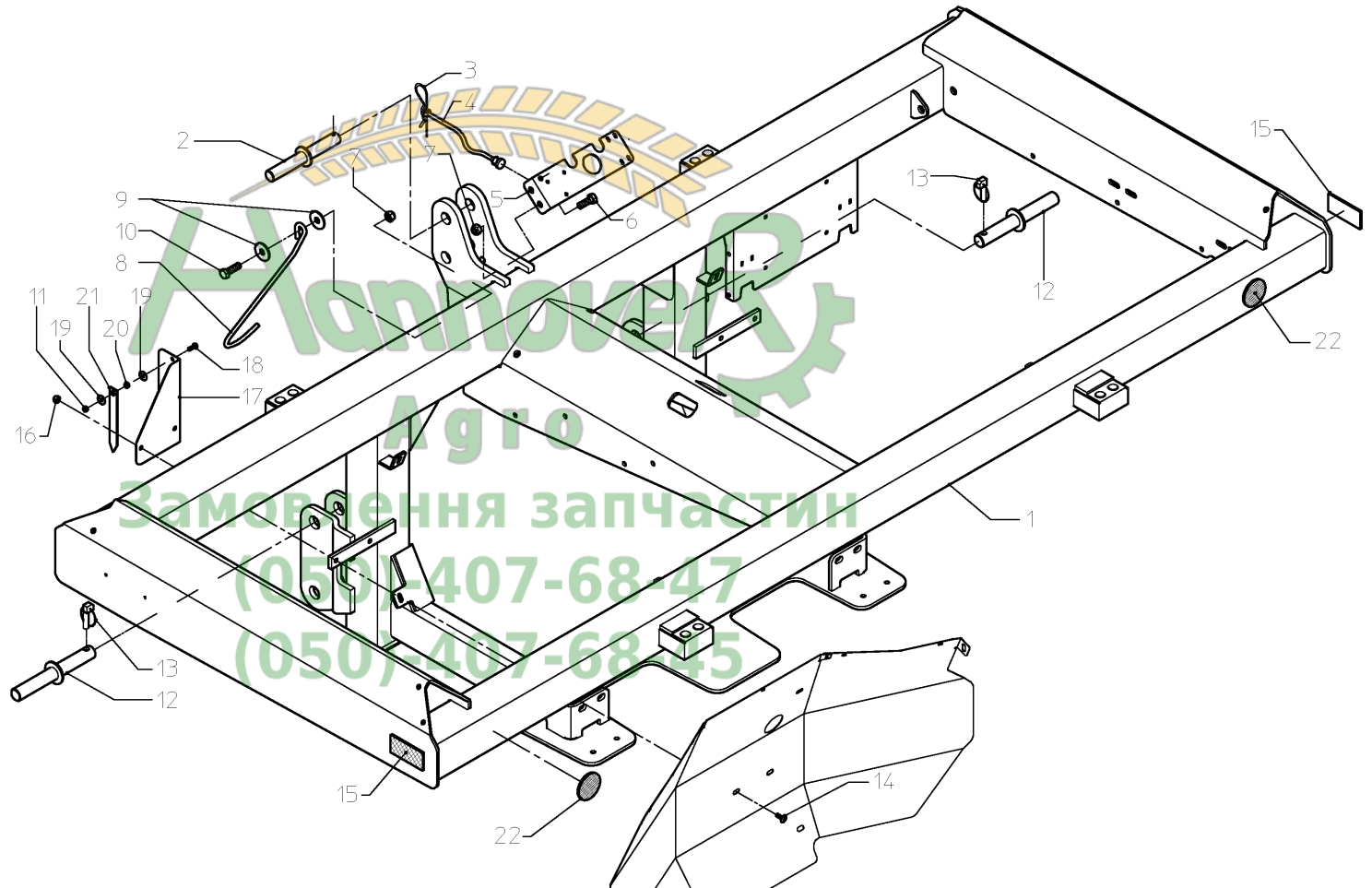

ROEDW_VN20802_N01

RO-EDW GEO / PROTECTION



PosNo.	Part No.	Qty.
1	VNB4344486	1
2	VN30128821	8
3	KG01901400	8
4	KG01069900	8
5	VNB4708802	4
11	VNB4780478	2
12	VNB4281502	1
13	VNB2426674	1
14	KG00494900	10
15	KG01059600	6
16	KG00501000	8
17	KG01264100	16
18	KG01070100	8
19	VNB4381402	1
20	VNB4381502	1
21	VNB4253078	2

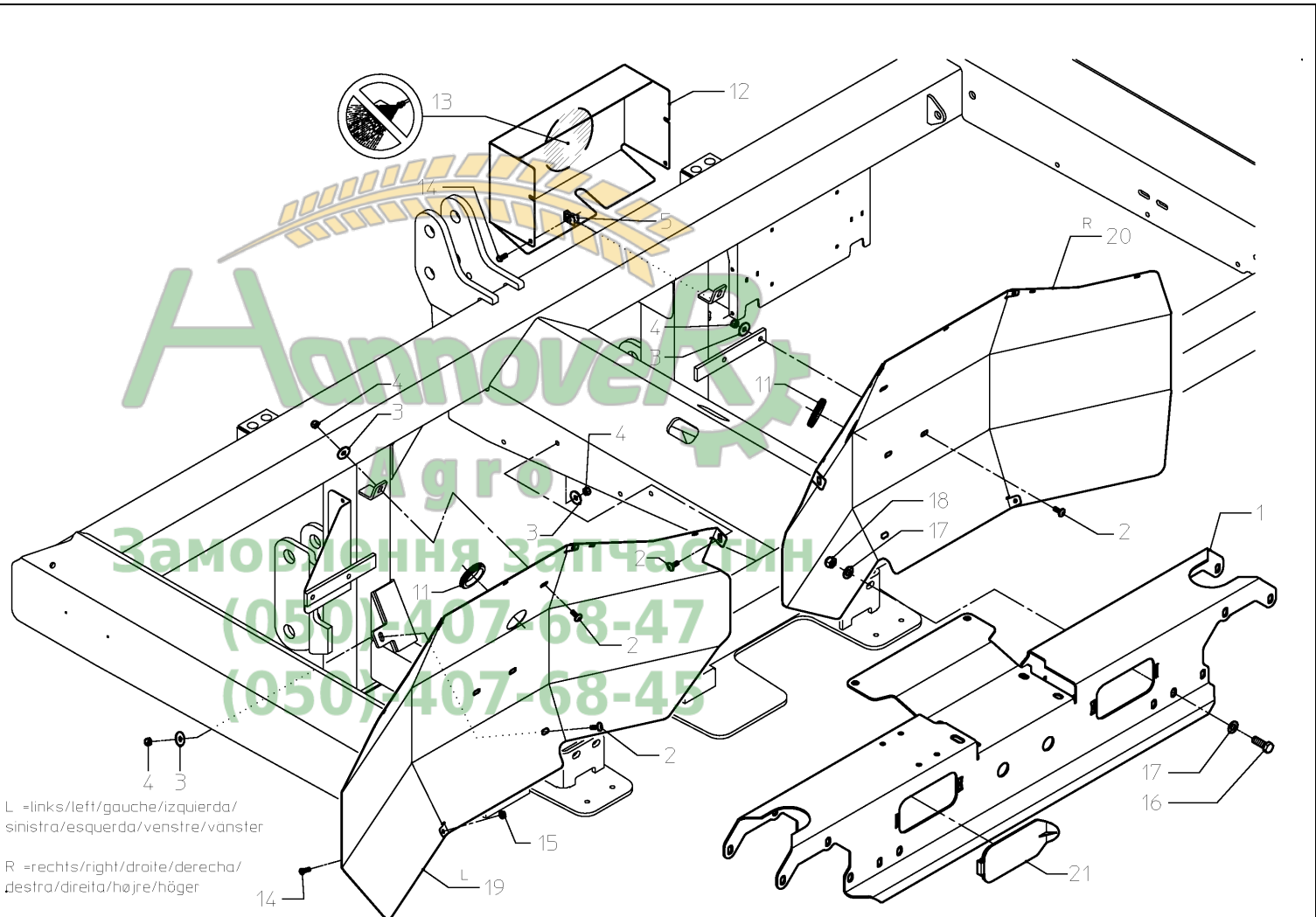

L = links/left/gauche/izquierda/
sinistra/esquerda/venstre/vanster

R = rechts/right/droite/derecha/
destra/direita/højre/höger

ROEDW_VN20803_P02

RO-EDW GEO / PROTECTION



PosNo.	Part No.	Qty.
1	VNB4281294	2
2	VNB4190102	4
5	KG00739400	8
6	KG01263900	8
7	KG01059700	8
8	VN30117100	32
9	KG01053800	32
10	KG00654300	32

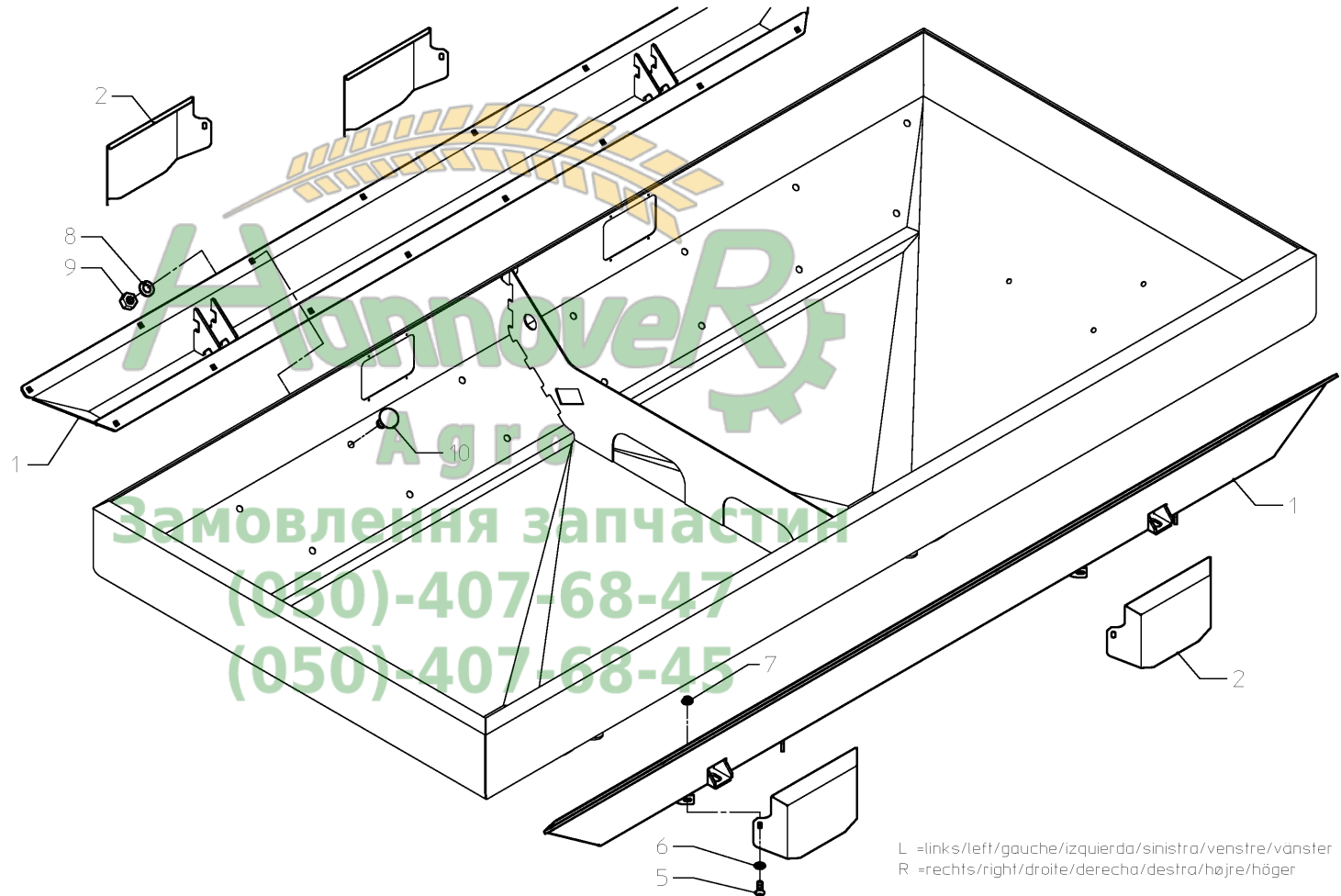

ROEDW_VN20802_N03

RO-EDW GEO / HOPPER AND SIEVE (1500 L)



PosNo.	Part No.	Qty.
1	VNB4261794	1
2	VNB4277786	2
3	VNB4277994	1
4	VNB4278094	1
5	KG00498700	6
6	KG01264000	6
7	KG01070000	6
11	VNB2068778	4
12	VNB2760978	4
13	VN30143310	16
14	VNB4319078	2
15	KG01901500	6
16	VNB4627794	2
17	KG00497100	6
18	KG01901400	6
19	VNB4270602	6
20	KG01069900	6
21	VNB4627578	2
22	KG00870000	6
23	KG01069800	6

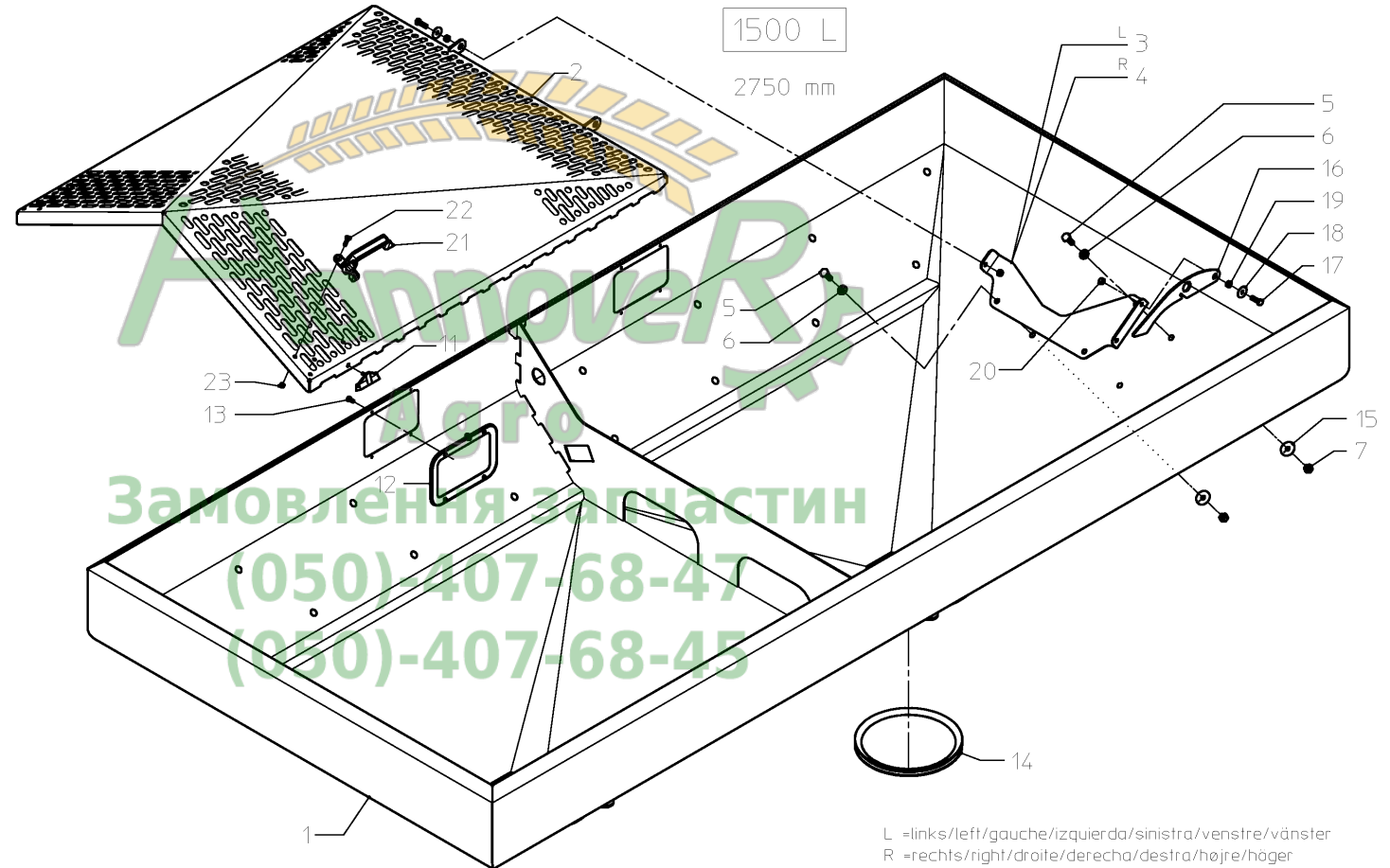

ROEDW_VN20802_N04

RO-EDW GEO / HOPPER AND SIEVE (1875 L)



PosNo.	Part No.	Qty.
1	VNB4363594	1
2	VNB4277786	2
3	VNB4277994	1
4	VNB4278094	1
5	KG00498700	6
6	KG01264000	6
7	KG01070000	6
11	VNB2068778	4
12	VNB2760978	4
13	VN30143310	16
14	VNB4319078	2
15	KG01901500	6
16	VNB4627794	2
17	KG00497100	6
18	KG01901400	6
19	VNB4270602	6
20	KG01069900	6
21	VNB4627578	2
22	KG00870000	6
23	KG01069800	6

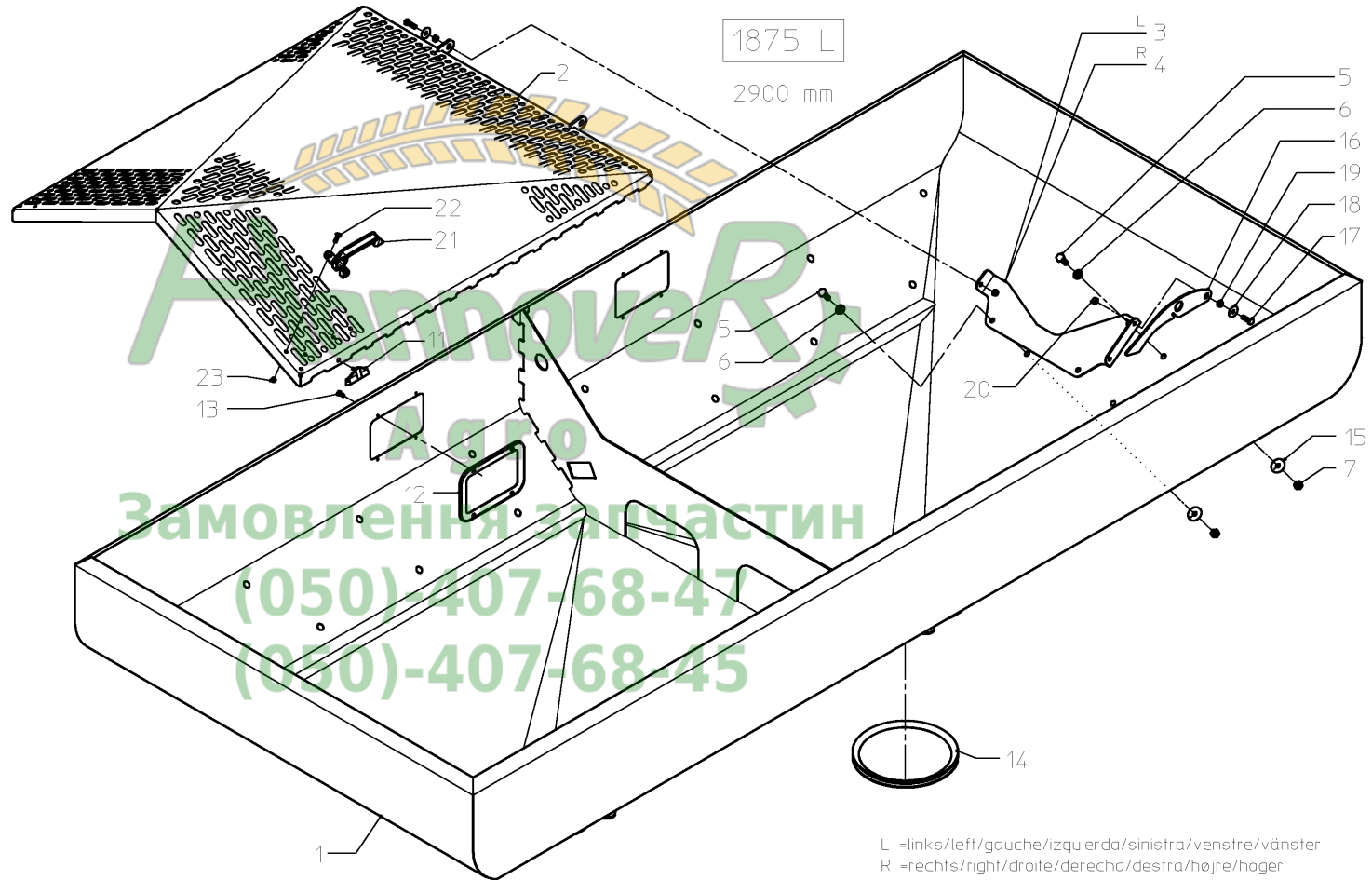

ROEDW_VN20802_N05

RO-EDW GEO / LIGHTING



PosNo.	Part No.	Qty.
1	VNB4281602	1
2	VNB4281702	1
3	KG01069900	4
4	VN48523002	4
5	VN48523001	2
6	KG00739400	4
7	KG01283000	7
8	KG01053400	7
9	VNB4255678	1
10	VN80504003	12
11	VN80504001	2
12	VNB0341273	1
13	KG00714100	3
14	KG01263900	4
15	VN48101007	1
16	VNB3620578	2
19	VNB3452478	1
20	VNB3452378	1

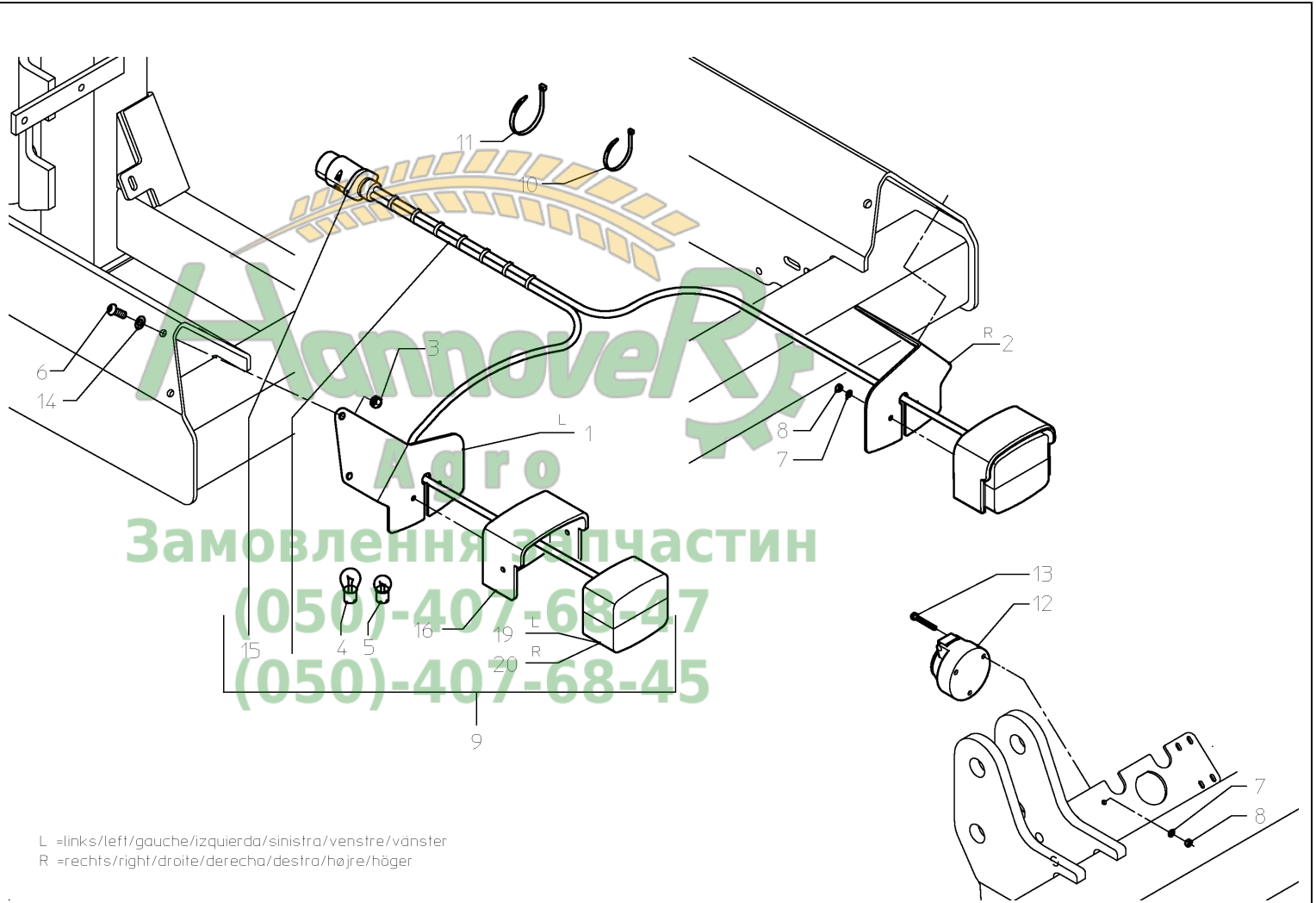

L =links/left/gauche/izquierda/sinistra/venstre/vänster
 R =rechts/right/droite/derecha/destra/højre/höger

ROEDW_VN20802_N06

RO-EDW GEO / DRIVE



PosNo.	Part No.	Qty.
2	KG01264100	20
4	KG01070100	10
5	VNB4064878	1
6	VNB4064978	1
7	KG00399800	6
9	KG00739600	12
10	VNB4668593	4
11	VNB2417578	4
12	VNB2417602	24
13	KG01263900	12
14	KG01069900	28
15	VNB4347993	2
16	VNB4348393	2
17	VNB4348193	2
18	VNB4341978	1
19	KG00399400	4
21	VNB0682993	2
22	VNB4466478	2
23	VNB3550678	1
25	VNB3588378	4
26	VNB3588478	4
36	VNB4348493	4
38	VNB4466678	1
40	RG00050664	12
41	VNB3910902	4

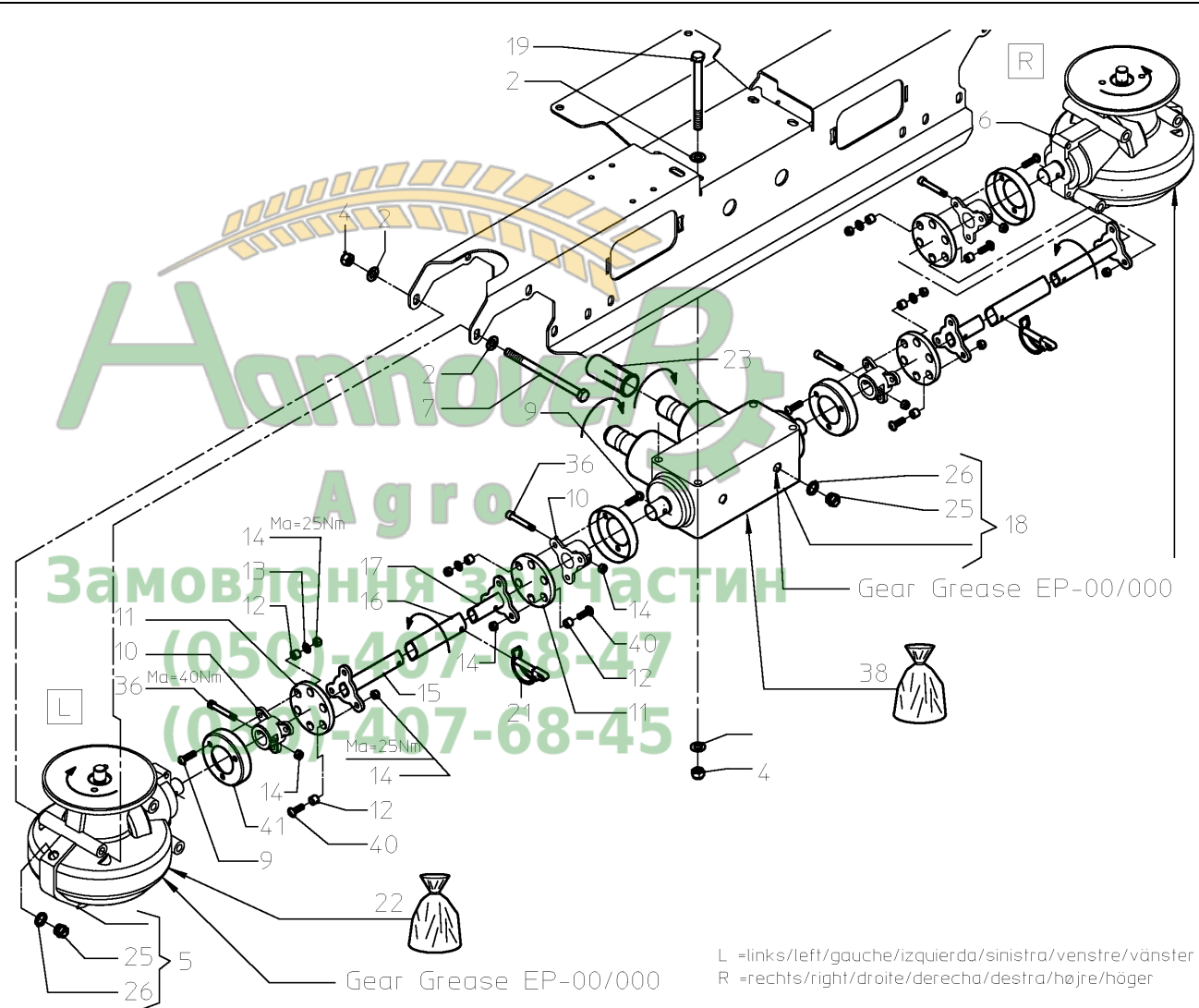

L =links/left/gauche/izquierda/sinistra/venstre/vänster
 R =rechts/right/droite/derecha/destra/højre/höger

ROEDW_VN20802_N07

RO-EDW GEO / DOSAGE



PosNo.	Part No.	Qty.
42	VN36107317	4
43	VN30130800	4
44	KG00945900	4
45	VNB4808502	8
46	KG01069900	8
48	VNB4063078	1
49	VNB4063178	1
50	KG00870200	6
51	VNB4790102	1
52	VNB4790202	1
53	VNB4790302	1
54	VNB4790402	1

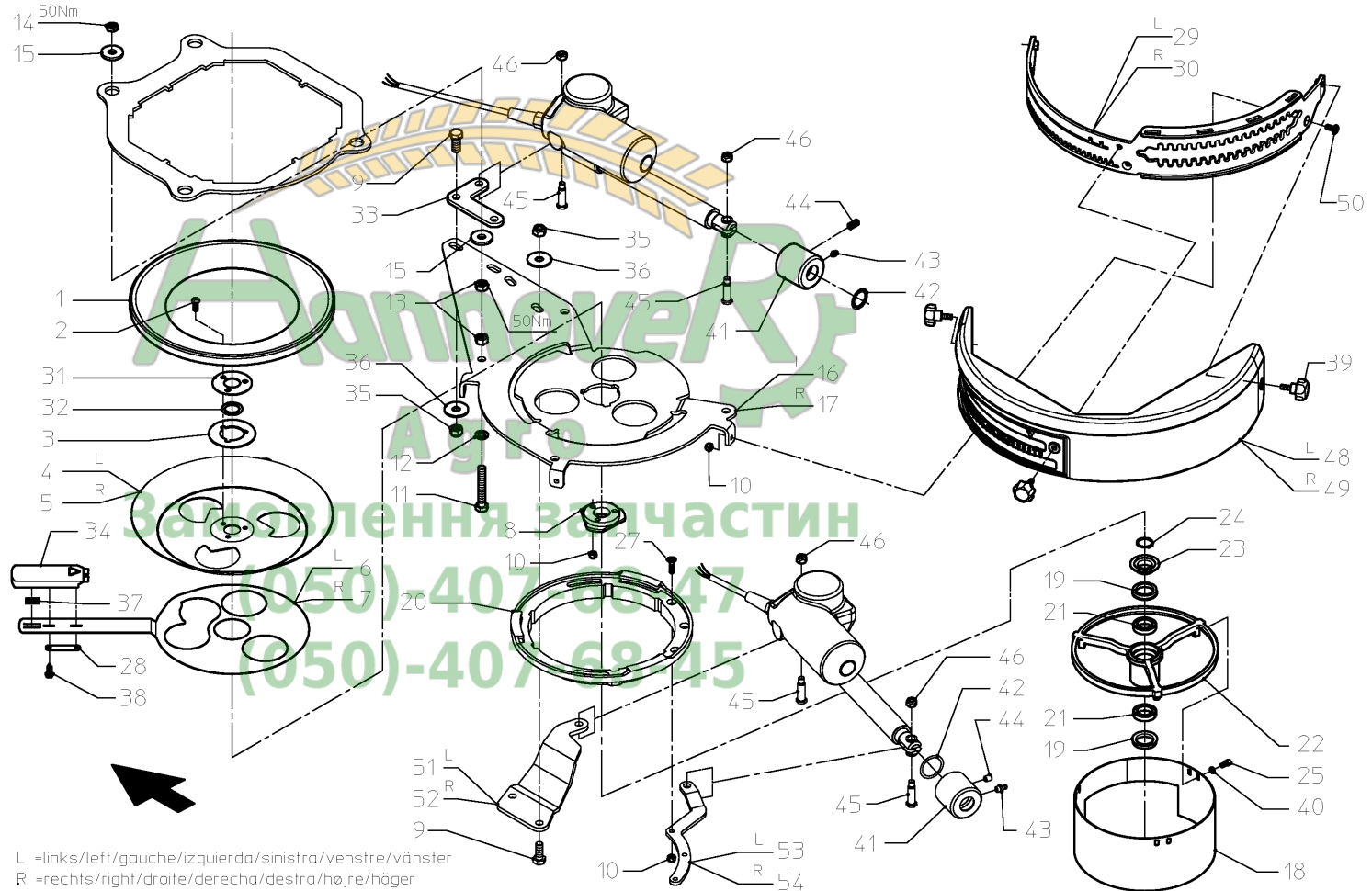

ROEDWGEO_VN22100_P08

RO-EDW GEO / DISC, BROADCASTER



PosNo.	Part No.	Qty.
1	VNB3414002	1
2	VNB1194874	1
3	VNB3414102	1
4	VNB1181374	1
5	VNB3388365	2
6	KG00498800	4
7	VNB3388402	2
8	VNB4077502	1
9	VNB4077602	1
10	VNB3717802	2
11	KG00565700	2
12	KG01069900	2
13	VNB1082102	12
14	VNB1060002	12
15	VN36112032	2
16	VN30130800	4
17	KG01283300	4
28	VN79771219	1

L =links/left/gauche/izquierda/sinistra/venstre/vänster
 R =rechts/right/droite/derecha/detra/højre/höger

Smeren : Dagelijks en na het schoonmaken
 Lubricate : Daily and after cleaning
 Graisser : Quotidien et après nettoyage
 Schmierer: Täglich und nach dem Reinmachen
 Lubricación Diaria y despues limpieza

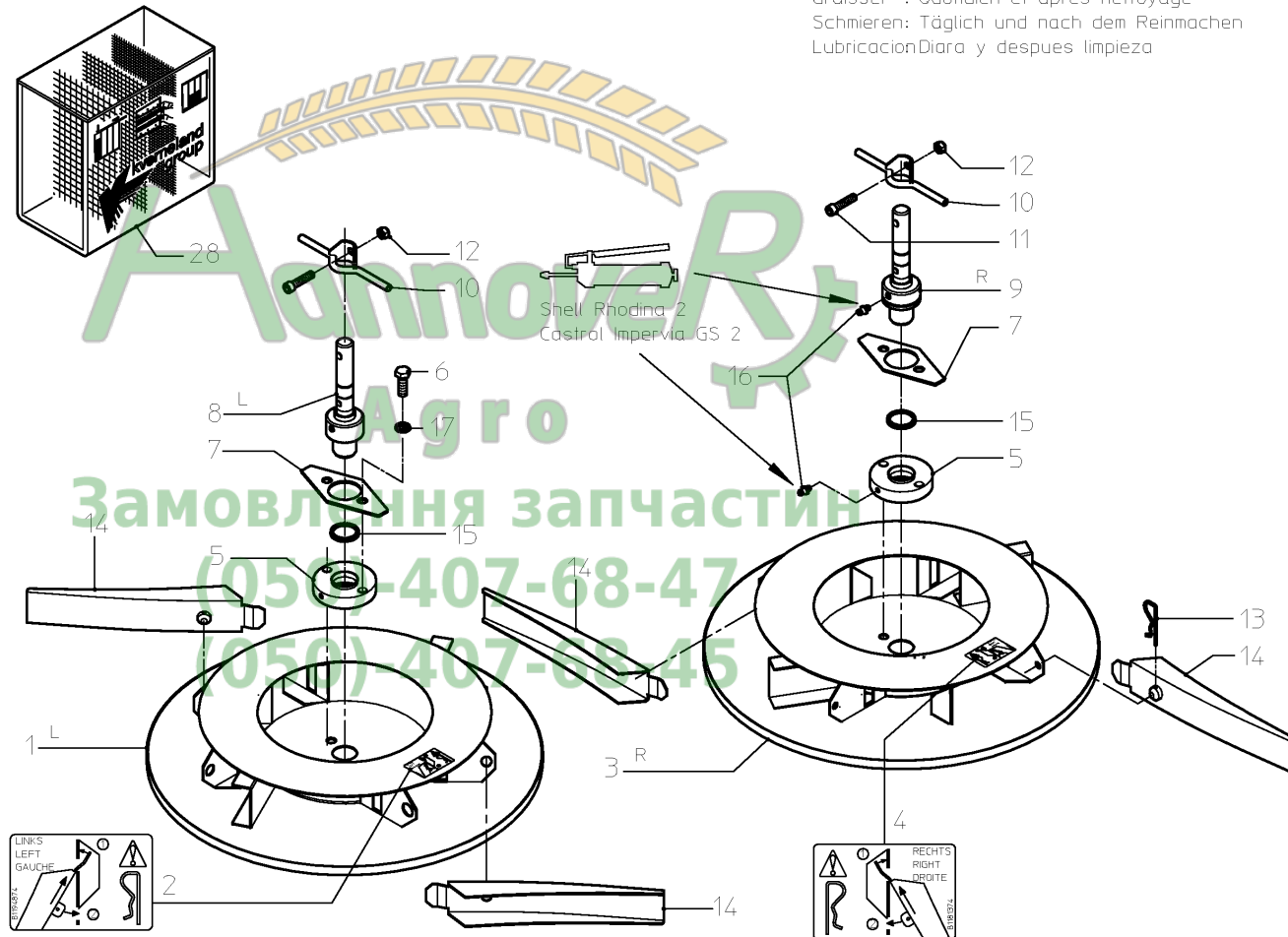

ROEDW_VN20802_N09

RO-EDW GEO / CONTROL, ISO



PosNo.	Part No.	Qty.
1	KG00433200	12
2	VNB4070073	4
3	KG00497600	4
4	KG01069900	4
5	VNB2336686	1
6	VNB4190702	4
7	VNB4190602	4
8	VNB4281802	8
9	VNB4281902	4
10	VNB4282002	4
11	VNB4190502	4
12	VN80504001	6
13	MT00001356	1

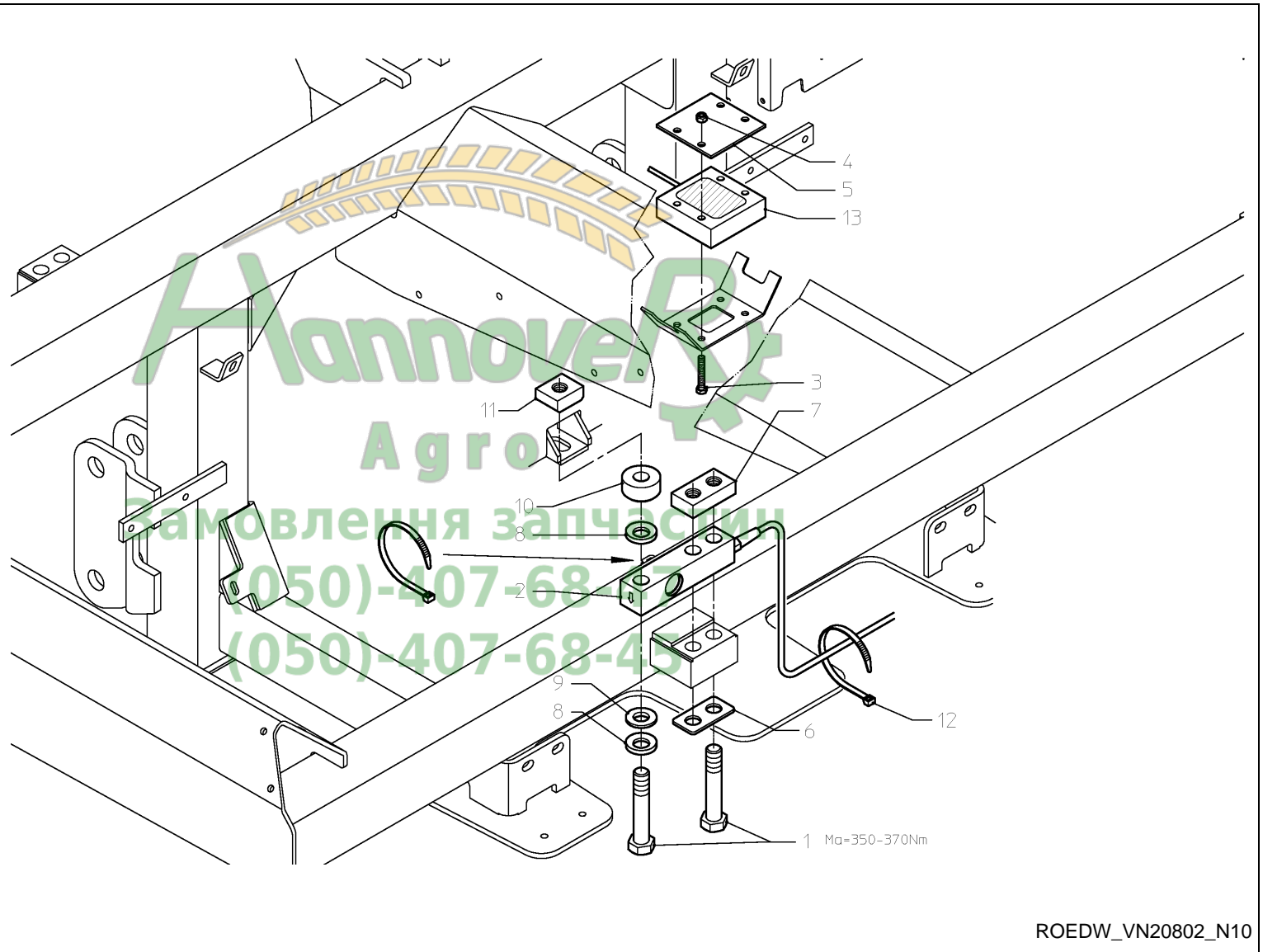

ROEDW_VN20802_N10

RO-EDW GEO / CONTROL, ISO



PosNo.	Part No.	Qty.
4	KG01069900	2
14	VN30117600	4
15	KG01053500	4
16	VNB4256202	1
17	KG00496800	2
18	VN80504001	12
19	VN80504003	10
20	VNB0578473	1
21	VNB0489473	1
22	MT00000532	1
23	VNB0563673	1
24	VNB0547873	1
25	MT00001663	1
26	MT00002021	1
27	VNB0554173	4
28	VNB2235978	16
29	MT00002020	1
30	MT00000723	1
31	MT00000724	1
32	MT00000726	1
33	VNB0566173	1
34	VNB0253473	1

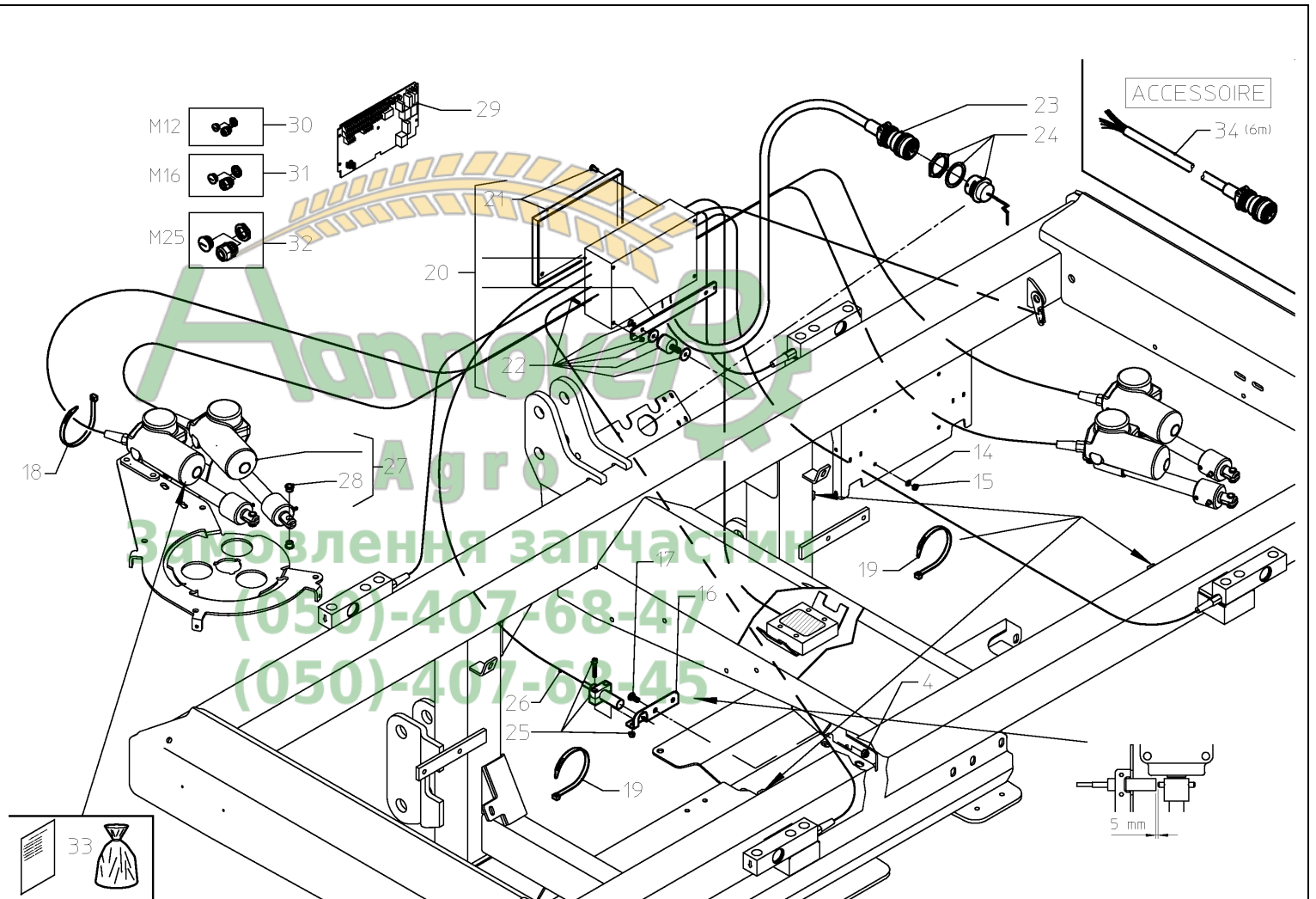

ROEDWGEO_VN22100_P11

RO-EDW GEO / UNIV. JOINT SHAFT



PosNo.	Part No.	Qty.
1	VN46120092	1
4	VG85.005	1
5	VG85.004	1
11	VG10.83.40	1
12	VGAGRASET173	1
13	VG56.117.19	1
21	VG10.01.00	2
22	VGND98026V	2
23	VG10.48.00	1
24	KG01192062	2
25	VG75.02.15	1
26	VG75.06.15	1
27	VG10.49.00	1
51	VG83.09.01	2
52	VG85.05.06	2
53	VG365305	2
54	VG83.10.03	2
55	VG82.36.03	2
90	VGAGRASET207	1

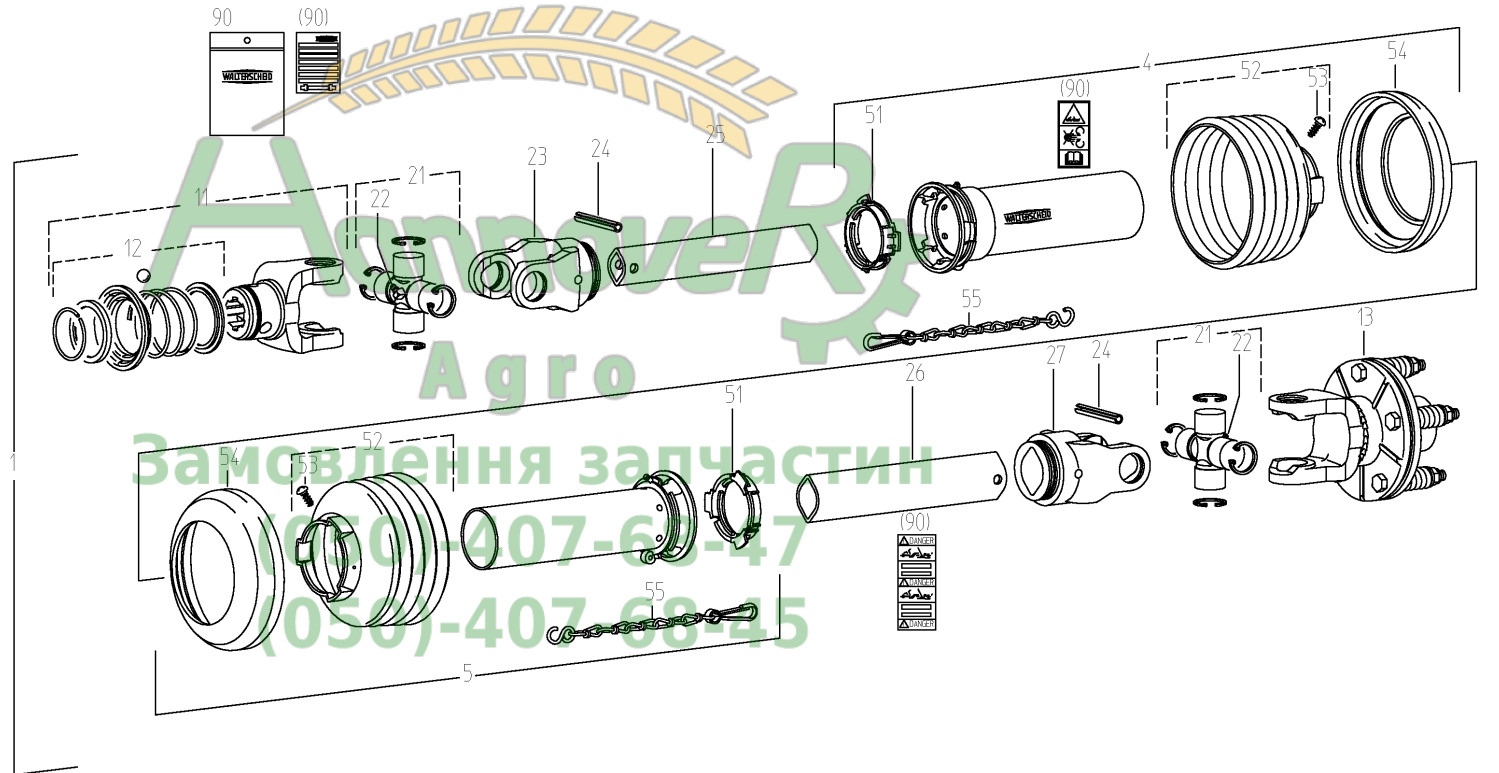

ROEDW_VN20802_C01

RO-EDW GEO / DECAL SCHEMATIC

PosNo. Part No. Qty.

1	VNB4053074	1
2	VNB4105274	1
3	VNB4377074	1
4	VNB4493474	1
5	VNB4376974	2
6	VNB4377174	1
7	VNB3444974	1
8	VNB4105474	2
9	VNB4366374	2
10	VNB1194874	1
11	VNB1181374	1
12	VNB4828674	2
13	VNB4377474	2
14	VNB4377574	2
15	VNB4800374	1
18	VNB2822600	1

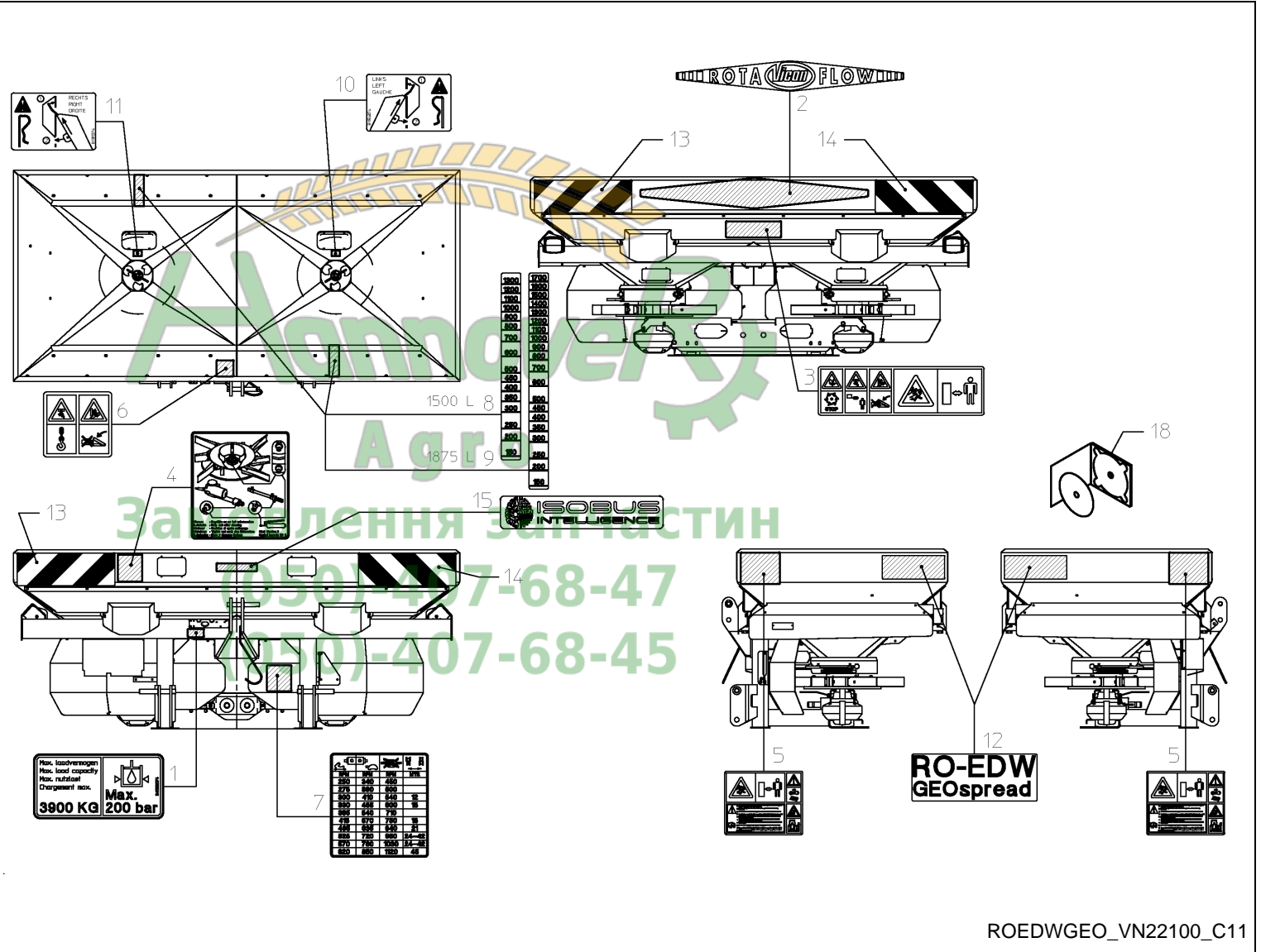

ROEDWGEO_VN22100_C11

RO-EDW GEO / DECAL SCHEMATIC



PosNo.	Part No.	Qty.
16	VNB4377474	1
17	VNB4377574	1

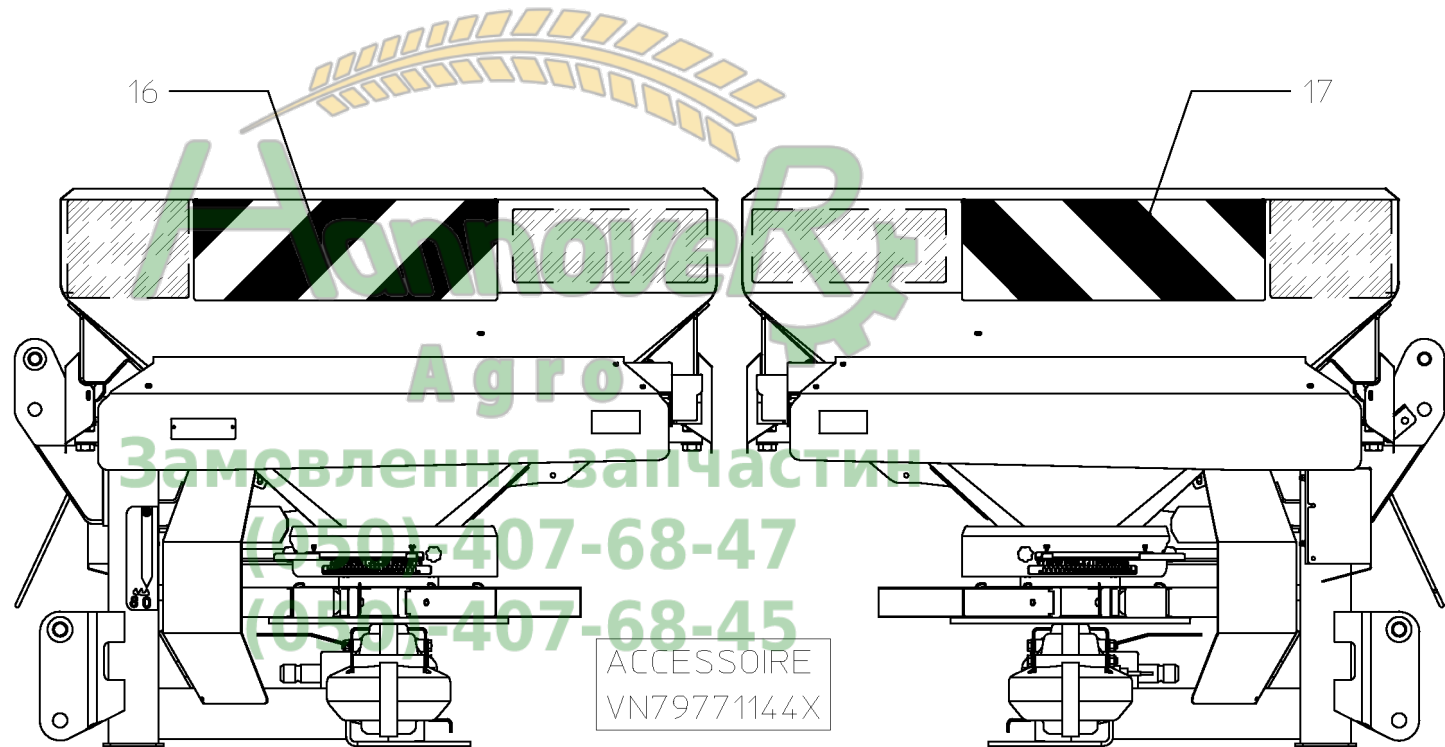

ROEDWGEO_VN22100_C12

RO-EDW GEO / ACCESSORIES



PosNo. Part No. Qty.

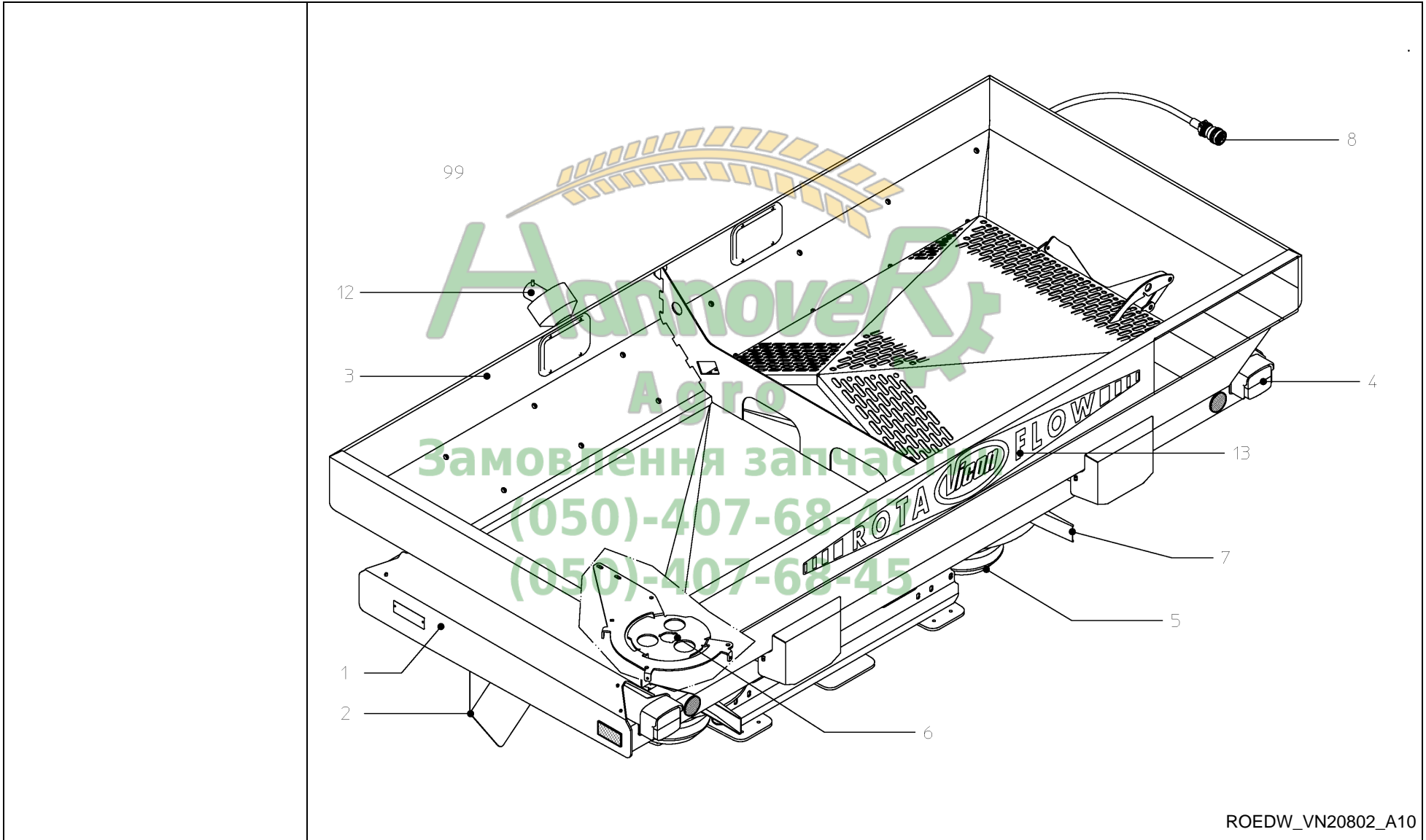

ROEDW_VN20802_A10

RO-EDW GEO / HOPPER EXTENSION (1500 L)



PosNo.	Part No.	Qty.
1	VNB4675602	2
2	VNB4675502	2
3	VNB3984186	4
4	VNB4218178	16
5	VNB4014778	4
6	VNB4053474	8

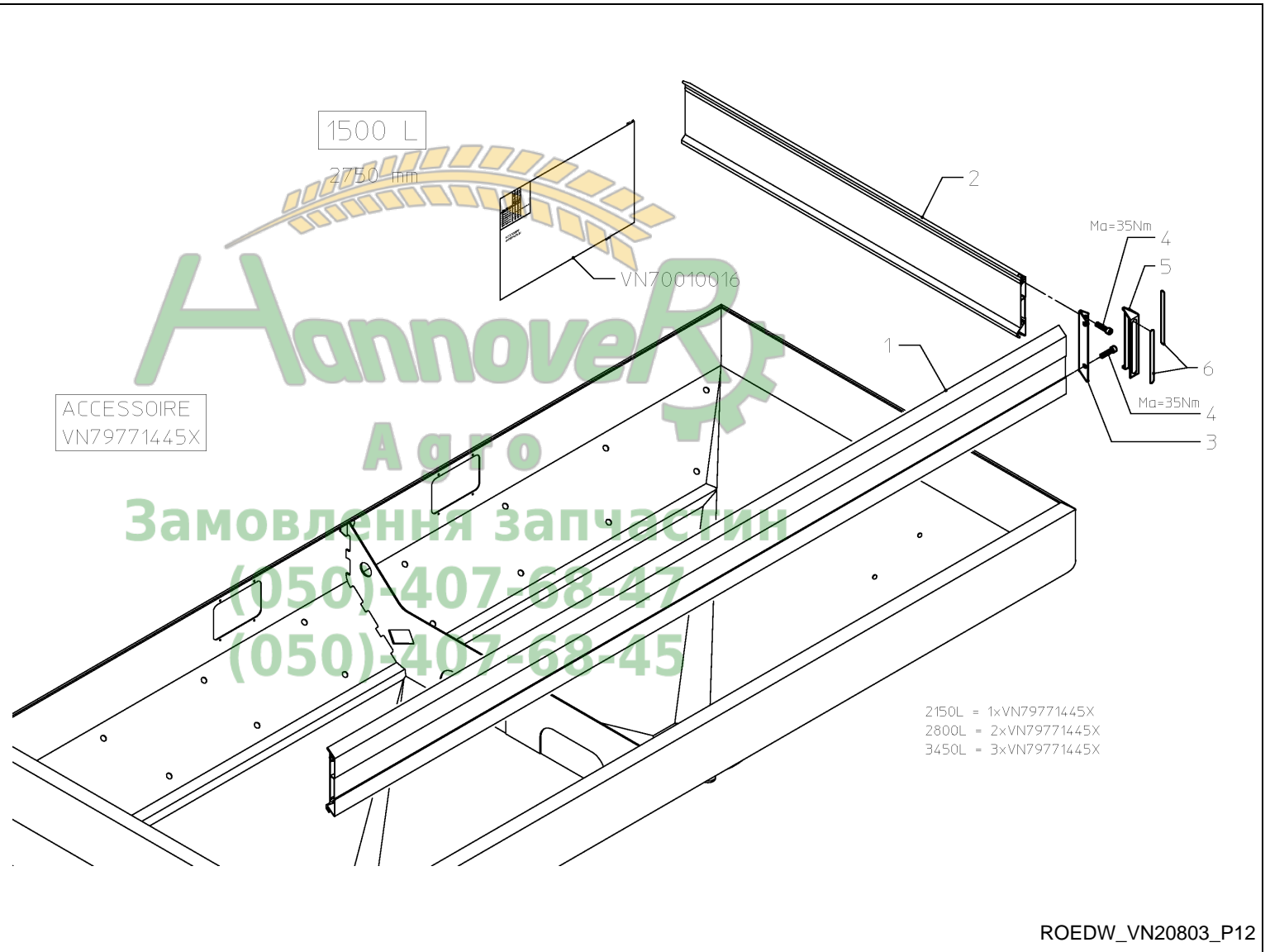

RO-EDW GEO / TARPAULIN (1500 L)



PosNo.	Part No.	Qty.
1	KG01053700	8
2	KG01263900	8
3	KG00738100	2
4	KG00652900	12
5	KG00739600	10
6	KG01053500	2
7	KG01069900	22
8	KG01901500	8
9	KG00712600	1
10	KG01901400	10
11	VNB2092402	4
12	VNB3443478	4
13	VNB3602694	1
14	VNB3602794	1
15	VNB3603194	2
16	VNB4306994	1
17	VNB3603394	1
18	VNB3708094	1
19	VNB3603594	1
20	VNB4487278	10
21	RG00040217	1
22	VGTR2059	1
23	VNB4306794	1
24	VNB4306894	1
25	VNB4309102	8
26	KG00497600	8
27	KG00497200	8
28	KG01263600	1
29	VNB3447178	1
30	KG01069600	1
31	VNB3707494	3
32	VNB4079778	1

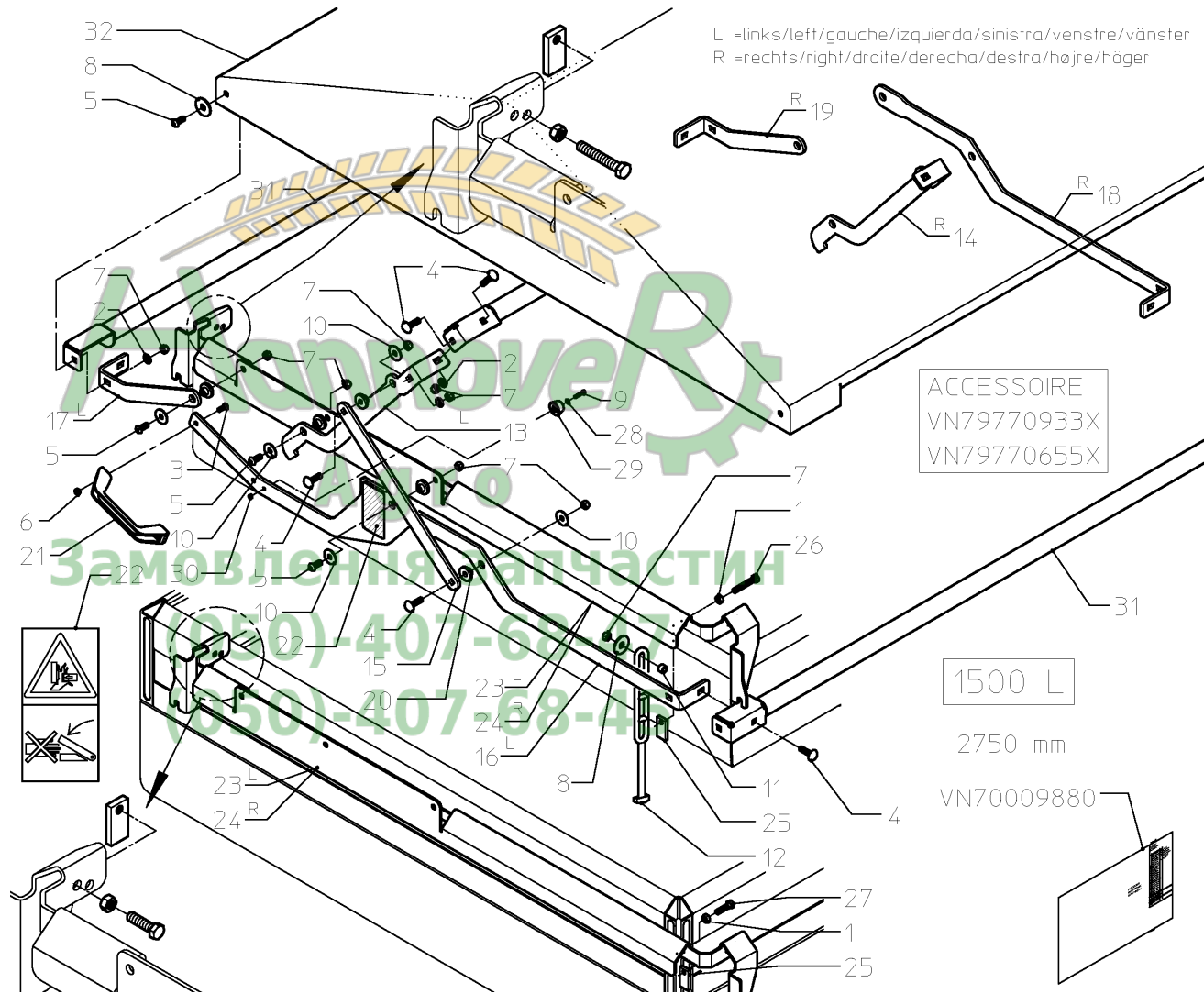

ROEDW_VN20802_N15

RO-EDW GEO / TARPAULIN (1875 L)



PosNo.	Part No.	Qty.
1	KG01053700	8
2	KG01263900	8
3	KG00738100	2
4	KG00652900	12
5	KG00739600	10
6	KG01053500	2
7	KG01069900	22
8	KG01901500	8
9	KG00712600	1
10	KG01901400	10
11	VNB2092402	4
12	VNB3443478	4
13	VNB3602694	1
14	VNB3602794	1
15	VNB3603194	2
16	VNB4306994	1
17	VNB3603394	1
18	VNB3708094	1
19	VNB3603594	1
20	VNB4487278	10
21	RG00040217	1
22	VGTR2059	1
23	VNB4306794	1
24	VNB4306894	1
25	VNB4309102	8
26	KG00497600	8
27	KG00497200	8
28	KG01263600	1
29	VNB3447178	1
30	KG01069600	1
31	VNB4373494	3
32	VNB4283878	1

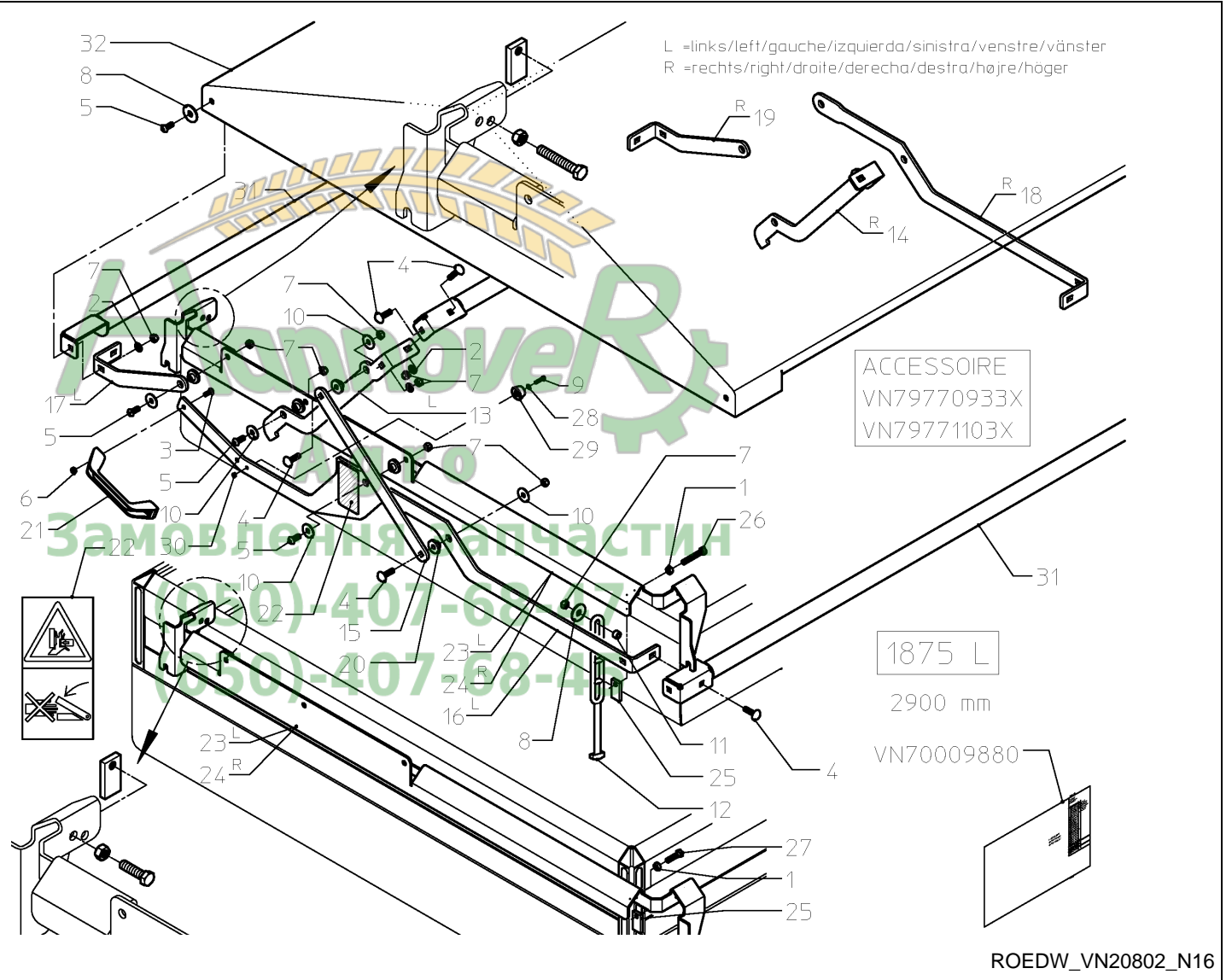

RO-EDW GEO / HOPPER EMPTYING SET



PosNo.	Part No.	Qty.
1	VNB4407802	2
2	KG00679900	8
3	KG01263600	8
4	VN30105400	8
5	VNB4408202	2
6	KG00738300	6
7	VNB4423502	6
8	VNB4451002	6
9	KG01264000	6
10	KG01069800	6
11	VNB4334578	4
12	KG00738100	4
13	VNB4408302	2
14	KG01901300	2

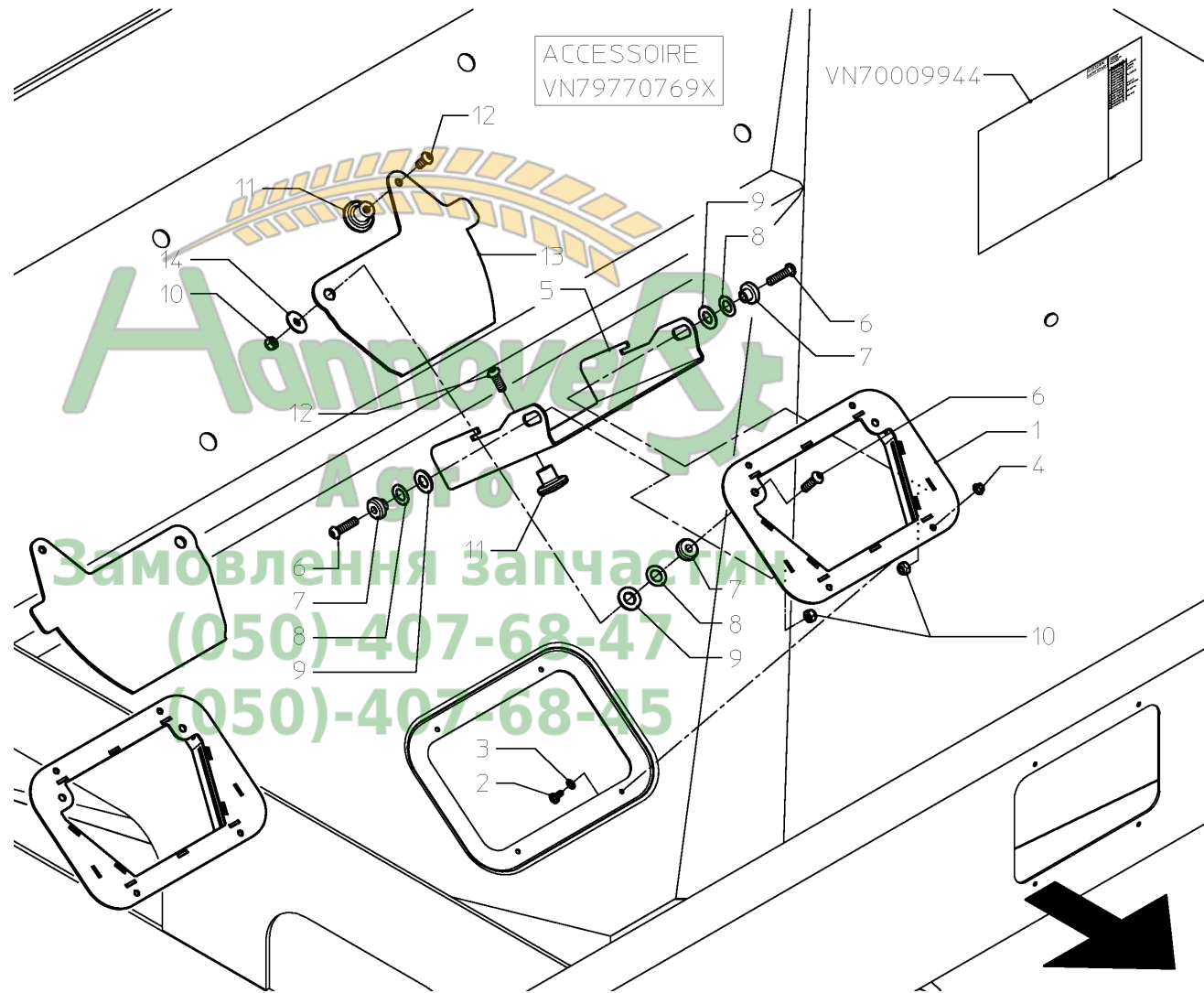

ROEDW_VN20802_N17

RO-EDW GEO / SCOOP SET



PosNo.	Part No.	Qty.
1	VNB1082102	12
2	VNB4769365	12



Замовлення запчастин
 (050)-407-68-47
 (050)-407-68-45

SPM\N000331

VN70010031

VN79771450

RO-EDW GEO / LADDERSET



PosNo.	Part No.	Qty.
1	KG00497100	7
2	KG00654400	1
3	KG00868600	6
4	KG00870200	6
5	KG01069700	6
6	KG01069800	6
7	KG01069900	7
8	KG01901400	7
9	VNB4442278	1
10	VNB4450578	2
11	VNB4451194	1
12	VNB4451294	2
13	VNB4451394	7
14	VNB4451494	1
15	VNB4451978	1
16	VNB4473502	1
17	VNB4743378	3

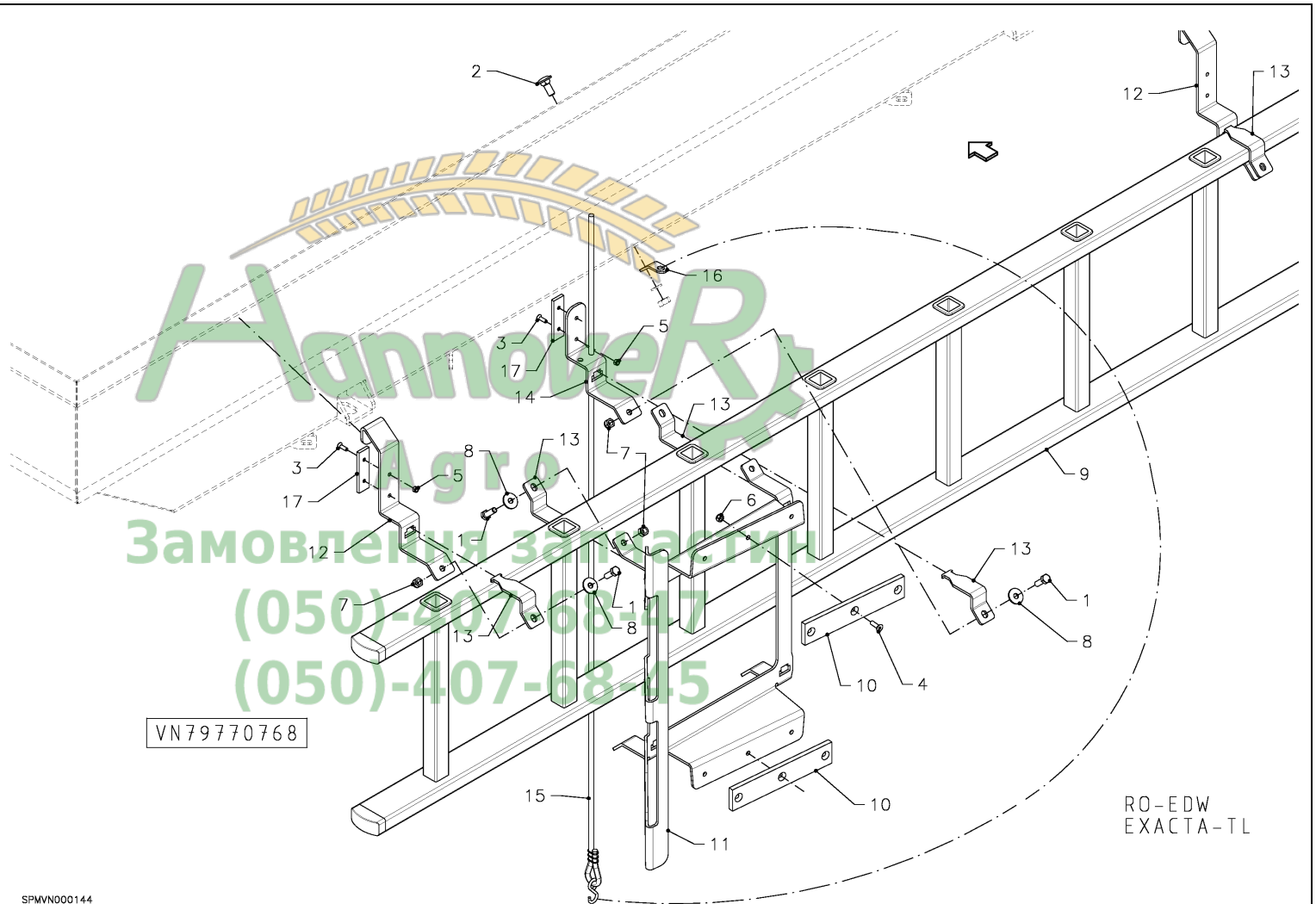

SPMVN000144

RO-EDW
EXACTA-TL

VN70009947

VN79770768-02-02

RO-EDW GEO / WHEELSET



PosNo.	Part No.	Qty.
1	VNB0765393	4
2	VNB1380878	2
3	VNB1402486	2
4	VNB1907978	2
5	VNB3770294	4
6	VNB3843994	2
7	VNB4376594	2
8	VNB3876594	2
9	VNB3876694	2
10	KG00397100	2
11	KG00496900	26
13	KG01069900	22
14	KG01070000	2
15	KG01901400	12
16	KG01059700	4

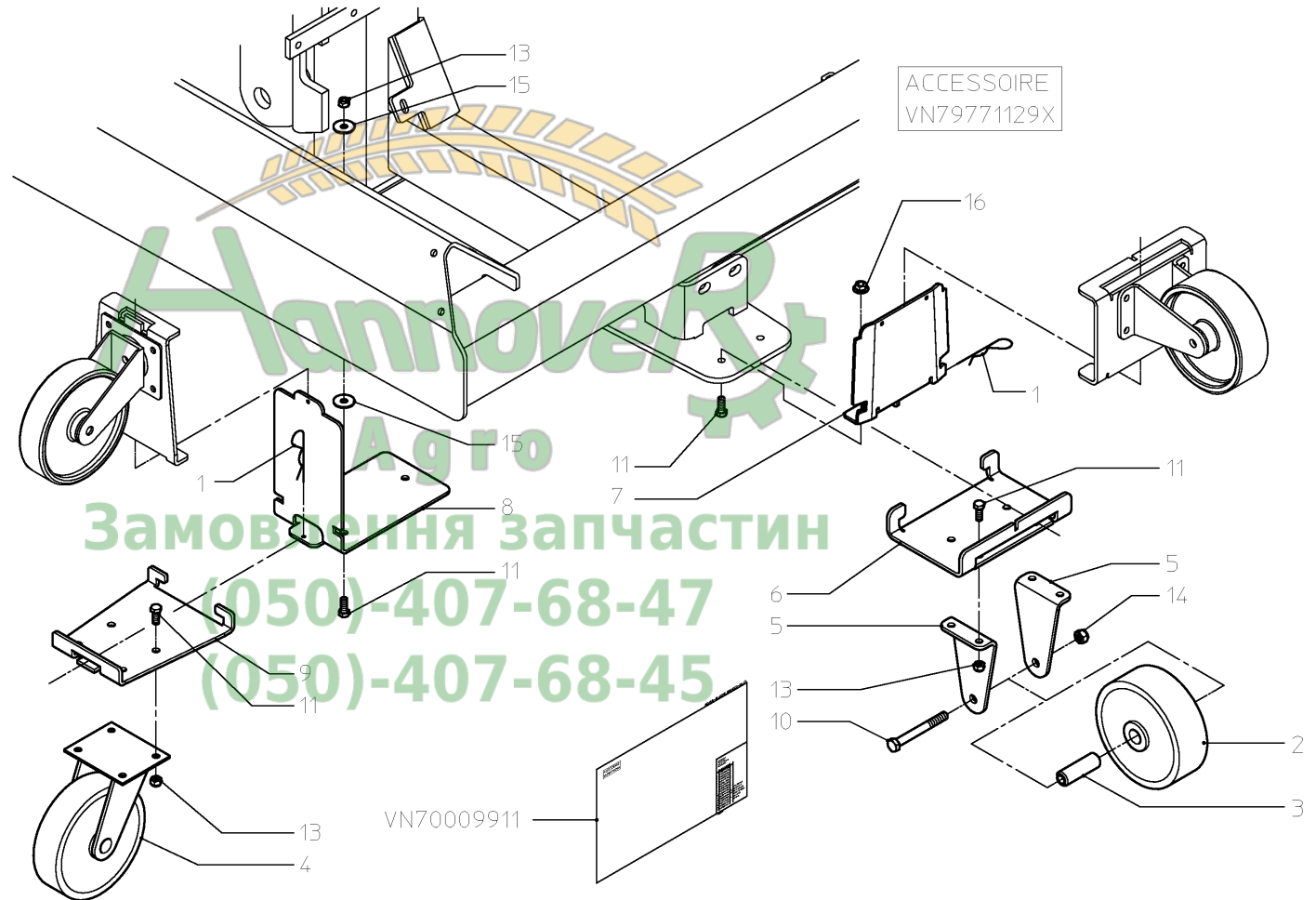

ROEDW_VN20802_N19

RO-EDW GEO / CALIBRATION CONTAINER



PosNo.	Part No.	Qty.
2	VNB4332994	1
3	VNB4334578	1
4	KG01059600	2
5	KG00495300	1
10	VNB4332194	1
11	VNB4332094	1
12	RG00040217	2
13	KG00495100	4
14	KG01069800	4
15	VNB2760978	1
16	VN30143310	4
17	VNB1100802	2
18	KG00493700	4
19	KG01901200	4
20	KG01069700	4
21	VNB3708174	1
22	VGTR2023	1

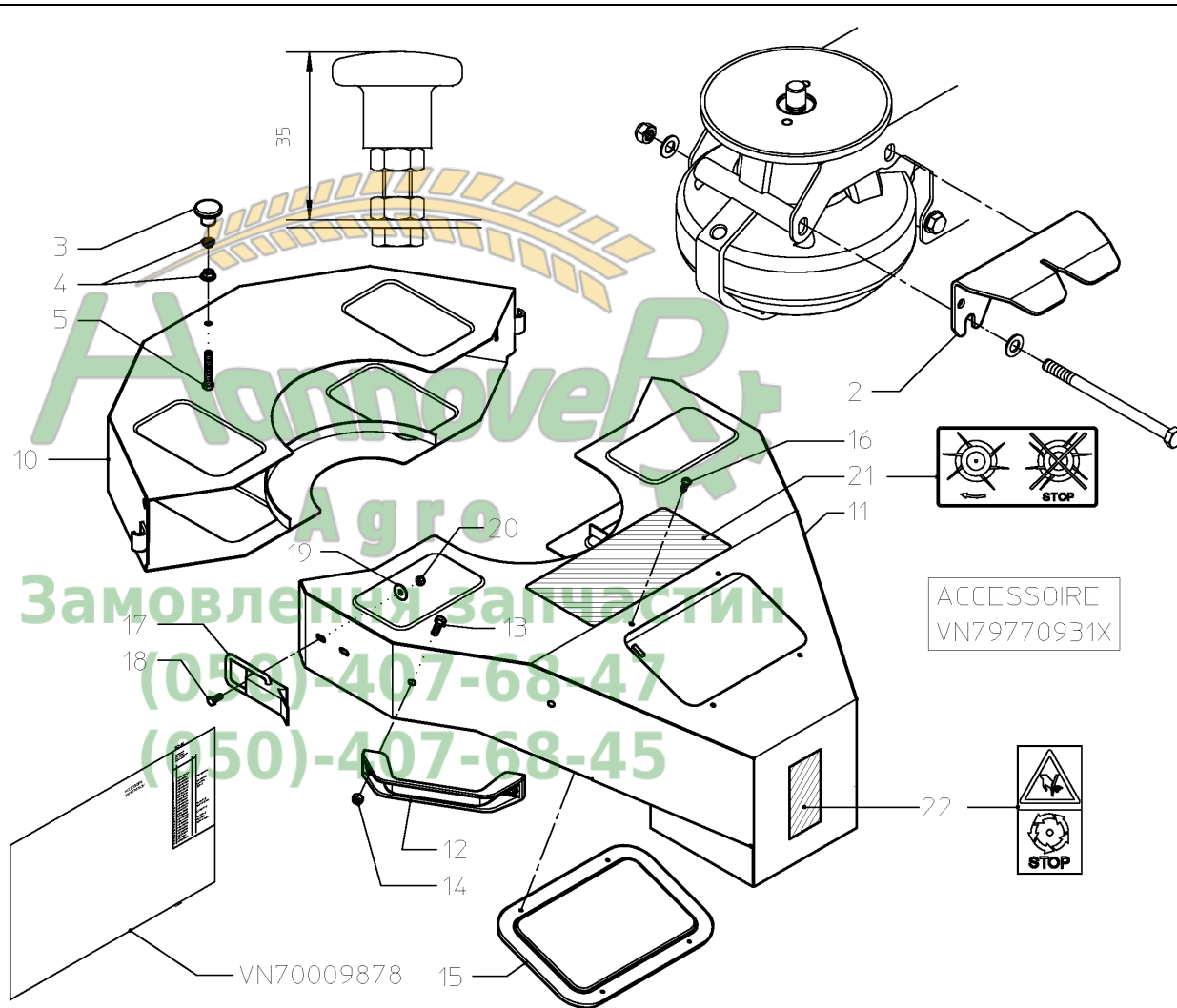

ROEDW_VN20802_N20

RO-EDW GEO / BOUNDARY SPREADING PLATE



PosNo.	Part No.	Qty.
1	VNB3428494	1
2	KG00496900	6
3	KG01059700	6
4	VNB3428094	1
5	VN17856588	1
6	VNB4190994	1

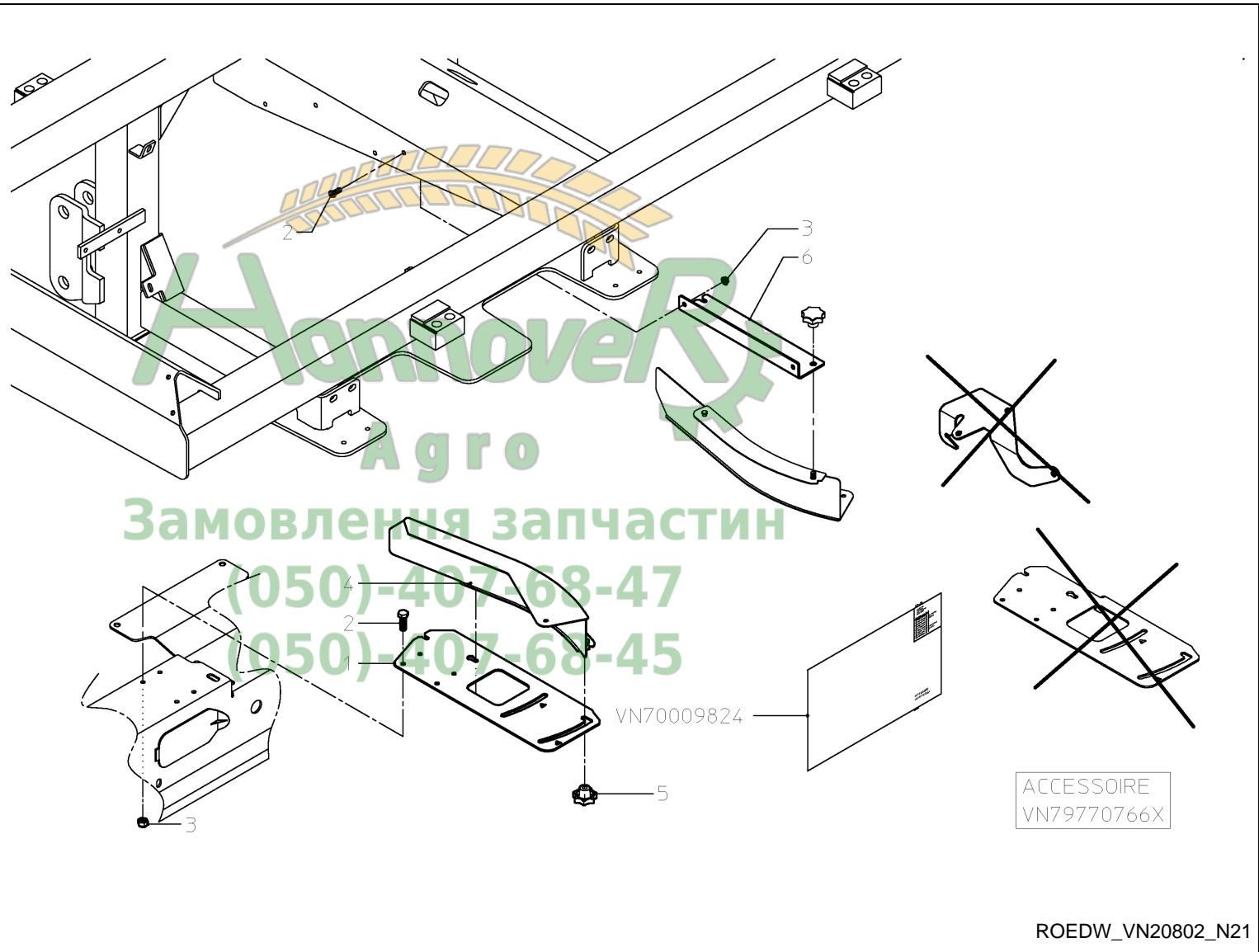

RO-EDW GEO / TRIMFLOW



PosNo.	Part No.	Qty.
1	VNB4580502	1
2	VNB4570494	1
3	VN17856588	2
4	KG01070000	6
5	VNB4769578	8
6	KG00402500	3
7	KG00402800	1
8	KG01070300	4
9	VNB4191794	1
10	VN90083444	1
11	VNB4808802	1
12	VNB4808502	1
13	VNB4191094	1
14	VNB4191494	1
15	VNB3281778	8
16	VNB4194694	1
17	VNB4192002	1
18	KG01901500	4
19	VNB0450173	1
20	VN80504003	5
21	KG01069900	2
22	VN30117100	2
23	VNB4297902	1
24	VNB4297478	1
25	VNB4743378	1
26	VN38854581	1
27	RG00048610	1
28	VN31419900	1
29	VN90007711	1
30	KG01069700	2
31	VGTR2059	1
32	KG00746800	4
33	KG01264300	4
34	VN79750037	1
35	KG00868600	2
36	VN31419024	1
37	VN79750027	1

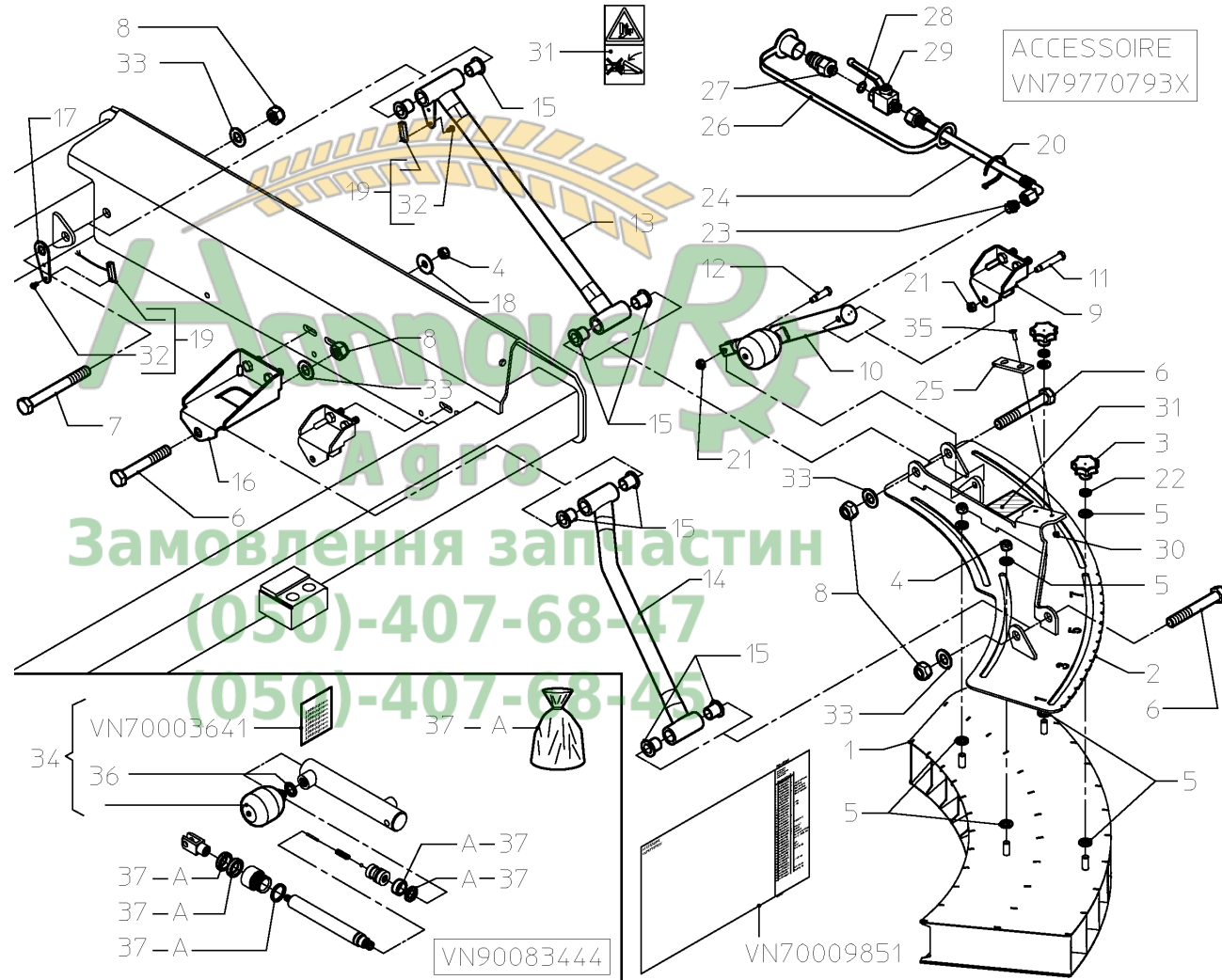

ROEDW_VN20803_P22

RO-EDW GEO / FEELER GAUGE



PosNo.	Part No.	Qty.
17	VNB1709302	1
18	VNB1754278	1

ACCESSOIRE
VN79770216X

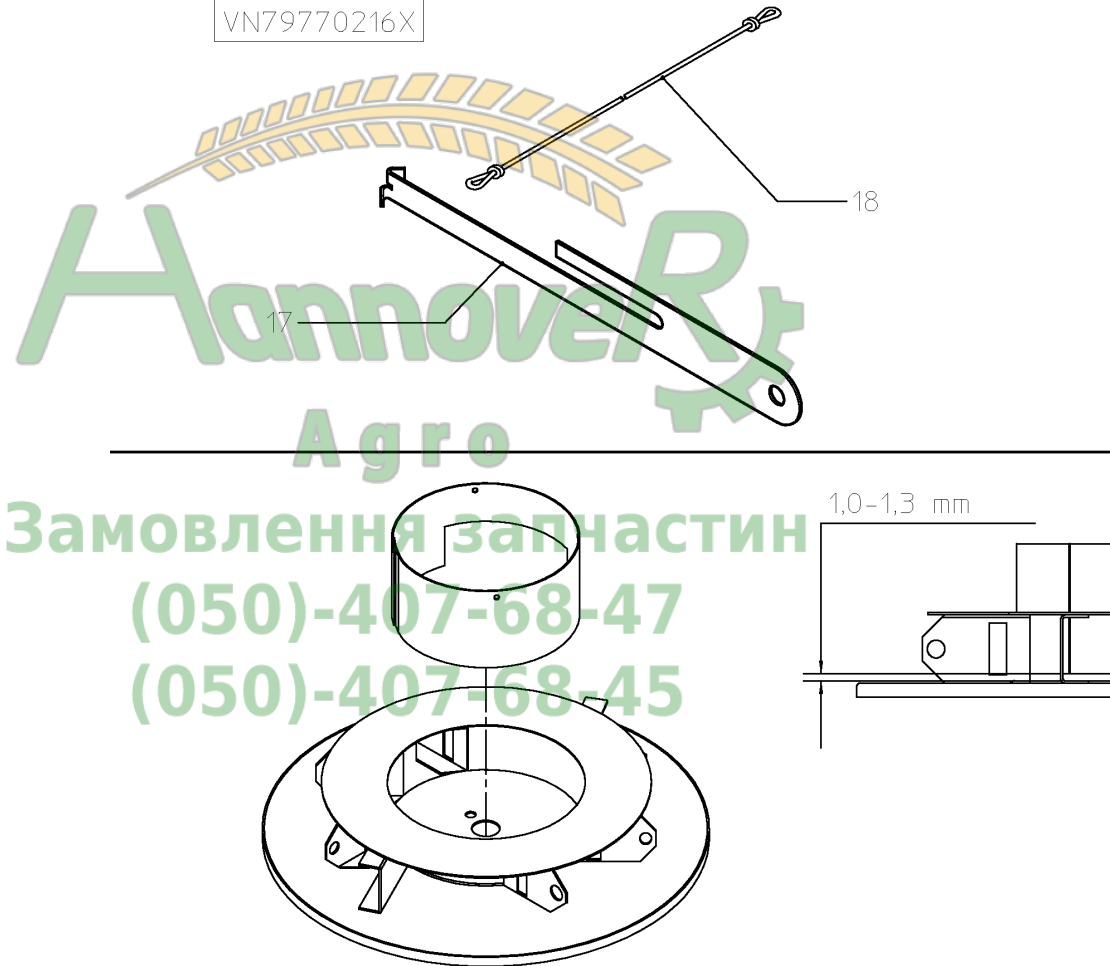

ROEDW_VN20802_N23

RO-EDW GEO / SPREADING PATTERN CONTROLSET



PosNo.	Part No.	Qty.
1	VN79771400	1
2	AC353924	1
3	VN79771219	1

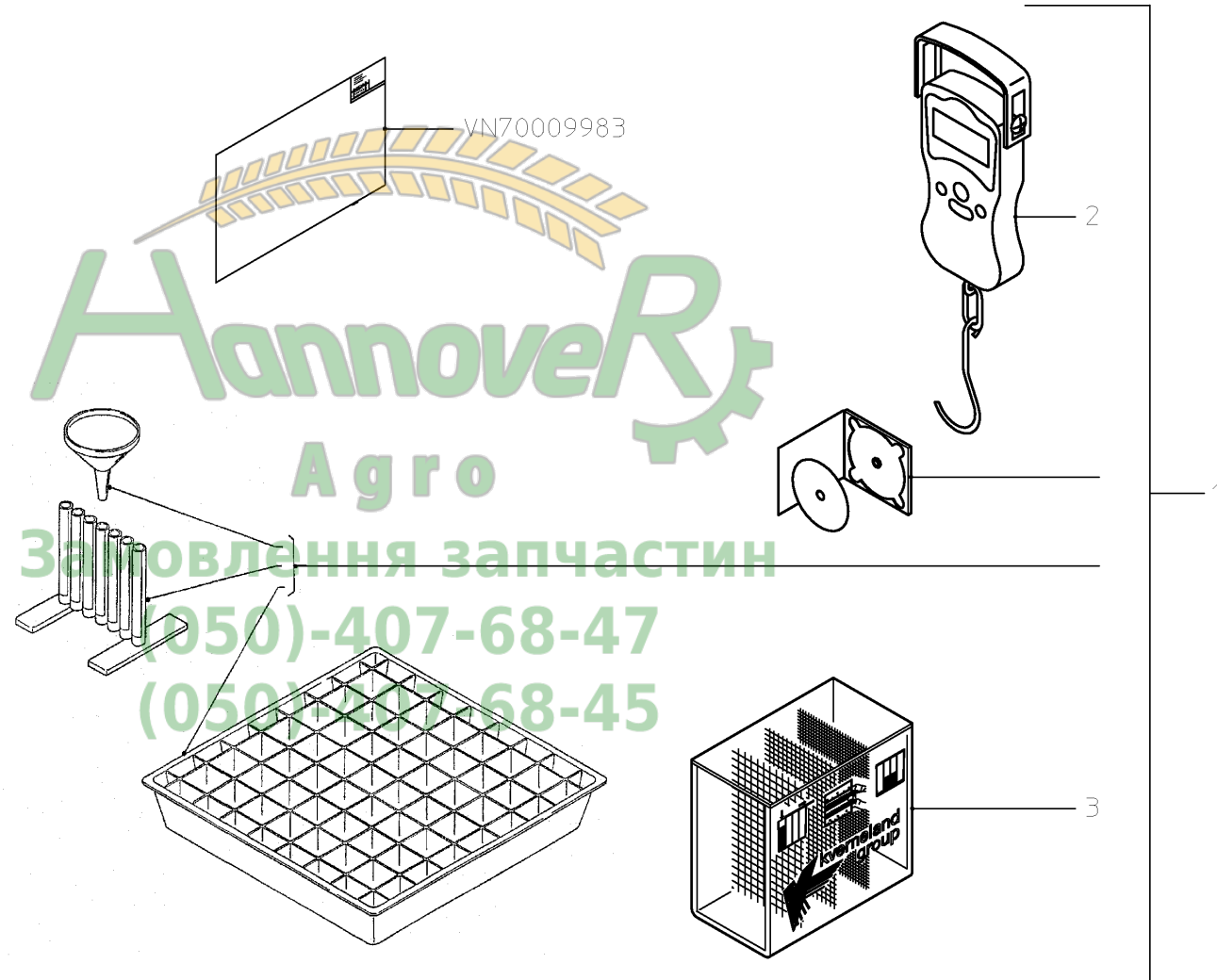

ROEDW_VN20802_N24

RO-EDW GEO / Part No Index



Part No.	Page	Pos No	Part No.	Page	Pos No	Part No.	Page	Pos No	Part No.	Page	Pos No
AC353924	28	2	KG00652900	18	4	KG01053700	18	1	KG01069900	22	7
KG00397100	23	10	KG00652900	19	4	KG01053700	19	1	KG01069900	23	13
KG00399400	7	19	KG00654300	3	10	KG01053800	3	9	KG01069900	26	21
KG00399800	7	7	KG00654400	22	2	KG01053800	8	13	KG01070000	4	7
KG00402500	26	6	KG00679900	20	2	KG01059600	2	15	KG01070000	5	7
KG00402800	26	7	KG00712600	18	9	KG01059600	24	4	KG01070000	8	35
KG00433200	10	1	KG00712600	19	9	KG01059700	3	7	KG01070000	23	14
KG00493700	24	18	KG00714100	6	13	KG01059700	23	16	KG01070000	26	4
KG00494900	2	14	KG00738100	8	2	KG01059700	25	3	KG01070100	1	7
KG00495100	24	13	KG00738100	18	3	KG01069600	18	30	KG01070100	2	18
KG00495200	1	18	KG00738100	19	3	KG01069600	19	30	KG01070100	7	4
KG00495300	24	5	KG00738100	20	12	KG01069700	22	5	KG01070300	26	8
KG00496800	11	17	KG00738300	20	6	KG01069700	24	20	KG01107862	8	24
KG00496900	23	11	KG00739400	3	5	KG01069700	26	30	KG01192062	12	24
KG00496900	25	2	KG00739400	6	6	KG01069800	1	11	KG01263600	18	28
KG00497100	4	17	KG00739600	7	9	KG01069800	4	23	KG01263600	19	28
KG00497100	5	17	KG00739600	18	5	KG01069800	5	23	KG01263600	20	3
KG00497100	22	1	KG00739600	19	5	KG01069800	8	10	KG01263900	3	6
KG00497200	18	27	KG00746800	26	32	KG01069800	20	10	KG01263900	6	14
KG00497200	19	27	KG00747600	8	38	KG01069800	22	6	KG01263900	7	13
KG00497600	10	3	KG00868600	22	3	KG01069800	24	14	KG01263900	18	2
KG00497600	18	26	KG00868600	26	35	KG01069900	1	16	KG01263900	19	2
KG00497600	19	26	KG00870000	4	22	KG01069900	2	4	KG01264000	4	6
KG00498700	4	5	KG00870000	5	22	KG01069900	4	20	KG01264000	5	6
KG00498700	5	5	KG00870000	8	27	KG01069900	5	20	KG01264000	20	9
KG00498700	8	9	KG00870200	8	50	KG01069900	6	3	KG01264100	2	17
KG00498800	9	6	KG00870200	22	4	KG01069900	7	14	KG01264100	7	2
KG00499500	8	11	KG00945900	8	44	KG01069900	8	46	KG01264300	26	33
KG00501000	1	6	KG01044900	8	14	KG01069900	9	12	KG01283000	6	7
KG00501000	2	16	KG01053400	6	8	KG01069900	10	4	KG01283000	8	40
KG00501200	1	10	KG01053500	11	15	KG01069900	11	4	KG01283300	9	17
KG00562400	8	25	KG01053500	18	6	KG01069900	18	7	KG01421400	8	21
KG00565700	9	11	KG01053500	19	6	KG01069900	19	7	KG01901200	24	19

RO-EDW GEO / Part No Index



Part No.	Page	Pos No	Part No.	Page	Pos No	Part No.	Page	Pos No	Part No.	Page	Pos No
KG01901300	1	19	VG365305	12	53	VN36107317	8	42	VNB0765193	1	13
KG01901300	20	14	VG56.117.19	12	13	VN36112005	8	19	VNB0765393	23	1
KG01901400	2	3	VG75.02.15	12	25	VN36112032	9	15	VNB0870178	1	4
KG01901400	4	18	VG75.06.15	12	26	VN37601011	1	15	VNB0897393	1	3
KG01901400	5	18	VG82.36.03	12	55	VN37601015	1	22	VNB1060002	9	14
KG01901400	18	10	VG83.09.01	12	51	VN38854581	26	26	VNB1082102	9	13
KG01901400	19	10	VG83.10.03	12	54	VN46120092	12	1	VNB1082102	21	1
KG01901400	22	8	VG85.004	12	5	VN48101007	6	15	VNB1100802	24	17
KG01901400	23	15	VG85.005	12	4	VN48523001	6	5	VNB1181374	9	4
KG01901500	4	15	VG85.05.06	12	52	VN48523002	6	4	VNB1181374	13	11
KG01901500	5	15	VGAGRASET173	12	12	VN79750027	26	37	VNB1194874	9	2
KG01901500	8	36	VGAGRASET207	12	90	VN79750037	26	34	VNB1194874	13	10
KG01901500	18	8	VGND98026V	12	22	VN79771219	9	28	VNB1380878	23	2
KG01901500	19	8	VGTR2023	24	22	VN79771219	28	3	VNB1402486	23	3
KG01901500	26	18	VGTR2059	18	22	VN79771400	28	1	VNB1599794	1	2
KG01901600	1	9	VGTR2059	19	22	VN80504001	6	11	VNB1599994	1	12
MT00000532	11	22	VGTR2059	26	31	VN80504001	10	12	VNB1709302	27	17
MT00000723	11	30	VN17856588	25	5	VN80504001	11	18	VNB1754278	27	18
MT00000724	11	31	VN17856588	26	3	VN80504003	6	10	VNB1907978	23	4
MT00000726	11	32	VN30105400	20	4	VN80504003	11	19	VNB2003102	1	17
MT00001356	10	13	VN30117100	3	8	VN80504003	26	20	VNB2003294	1	21
MT00001663	11	25	VN30117100	8	12	VN90007711	26	29	VNB2003302	1	20
MT00002020	11	29	VN30117100	26	22	VN90083444	26	10	VNB2068778	4	11
MT00002021	11	26	VN30117600	11	14	VNB0253473	11	34	VNB2068778	5	11
RG00040217	18	21	VN30128821	1	14	VNB0341273	6	12	VNB2092402	18	11
RG00040217	19	21	VN30128821	2	2	VNB0450173	26	19	VNB2092402	19	11
RG00040217	24	12	VN30130800	8	43	VNB0489473	11	21	VNB2235978	11	28
RG00048610	26	27	VN30130800	9	16	VNB0547873	11	24	VNB2332694	1	8
RG00050664	7	40	VN30143310	4	13	VNB0554173	11	27	VNB2336686	10	5
VG10.01.00	12	21	VN30143310	5	13	VNB0563673	11	23	VNB2417578	7	11
VG10.48.00	12	23	VN30143310	24	16	VNB0566173	11	33	VNB2417602	7	12
VG10.49.00	12	27	VN31419024	26	36	VNB0578473	11	20	VNB2426674	2	13
VG10.83.40	12	11	VN31419900	26	28	VNB0682993	7	21	VNB2760978	4	12

RO-EDW GEO / Part No Index



Part No.	Page	Pos No	Part No.	Page	Pos No	Part No.	Page	Pos No	Part No.	Page	Pos No
VNB2760978	5	12	VNB3603594	19	19	VNB4063078	8	48	VNB4277786	5	2
VNB2760978	24	15	VNB3620578	6	16	VNB4063178	8	49	VNB4277994	4	3
VNB2822600	13	18	VNB3707494	18	31	VNB4064878	7	5	VNB4277994	5	3
VNB3281778	26	15	VNB3708094	18	18	VNB4064978	7	6	VNB4278094	4	4
VNB3317278	8	1	VNB3708094	19	18	VNB4070073	10	2	VNB4278094	5	4
VNB3317378	8	41	VNB3708174	24	21	VNB4073178	8	8	VNB4281086	1	1
VNB3358794	1	5	VNB3717802	9	10	VNB4077378	8	39	VNB4281294	3	1
VNB3388365	9	5	VNB3770294	23	5	VNB4077502	9	8	VNB4281502	2	12
VNB3388402	9	7	VNB3843994	23	6	VNB4077602	9	9	VNB4281602	6	1
VNB3414002	9	1	VNB3876594	23	8	VNB4079778	18	32	VNB4281702	6	2
VNB3414102	9	3	VNB3876694	23	9	VNB4105274	13	2	VNB4281802	10	8
VNB3428094	25	4	VNB3910902	7	41	VNB4105474	13	8	VNB4281902	10	9
VNB3428494	25	1	VNB3957302	8	6	VNB4190102	3	2	VNB4282002	10	10
VNB3443478	18	12	VNB3957402	8	7	VNB4190502	10	11	VNB4283878	19	32
VNB3443478	19	12	VNB3958278	8	34	VNB4190602	10	7	VNB4297478	26	24
VNB3444974	13	7	VNB3967598	8	16	VNB4190702	10	6	VNB4297902	26	23
VNB3447178	18	29	VNB3967698	8	17	VNB4190994	25	6	VNB4306794	18	23
VNB3447178	19	29	VNB3970002	8	37	VNB4191094	26	13	VNB4306794	19	23
VNB3452378	6	20	VNB3984186	16	3	VNB4191494	26	14	VNB4306894	18	24
VNB3452478	6	19	VNB3984186	17	3	VNB4191794	26	9	VNB4306894	19	24
VNB3550678	7	23	VNB4014778	16	5	VNB4192002	26	17	VNB4306994	18	16
VNB3559902	8	28	VNB4014778	17	5	VNB4194694	26	16	VNB4306994	19	16
VNB3588378	7	25	VNB4023502	8	23	VNB4218178	16	4	VNB4309102	18	25
VNB3588478	7	26	VNB4042498	8	29	VNB4218178	17	4	VNB4309102	19	25
VNB3602694	18	13	VNB4042598	8	30	VNB4225402	8	22	VNB4319078	4	14
VNB3602694	19	13	VNB4042702	8	15	VNB4239702	8	18	VNB4319078	5	14
VNB3602794	18	14	VNB4053074	13	1	VNB4253078	2	21	VNB4332094	24	11
VNB3602794	19	14	VNB4053474	16	6	VNB4255678	6	9	VNB4332194	24	10
VNB3603194	18	15	VNB4053474	17	6	VNB4256202	11	16	VNB4332994	24	2
VNB3603194	19	15	VNB4059402	8	31	VNB4261794	4	1	VNB4334578	20	11
VNB3603394	18	17	VNB4060978	8	20	VNB4270602	4	19	VNB4334578	24	3
VNB3603394	19	17	VNB4061702	8	3	VNB4270602	5	19	VNB4341978	7	18
VNB3603594	18	19	VNB4061978	8	32	VNB4277786	4	2	VNB4344486	2	1



RO-EDW GEO / Part No Index

Part No.	Page	Pos No	Part No.	Page	Pos No
VNB4347993	7	15	VNB4487278	19	20
VNB4348193	7	17	VNB4493474	13	4
VNB4348393	7	16	VNB4570494	26	2
VNB4348493	7	36	VNB4580502	26	1
VNB4363594	5	1	VNB4627578	4	21
VNB4366374	13	9	VNB4627578	5	21
VNB4373494	19	31	VNB4627794	4	16
VNB4376594	23	7	VNB4627794	5	16
VNB4376974	13	5	VNB4668593	7	10
VNB4377074	13	3	VNB4675502	16	2
VNB4377174	13	6	VNB4675502	17	2
VNB4377474	13	13	VNB4675602	16	1
VNB4377474	14	16	VNB4675702	17	1
VNB4377574	13	14	VNB4708802	2	5
VNB4377574	14	17	VNB4713902	8	33
VNB4381402	2	19	VNB4743378	22	17
VNB4381502	2	20	VNB4743378	26	25
VNB4407802	20	1	VNB4769365	21	2
VNB4408202	20	5	VNB4769578	26	5
VNB4408302	20	13	VNB4780478	2	11
VNB4423502	20	7	VNB4789802	8	4
VNB4442278	22	9	VNB4789902	8	5
VNB4450578	22	10	VNB4790102	8	51
VNB4451002	20	8	VNB4790202	8	52
VNB4451194	22	11	VNB4790302	8	53
VNB4451294	22	12	VNB4790402	8	54
VNB4451394	22	13	VNB4800374	13	15
VNB4451494	22	14	VNB4808502	8	45
VNB4451978	22	15	VNB4808502	26	12
VNB4466478	7	22	VNB4808802	26	11
VNB4466678	7	38	VNB4828674	13	12
VNB4473502	22	16			
VNB4487278	18	20			



RO-EDW GEO

01001 < Mach. ID <=

Kverneland Group Nieuw-Venep
Kverneland Group Nieuw-Venep BV
Hoofdweg 1278
2153 LR Nieuw-Venep
Netherlands
+31 252 662244
+31 252 662173



Замовлення запчастин

(050)-407-68-47

(050)-407-68-45

© Kverneland Group

All rights reserved. No parts of this book may be reproduced, stored in a database or retrieval system, or published in any form or in any way, electronically, mechanically, optically, by print, photo print, microfilm (including micro and macro fiche), or any other means, including all video and CD systems, without prior written permission from the publisher.

Print date: 2011-10-28



AANHAALMOMENTEN / TORQUES / ANZUGSMOMENTE / COUPLES DE SERRAGE / PARES DE APRIETE / MOMENTI DI TORSIONE / BINÁRIOS DE APERTO / TILSTRAMMINGSMOMENTER / TILSPÆNDINGSMOMENTER

NL Richtlijnen voor aanhaalmomenten (in Nm) voor zelfborgende moeren, zeskantbouten en moeren.
DE Richtlinien für Anzugsmomente (in Nm) für selbstsichernde Muttern, Sechskantschrauben und -mutter.
ES Directrices para los pares de apriete (en Nm) para las tuercas autoblocantes, los tornillos hexagonales y las tuercas.
IT Direttive per momenti di torsione (espressi in Nm) per dadi autobloccanti, bulloni esagonali e dadi.
NO Retningslinjer for tilstrammingsmomenter (i Nm) for selvlåsende muttere, sekskantbolter og muttere.

EN Guidelines for torques (in Nm) for self-locking nuts, hexagon bolts and nuts.
FR Directives pour les couples de serrage (en Nm) pour écrous à autobloquants, boulons à six pans et écrous.
PT Directrizes para os binários de aperto (em Nm) para porcas autobloqueadoras, parafusos hexagonais e porcas.
DA Retningslinier for tilspændingsmomenter (i Nm) for selvlåsende møtrikker, sekskantbolte og møtrikker.

Kwaliteit / Quality / Qualität / Qualité / Calidad / Qualidade / Qualità / Kvalitet	4.6		8.8		10.9		12.9	
	0,10	0,13	0,10	0,13	0,10	0,13	0,10	0,13
Wrijving / Friction / Reibung / Fricción / Atrito / Attrito / Friktion /Friksjon *								
Schroefdraad / Thread / Gewinde / Filetage Rosca / Filettatura / Gevind / Skruegjenge								
M5	1,7	2	5	6	7	9	8	10
M6	3	4	9	10	13	15	15	18
M8	8	9	21	25	31	36	36	42
M10	16	19	40	50	60	70	70	85
M12	27	32	70	85	105	120	120	145
M14	42	50	115	135	165	195	195	230
M16	65	76	175	210	260	300	300	350
M18	90	110	250	290	350	420	410	490
M20	125	150	350	420	500	600	580	700
M22	170	200	470	560	670	800	780	930
M24	210	250	600	710	860	1020	1000	1180

- * **NL** De wrijvingscoëfficiënt van 0,10 geldt voor geoliede plaat, gietijzer, geharde vlakken, vette schroefdraad, etc. De hogere waarde van 0,13 geldt voor een droge plaat. Uitzonderingen op deze tabel zijn vermeld in het onderdelen- en/of instructieboek. Aanhaalmomenten voor bouten en moeren met gekartelde onderkant, zoals Tensilock en Whizlock, 10% extra.
- * **EN** The friction coefficient of 0.10 applies to oiled sheet, cast iron, hardened surfaces, greasy thread, etc. The higher value of 0.13 applies to dry sheet. Exceptions to this table are stated in the parts- and /or instruction manual. Torques for bolts and nuts with a knurled underside, like Tensilock and Whizlock, 10% extra.
- * **DE** Der Reibungskoeffizient von 0,10 gilt für geölte Flächen, Gußeisen, gehärtete Flächen, gefettetes Gewinde usw. Der höhere Wert von 0,13 gilt für trockene Flächen. Ausnahmen zu dieser Tabelle sind im Ersatzteilhft und/oder in der Betriebsanleitung. Anzugsmomente für Schrauben und Muttern mit gerändelter Unterseite, wie Tensilock und Whizlock, zuzüglich 10% extra.
- * **FR** Le coefficient de frottement de 0,10 s'applique aux surfaces huilées, à la fonte, aux surfaces trempées, aux filetages graissés etc. Le coefficient de 0,13 aux surfaces sèches. Les exceptions à se tableau sont mentionnées dans la nomenclature des pièces et/ou dans le manuel d'emploi. Ajoutez 10% pour les boulons et écrous à partie inférieure crénelée, comme les Tensilock et les Whizlock.
- * **ES** El coeficiente de fricción de 0,10 es indicado para planchas lubricadas, hierro fundido, superficies endurecidas, rosca grasienta, etc. El valor más alto de 0,13 es para planchas secas. Las excepciones a este cuadro se mencionan en el libro de repuestos y/o manual de instrucciones. Los pares de apriete para tonillos y tuercas con cara inferior dentada, como los Tensilock y Whizlock, 10% extra.
- * **PT** O coeficiente de atrito de 0.10 aplica-se às superfícies olcadas, ao ferro fundodo, às superfícies temperadas, às roscas emassadas etc. O coeficiente de 0.13 às superfícies secas. As excepções a este quadro estão mencionadas na nomenclatura das peças e/ou no manual de instruções. Os binários de aperto para porcas e parafusos cujas bases sejam serradas (Tensilock, Whizlock) devem ser aumentados em 10%.
- * **IT** Il coefficiente di frizione pari a 0,10 si riferisce a superfici oliate, alla ghisa, a superfici temprate, a filettature spesse ecc. Il valore più alto, npari a 0,13, si riferisce a superfici asciutte. Tutte le eccezioni a quanto riportato in questa tabella, si trovano nel libretto dei pezzi o nel libretto delle istruzioni. I momenti torcenti per bulloni e dadi la cui parte inferiore è zigrinata, come i Tensilock (K 100) e Whizlock, sono superiori del 10%.
- * **DA** Friktionskoefficienten på 0,10 gælder for smurte flader, støbejern, hærkede overflader, fedtholdige gevind etc. Den højere værdi på 0,13 gælder for tørre flader. Undtagelser til tabellen er angivet i reservedels- og/eller instruktionsbog. Når det drejer sig om momenter for bolte og møtrikkers med en riflet underside, som Tensilock (K100) og Whizlock, skal der tilføjes 10% ekstra.
- * **NO** Friksjonskoeffisenten på 0,10 gjelder for smurt plate, støpejern, herdede flater, innfettete gjenger etc. Den høyere verdien på 0,13 gjelder for tørr plate. Unntak fra denne tabellen er angitt i deleboken og/eller i instruksjonsboken. Tiltrekkingsmomenter for skruer og mutre med riflet underkant, som Tensilock (K100) og Whizlock 10% tillegg.

VRIDMOMENT / MOMENTY OBROTOWE / UTAHOVACÍ MOMENTY / МОМЕНТ ЗАТЯГИВАНИЯ / PRIVIJALNI MOMENTI / MEGHÚZÁSI NYOMATÉKOK

SV Anvisningar för vridmoment (i Nm) för självläsande muttrar, sexkantiga bultar och muttrar.

CS Směrnice pro utahovací momenty (v Nm) pro samosvorné matice, šrouby a matice s šestihran hlavou

SL Navodila za privijalne (navorne) momente (v Nm) za matice in vijake.

PL Wytyczne dotyczące momentów obrotowych (w Nm) nakrętek samozabezpieczających, śrub z łbem sześciokątnym i nakrętek.

RU Указания для моментов затягивая (в Нм) для самоблокирующихся гаек, шестигранных болтов и гаек.

HU Előírt meghúzási nyomatékok (Nm-ben) az önzáró anyákhoz, hatlapfejű csavarokhoz és anyákhoz.

Kvalitet / Jakość / Jakost / Качество / Kvaliteta / Minőség	4.6		8.8		10.9		12.9	
Friktion / Tarcie / Třeni / Трение / Trenje / Súrlódás *	0,10	0,13	0,10	0,13	0,10	0,13	0,10	0,13
Gänga / Gwint / Závit / Резьба								
Navoj / Menet								
M5	1,7	2	5	6	7	9	8	10
M6	3	4	9	10	13	15	15	18
M8	8	9	21	25	31	36	36	42
M10	16	19	40	50	60	70	70	85
M12	27	32	70	85	105	120	120	145
M14	42	50	115	135	165	195	195	230
M16	65	76	175	210	260	300	300	350
M18	90	110	250	290	350	420	410	490
M20	125	150	350	420	500	600	580	700
M22	170	200	470	560	670	800	780	930
M24	210	250	600	710	860	1020	1000	1180

* **SV** Friktionskoefficienten 0,10 gäller oljad plåt, gjutjärn, härdade ytor, smorda gängor etc. Det högre värdet 0,13 gäller torr plåt. Undantag från denna tabell anges i reservdels- och/eller instruktionsboken. Åtdragningsmoment för räfflade bultar och muttrar, som Tensilock och Whizlock 10% extra.

* **PL** Współczynnik tarcia 0,10 dotyczy płyty oliwonej, żeliwa, powierzchni hartowanych, nasmarowanych gwintów, itp. Wyższy współczynnik 0,13 dotyczy płyty suchej. Wyjątki od niniejszej tabeli podano w katalogu części i/lub instrukcji. Momenty obrotowe zwiększają się o dodatkowe 10% w przypadku śrub i nakrętek z radełkowanym spodem, jak na przykład, Tensilock (K100) o Whizlock.

* **CS** Koeficient třeni 0.10 platí pro naolejovaný plech, litinu, kalené povrchy, namazaný závit a tak dále. Vyšší hodnota 0.13 platí pro suchý plech. Výjimky z této tabulky jsou uvedeny v seznamu náhradních dílů a/nebo v provozním návodu. Utahovací momenty pro šrouby a matice s rýhovanou spodní stranou 10% navíc, jako např. Tensilock (K100), Whizlock.

* **RU** Коэффициент трения в 0,10 относится к смазанным плитам, чугуны, затвердевшим поверхностям резьбе с нанесенной смазкой и т.д. Более высокое значение в 0,13 относится к сухим плитам. Исключения для данной таблицы указаны в брошюре с описанием рабочих деталей и/или инструкции по эксплуатации. Моменты затягивания для болтов и гаек с зазубренной стороной выше на 10% для таких как, Tensilock (k 100) и Whizlock.

* **SL** Koeficient trenja 0,10 velja za naoljene površine, litino, kovane površine, namazane navoje itd. Višja vrednost 0,13 velja za suhe površine. Izjeme v tej tabeli so v zvezku rezervnih delov ali pa v navodilu o uporabi navedene. Navornim momentom za vijake in matice z naribano spodnjo površino, kot so Tensilock (K100) in Whizlock, dodamo 10%.

* **HU** A 0,10 súrlódási tényező az olajozott lemezekre, öntöttvasra, edzett felületekre, zsírozott menetre, stb alkalmazható. A 0,13 asmagasabb érték a száraz lemezekre alkalmazható. E táblázat alól kivételt képező tételek az alkatrészeknél és/vagy a gépkönyvekben vannak felsorolva. A meghúzási nyomaték az alsó peremen bordázott csavarok és anyák esetében 10%-kal nagyobb, pl. Tensilock (K100) és Whizlock.