

TELAIO

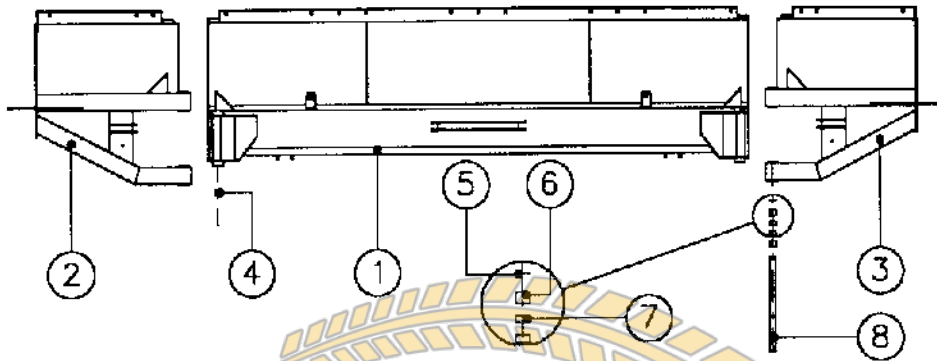

POS.	CODICE	DESCRIZIONE
1	SR0020	TELAIO CENTRALE REG. 75
1	SR0370	TELAIO CENTRALE REG. 80
2	SR0349	TELAIO SX REG. 75
2	SR0369	TELAIO SX REG. 80
3	SR0020	TELAIO DX REG. 75
3	SR0371	TELAIO DX REG. 80
4	CU9206	BOCCOLA JR 35x40x30
5	B870238	ANELLO ELASTICO E35 UNI 7435-75
6	PAP3530P20	BUSSOLA AUTOLUBRIFICANTE
7	PAP3520P20	BUSSOLA AUTOLUBRIFICANTE
8	SR0015	ALBERO COLLEGAMENTO TELAI

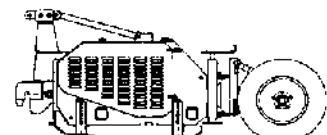
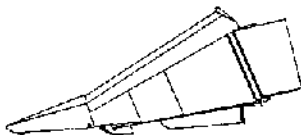

COCLEA CONVOGLIATRICE

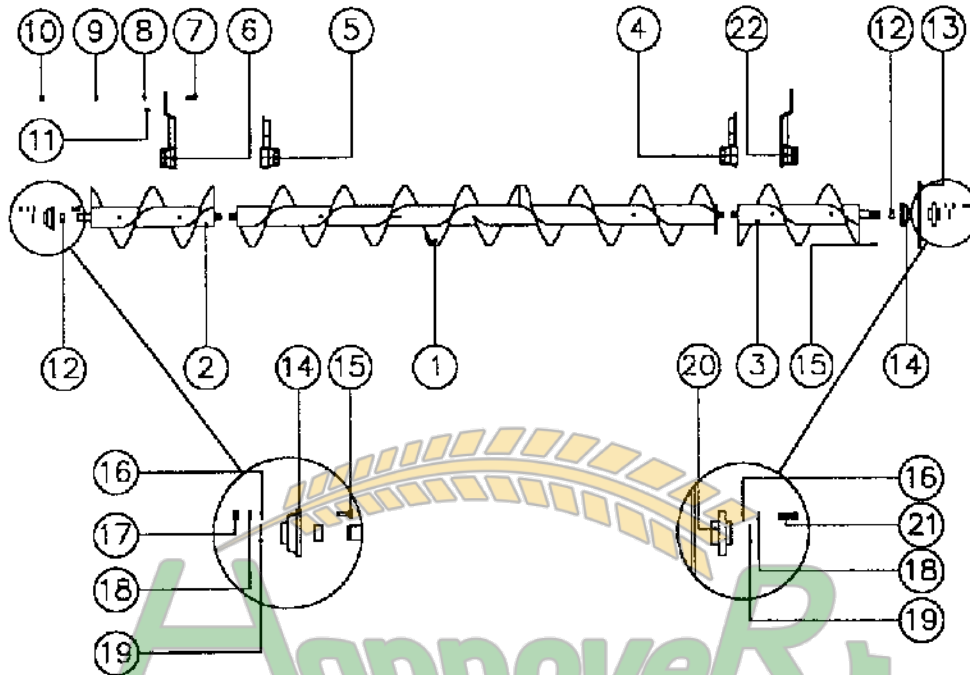

POS.	CODICE	DESCRIZIONE
1	SR0095	COCLEA CENTRALE 6/F R.75
1	SRSR0386	COCLEA CENTRALE 6/F R.80
2	SR0078	COCLEA LATERALE DX R.75
2	SR0390	COCLEA LATERALE DX R.80
3	SR0071	COCLEA LATERALE SX R.75
3	SR0393	COCLEA LATERALE SX R.80
4	SR0087	SUPPORTO COCLEA CENTRALE SX
5	SR0315	SUPPORTO COCLEA CENTRALE DX
6	SR0316	SUPPORTO COCLEA RIB. DX
7	B870101	VITE TE M16X45 UNI5739
8	B870086	ROSETTA PER M16 UNI6592
9	B870010	R.D.E. PER M16 UNI8842
10	B870011	DADO M16 ALTO UNI5587
11	B91019	SPINA ELAST. 8x25 UNI6875-71
12	SR0345	DISTANZIALE ESTERNO PER COCLEA
13	GS87710	CORONA Z62ASA60 FORI FILETTATI
14	S870003	SUPPORTO UCF208 mm40 BLOC. CON GRANO
15	B870051	LINGUETTA 10x8x40 UNI6604
16	B870044	ROSETTA PER M12 UNI6593
17	B870007	DADO M12 ALTO UNI5587
18	B870008	R.D.E. PER M12 UNI8842
19	B870052	ANILLO ELASTICO E40 UNI7435-75
20	GS87702	MOZZO COCLEA
21	B900006	VITE TE M12X45X1,25 UNI5738
22	SR0188	SUPPORTO COCLEA RIB. SX

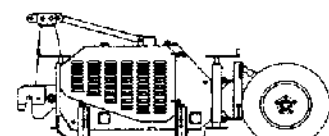
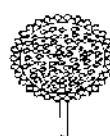
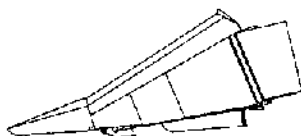

TRASMISSIONE COCLEA

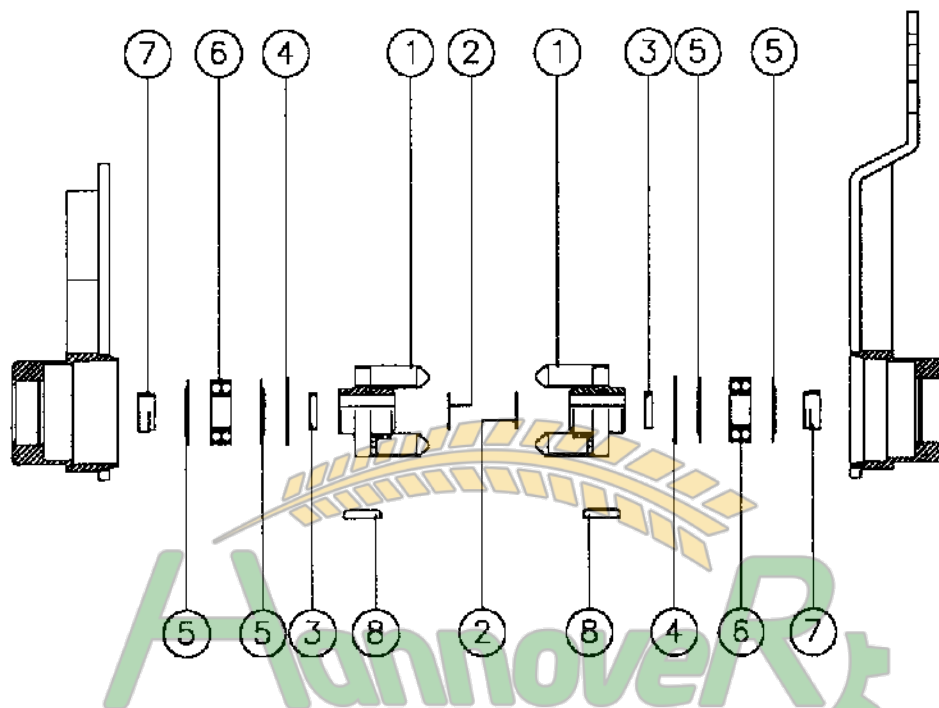

POS.	CODICE	DESCRIZIONE
1	SR0105	INNESTO COCLEA
2	B870025	ANELLO ELASTICO E30 UNI7435-75
3	SR0165	DISTANZIALE PER COCLEA
4	B870116	ANELLO ELASTICO I62 UNI7437-75
5	B91018	ANELLO NYLOS 2206 JV
6	CU9204	CUSCINETTO 2206 2RS
7	SR0166	DISTANZIALE POSTERIORE COCLEA
8	B870024	LINGUETTA 8x7x45

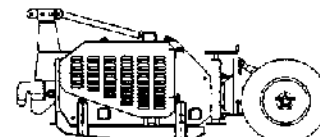

SCATOLA SENZA TRINCIASTOCCHI

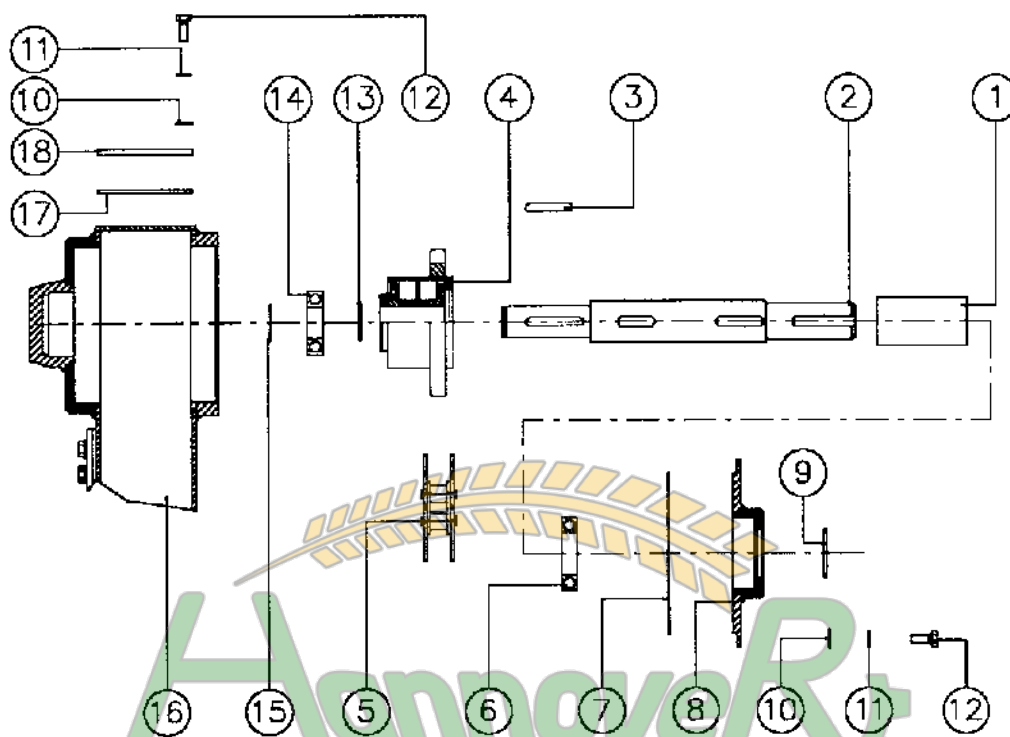

POS.	CODICE	DESCRIZIONE
1	SR0117	DISTANZIALE
2	SR0229	ALBERO PER SCATOLA TRASM.
3	B870024	LINGUETTA 8x7x45
4	SR0332	FRIZIONE Z16x1" 63 dNm
5	C92022	CATENA ASA80 57 PASSI +GIUNTO
6	CU910002	CUSCINETTO 6008
7	B91012	CORDA O.R. 1,78 LUNG. 470 mm
8	SR0069	COPERCHIO
9	B91008	O.R. 144
10	B870031	ROSETTA PER M8 UNI6592
11	B870032	R.D.E. PER M8 UNI8842
12	B870048	VITTE M8x16 UNI5739
13	B870077	RONDELLA DI RASAM. 30x42x0.5
14	CU910001	CUSCINETTO 6206
15	B870025	ANELLO ELASTICO E30 UNI7435-75
16	SR0338	SCATOLA TRASM. SALDATA DX
16	SR0016	SCATOLA TRASM. SALDATA SX
17	SR0109	GUARNIZIONE GOMMA MEDIA
18	SR0108	COPERCHIO SCATOLA

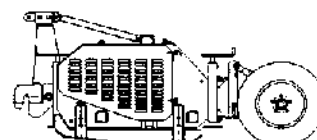

SCATOLA SENZA TRINCIASTOCCHI

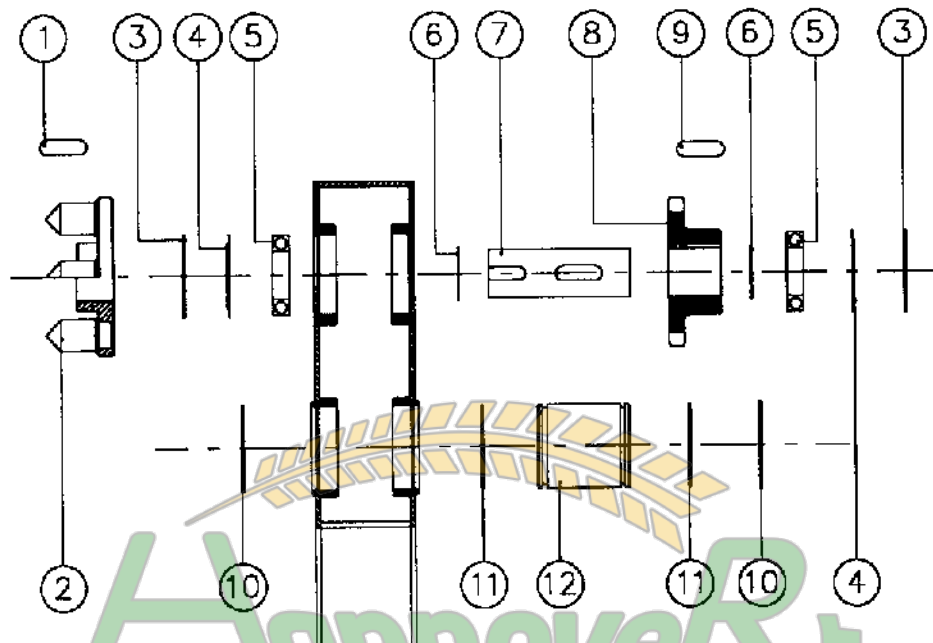

POS.	CODICE	DESCRIZIONE
1	B91015	LINGUETTA 12x8x35 UNI16604-69
2	SR0637	INNESTO TRASM. D=45 SX M.1993
2	SR0638	INNESTO TRASM. D=45 DX M.1993
3	B870060	ANELLO ELASTICO 175 UNI7437-75
4	B91016	ANELLO NILOS 6009 ZIV
5	CU870003	CUSCINETTO 6009-2RS
6	B92118	RONDELLA DI RASAM. 45x52x0.2
7	SR0090	BUSSOLA CEMENTATA
8	SR0331	PIGNIONE Z16 ASA 80 FORO 45 mm
9	B91014	LINGUETTA 12x8x45 UNI16604-69
10	B870087	ANELLO ELASTICO 180 UNI7437-75
11	B91011	OR 176
12	SR0129	TUBO CON SEDI PER OR

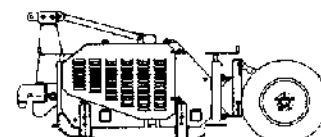
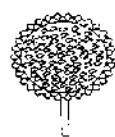

SCATOLA CON TRINCIASTOCCHI

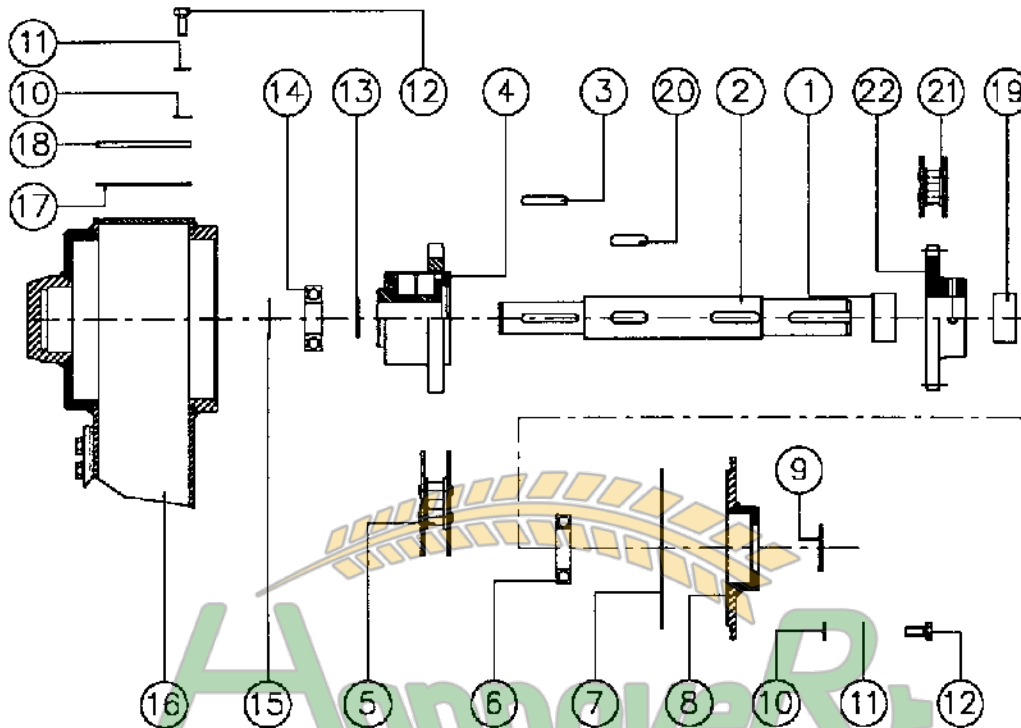

POS.	CODICE	DESCRIZIONE
1	SR0335	DISTANZIALE
2	SR0229	ALBERO PER SCATOLA TRASM.
3	B870024	LINGUETTA 8x7x45
4	SR0332	FRIZIONE Z16x1*63 dNm
5	C92022	CATENA ASA80 57 PASSI + GIUNTO
6	CU910002	CUSCINETTO 6008
7	B91012	CORDA O.R.1,78 LUNG.470 mm
8	SR0069	COPERCHIO
9	B91008	O.R. 144
10	B870031	ROSETTA PER M8 UNI 6592
11	B870032	R.D.E. PER M8 UNI 8842
12	B870048	VITE M8x16 UNI 5739
13	B870077	RONDELLA DI RASAM.30x42x0.5
14	CU910001	CUSCINETTO 6206
15	B870025	ANELLO ELASTICO I130 UNI7435-75
16	SR0338	SCATOLA TRASM. SALDATA DX
16	SR0016	SCATOLA TRASM. SALDATA SX
17	SR0109	GUARNIZIONE GOMMA MEDIA
18	SR0108	COPERCHIO SCATOLA
19	SR0334	DISTANZIALE
20	B890002	LINGUETTA 10x8x35
21	C92023	CATENA ASA60 H 69 PASSI
22	P22ASA60.G	PIGNONE Z22ASA60.G

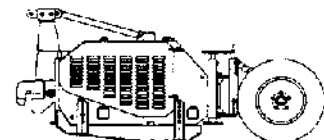

SCATOLA CON TRINCIASTOCCHI

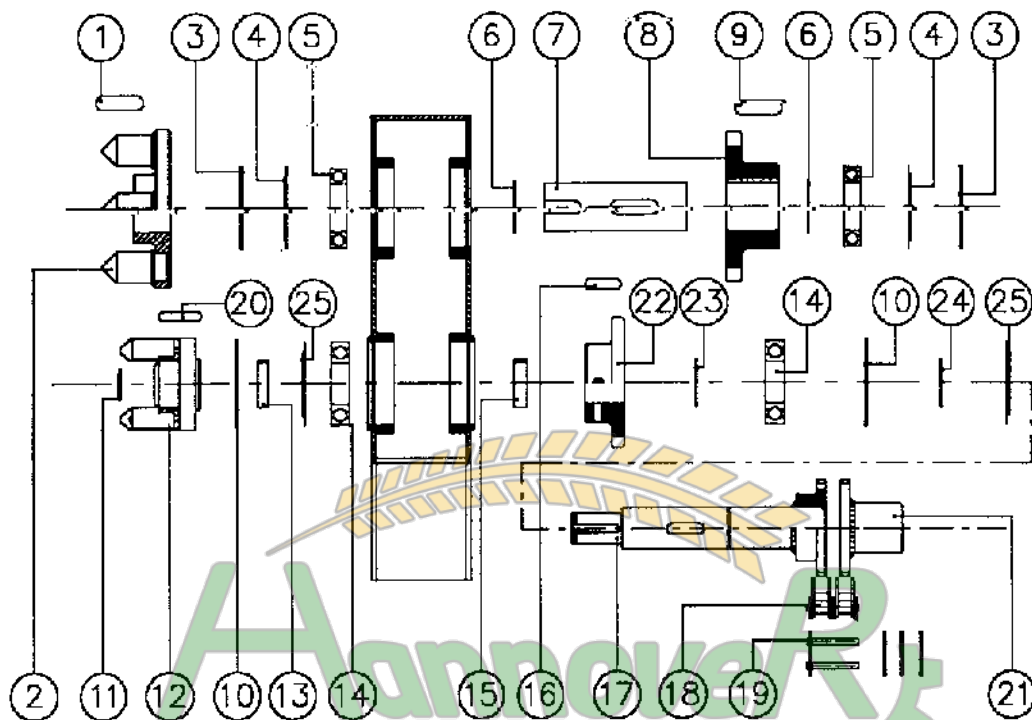

POS.	CODICE	DESCRIZIONE
1	B91015	LINGUETTA 12x8x35 UNI 6604-69
2	SR0638	INNESTO TRASM. D=45 SX M. 1993
2	SR0637	INNESTO TRASM. D=45 DX M. 1993
3	B870060	ANELLO ELAST. 175 UNI 7437-75
4	B91016	ANELLO NILOS 6009
5	CU870003	CUSCINETTO 6009-2RS
6	B92118	RONDELLA DI RASAM. 45x52x0.2
7	SR0090	BUSSOLA CEMENTATA
8	SR0331	PIGNONE Z. 16 ASA 80 FORO 45mm
9	B91014	LINGUETTA 12x8x45 UNI 6604-69
10	B870087	ANELLO ELAST. 180 UNI 7437-75
11	B870025	ANELLO ELAST. E30 UNI 7435-75
12	SR0321	INNESTO DX TRINCIASTOCCHI
13	SR0330	DIST. PER SCATOLA TRINC. 10mm
14	CU9203	CUSCINETTO 6208-2RS
15	SR0339	DIST. PER SCATOLA TRINC. 13mm
16	B890002	LINGUETTA 10x8x35 UNI 6604-69
17	SR0317	ALBERO PER SCATOLA TRINC.
18	C890007	CATENA ASA 60 DOPPIA 13 PASSI

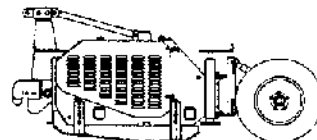

SCATOLA CONTRINCIASTOCCHI

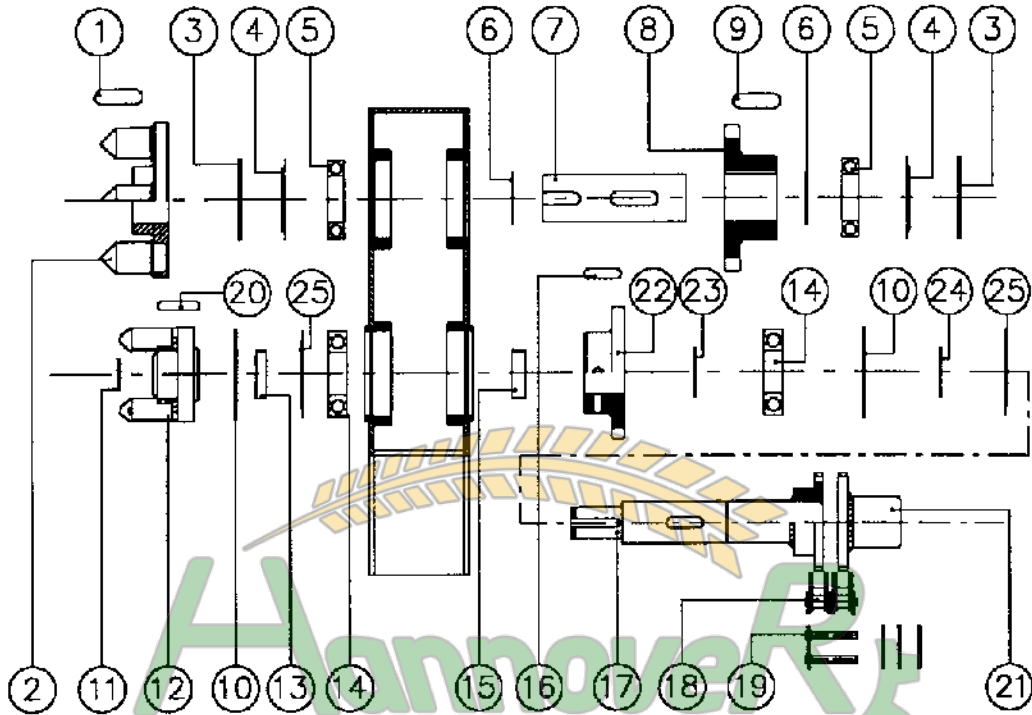

POS.	CODICE	DESCRIZIONE
------	--------	-------------

19	C890008	GIUNTO ASA 60 DOPPIO
20	B880004	LINGUETTA 8x7x40 UNI 6604-69
21	SR0319	GIUNTO TRASMISSIONE TRINC.
22	P19ASA60	PIGNONE Z 19 ASA 60
23	B91007	RONDELLA DI RASAM. 40x50x1
24	B870052	ANELLO ELAST.F40 UNI 7435-75
25	B92117	ANELLO NILOS 6208 ZJV

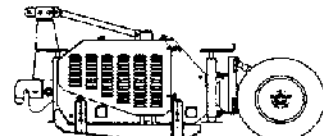
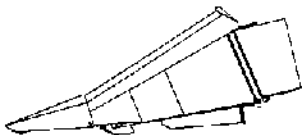

TENDITORI SCATOLA

TENDITORE CATENA TRINCIASTOCCHI

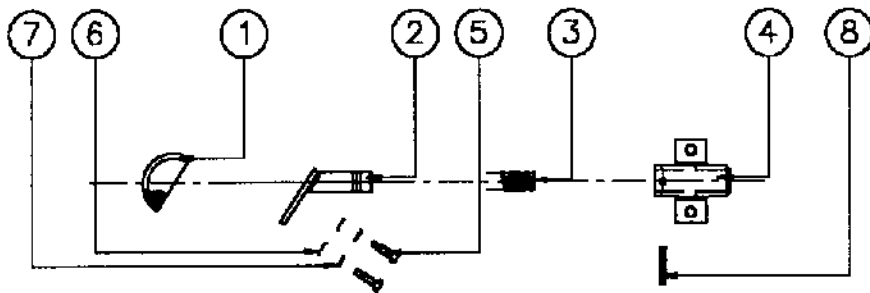

TENDITORE CATENA TRASMISSIONE

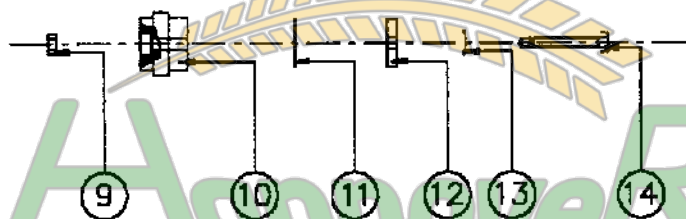

POS.	CODICE	DESCRIZIONE
1	SR0524	NYLON PER TENDITORE TR
2	SR0525	PERNO SCORREVOLE
3	SR0527	MOLLA PER TENDITORE TR
4	SR0526	TUBO PER PERNO TENDITORE TR
5	B870035	VITE M6x16 UNI 5739
6	BZ01029	ROSETTA PER M6 UNI 6592
7	B870037	R.D.E. PER M6 UNI 8842
8	B91009	SPINA ELAST. 6x35 UNI 6875-71
9	B870013	DADO M10 FLANG. TEMPRATO
10	SR0114	TENDITORE CATENA ASA80
11	SR0147	GUARNIZIONE
12	SR0140	PIATTO DI CHIUSURA
13	B870017	ROSETTA PER M10 UNI 6593
14	B90011	VITE M10x65 UNI 5737

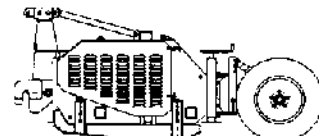

INNESTI PUNTA

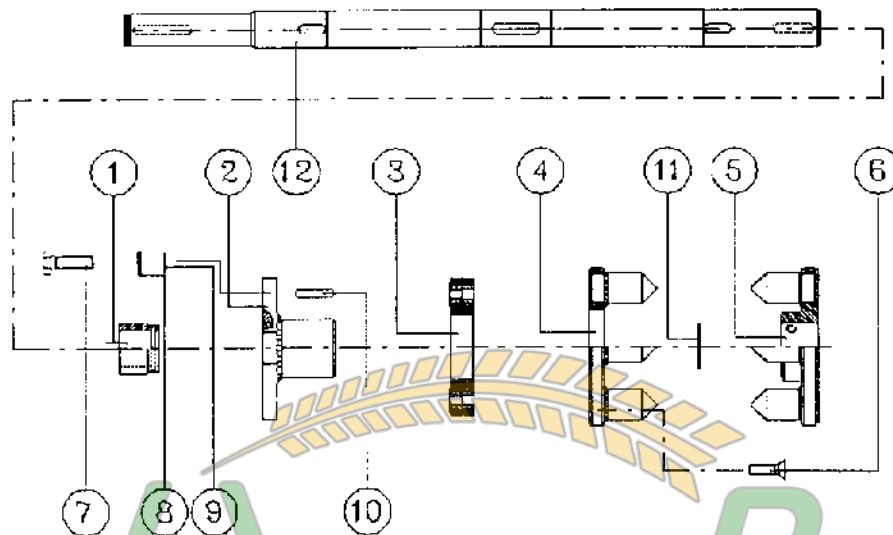

POS.	CODICE	DESCRIZIONE
1	SR0119	DISTANZIALE CON OR REG. 75-80
1	SR0119	DISTANZIALE CON OR REG. 70
2	SR0620	FLANGIA PORTA GOMMA REG. 75-80
2	SR0730	FLANGIA PORTA GOMMA REG. 70
3	SR0568	GIUNTO IN GOMMA
4	SR0639	INNESTO DX REG. 75-80
4	SR0740	INNWSTRD DX REG. 70
4	SR0640	INNESTO SX REG. 75-80
4	SR0732	INNESTO SX REG. 70
5	SR0637	INNESTO D=45 DX REG. 75-80
5	SR0729	INNESTO D=45 DX REG. 70
5	SR0638	INNESTO D=45 SX REG. 75-80
5	SR0638	INNESTO D=45 SX REG. 70
6	B900007	VITE M10x35 UNI 5933
6	B890015	VITE M10x30 UNI 5933
7	B92012	VITE M12x40 UNI 5739
7	B92037	VITE TSEI M10x25 UNI 5933
8	B870017	ROSETTA PER M10 UNI 6593
9	B870033	R.D.E. PER M10 UNI 8842
10	B870024	LINGUETTA 8x7x45
11	B870238	ANELLO ELAST. E35 UNI 7435-75
12	SR0521	ALBERO RIBALTABILE REG. 80
12	SR0121	ALBERO RIBALTABILE REG. 75
12	SR0759	ALBERO RIBALTABILE REG. 70

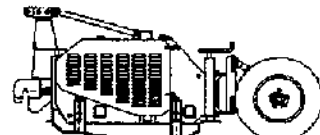

INNESTO TRINCIASTOCCHI

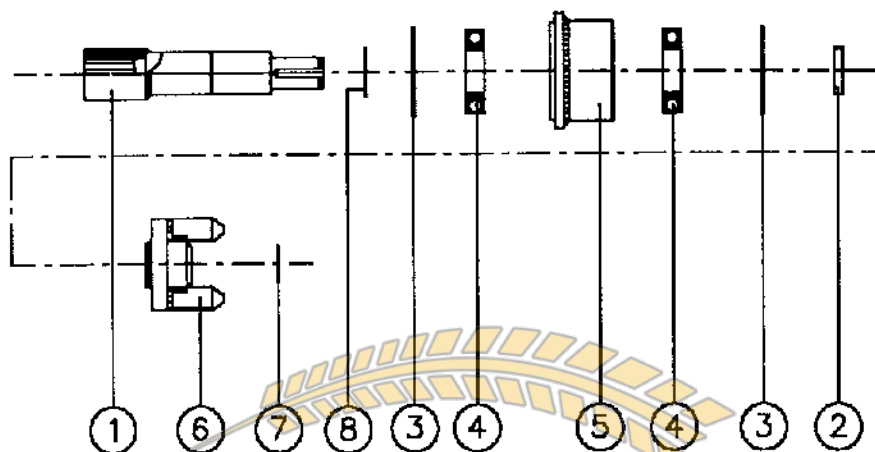

POS.	CODICE	DESCRIZIONE
1	SR0312	ALBERO TRASMIS. TRINCIASTOCCHI
2	SR0325	DISTANZIALE TRASMIS. TRINCIASTOCCHI
3	B870087	ANELLO ELAST. I80 UNI 7437-75
4	CU9207	CUSCINETTO RADIALE 6208-Z
5	SR0327	BUSSOLA CON FLANGIA
6	SR0323	INNESTO SX TRINCIASTOCCHI
6	SR0321	INNESTO DX TRINCIASTOCCHI
7	B870025	ANELLO ELAST. E30 UNI 7435-75
8	B870052	ANELLO ELAST. UNI 7435-75

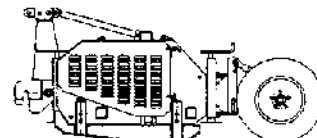
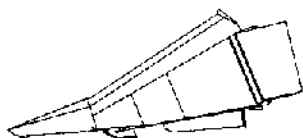

TRINCIASTOCCHI

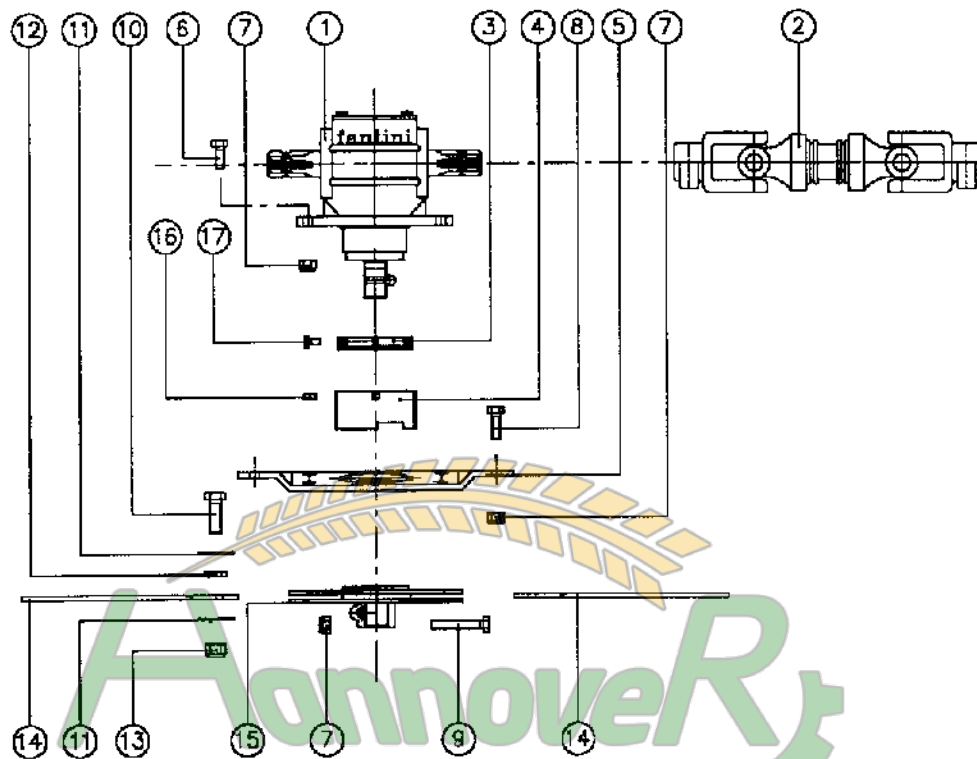

POS.	CODICE	DESCRIZIONE
1	SP88100	MOLTIPLICATORE
2	SP045871	CARDANO PER REG. 75
2	SP044871	CARDANO PER REG. 80
3	91034	RONDELLA DI SPESSORE PER TRIC.
4	91020	PROTEZIONE SCAT. TR. CON ROND.
5	SP882616	PIASTRA FISSAGGIO
6	B870027	VITE M12x30 UNI 7539
7	B870028	DADO M12 ALTO AUTOBLOCCANTE
8	B870041	VITE M12x35 UNI 5739
9	B90002	VITE M12x70 UNI 5737
10	B870101	VITE M16x45 UNI 5739
11	B91024	GREMBIALINA 16x48x3 UNI 6593
12	SP882603	BOCCOLA PER TRINC. TEMPRATA
13	B870059	DADO M16 ALTO AUTOBLOCCANTE
14	SP882602/A	COLTELLO L-260
14	SP882602	COLTELLO L-290
14	SP882602/B	COLTELLO L-310
15	SP882617	SUPPORTO COLTELLI
16	B92097	GRANO A COPPA M8x16 UNI 5929
17	B870030	VITE M8x16 UNI 5739

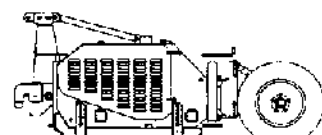

SCATOLA TRINCIASDOCCHI

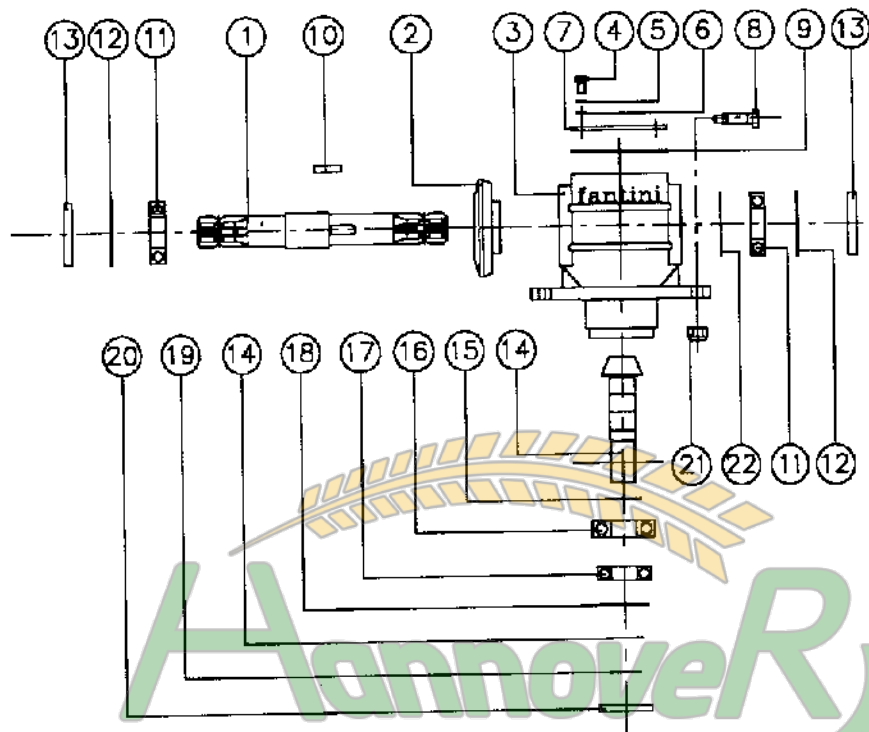

POS.	CODICE	DESCRIZIONE
1	SP87110	ALBERO SCATOLA TRINC.
2	SP87109	CORONA Z28 M4
3	SP87116	SCATOLA TRINC. VUOTA
4	B900039	VITE M8x14 UNI 5739
5	B870037	R.D.F. PER M6 UNI 8842
6	B870036	ROSETTA PER M6 UNI 6593
7	SP87101	COPERCHIO SCATOLA 120x5x120
8	B870027	VITE M12x30 UNI 5739
9	SP87102	GUARNIZIONE 120x3x120
10	B870242	LINGUETTA 10x8x30 RON.
11	CU870014	CUSCINETTO 6207
12	B870085	ANELLO ELAST. 172 UNI 7437-75
13	B870240	ANELLO DI TENUTA 35x72x10
14	SP87108	PIGNONE Z10 M4
15	B870077	RONDELLA DI RASAM. 30x42x0.5
16	CU870001	CUSCINETTO 6306
17	CU870002	CUSCINETTO 6206-2RS
18	B870243	ANELLO NYLOS 6206 AV
19	B870025	ANELLO ELAST. F30 UNI 7435-75
20	B870021	ANELLO DI TENUTA 30x62x7
21	B870028	DADO M12 ALTO AUTOBLOCCANTE
22	B91023	RONDELLA DI RASAM. 60.3x71.7

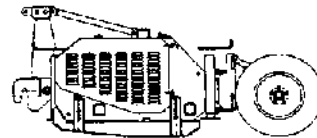
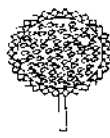

PUNTA

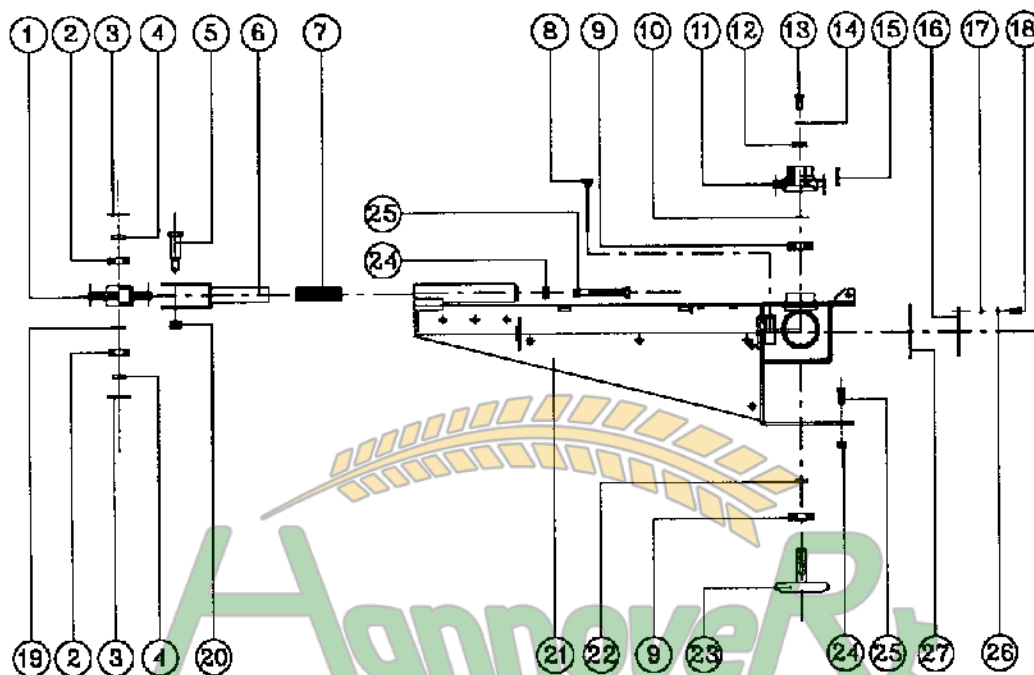

POS.	CODICE	DESCRIZIONE
1	SP882908	PIGNONE GHISA Z11 PASSO 41,4
2	CU870010	CUSCINETTO 6205 2RS
3	B870065	ANELLO ELAST. I52 UNI 7427-75
4	GS871312	DISTANZIALE 32x3 7mm
5	GS871310	PERNO ESAGONALE E30
6	GS871333	FORCELLA TENDICATENA
7	GS871334	MOLLA PER FORCELLA TENDICATENA
8	P910002	TAPPO DI LIVELLO DA 3/8
9	CU870004	CUSCINETTO 6305 2RS
10	B870061	RONDELLA DI RASAM. 25x42x0,5
11	SP882802	PIGNONE Z9 PASSO 41,4
12	SP871005	RONDELLA 36x13x8
13	B870027	VITE M12x30 UNI 5739
14	B870033	R.D.E. PER M10 UNI 8842
15	B870024	LINGUETTA 8x7x45
16	SP871015	COPERCHIO SCATOLA SP
17	B870031	ROSETTA PER M8 UNI 6592
18	B870048	VITE M8x20 UNI 5739
19	GS871313	DISTANZIALE 32x3 L=6mm
20	B870059	DADO M16 ALTO AUTOBLOCCANTE

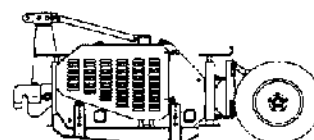
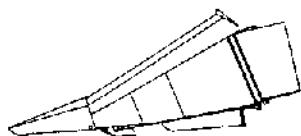

PUNTA

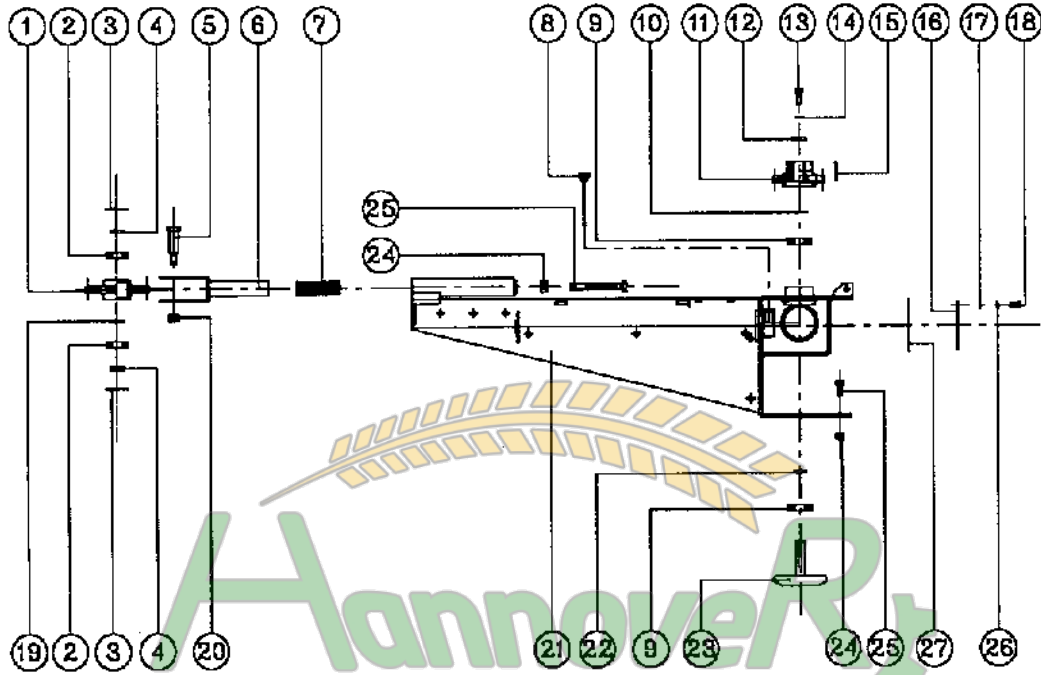

POS. CODICE DESCRIZIONE

21	SP882900/A	TELAIO PUNTA CENTRALF.
21	SR0594	TELAIO PUNTA PH RINF. LAT.
22	SP871008	SPESSORE
23	SP882809	CORONA CON GAMBO Z27 M5
24	B870028	DADO M12 ALTO AUTOBLOCCANTE
25	B870027	VITTE M12x30 UNI 5739
26	B870032	R.D.E. PER M8 UNI 8842
27	SP871016	GUARNIZIONE GOMMA 120x3-290

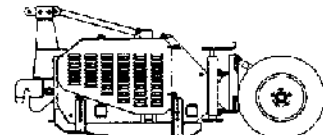
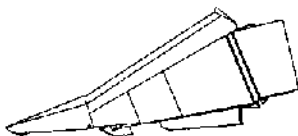

PUNTA

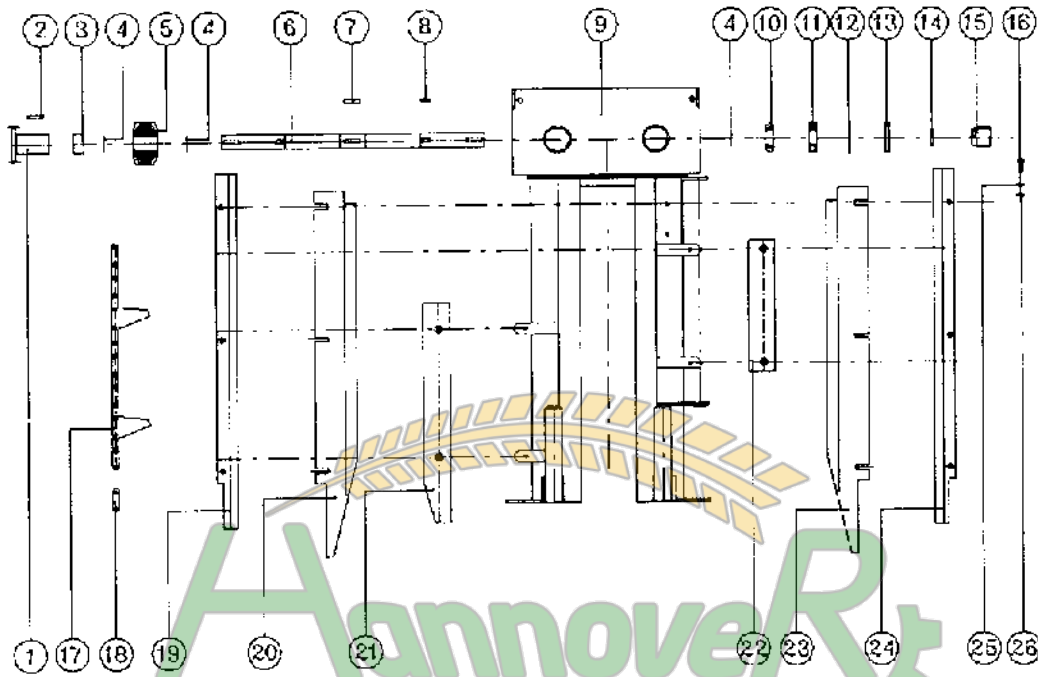

POS.	CODICE	DESCRIZIONE
1	GS88425/70	GIUNTO PER R 70 GS. CATENE
1	GS88425/75	GIUNTO PER R 75 GS. CATENE
1	GS88425/80	GIUNTO PER R 80 GS. CATENE
2	B870024	LINGUETTA 8x7x45
3	SP882803/70	TUBO 48.3x8 LG=19 DIST.REG.70
3	SP882803/75	TUBO 48.3x8 LG=45 DIST.REG.75
3	SP882803/80	TUBO 48.3x8 LG=71 DIST.REG.80
4	B870238	ANELLO ELAST. E35 UNI 7435-75
5	SP882811	CORONA DOPPIA 7,22 M5
6	SR0118	ALBERO SCATOLA GRUPPO LATERALE FISSA
6	SP882810/L	ALBERO SCATOLA GRUPPO CENTRALE
7	B870104	LINGUETTA 10x8x45
8	B870098	LINGUETTA 8x7x25
9	SP882900/A	TELAIO PUNTA
10	SP882805	INGRANAGGIO Z15 M5
11	CU870006	CUSCINETTO 6307
12	B870087	ANELLO ELAST. I80 UNI 7437-75
13	P870003	ANELLO DI TENUTA 45x80x10
14	P870001	O.R. 4137
15	GS88422	DISTANZIALE CON O.R. L=27mm
16	B870012	VITE M10x25 UNI 5739
17	C880001	CATENA DI RACCOLTA CA550 61P
18	C890016	MAGLIA GIUNZIONE CA550

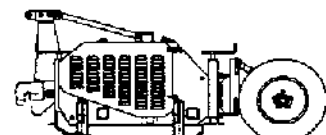
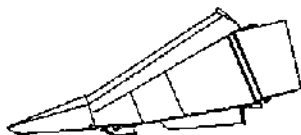

PUNTA

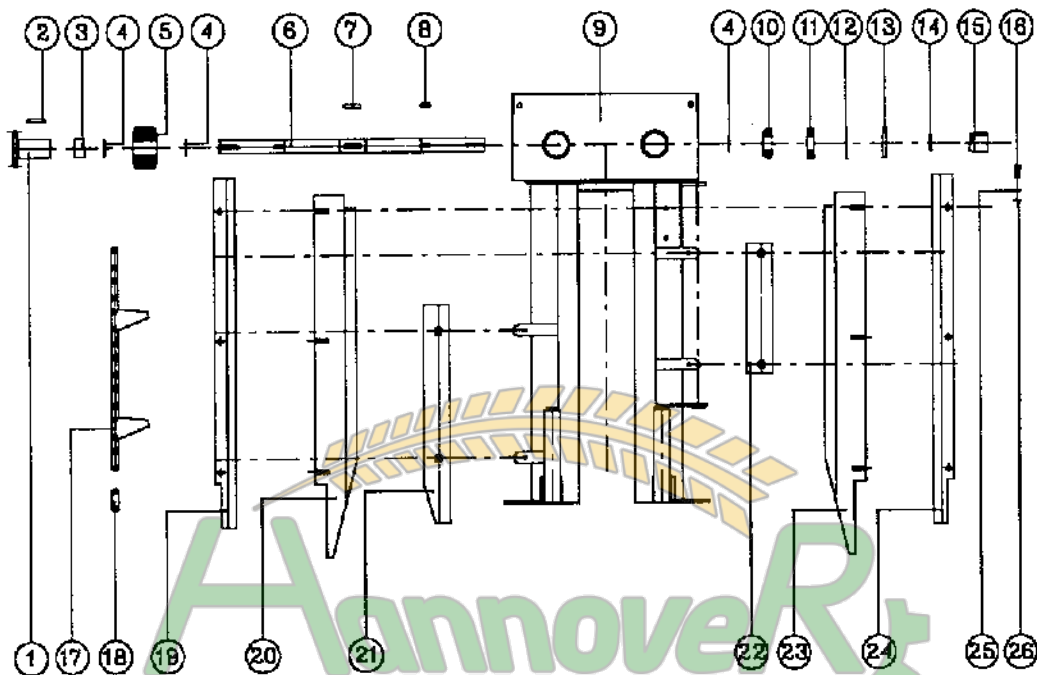

POS.	CODICE	DESCRIZIONE
19	SP88910/D	GUIDA CAT. DI RACCOLTA DX
20	SP882907/B	LAMA STR. PAN. PIEG. DX
20	SP88912/D	LAMA STR. PAN. DX
21	SP882905/S	ASSICELLA DX
22	SP891201/A	ASSICELLA SX 70x15x350 L.E.
22	SP882905/S	ASSICELLA SX
23	SP882907/A	LAMA STR. PAN. PIEG. SX
23	SP88912/S	LAMA STR. PAN. SX
24	SP88910/S	GUIDA CATENA SX
25	B870033	R.D.E. PER M10 UNI 8842
26	B870017	ROSETTA PER M10 UNI 6593

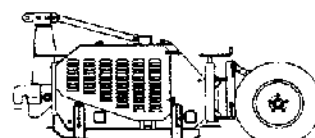

RULLO MUNGITORE

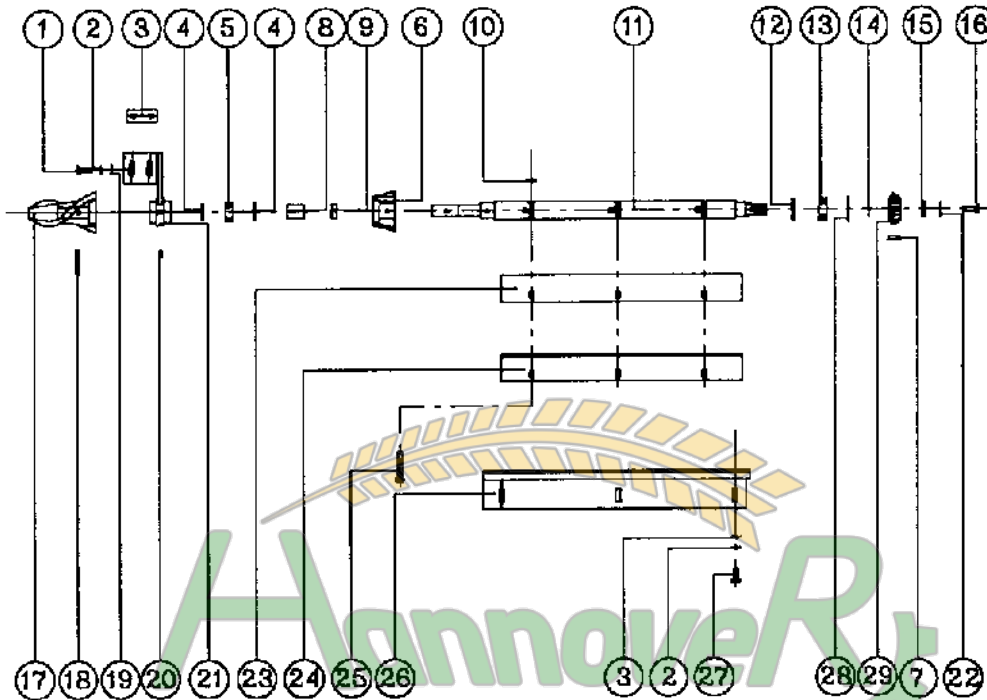

POS.	CODICE	DESCRIZIONE
1	B870067	VITE M10x30 UNI 5739
2	B870033	R.D.E. PER M10 UNI 8842
3	SP88608	PIATTO SUPPORTO RULLI 30x4x70
4	P870004	ANELLO DI TENUTA 30x37x4 DM
5	CU870007	CUSCINETTO A RULLINI DHK 3038
6	SP88609/D	PRIMARIO DESTRO IN GHISA
6	SP88609/S	PRIMARIO SINISTRO IN GHISA
7	B870002	LINGUETTA 8x7x30 UNI 6604-69A
8	CU870009	BOCCOLA LR 25x30x38.5
9	CU870008	BOCCOLA LR 25x30x12.5
10	B870013	DADO M10 h=8 FLANG. TEMPRATO
11	SP88601	ALBERO QUADRO 40x40x722
12	B870064	ANELLO DI TENUTA 32x45x7 DPSM
13	CU870005	CUSCINETTO 2205-2RS
14	SP871019	DISTANZIALE 32x3 L=5
15	SP871021	RONDELLA 33x10.5x6
16	B870067	VITE M10x30 UNI 5739
17	SP88610/D	PUNTA IN GHISA DESTRA
17	SP88610/S	PUNTA IN GHISA SINISTRA
18	B870093	SPINA ELAST. 8x55 UNI 6875-71
19	B870017	ROSETTA PER M10 UNI 6593
20	B870092	INGRASSATORE 1/8 GAS DIRITTO

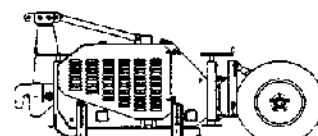
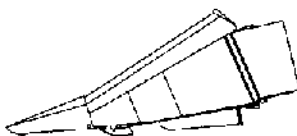

RULLO MUNGITORE

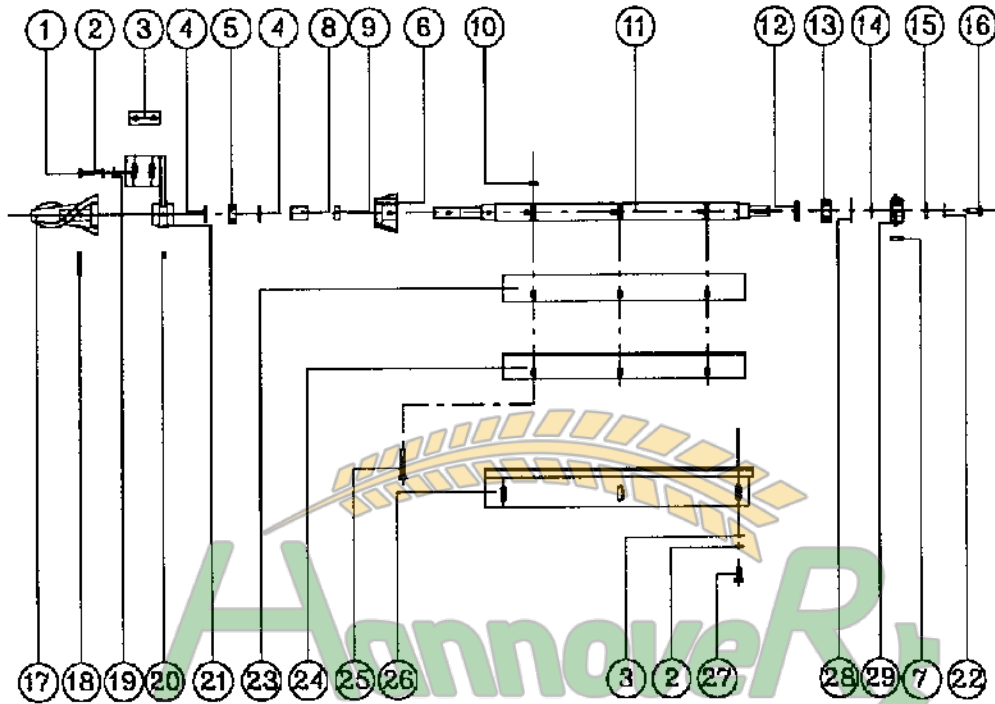

POS.	CODICE	DESCRIZIONE
21	SP88612/D	SUPPORTO ANTERIORE RULLO DX
21	SP88612/S	SUPPORTO ANTERIORE RULLO SX
22	B870066	GREMBIALINA 10x30x1 UNI 6593
23	FA70025	COLTELLO NORMALE
24	SP88602/R	COLTELLO CR DESTRO
24	SP88602/L	COLTELLO CR SINISTRO
25	890001	VITE M10x60 UNI 5739
26	SP88913/D	CONTRO COLTELLO DESTRO
26	SP88913/S	CONTRO COLTELLO SINISTRO
27	B870012	VITE M10x25 UNI 5739
28	B870065	ANELLO ELAST. I52 UNI 7437-35
29	SP871020	PIGNONE Z13 M5

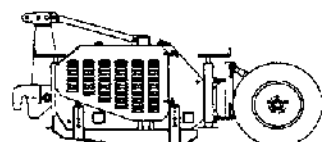
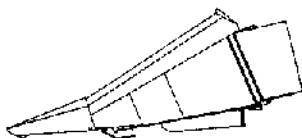

COFANTURA

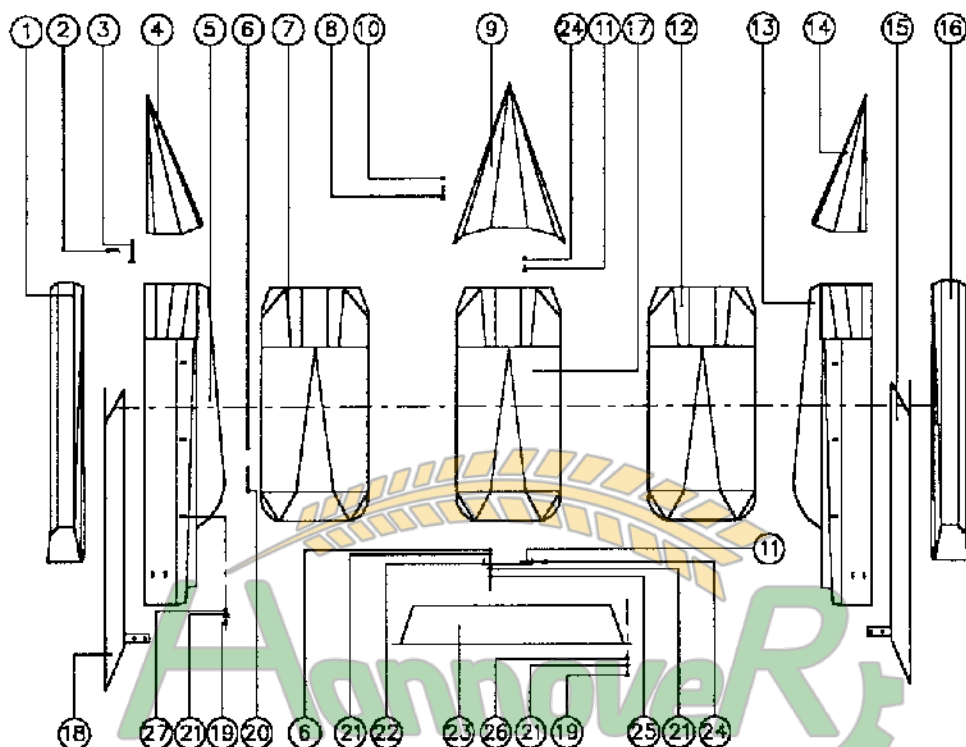

POS.	CODICE	DESCRIZIONE
1	SR0439	SOVRASPONDA BASSA SX
1	SR0487	SOVRASPONDA ALTA SX
2	BZ870029	COPIGLIA FI. mm3.5 UNI 8833 Z.
3	SR0671	SPINA PER PUNTA SPARTIFILE RIB
4	SR0214	PUNTA LATERALE SX
5	SR0438	COFANO LAT. SX BASSO SP. PH.
6	B870019	DADO M8 ALTO AUTOBLOCCANTE
7	SR0591	COFANO LAT. PUNTA RIB. SX R70
7	SR0209	COFANO LAT. PUNTA RIB. SX R75
7	SR0542	COFANO LAT. PUNTA RIB. SX R80
8	HZ92120	VITE M10x70 UNI 5739 ZINCATA
9	SR0781	PUNTA CENTRALE R70 RIBALTAB.
9	SR0212	PUNTA CENTRALE R75 RIBALTAB.
9	SR0540	PUNTA CENTRALE R80 RIBALTAB.
10	BZ92116	DADO M10 MEDIO ZINC. UNI 5588
11	BZ870010	VITE M10x25 ZINC. UNI 5739
12	SR0592	COFANO LAT. PUNTA RIB. DX R70
12	SR0208	COFANO LAT. PUNTA RIB. DX R75
12	SR0541	COFANO LAT. PUNTA RIB. DX R80
13	SR0210	COFANO LAT. DX BASSO SP. PH.
14	SR0213	PUNTA LATERALE DX
15	SR0488	SPONDA DX COCLEA
16	SR0440	SOVRASPONDA BASSA DX
16	SR0486	SOVRASPONDA ALTA DX
17	SR0593	COFANO CENTRALE R70 SP. PH.

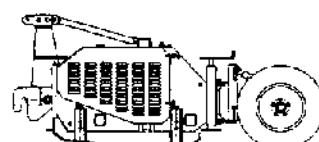
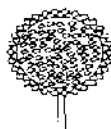
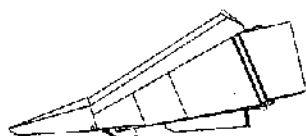

COFANATURA

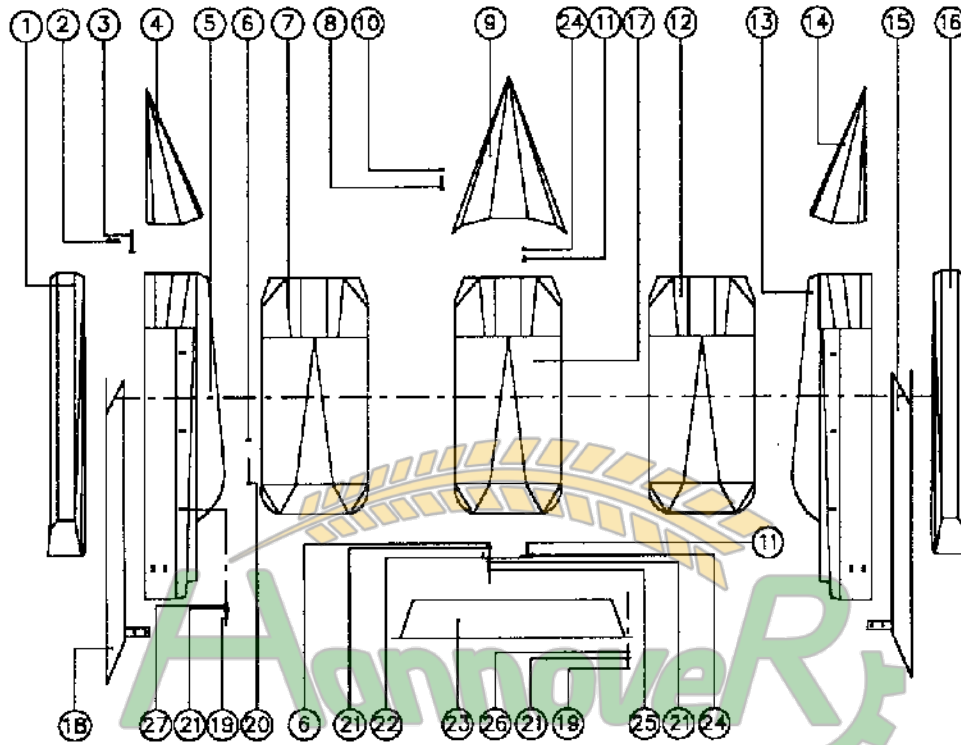

POS.	CODICE	DESCRIZIONE
17	SR0207	COFANO CENTRALE R75 SP. PH.
17	SR0543	COFANO CENTRALE R80 SP. PH.
18	SR0489	SPONDA SX COCLEA
19	BZ870030	VITE M8x20 ZINC. UNI 5739
20	SR0673	VITE PER COFANO LAT. RIB.
21	BZ870022	GREMBIALINA 8x24 UNI 6593 ZINC
22	SP882725	PIATTO FISSAGGIO COFANO R70
22	SP882726	PIATTO FISSAGGIO COFANO R75
22	SP882727	PIATTO FISSAGGIO COFANO R80
23	SR0341	PROTEZIONE COCLEA ZINCATA
24	B870006	DADO M10 ALTO AUTOBLOCCANTE
25	BZ870016	VITE M8x25 UNI 5739 ZINCATA
26	BZ870014	R.D.E. PER M8 UNI 8842 ZINCATA
27	B92031	DADO FLANGIATO M8

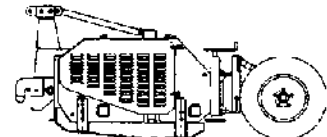

CARTER INTERFILELA - ASTE LAME ELETTRICHE

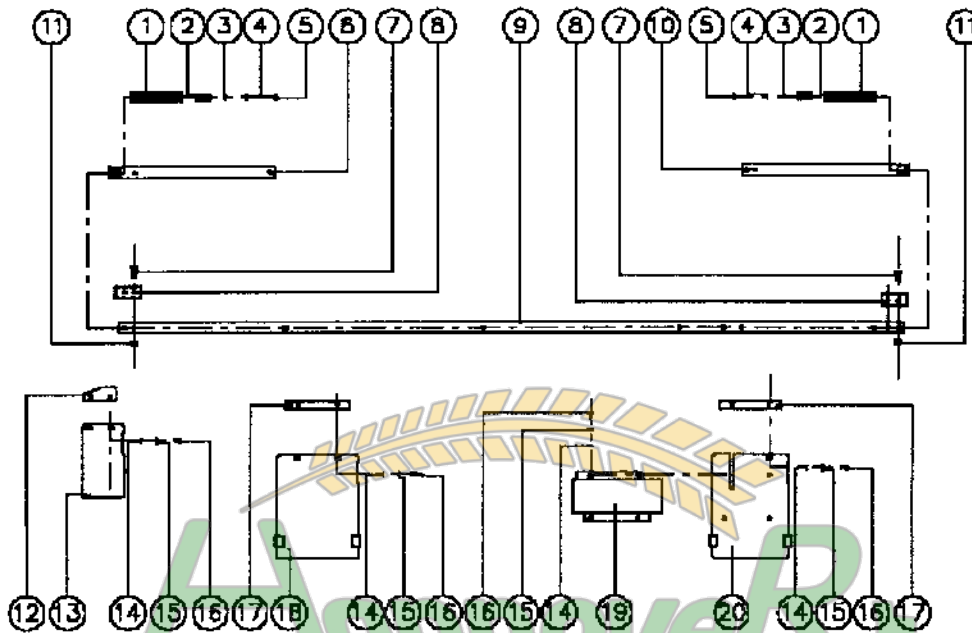

POS.	CODICE	DESCRIZIONE
1	SR0301	MOLLA DI RITORNO
2	SR0892	PERNO PER MOLLA DI RITORNO
3	BZ870034	R.D.E. PER M10 UNI 8842
4	BZ870011	ROSETTA PER M10 ZINCATA
5	B870067	VITE M10x30 UNI 5739
6	SR0309	ASTA COMANDO DX R.75
7	B91001	VITE TSEI M12x35 UNI 5933
8	SR0306	PIATTO APOGGIO ASTA L.E.
9	SR0789	ASTA CENTR. COMANDO I.F. R.70
9	SR0308	ASTA CENTR. COMANDO L.E. R.75
9	SR0790	ASTA CENTR. COMANDO L.E. R.80
10	SR0893	ASTA COMANDO SX R.70
10	SR0302	ASTA COMANDO SX R.75
10	SR0894	ASTA COMANDO SX R.80
11	B870028	DADO M12 ALTO AUTOBLOCCANTE
12	SR0795	CARTER SUPERIORE DX R.70
12	SR0796	CARTER SUPERIORE SX R.70
12	SR0703	CARTER SUPERIORE DX R.75
12	SR0705	CARTER SUPERIORE SX R.75
12	SR0709	CARTER SUPERIORE DX R.80
12	SR0710	CARTER SUPERIORE SX R.80
13	SR0792	LAMIERA CARTER DX R.70
13	SR0793	LAMIERA CARTER SX R.70
13	SR0432	LAMIERA CARTER DX R.75
13	SR0436	LAMIERA CARTER SX R.75

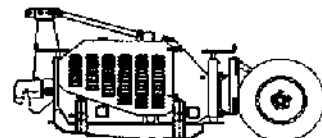
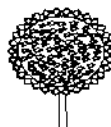
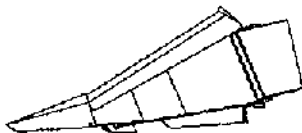

CARTER INTERFILA - ASTE LAME ELETTRICHE

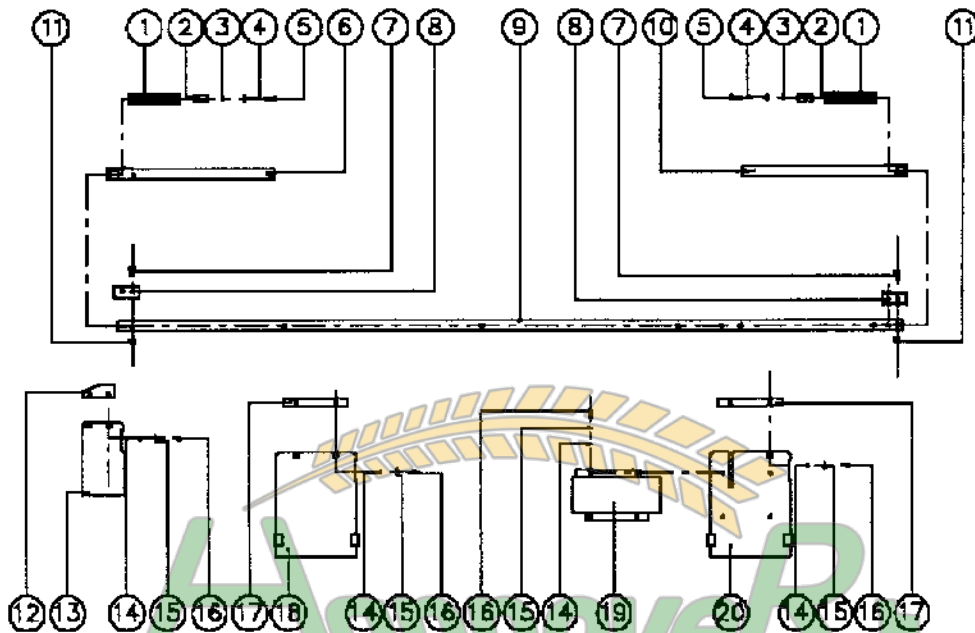

POS.	CODICE	DESCRIZIONE
13	SR0442	LAMIERA CARTER DX R.80
13	SR0444	LAMIERA CARTER SX R.80
14	BZ870022	GREMBIALINA 8x24 UNI 6593 ZINC
15	BZ870014	R.D.E. PER M8 UNI 8842 ZINC.
16	BZ870030	VITE M8x20 UNI 5739 ZINCATA
17	SP891213A/70	CARTER SUPERIORE INTERFILA
17	SP891213A/75	CARTER SUPERIORE INTERFILA
17	SP891213A/80	CARTER SUPERIORE INTERFILA
18	SP891211A/70	CARTER INTERFILA ANTERIORE
18	SP891211A/75	CARTER INTERFILA ANTERIORE
18	SP891211A/80	CARTER INTERFILA ANTERIORE
19	SP891212A/70	PROTEZIONE ATTUATORE
19	SP891212A/75	PROTEZIONE ATTUATORE
19	SP891212A/80	PROTEZIONE ATTUATORE
20	SP891211B/70	CARTER ANTERIORE I.E.
20	SP891211B/75	CARTER ANTERIORE I.E.
20	SP891211B/80	CARTER ANTERIORE I.E.

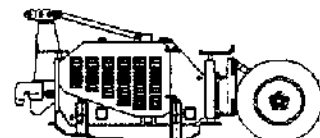
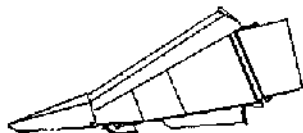

IMPIANTO LAME ELETTRICHE

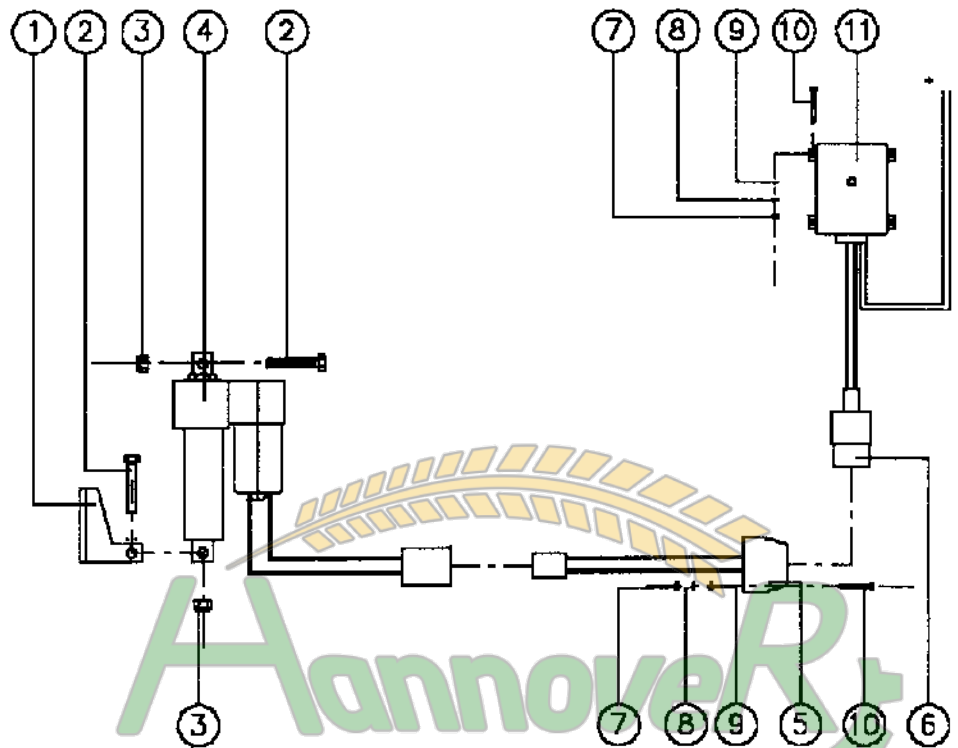

POS.	CODICE	DESCRIZIONE
1	SP891203A	ASTA AGGANCIO
2	B90002	VITE M12x70 UNI 5737
3	B870028	DADO M12 ALTO AUTOBLOCCANTE
4	SP891216	ATTUATORE LINEARE 2200 N
5	SP891220	SPINA FEMMINA
6	SP891219	SPINA MASCHIO
7	BZ890006	DADO M5 ALTO UNI 5587 ZINC.
8	BZ890007	R.D.E. PER M5 UNI 8842 ZINC.
9	BZ890008	ROSETTA PER M5 ZINCATA
10	BZ890005	VITE TC M5x40 UNI 6107 ZINC.
11	SP891218	CENTRALINA COMANDO ATTU.MCS302

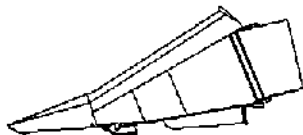

LAMELETTRICHE

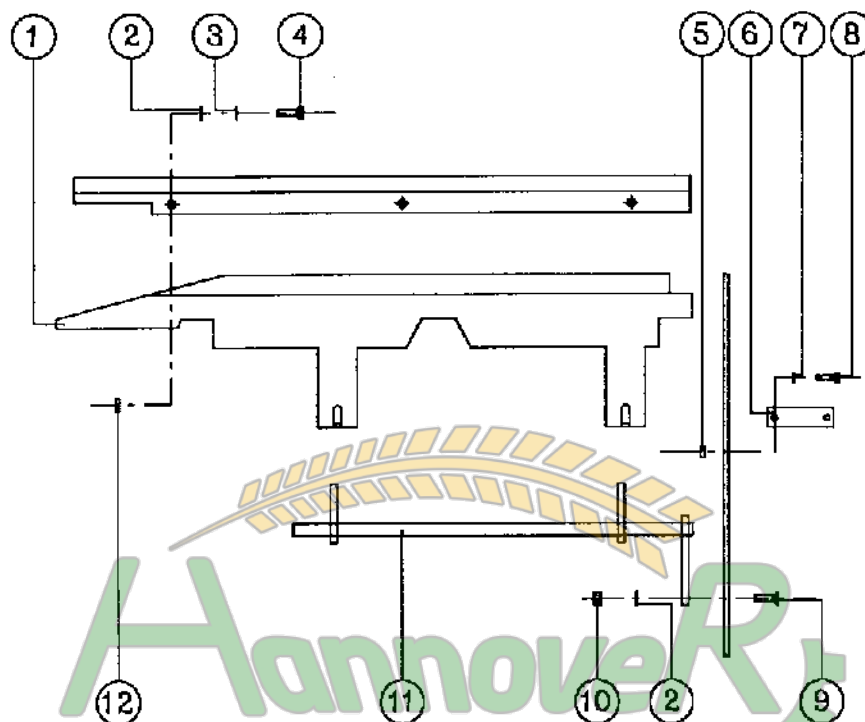

POS.	CODICE	DESCRIZIONE
1	SP891206/A	LAMA STRAPPAPANOCCHIA SX
2	B870017	ROSETTA PER M10 UNI 6593
3	B870033	R.D.E. PER M10 UNI 8842
4	B870067	VITE M10x30 UNI 5739
5	SP891208/A	SPESSORE 18x6.5
6	SP891215/A	PIASTRINA DI FISSAGGIO LAMA
7	B870031	ROSETTA PER M8 UNI 6592
8	B900008	VITE M8x30 UNI 5739
9	B900007	VITE TSEI M10x35 UNI 5933
10	B870006	DADO M12 ALTO AUTOBLOCCANTE
11	SP891210	BILANCERE
11	SP891210/L	BILANCERE LATERALE
12	SP891207/A	DISTANZIALE 20x5 L=6.5

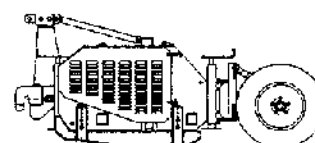

LAME ELETTRICHE

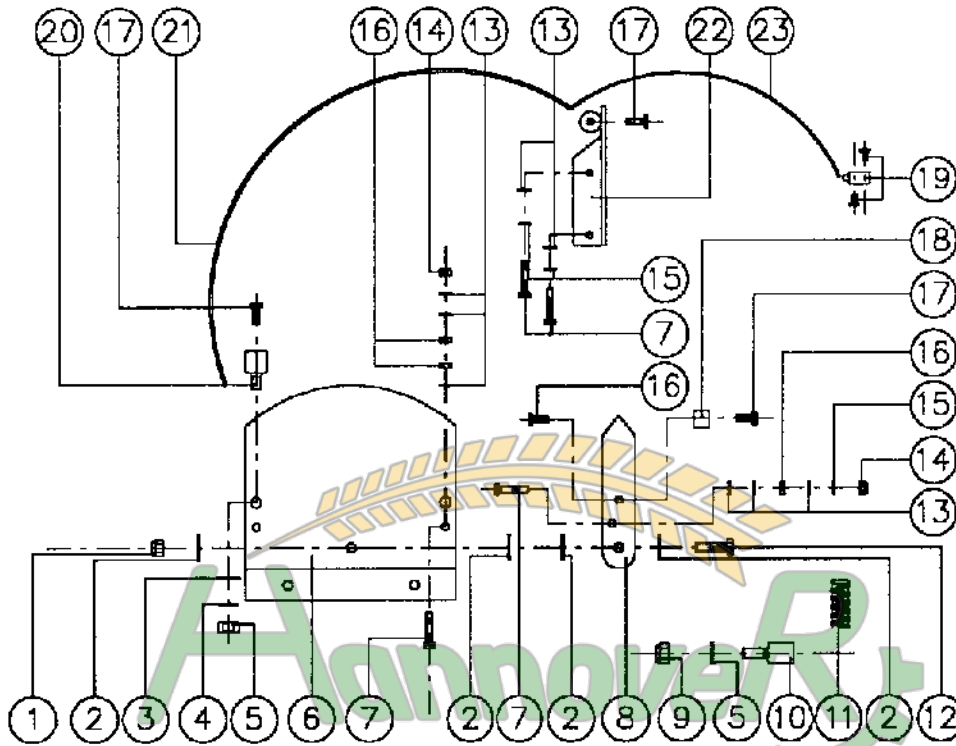

POS. CODICE DESCRIZIONE

POS.	CODICE	DESCRIZIONE
1	B870019	DADO M8 ALTO AUTOBLOCCANTE
2	BZ870022	GRIMBIALINA 8x24 UNI 6593 ZINC
3	B870017	ROSETTA PER M10 UNI 6593
4	B870033	R.D.E. PER M10 UNI 8842
5	B870034	DADO M10 ALTO UNI 5587
6	SP0095	SEGNA CORSA MOD. 1993
7	BZ91028	VITE M6x30 UNI 5739 ZINC.
8	SP0096	INDICATORE PER L.E. MOD. 1993
9	B870006	DADO M10 ALTO AUTOBLOCCANTE
10	SP891218/A	FERMA FILO PER ASTA
11	SP891607	MOLLA PER INDICATORE L.E.
12	BZ870018	VITE M8x30 UNI 5739 ZINC.
13	BZ91029	ROSETTA PER M6 UNI 6592 ZINC.
14	B870040	DADO M6 AUTOBLOCCANTE BASSO
15	BZ91030	R.D.E. PER M6 UNI 8842 ZINC.
16	BZ91032	DADO M6 UNI 5588 ZINC.
17	BZ91027	VITE M6x16 UNI 5739 ZINC.
18	SP891218/B	FERMA FILO PER INDICATORE
19	SP891608	MORSETTO
20	SP891219/A	FERMO GUAINA PICCOLO
21	SP891606	GUAINA FLESSIBILE
22	SP891220/A	FERMO GUAINA
23	SP891605	FILO PER GUAINA

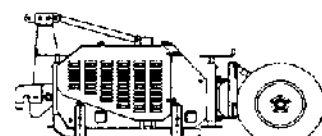
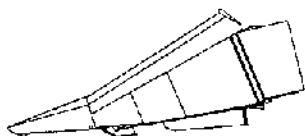

COFANATURA LATERALE

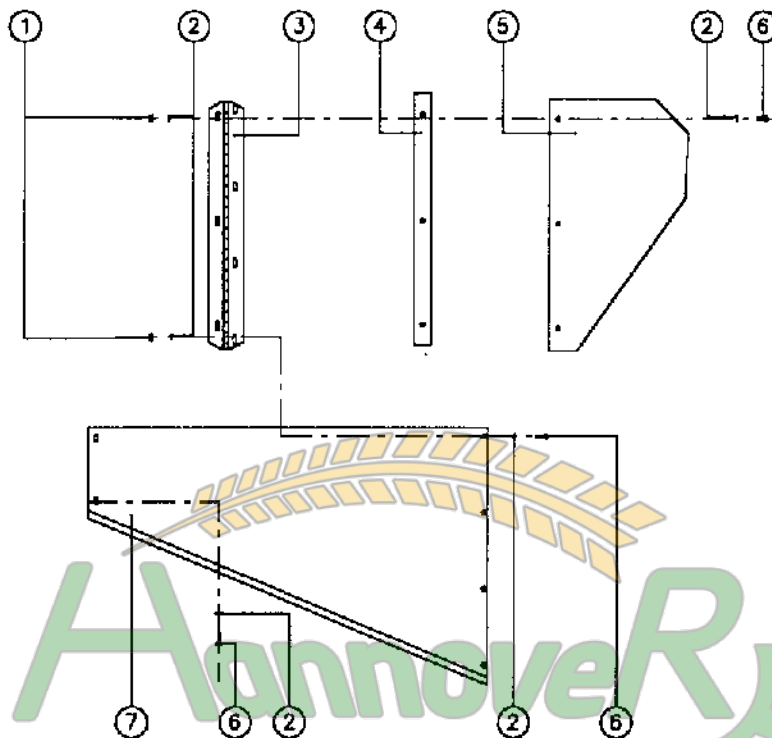

POS.	CODICE	DESCRIZIONE
------	--------	-------------

1	B92031	DADO M8 FLANGIATO
2	BZ870013	ROSETTA PER M8 ZINCATA
3	90109	CERNIERA PER CARTER LATERALI
4	SR0520	SUPPORTO CERNIERE CARTER LAT.
5	SR0461	CARTER POSTERIORE DX
5	SR0462	CARTER POSTERIORE SX
6	BZ870016	VITE M8x25 UNI 5739 ZINCATA
7	SR0459	ALETTA DX
7	SR0460	ALETTA SX

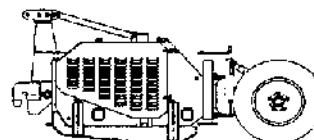
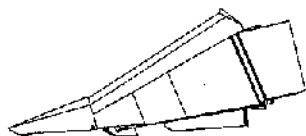

PROTEZIONE TRINCIAS TOCCHIò

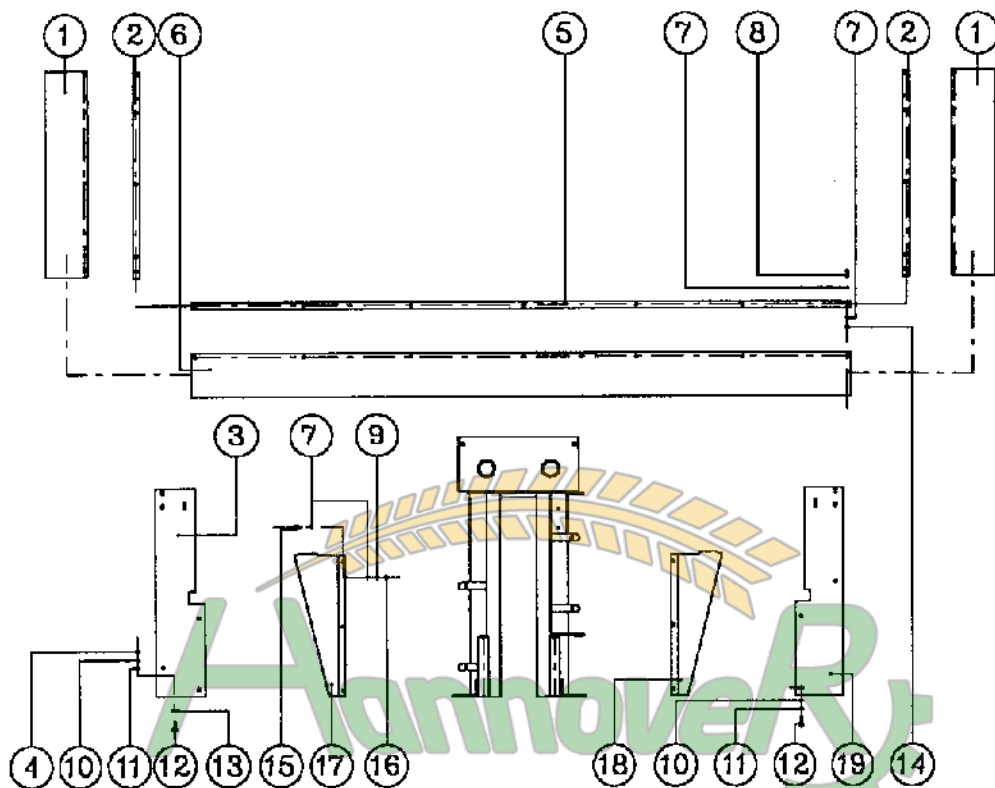

POS. CODICE DESCRIZIONE

1	SR0694	GOMMA PROT. TRINC. LAT. R.70
1	SR0661	GOMMA PROT. TRINC. LAT. R.75
1	SR0662	GOMMA PROT. TRINC. LAT. R.80
2	SR0693	FISSAG. GOMMA TR. TEL. RIB. R.70
2	SR0654	FISSAG. GOMMA TR. TEL. RIB. R.75
2	SR0693	FISSAG. GOMMA TR. TEL. RIB. R.80
3	SP882607/D	PROTEZIONE LAT. TRINC. DX
4	B870034	DADO M10 ALTO UNI 5587
5	SR0696	FISSAGGIO GOMMA TEL. FIS. R.70
5	SR0655	FISSAGGIO GOMMA TEL. FIS. R.75
5	SR0656	FISSAGGIO GOMMA TEL. FIS. R.80
6	SR0695	GOMMA PROT. TELAIO FISSO R.70
6	SR0659	GOMMA PROT. TELAIO FISSO R.75
6	SR0660	GOMMA PROT. TELAIO FISSO R.80
7	BZ870013	ROSETTA PER M8 UNI 6592 ZINC.
8	BZ870018	VITE M8x30 UNI 5739 ZINCATA
9	B870032	R.D.E. PER M8 UNI 8842
10	BZ870033	R.D.E. PER M10 UNI 8842
11	B870017	ROSETTA PER M10 UNI 6593
12	B870012	VITE M10x25 UNI 5739
13	B870005	GREMBIALINA 10x30x3 UNI 6593
14	BZ900006	DADO FLANGIATO ZINCATO

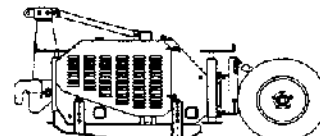
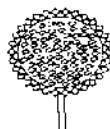

PROTEZIONE TRINCIACOCCHI

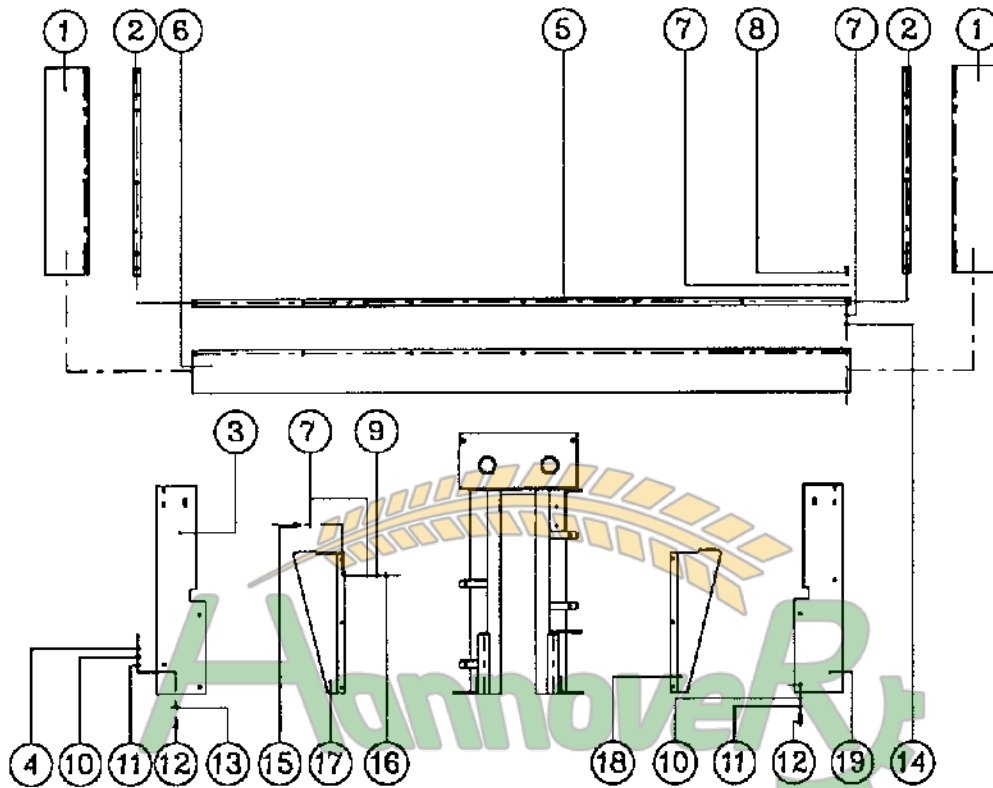

POS. CODICE DESCRIZIONE

15	B870048	VITE M8x20 UNI 5739
16	B870050	DADO M8 ALTO UNI 5587
17	SP882601/S	CARTER SINISTRO
18	SP882601/D	CARTER DESTRO
19	SP882607/S	PROTEZIONE LAT. TRINC. SX

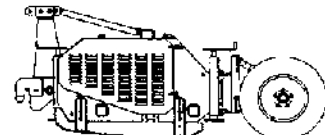
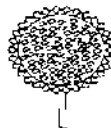
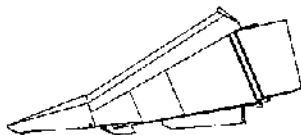

IMPIANTO IDRAULICO DI SOLLEVAMENTO SUPERIORE

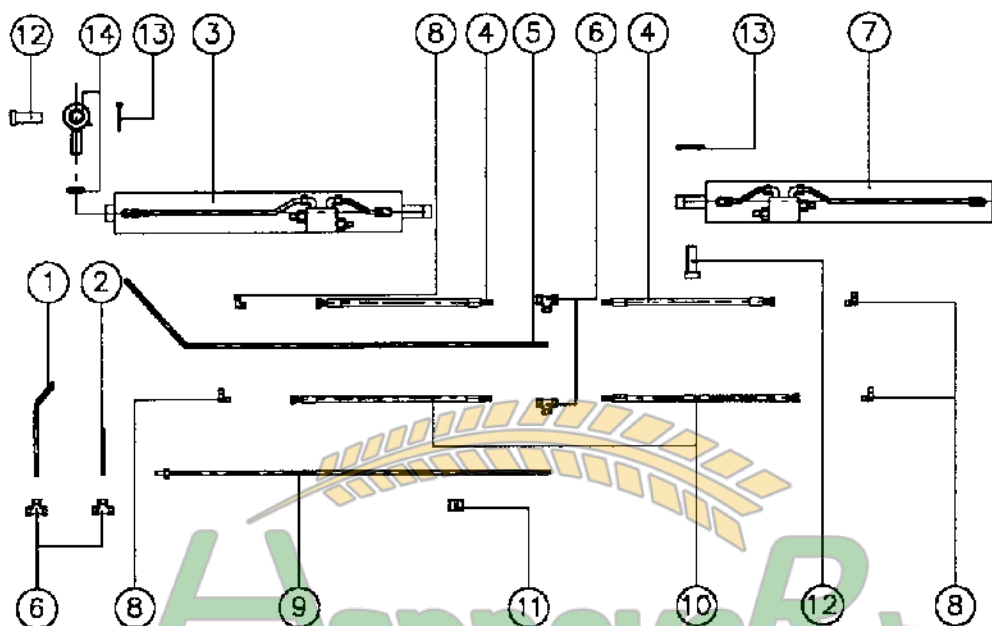

POS.	CODICE	DESCRIZIONE
1	SR0806	TUBO ZINCATO D10 SUPERIORE
2	SR0805	TUBO ZINCATO D10 SUPERIORE
3	SR0112S	CILINDRO DI SOLLEVAMENTO SX
4	SR0274	TUBO R2 1/4 AT F1/4+T10 L.400
5	SR0807	TUBO ZINCATO D10 SUPERIORE
6	SR0191	ADATTATORE T 3 OGIVE D.10
7	SR0112D	CILINDRO DI SOLLEVAMENTO DX
8	B93025	RIDUZIONE 90 M1/4 M1/4
9	SR0808	TUBO ZINCATO D10 SUPERIORE
10	SR0275	TUBO R2 1/4 AT F1/4+T10 L.450
11	B92086	COLLARE COMPLETO 2 TUBI D10-10
12	SR0464	PERNO FISSAGGIO CILINDRO
13	BZ92115	COPIGLIA 6x60 UNI 1336 ZINCATA
14	S92010	SNODO SFERICO SKF GE25ES M24x2À

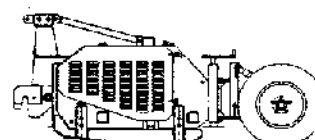
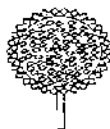

IMPIANTO IDRAULICO DI SOLLEVAMENTO

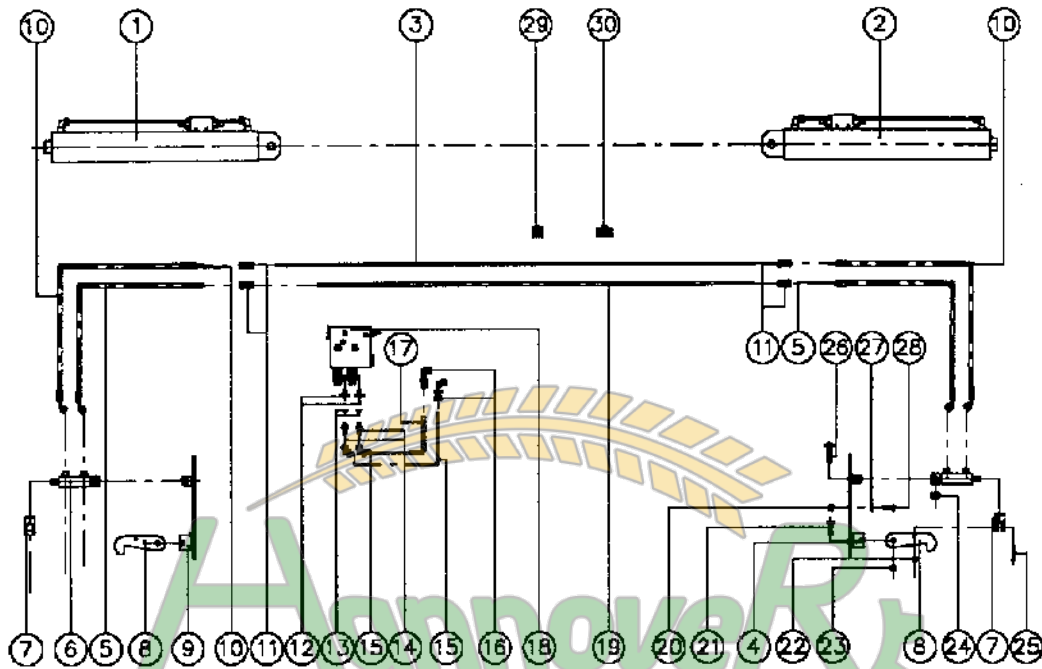

POS.	CODICE	DESCRIZIONE
1	SR0112/S	CILINDRO DI SOLLEVAMENTO SX
2	SR0112/D	CILINDRO DI SOLLEVAMENTO DX
3	SR0561	TUBO ZINCATO D10 L2170
4	SR0430	AGGANCIO PER CIL. BLOCC. DX
5	SR0505	TUBO R2 AT L862
6	SR0150	CILINDRO DI BLOCCAGGIO
7	SR0398	AGGANCIO PER CIL. DI BLOCC.
8	SR0456	BECCO DI BLOCCAGGIO
9	SR0425	AGGANCIO PER CIL. DI BLOCC. SX
10	SR0504	TUBO R2 AT L1002
11	SR0887	RACC. DIRITTO TUBO D10 D10
12	SR0651	RIDUZIONE+GUARNIZ M 1/2 F 1/4
13	SR0184	RONDELLE IN RAME 1/4
14	SR0174	RIDUZIONE M 1/4 OGIVA 10
15	B920103	RACC. OLEOD. E 237 10L
16	B920102	RACC. OLEOD. E 302 10L.
17	SR0809	TUBO ZINC. D10 MASSELLO CORTO
18	SR0256	BLOCCO VALVOLE IN ALLUMINIO
19	SR0560	TUBO ZINCATO D10 L.2300
20	B870013	DADO M10 h=0,8 FLANG. TEMPR.
21	B92156	VITE TSEI M12x45 UNI 5933
22	B870019	DADO M8 ALTO AUTOBLOCCANTE
23	B870028	DADO M12 ALTO AUTOBLOCCANTE
24	B870059	DADO M16 ALTO AUTOBLOCCANTE
25	B92035	VITE TSEI M8x50 UNI 5933

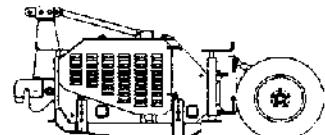
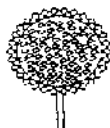

IMPIANTO IDRAULICO DI SOLLEVAMENTO

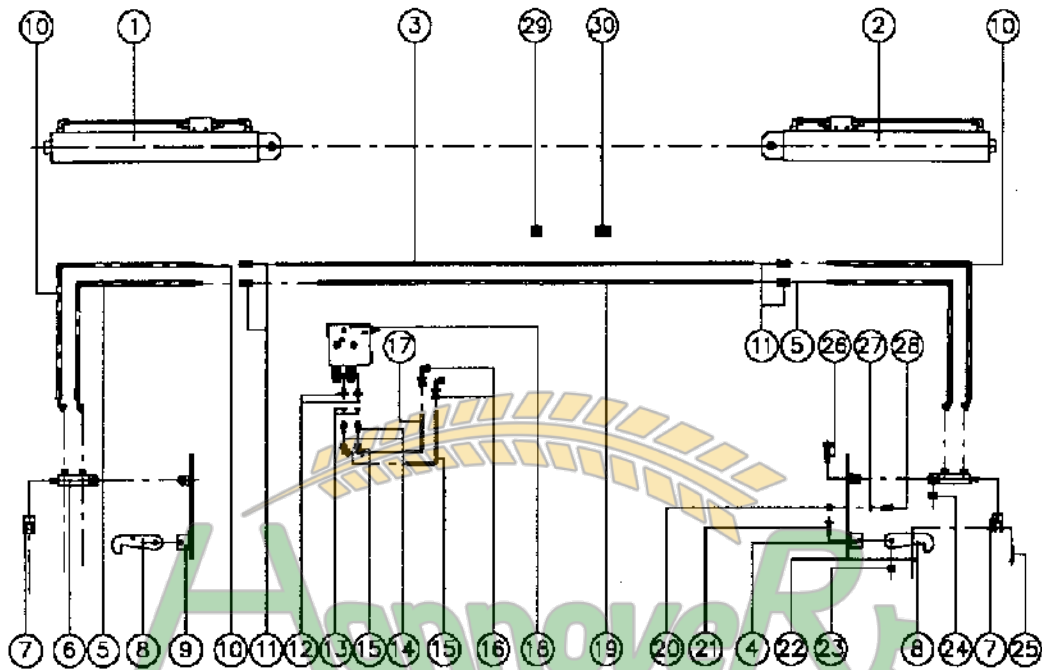

POS.	CODICE	DESCRIZIONE
------	--------	-------------

26	B870076	VITE M16x55 UNI 5739
27	B870017	ROSETTA PER M10 UNI 6593
28	B870067	VITE M10x30 UNI 5739
29	B92086	COLLARE COMPLETO 2TUBI d.10-10
30	B92087	COLLARE COMPLETO 2TUBI d.15-15

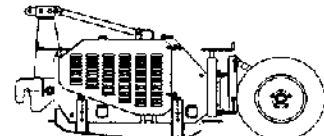
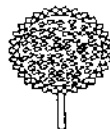
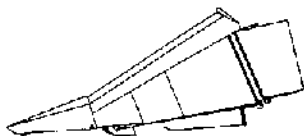

COCLEE IDRAULICHE LATERALIÀ

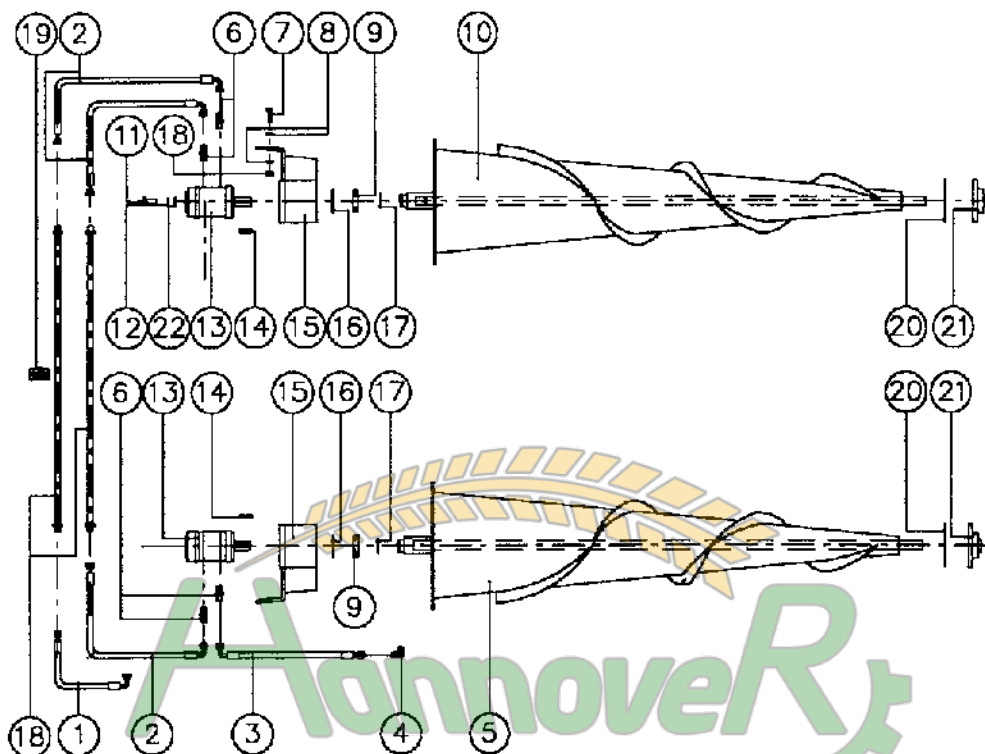

POS.	CODICE	DESCRIZIONE
1	SR0700	TUBO DA FILTRO A T. DI RITORNO
2	SR0817	TUBO DA MOTORE A TUBO IN FERRO
3	SR0701	TUBO DEVIATORE MOTORE COCLEA
4	B93025	NIPLES DI RIDUZIONE M1/4 M1/4
5	SR0551	COCLEA CONICA DX
6	B870225	NIPLES DI CONGIUNZIONE 3/8 3/8
7	BZ870032	VITE M10x30 UNI 5739 ZINC.
8	BZ870011	ROSETTA PER M10 ZINCATÀ
9	CL900001	CUSCINETTO 6007-2RS
10	SR0400	COCLEA CONICA SX
11	BZ870001	VITE M12x30 UNI 5739 ZINC.
12	BZ870004	R.D.E. PER M12 UNI 8842 ZINC.
13	CI880002	MOTORE IDRAULICO OMP50 COCLEE
14	B870002	LINGUETTA 8x7x30 UNI 6604-69A
15	SR0738	SUPPORTO COCLEA LAT. MOD.1993
16	B870116	ANELLO ELAST. 162 UNI 7437-75
17	B870238	ANELLO ELAST. E35 UNI 7435-75
18	SP87309/575	TUBO IN Fe CON NIPLES SALDATO
19	B92087	COLLARE COMPL. 2 TUBI d.15-15
20	SP87308	PROT. SUPP. ANT. COCLEA
21	S900001	SUPPORTO UCHL BLOC. CON GRANO
22	BZ870035	ROSETTA PER M12 UNI 6593

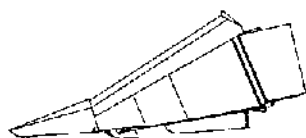

TRASM. POST. - TENDITORE CATENA -

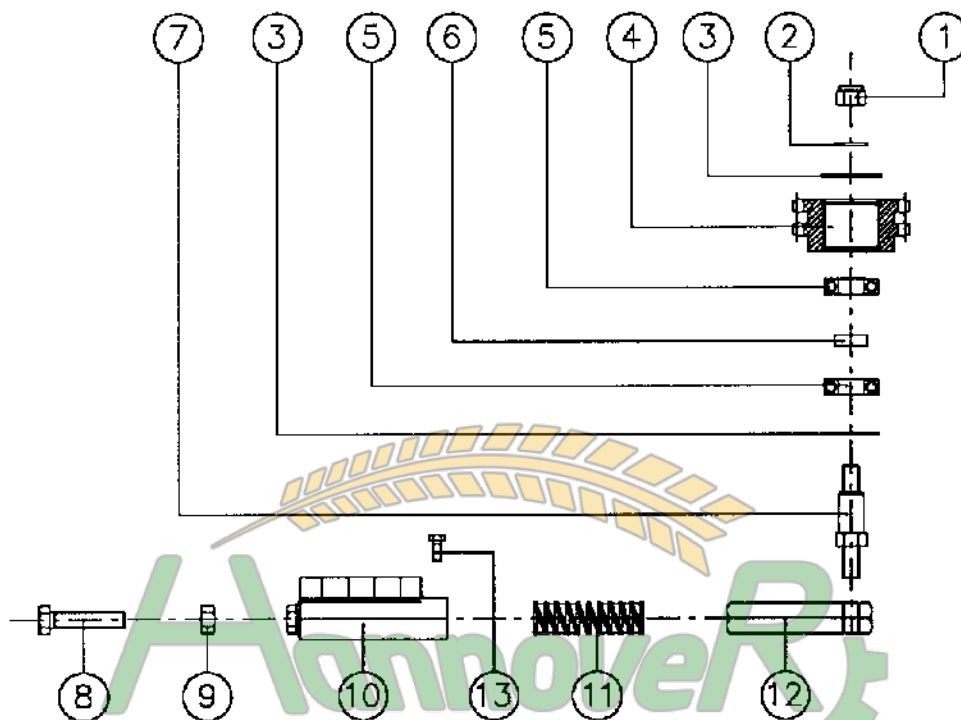

POS.	CODICE	DESCRIZIONE
1	B870059	DADO M16 ALTO AUTOBLOCCANTE
2	BZ870020	ROSETTA PER M16 ZINCATA
3	B870065	ANELLO ELAST. I52 UNI 7437-75
4	SR0616	PIGNONE Z17ASA60 DOPPIO
5	CU870010	CUSCINETTO 6205-2RS
6	SR0617	DISTANZIALE TENDITORE
7	SR0619	ALBERINO PER TENDITORE
8	BZ870025	VITE M16x70 UNI 7537 ZINCATA
9	BZ870027	DADO M16 ALTO UNI 5587
10	SR0615	BLOCCO FISSO TENDITORE
11	SR0618	MOLLA TENDITORE
12	SR0614	PERNO ESAGONALE SCORREVOLE
13	BZ870030	VITE M8x20 UNI 5739 ZINCATA

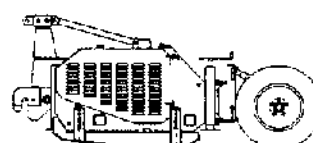

TRASM. POST. - SUPPORTO TRASM -ø

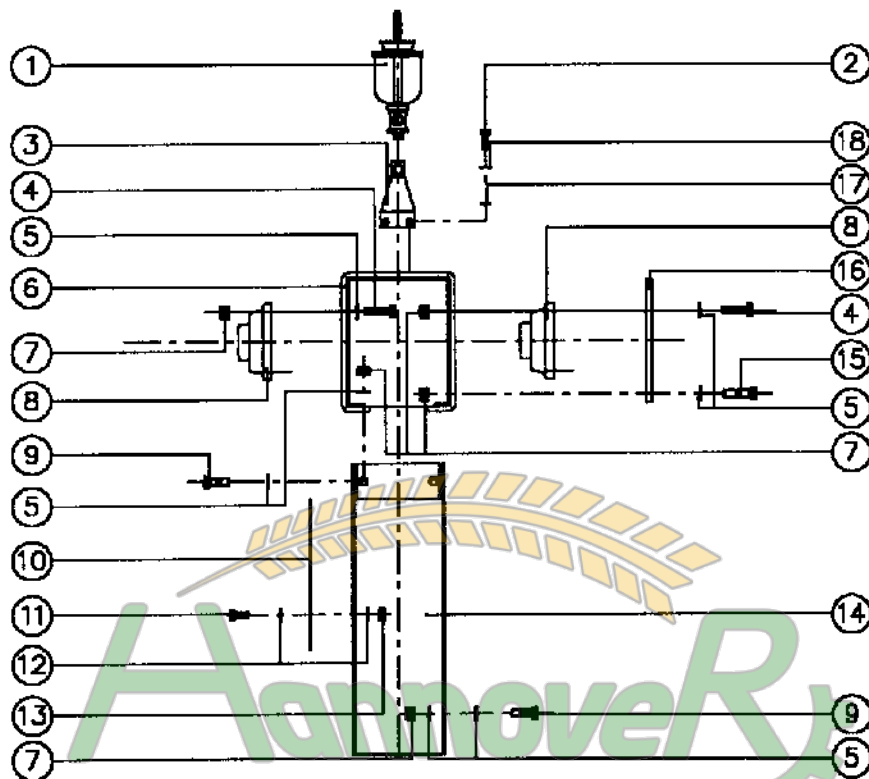

POS. CODICE DESCRIZIONE

1	SR0722	OLIATORE CATENA TRASMISSIONE
2	BZ870016	VITE M8x25 UNI 5739 ZINCATA
3	SR0736	SUPPORTO PER OLIATORE
4	BZ90007	VITE M12x45 UNI 5739 ZINCATA
5	BZ870035	ROSETTA PER M12 UNI 6593 ZINC.
6	SR0236	SUPPORTO TRASMISSIONE SX
6	SR0294	SUPPORTO TRASMISSIONE DX
6	SR0421	SUPPORTO TRASMISSIONE SX LUNGO
6	SR0414	SUPPORTO TRASMISSIONE DX LUNGO
7	B870028	DADO M12 AT.TO AUTOBLOCCANTE
8	S870002	SUPPORTO UCF BLOCCAGGIO ECC.
9	BZ870002	VITE M12x35 UNI 5739 ZINC.
10	SR0298	LAMIERA CHIUSURA TRASMISSIONE
10	SR0423	LAMIERA CHIUSURA TRASM. LUNGA
11	BZ870010	VITE M10x25 UNI 5739 ZINCATA
12	BZ870007	GREMBIAIINA 10x30x3 ZINCATA
13	B870013	DADO M10 h=0.8 FLANG. TEMPR.
14	SR0295	RINFORZO PER SUPP. TRASMISSIONE
14	SR0424	RINFORZO PER SUPP. TRASM. LUNGO
15	BZ90001	VITE M12x50 UNI 5737 ZINCATA
16	SR0299	LAMIERA PER TRASM. N.H. FISSA
17	BZ870013	ROSETTA PER M8 ZINCATA
18	BZ870014	R.D.E. PER M8 UNI 8842 ZINC.

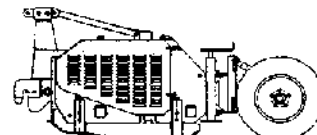
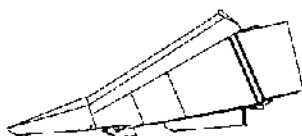

TRASMISSIONE POSTERIORE

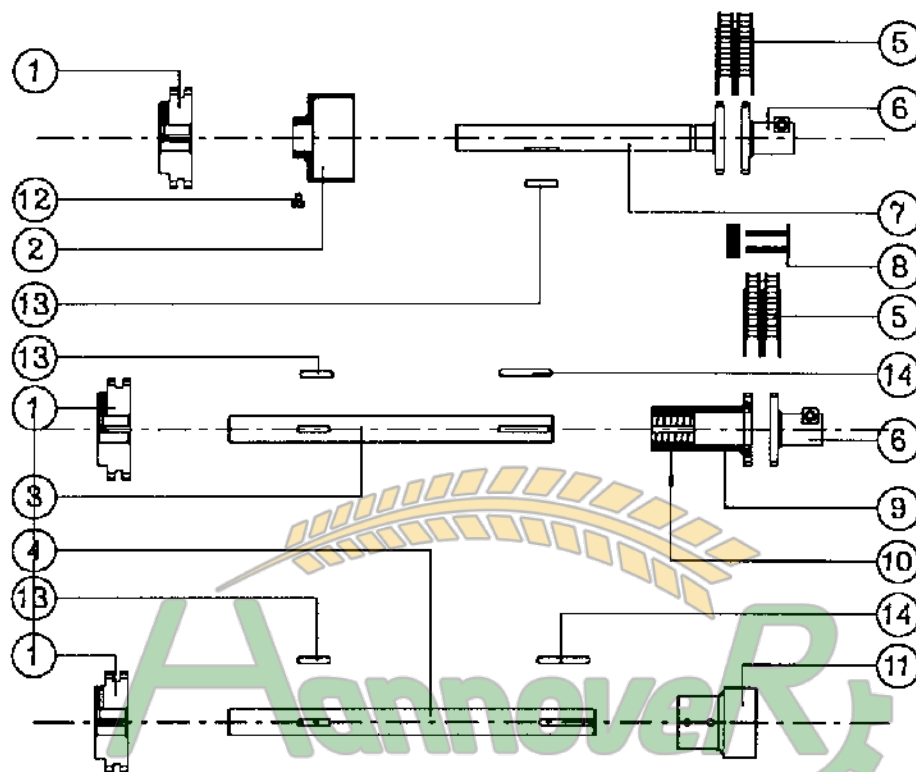

POS. CODICE DESCRIZIONE

1	SR0626	PIGNONE Z24ASA60 DOPPIO F40
1	SR0627	PIGNONE Z15ASA60 DOPPIO
1	SR0628	PIGNONE Z22ASA60 DOPPIO
1	SR0629	PIGNONE Z19ASA60 DOPPIO
2	SR0767	BUSSOLA PER TRASSMISS. CLASS PH
3	SR0761	ALBERO TRASM. Dx I.H. 6x80 PH
3	SR0762	ALBERO TRASM. Sx I.H. 6x80 PH
3	SR0632	ALBERO TRASM. Dx I.H.
3	SR0633	ALBERO TRASM. Sx I.H.
3	SR0605	ALBERO TRASM. Tx 36
4	SR0155	ALBERO TRASM. N.H.
4	SR0750	ALBERO TRASM. N.H. 6x70
5	C92028	CATENA ASA60 DOPPIA 11 PASSI
6	SR0607	GINUTO CAT. 1"3/8 CON BOTTONE
6	SR0634	GIUNTO CAT. 1"1/8 CON BOTTONE
7	SR0765	ALB. Dx 6x75 CLASS PH L 455
7	SR0766	ALB. Sx 6x75 CLASS PH L 360
7	SR0769	ALB. Dx 6x80 CLASS PH L 435
7	SR0770	ALB. Sx 6x80 CLASS PH L 530
7	SR0772	ALB. Dx N.H. 6x75 L 407.5
7	SR0774	ALB. Sx N.H. 6x80 L 482.5
7	SR0903	ALB. Tx 36 L 357
7	SR0915	ALB. LAVERDA 624 L 345.5

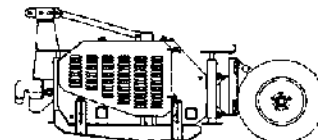

TRASMISSIONE POSTERIORE

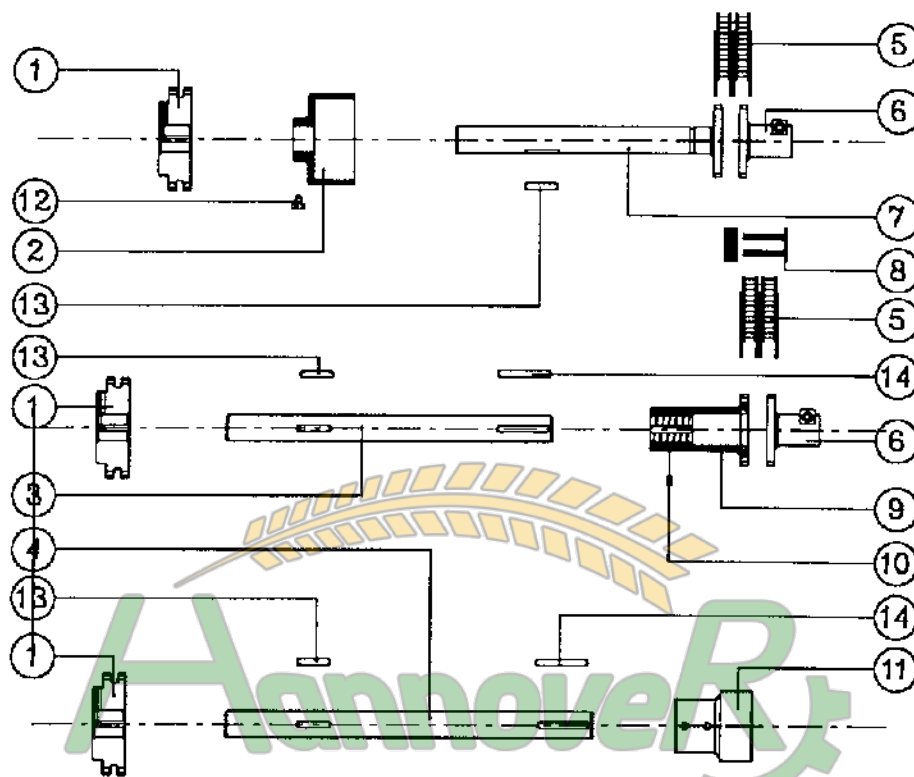

POS. CODICE DESCRIZIONE

8	C92020	GIUNTO CATENA ASA 80 DOPPIO
9	SR0606	GIUNTO CATENA FORO 40 mm
10	B870092	INGRASSATORE 1/8 GAS DIRITTO
11	GS87802	GIUNTO N.H. IN GHISA
12	KA1214	VITE CON BOMBATURA
13	B870056	LINGUETTA 10x8x50 UNI6604-69A
14	B870057	LINGUETTA 10x8x80 UNI6604-69A

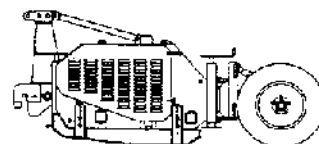
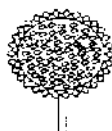

KIT MIX E TRASM. INFERIORE

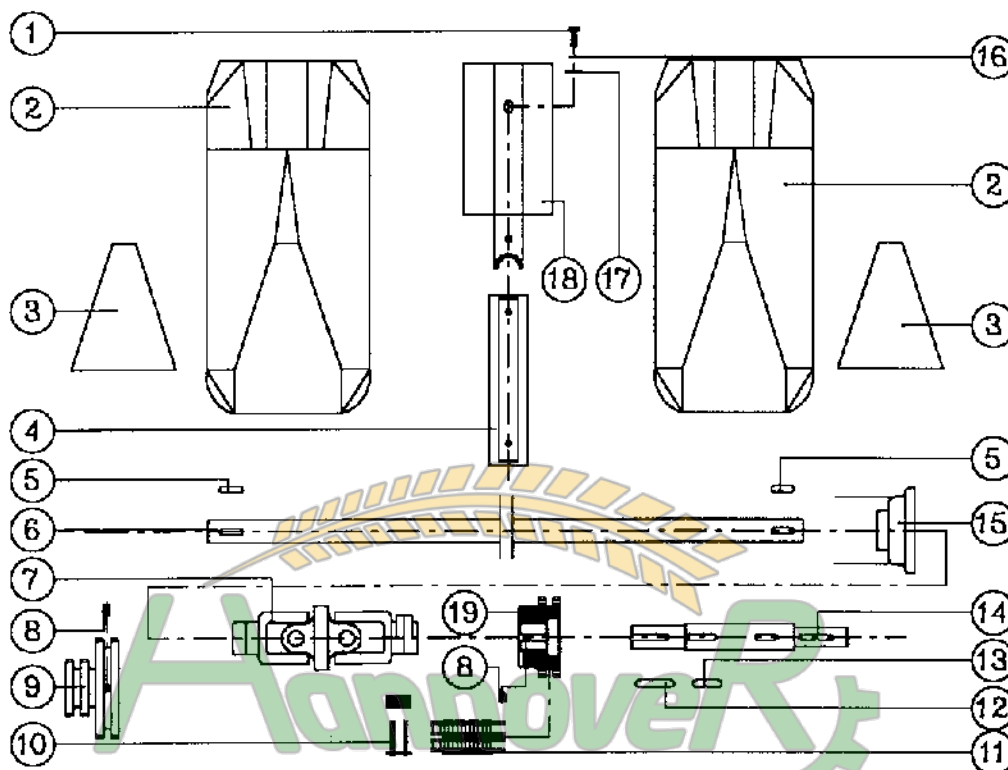

POS.	CODICE	DESCRIZIONE
1	BZ870016	VITE TE M8x25 UNI 5739 ZINC.
2	SR0798	COFANO LAT.PUNT.RIB.DX R70 MIX
2	SR0581	COFANO LAT.PUNT.RIB.DX R75 MIX
2	SR0541	COFANO LAT.PUNT.RIB.DX R80 MIX
2	SR0799	COFANO LAT.PUNT.RIB.SX R70 MIX
2	SR0823	COFANO LAT.PUNT.RIB.SX R75 MIX
2	SR0648	COFANO LAT.PUNT.RIB.SX R80 MIX
3	90722/70	COPERCHIO PER COFANO MIX R. 70
3	90722/75	COPERCHIO PER COFANO MIX R. 75
3	90722/80	COPERCHIO PER COFANO MIX R. 80
4	90723	PIASTRA FISSAGGIO LAMA TAGLIO
5	B890002	LINGUETTA 10x8x35 UNI 6604-69
6	SR0230	ALBERO PASSANTE PER 6x75
6	SR0395	ALBERO PASSANTE PER 6x80
7	SP161849	FORCELLA DOPPIA DIAMETRO 35mm
8	B92157	GRANO A PUNTA M10x16
9	SR0820	PIGNONE Z13 724 ASA60 DOPPIO
10	C890008	GIUNTO CATENA ASA 60 DOPPIO
11	C91003	CATENA ASA 60 DOPPIO
12	B870056	LINGUETTA 10x8x50 UNI 6604-69A
13	B870104	LINGUETTA 10x8x45 UNI 6604-69
14	SR0229	ALBERO PER SCATOLA TRASMIS.

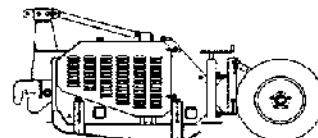
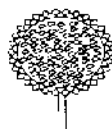
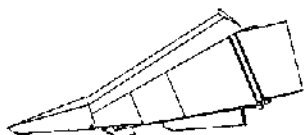

KIT MIX E TRASM. INFERIORE

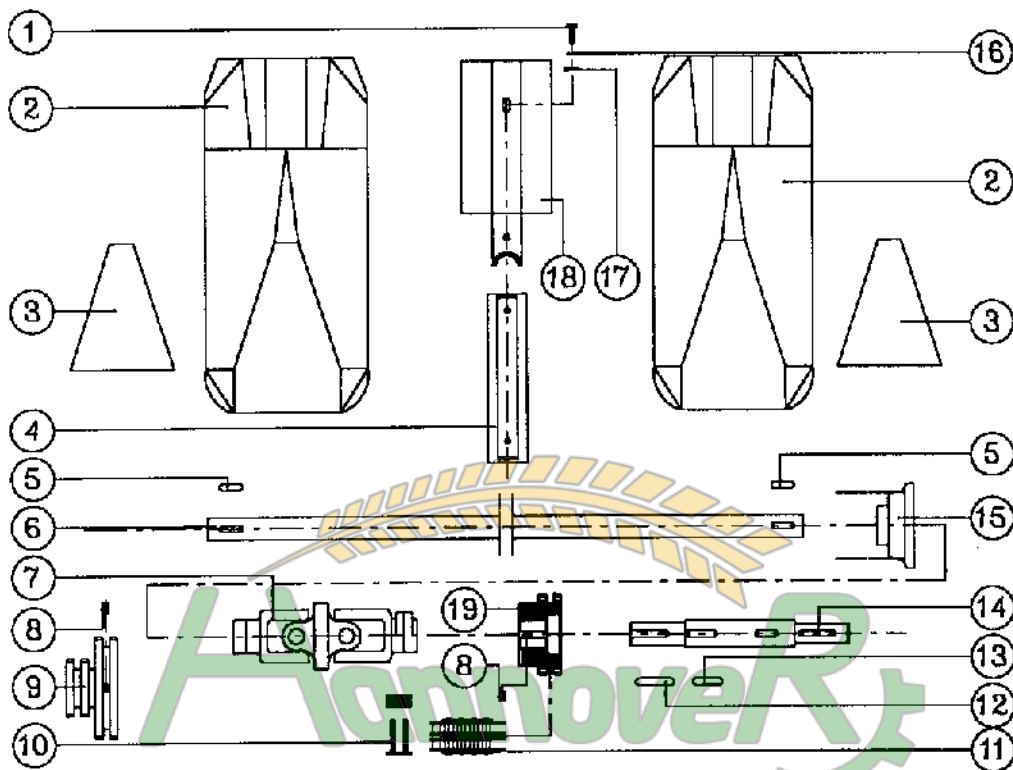

POS. CODICE DESCRIZIONE

15	S870002	SUPPORTO UCF 208 D.40mm
16	BZ870014	R.D.E. PER M8 UNI 8842 ZINC.
17	BZ870022	GREMBIALINA 8x24 UNI6593 ZINC.
18	90720	LAMA DA TAGLIO CON PIEGHE
19	SR0625	PIGNONE Z19 ASA 60 DOPPIO

